

NOTE:

1. EXISTING PAVEMENT MARKINGS TO BE REMOVED WHEN IN CONFLICT WITH STAGING AND PERMANENT PAVEMENT MARKINGS. SEE STAGING AND PAVEMENT MARKING PLAN SHEETS AS TO LOCATIONS OF REMOVAL.
2. CONTRACTOR TO SAWCUT ALONG EXISTING PAVEMENT AND SHOULDER AS NECESSARY FOR REMOVAL TO CONSTRUCT CROSSOVERS AND PAVEMENT WIDENING. COST OF SAWCUT INCLUDED IN COST OF REMOVAL ITEM FOR WHICH THE SAWCUT IS BEING MADE.
3. REMOVAL OF OUTLET AND HEADWALL AT EXISTING PIPE UNDERDRAIN OUTLETS TO BE INCLUDED IN COST OF PIPE UNDERDRAIN REMOVAL (SPECIAL).
4. LIMITS OF GUARDRAIL REMOVAL NEAR STRUCTURES MAY VARY IN THE FIELD.

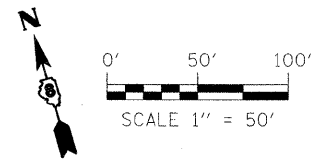
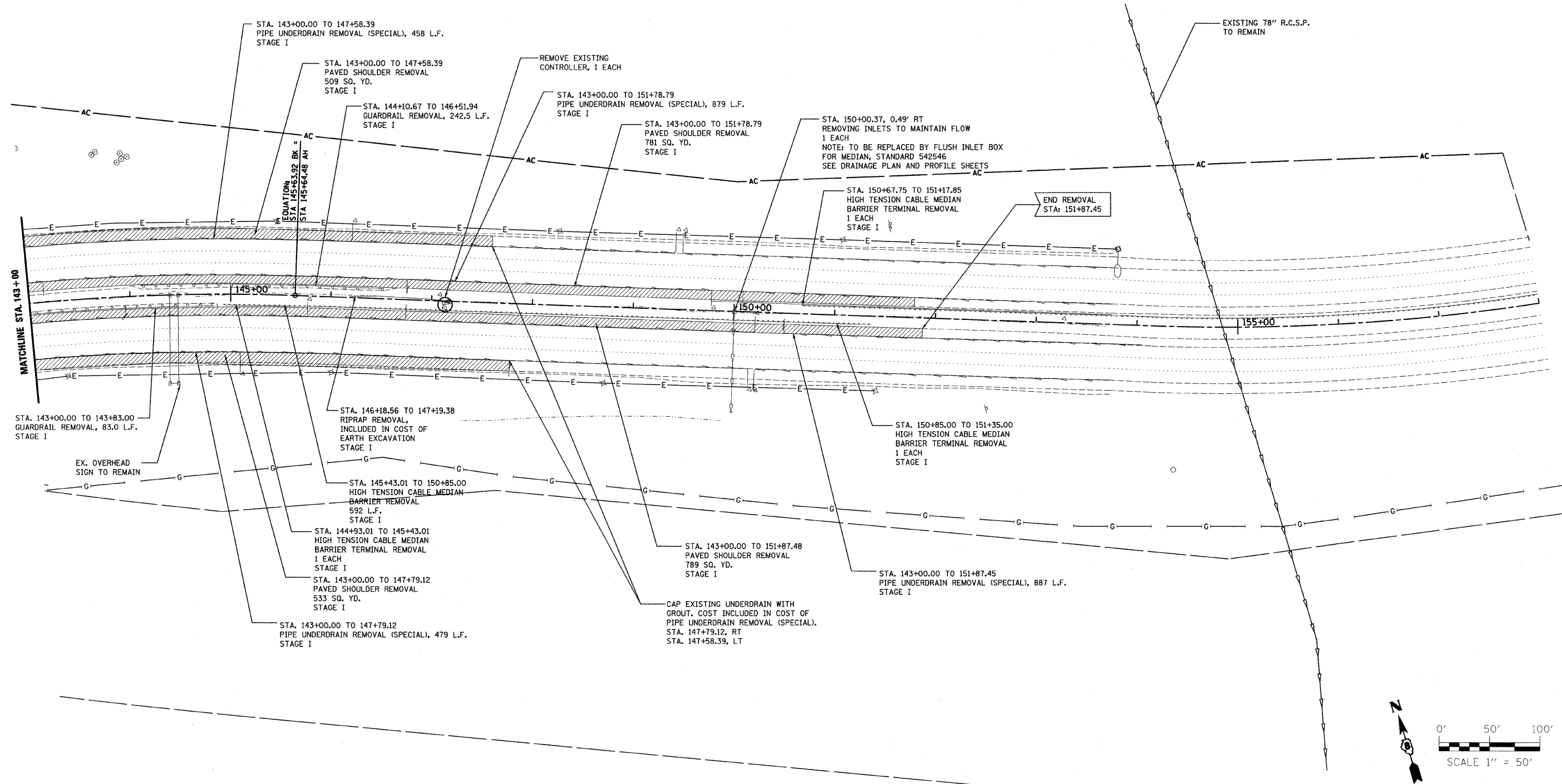

FILE NAME = P:\0605018\dn\CADD Sheets\0876876-sh	USER NAME = jheger	DESIGNED - DRB	REVISD -	STATE OF ILLINOIS DEPARTMENT OF TRANSPORTATION	REMOVAL PLAN		F.A.I. RTE. 64	SECTION 82-2VB-2	COUNTY ST. CLAIR	TOTAL SHEETS 153	SHEET NO. 15	
	em-083.dgn	DRAWN - MLS	REVISD -		SCALE: 1:50	SHEET NO. 3 OF 3 SHEETS	STA. 143+00.00 TO STA. 151+87.45	CONTRACT NO. 76867				
	PLOT SCALE = 50.0000' / IN.	CHECKED - SJK	REVISD -		FED. ROAD DIST. NO. 8 ILLINOIS FED. AID PROJECT							
	PLOT DATE = 8/7/2009	DATE -	REVISD -									