

LEGEND

OVERHEAD BRIDGE ABOVE

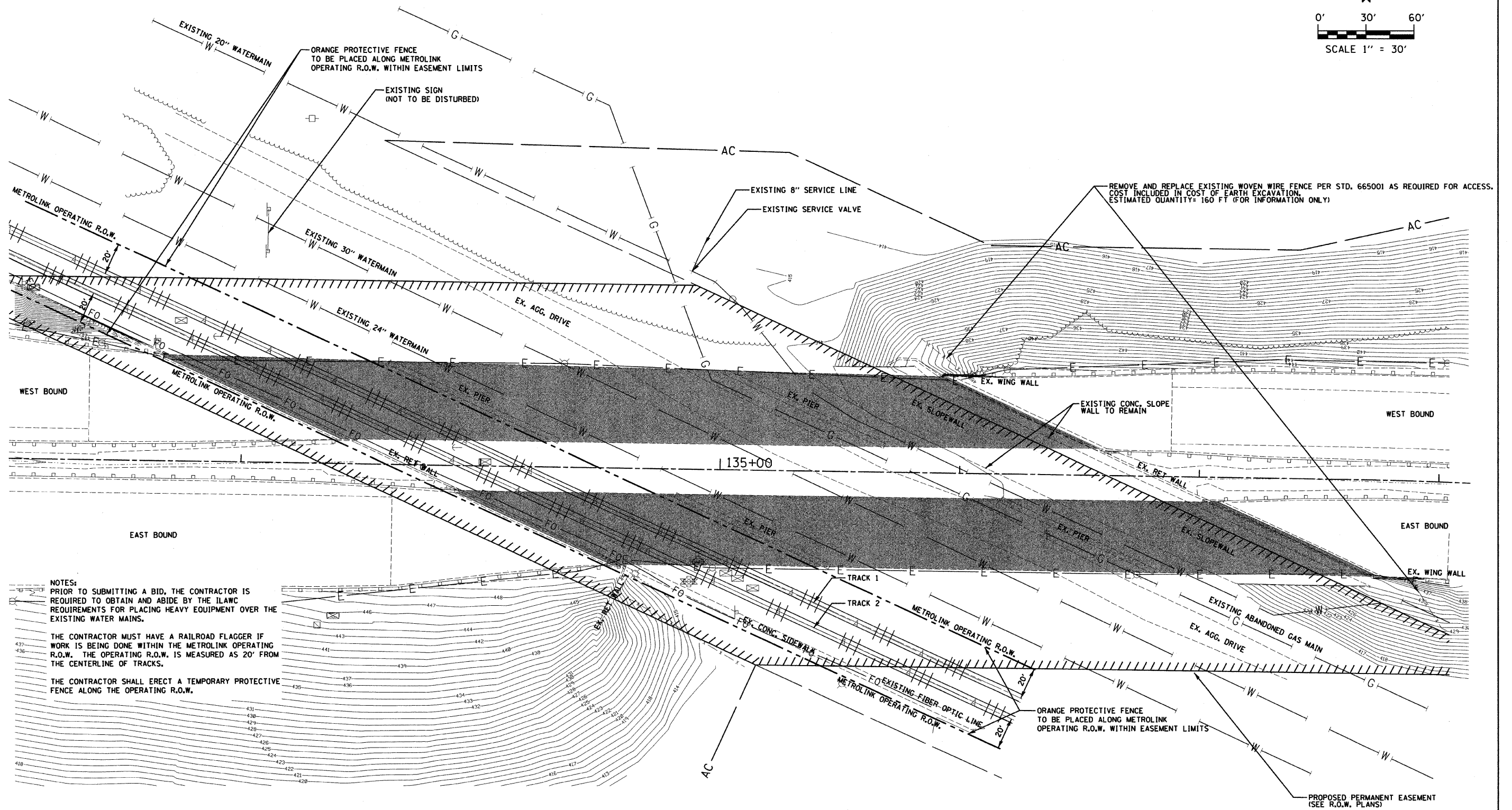
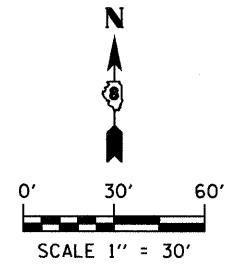

NOTES:  
 PRIOR TO SUBMITTING A BID, THE CONTRACTOR IS REQUIRED TO OBTAIN AND ABIDE BY THE ILWC REQUIREMENTS FOR PLACING HEAVY EQUIPMENT OVER THE EXISTING WATER MAINS.  
 THE CONTRACTOR MUST HAVE A RAILROAD FLAGGER IF WORK IS BEING DONE WITHIN THE METROLINK OPERATING R.O.W. THE OPERATING R.O.W. IS MEASURED AS 20' FROM THE CENTERLINE OF TRACKS.  
 THE CONTRACTOR SHALL ERECT A TEMPORARY PROTECTIVE FENCE ALONG THE OPERATING R.O.W.

FILE NAME = P:\060501B\CADD Sheets\0676876-sht	USER NAME = jheger	DESIGNED - DRB	REVISED -	<b>STATE OF ILLINOIS DEPARTMENT OF TRANSPORTATION</b>	<b>EXISTING SITE PLAN</b>			F.A.I. RTE. 64	SECTION 82-2VB-2	COUNTY ST. CLAIR	TOTAL SHEETS 153	SHEET NO. 19
PLOT SCALE = 30.0000' / IN.	CHECKED - SJK	DRAWN - DRB	REVISED -		SCALE: 1:30	SHEET NO. 1 OF 1 SHEETS	STA. 132+95 TO STA. 138+20	CONTRACT NO. 76867				
PLOT DATE = 8/7/2009	DATE -	CHECKED - SJK	REVISED -		FED. ROAD DIST. NO. 8 ILLINOIS FED. AID PROJECT							
		DATE -	REVISED -									