

DATE: \_\_\_\_\_ BY: \_\_\_\_\_  
 SURVEYED: \_\_\_\_\_  
 PLOTTED: \_\_\_\_\_  
 CHECKED: \_\_\_\_\_  
 RT. OF WAY CHECKED: \_\_\_\_\_  
 NO. CAD FILE NAME: \_\_\_\_\_

DATE: \_\_\_\_\_ BY: \_\_\_\_\_  
 SURVEYED: \_\_\_\_\_  
 PLOTTED: \_\_\_\_\_  
 CHECKED: \_\_\_\_\_  
 B.M. NOTED: \_\_\_\_\_  
 STRUCTURE NOTATING CRKD: \_\_\_\_\_

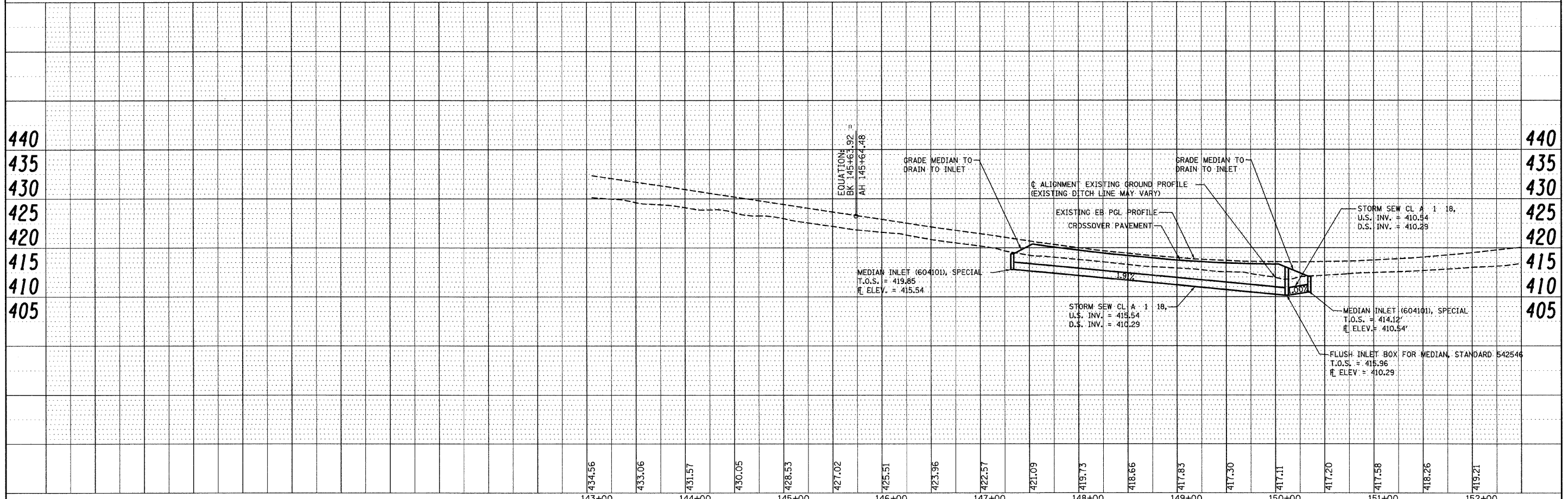
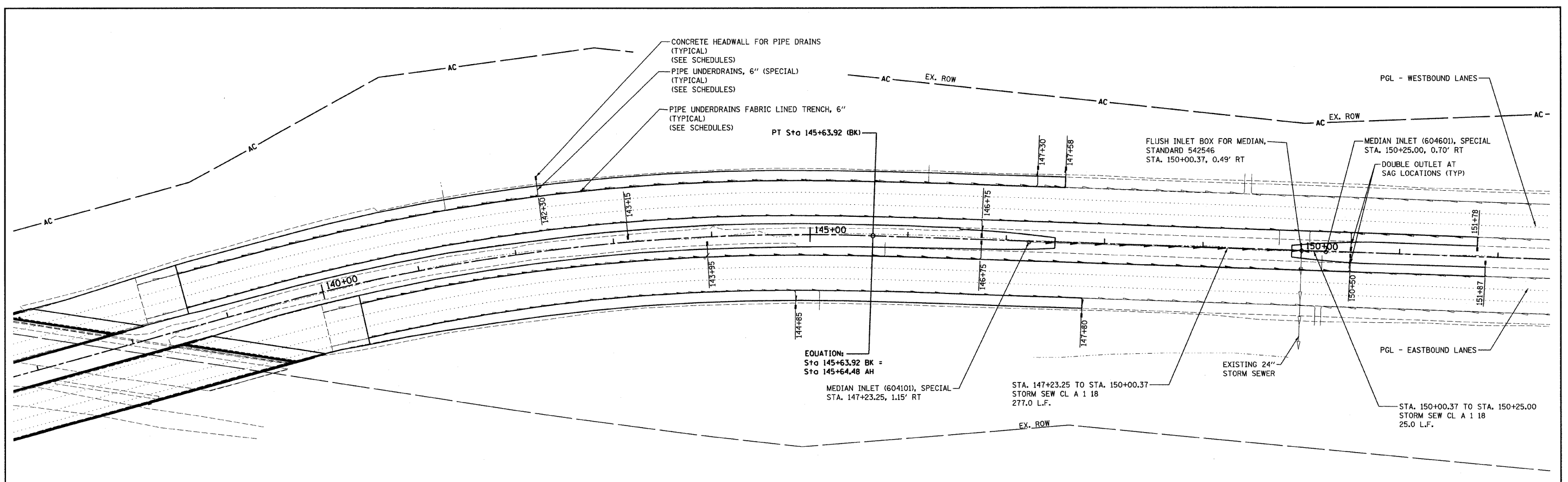

FILE NAME =	USER NAME = mschwier.john	DESIGNED - JWS	REVISED -	<b>STATE OF ILLINOIS DEPARTMENT OF TRANSPORTATION</b>	<b>DRAINAGE PLAN AND PROFILE</b>	F.A.I. RTE. 64	SECTION 82-2VB-2	COUNTY ST. CLAIR	TOTAL SHEETS 153	SHEET NO. 46	
PA:\0686018\dgn\CADD Sheets\0876876-shd-drainage-002.dgn	PLOT SCALE = 50.0000' / IN.	DRAWN - JWS	REVISED -			CONTRACT NO. 76867					
PLOT DATE = 8/7/2009	DATE = 8/7/2009	CHECKED - SJK	REVISED -			SCALE: 1" = 50' SHEET NO. 2 OF 2 SHEETS STA. 143+00.00 TO STA. 151+87.45					
		DATE = 8/7/2009	REVISED -			FED. ROAD DIST. NO. 8 ILLINOIS FED. AID PROJECT					