

NOTE:
 SIGNAGE TO REMAIN IN PLACE
 PAVEMENT MARKING TO BE PLACED AS INDICATED IN STANDARD 780001.
 RAISED REFLECTIVE PAVEMENT MARKERS TO BE PLACED AS INDICATED IN STANDARD 781001.
 PREFORMED PLASTIC PAVEMENT MARKING SHALL BE UTILIZED WITHIN LIMITS OF TRANSITION PAVEMENT, BRIDGE APPROACH PAVEMENT (SPECIAL), AND THE BRIDGE. ALL OTHER LOCATIONS SHALL UTILIZE THERMOPLASTIC PAVEMENT MARKING.

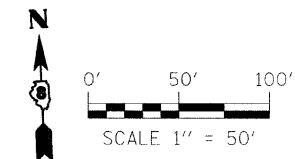
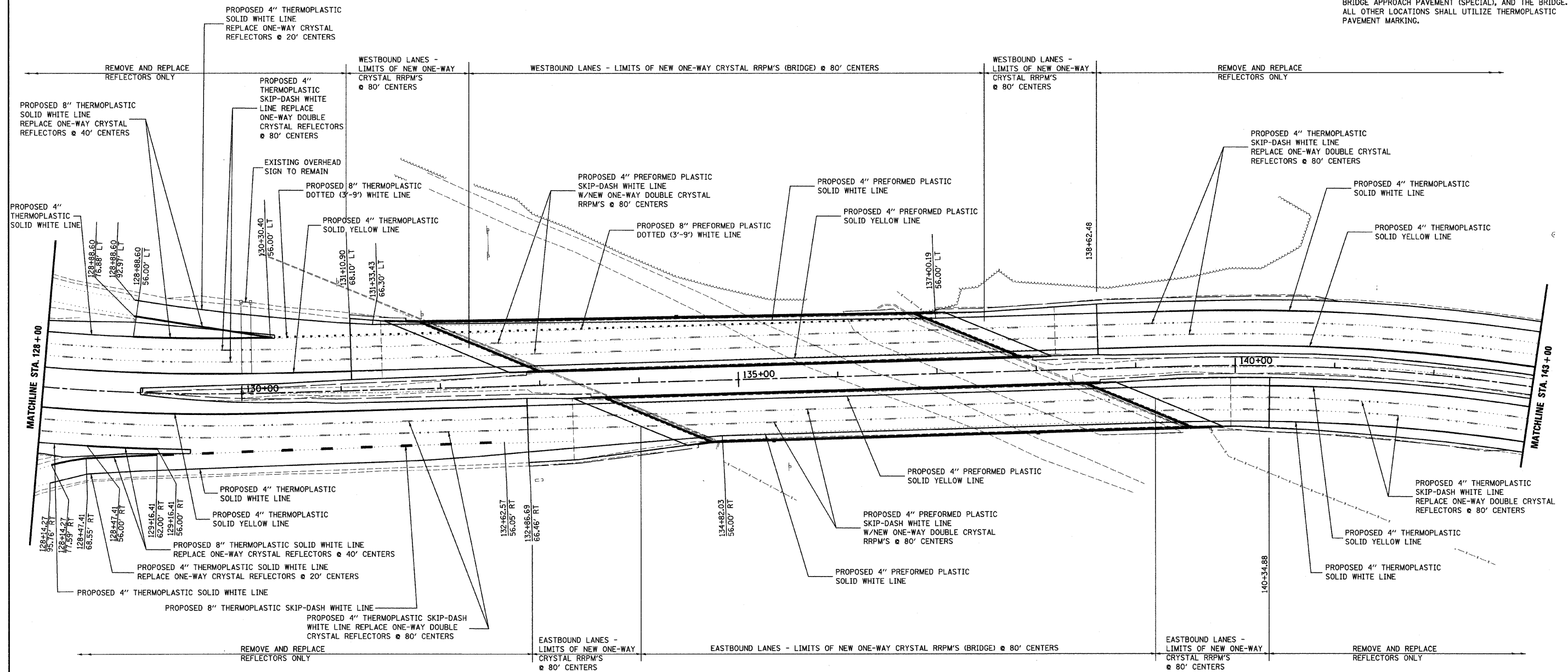

FILE NAME =	USER NAME = machwier-john	DESIGNED - DRB	REVISED -	STATE OF ILLINOIS DEPARTMENT OF TRANSPORTATION	PAVEMENT MARKING PLAN	F.A.I. RTE.	SECTION	COUNTY	TOTAL SHEETS	SHEET NO.
P:\060601B\1\0\CADD Sheets\0876876-sht-bank-002.dgn	DRAWN - MLS	REVISED -	64			82-2VB-2	ST. CLAIR	153	52	
PLOT SCALE = 50.0000' / IN.	CHECKED - SJK	REVISED -	CONTRACT NO. 76867							
PLOT DATE = 8/7/2009	DATE -	REVISED -	FED. ROAD DIST. NO. 8 ILLINOIS FED. AID PROJECT							
					SCALE:	SHEET NO. 2 OF 4 SHEETS		STA. 128+00.00 TO STA. 143+00.00		