

STATE OF ILLINOIS  
 DEPARTMENT OF TRANSPORTATION  
 DIVISION OF HIGHWAYS  
**PROPOSED  
 HIGHWAY PLANS**

F.A.P. RTE.	SECTION	COUNTY	TOTAL SHEETS	SHEET NO.
600	60-(30,31,128)-2	MADISON	42	1
		ILLINOIS	CONTRACT NO. 76B87	

FOR INDEX OF SHEETS, SEE SHEET NO. 2

F.A.P. ROUTE 600 (IL 159)  
 SECTION 60-(30,31,128)-2

RESURFACING  
 MADISON COUNTY

C-98-057-09

PROJECT ENDS  
 STA. 675+08.79  
 LONGITUDE 89.9581  
 LATITUDE 38.7109

BRIDGE OMISSION  
 STA 663+16.60 TO  
 STA 666+08.27

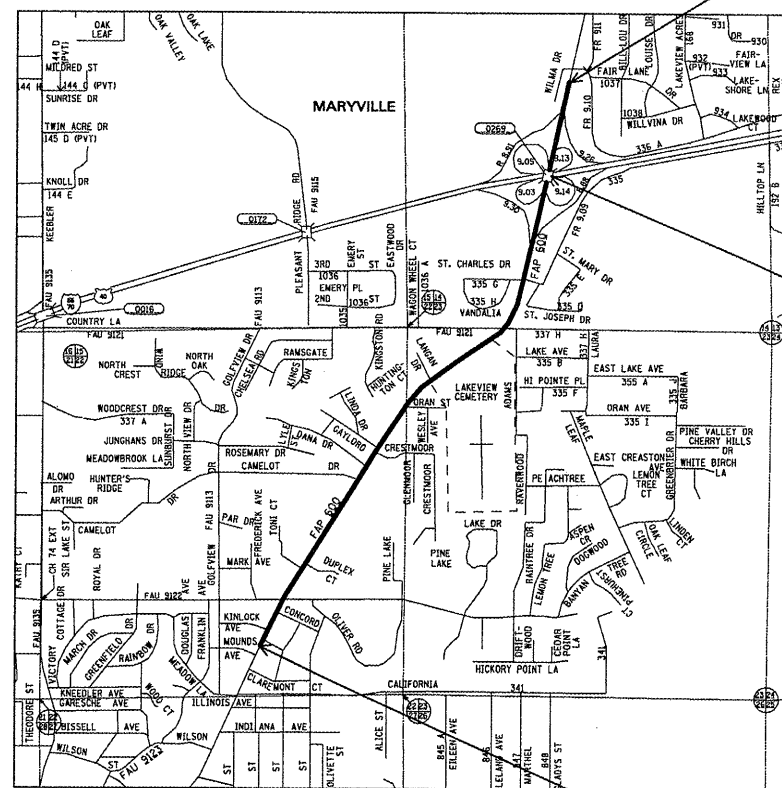

**LOCATION MAP**

NOT TO SCALE

GROSS LENGTH = 9162.44 FT. = 1.735 MILES  
 NET LENGTH = 8870.77 FT. = 1.680 MILES

PROJECT BEGINS  
 STA. 583+46.35  
 LONGITUDE 89.9735  
 LATITUDE 38.6892

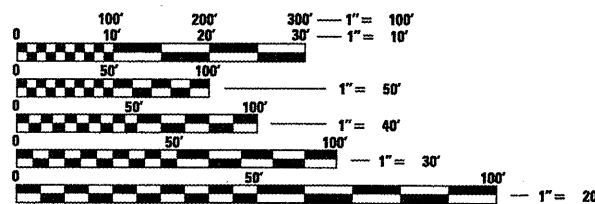

FULL SIZE PLANS HAVE BEEN PREPARED USING STANDARD ENGINEERING SCALES. REDUCED SIZED PLANS WILL NOT CONFORM TO STANDARD SCALES. IN MAKING MEASUREMENTS ON REDUCED PLANS, THE ABOVE SCALES MAY BE USED.

J.U.L.I.E.  
 JOINT UTILITY LOCATION INFORMATION FOR EXCAVATION  
 1-800-892-0123  
 OR 811

PROJECT ENGINEER: PATTI LEBEAU 618/346-3179  
 PROJECT MANAGER: CHERYL KEPLAR 618/346-3186

CONTRACT NO. 76B87

D-98-110-05

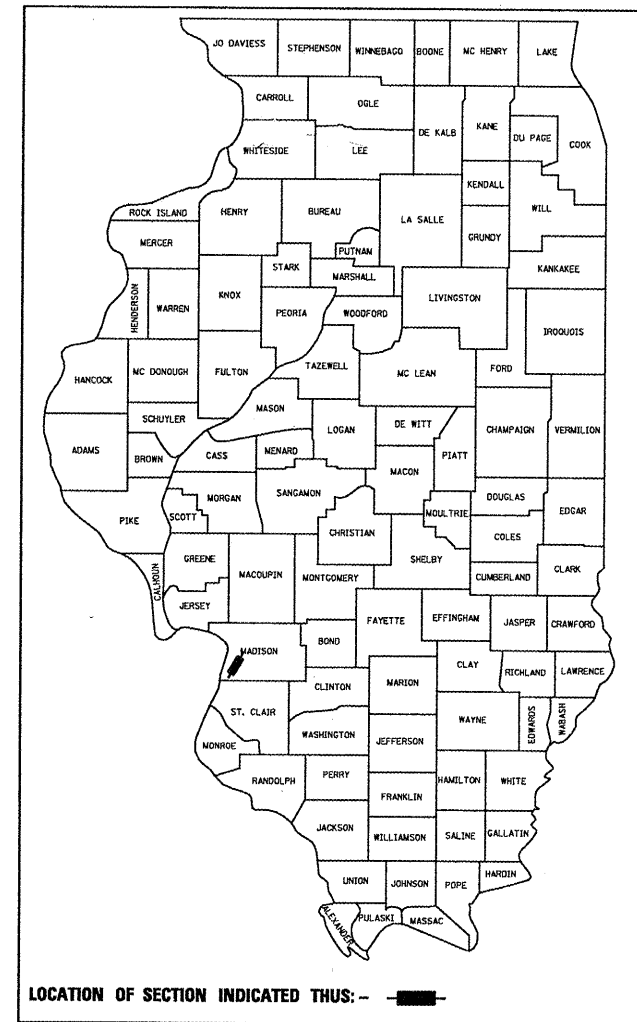

LOCATION OF SECTION INDICATED THUS: — ■ —

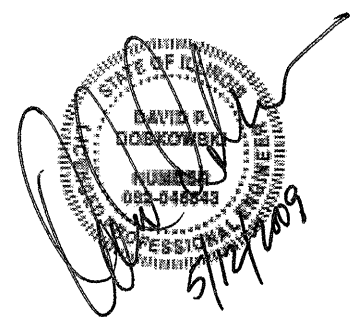

STATE OF ILLINOIS  
 DEPARTMENT OF TRANSPORTATION  
 DIVISION OF HIGHWAYS  
 SUBMITTED May 15 2009  
9 May James  
 DEPUTY DIRECTOR OF HIGHWAYS, REGION 5 ENGINEER  
October 2, 2009  
Charles G. Ingersoll  
 ENGINEER OF DESIGN AND ENVIRONMENT  
October 2, 2009  
Christine M. Reed  
 DIRECTOR OF HIGHWAYS, CHIEF ENGINEER

PRINTED BY THE AUTHORITY  
 OF THE STATE OF ILLINOIS