

PROPOSED IL ROUTE 159
STA. 583+64.35 TO STA. 629+85±
(LOOKING NORTH)

* BI-DIRECTIONAL TURN LANE BECOMES FLAT MEDIAN WHEN LESS THAN 12'
** STA 590+00± TO STA 610+00±

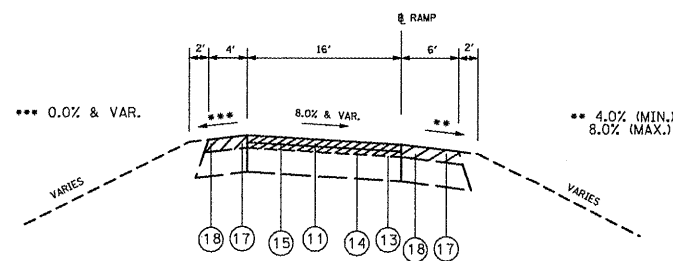

TYPICAL RAMP SECTION @ FAI 55/70
APPLIES ONLY TO RAMP FROM
STA. 654+00± TO STA. 675+00±

LEGEND

- ① PROPOSED HMA SURFACE REMOVAL, 2 1/4" - [diagonal hatching]
- ② PROPOSED BITUMINOUS PRIME COAT
- ③ PROPOSED AGGREGATE PRIME COAT
- ④ PROPOSED HMA LEVELING BINDER, 3/4"
- ⑤ PROPOSED HMA SURFACE COURSE, 1 1/2"
- ⑥ PROPOSED STRIP REFLECTIVE CRACK CONTROL TREATMENT
- ⑦ PROPOSED HMA SHOULDER REMOVAL, 2 1/4" - [diagonal hatching]
- ⑧ PROPOSED HMA SHOULDER, 2 1/4"

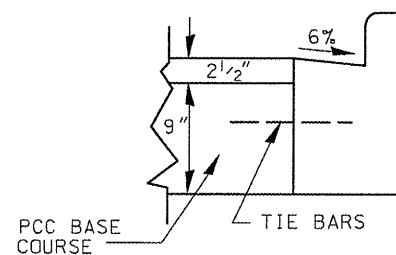

DETAIL A

STA. 690+36.00 TO STA. 691+68.00

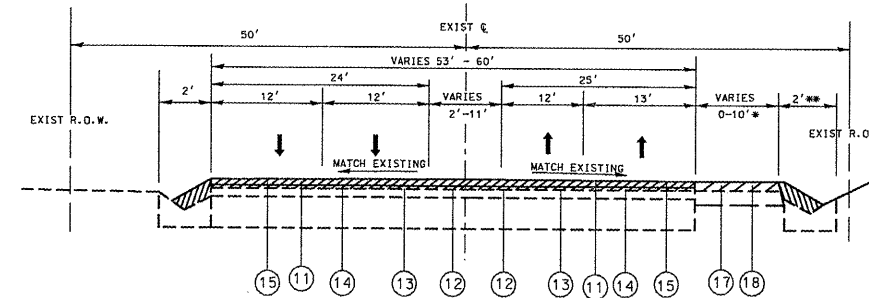

PROPOSED IL ROUTE 159
STA. 629+85± TO STA. 641+95.50
(LOOKING NORTH)

* NOT PRESENT FROM STA 629+85± TO STA 634+04.39
** NOT PRESENT FROM STA 634+04.39 TO STA 639+37.78

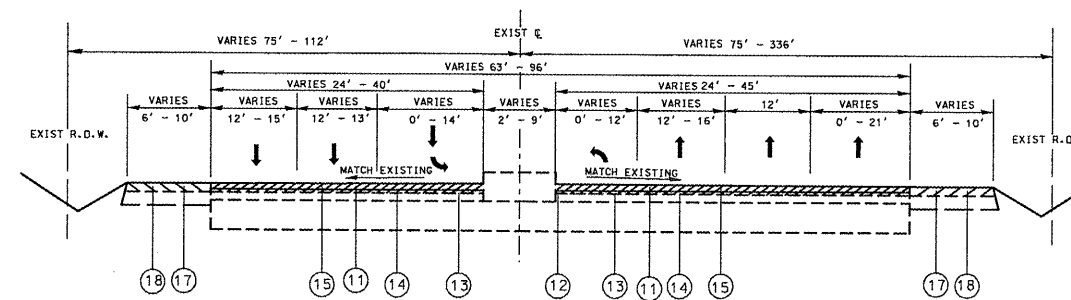

PROPOSED IL ROUTE 159
STA. 641+95.50 TO STA. 654+99.12
(LOOKING NORTH)

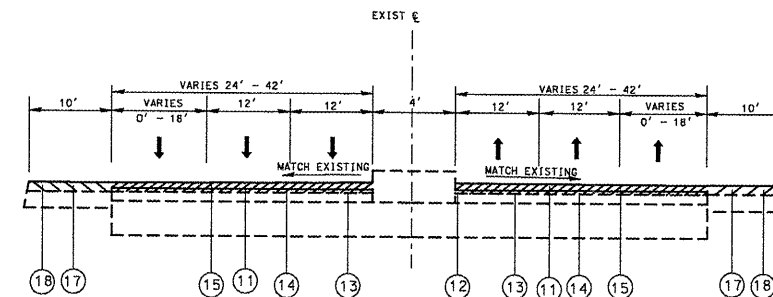

PROPOSED IL ROUTE 159
STA. 654+99.12 TO STA. 663+16.60
STA. 666+08.27 TO STA. 675+08.79
(LOOKING NORTH)

FILE NAME =	USER NAME = #USER#	DESIGNED - AAB	REVISED -	STATE OF ILLINOIS DEPARTMENT OF TRANSPORTATION	TYPICAL SECTIONS			F.A.P. RTE. 600	SECTION 60-(30,31,128)-2	COUNTY MADISON	TOTAL SHEETS 42	SHEET NO. 7
#FILE#	PLOT SCALE = #SCALE#	DRAWN - MNR	REVISED -		SCALE:	SHEET NO. 2 OF 2 SHEETS	STA.	TO STA.	CONTRACT NO. 76B87			
	PLOT DATE = #DATE#	CHECKED - AAA	REVISED -						ILLINOIS FED. AID PROJECT			
		DATE - MAY 12, 2009	REVISED -									