

PROP. CURVE 64E-3 PI STA. = 53+19.44 Δ = 6° 19' 10" (LT) D = 1° 35' 30" R = 3,600.00' T = 198.73' L = 397.06' E = 5.48' e = ----- T.R. = ----- S.E. RUN = ----- P.C. STA = 51+20.71 P.T. STA = 55+17.76	PROP. CURVE 64E-4 PI STA. = 58+88.81 Δ = 10° 35' 58" (LT) D = 1° 25' 57" R = 4,000.00' T = 371.05' L = 739.97' E = 17.17' e = ----- T.R. = ----- S.E. RUN = ----- P.C. STA = 55+17.76 P.T. STA = 62+57.74	PROP. CURVE 64E-5 PI STA. = 67+01.39 Δ = 13° 31' 16" (LT) D = 1° 31' 51" R = 3,742.50' T = 443.65' L = 883.18' E = 26.20' e = ----- T.R. = ----- S.E. RUN = ----- P.C. STA = 62+57.74 P.T. STA = 71+40.92	PROP. CURVE ST_CLR-1 PI STA. = 11+99.66 Δ = 17° 44' 08" (RT) D = 7° 09' 43" R = 800.00' T = 124.82' L = 247.64' E = 9.68' e = ----- T.R. = ----- S.E. RUN = ----- P.C. STA = 10+74.84 P.T. STA = 13+22.48	PROP. CURVE ST_CLR-2 PI STA. = 29+33.84 Δ = 22° 25' 05" (RT) D = 24° 54' 40" R = 230.00' T = 45.58' L = 89.99' E = 4.47' e = ----- T.R. = ----- S.E. RUN = ----- P.C. STA = 28+88.26 P.T. STA = 29+78.25	PROP. CURVE BAUGH-S-1 PI STA. = 12+42.25 Δ = 23° 23' 50" (LT) D = 9° 03' 32" R = 632.49' T = 130.97' L = 258.28' E = 13.42' e = ----- T.R. = ----- S.E. RUN = ----- P.C. STA = 11+11.28 P.T. STA = 13+69.57	PROP. CURVE RAMP-D-1 PI STA. = 400+32.53 Δ = 44° 06' 43" (LT) D = 71° 22' 07" R = 80.28' T = 32.53' L = 61.81' E = 6.34' e = ----- T.R. = ----- S.E. RUN = ----- P.C. STA = 400+00.00 P.T. STA = 400+61.81	PROP. CURVE RAMP-D-2 PI STA. = 401+07.44 Δ = 15° 33' 38" (LT) D = 17° 09' 16" R = 334.00' T = 45.63' L = 90.71' E = 3.10' e = ----- T.R. = ----- S.E. RUN = ----- P.C. STA = 400+61.81 P.T. STA = 401+52.52	PROP. CURVE RAMP-E-1 PI STA. = 11+49.99 Δ = 13° 51' 37" (RT) D = 4° 38' 35" R = 1,234.00' T = 149.99' L = 298.51' E = 9.08' e = ----- T.R. = ----- S.E. RUN = ----- P.C. STA = 10+00.00 P.T. STA = 12+98.51
---	---	---	---	--	---	--	---	---

PROP. CURVE 64W-1 PI STA. = 73+67.12 Δ = 6° 45' 48" (RT) D = 1° 27' 01" R = 3,950.66' T = 233.44' L = 466.34' E = 6.89' e = ----- T.R. = ----- S.E. RUN = ----- P.C. STA = 71+33.67 P.T. STA = 76+00.02	PROP. CURVE 64W-2 PI STA. = 79+29.11 Δ = 9° 39' 54" (RT) D = 1° 28' 19" R = 3,892.58' T = 329.09' L = 656.62' E = 13.89' e = ----- T.R. = ----- S.E. RUN = ----- P.C. STA = 76+00.02 P.T. STA = 82+56.64	PROP. CURVE 64W-3 PI STA. = 83+20.10 Δ = 2° 30' 26" (RT) D = 1° 58' 33" R = 2,900.00' T = 63.46' L = 126.91' E = 0.69' e = ----- T.R. = ----- S.E. RUN = ----- P.C. STA = 82+56.64 P.T. STA = 83+83.54	PROP. CURVE 64W-4 PI STA. = 85+63.51 Δ = 4° 34' 49" (RT) D = 1° 16' 24" R = 4,500.00' T = 179.97' L = 359.74' E = 3.60' e = ----- T.R. = ----- S.E. RUN = ----- P.C. STA = 83+83.54 P.T. STA = 87+43.28	PROP. CURVE 64W-5 PI STA. = 88+27.34 Δ = 3° 30' 05" (RT) D = 2° 05' 01" R = 2,750.00' T = 84.06' L = 168.06' E = 1.28' e = ----- T.R. = ----- S.E. RUN = ----- P.C. STA = 87+43.28 P.T. STA = 89+11.35	PROP. CURVE 64W-6 PI STA. = 90+75.92 Δ = 3° 21' 59" (RT) D = 1° 01' 23" R = 5,600.16' T = 164.57' L = 329.05' E = 2.42' e = ----- T.R. = ----- S.E. RUN = ----- P.C. STA = 89+11.35 P.T. STA = 92+40.39	PROP. CURVE RAMP-D-3 PI STA. = 402+33.30 Δ = 21° 16' 45" (RT) D = 13° 19' 29" R = 430.00' T = 80.78' L = 159.70' E = 7.52' e = ----- T.R. = ----- S.E. RUN = ----- P.C. STA = 401+52.52 P.T. STA = 403+12.22	PROP. CURVE RAMP-D-4 PI STA. = 403+72.94 Δ = 12° 57' 43" (RT) D = 10° 43' 07" R = 534.54' T = 60.72' L = 120.93' E = 3.44' e = ----- T.R. = ----- S.E. RUN = ----- P.C. STA = 403+12.22 P.T. STA = 404+33.14	PROP. CURVE RAMP-E-2 PI STA. = 17+13.80 Δ = 3° 44' 23" (RT) D = 2° 51' 53" R = 2,000.00' T = 65.29' L = 130.54' E = 1.07' e = ----- T.R. = ----- S.E. RUN = ----- P.C. STA = 16+48.51 P.T. STA = 17+79.05
---	--	--	---	--	---	--	--	---

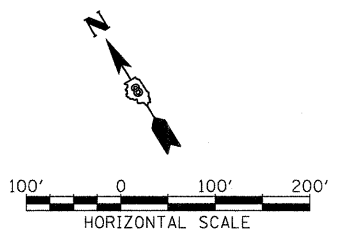
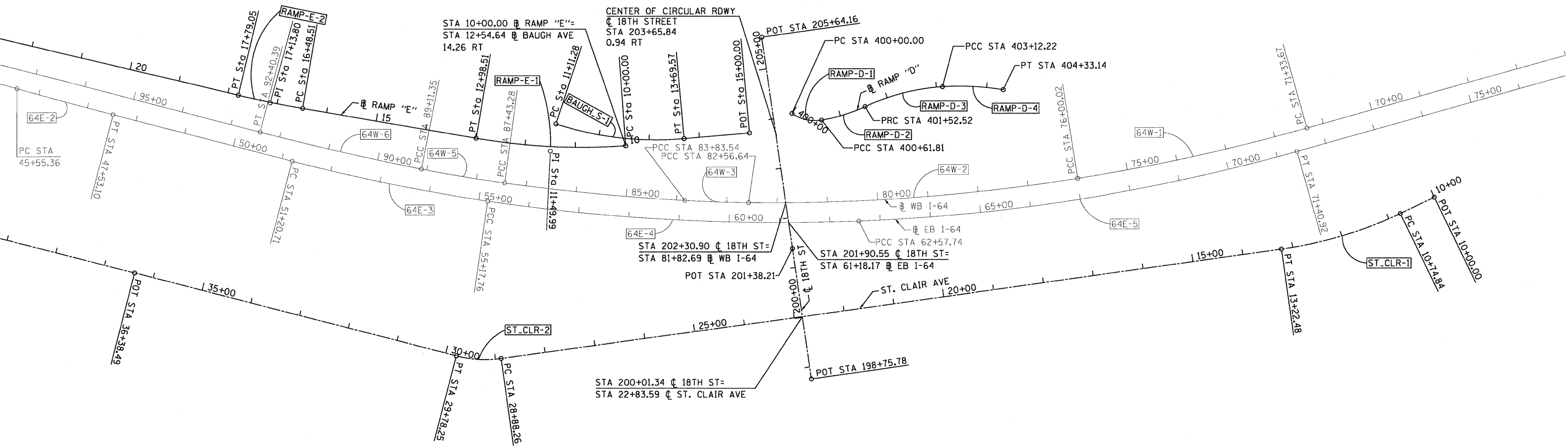

FILE NAME = DBTRI-76C38-shf-aligntiebm-01-03.dgn	USER NAME = jdf	DESIGNED - LDC	REVISED -	STATE OF ILLINOIS DEPARTMENT OF TRANSPORTATION	ALIGNMENT, TIES, AND BENCHMARKS	F.A.U. RTE. =	SECTION = 82-1-10N	COUNTY = ST. CLAIR	TOTAL SHEETS = 68	SHEET NO. = 16		
MODEL NAME = DBTRI-76C38-shf-aligntiebm-01	DRAWN = JDF	CHECKED = GEB	REVISED =			SCALE: 1"=100'	SHEET NO. 1 OF 3 SHEETS	STA. ----- TO STA. -----	FED. ROAD DIST. NO. = 9166/9180	CONTRACT NO. 76C38		
PLOT SCALE = 1:1000	DATE = 08/14/09	REVISED =	REVISED =			ILLINOIS FED. AID PROJECT						
PLOT DATE = 8/13/2009	DATE = 08/14/09	REVISED =	REVISED =									