



**CHANGEABLE MESSAGE SIGN**

THE KANE COUNTY DEPARTMENT OF TRANSPORTATION REQUIRES THAT ELECTRONIC CHANGEABLE MESSAGE SIGNS BE PLACED ON THE EAST AND WEST SIDE OF THE BRIDGE TO WARN THE PUBLIC OF THE PENDING CLOSURE. THE MESSAGE BOARDS WILL NEED TO BE PLACED AND SET OUT FOR SEVEN (7) DAYS IN ADVANCE OF THE ANTICIPATED FIRST DAY OF CONSTRUCTION. THE SIGNS SHALL REMAIN IN PLACE FOR THE SPECIFIED CONTRACT TIME. THE CONTRACTOR WILL COORDINATE WITH THE RESIDENT ENGINEER ON THE EXACT PLACEMENT OF THE MESSAGE BOARDS AND THE MESSAGE THAT IS TO BE DISPLAYED. THE MESSAGE MAY PERIODICALLY BE CHANGED BY THE COUNTY. THERE WILL BE NO ADDITIONAL COMPENSATION FOR CHANGING OF THE MESSAGE(S). THE MESSAGE BOARDS WILL BE PAID FOR AS CHANGEABLE MESSAGE SIGN, PER CALENDAR MONTH FOR EACH MESSAGE SIGN UTILIZED.

**TEMPORARY INFORMATION SIGN**

THE KANE COUNTY DEPARTMENT OF TRANSPORTATION REQUIRES THAT TEMPORARY INFORMATION SIGNING WILL BE ERRECTED ON THE EAST AND WEST SIDE OF THE BRIDGE TO INFORM THE PUBLIC OF THE CONSTRUCTION DURATION. THE CONTRACTOR WILL COORDINATE WITH THE RESIDENT ENGINEER ON THE EXACT PLACEMENT OF THE SIGN. THE SIGN SHALL BE IN PLACE FOR THE ENTIRE DURATION OF THE CONTRACT OR AS DIRECTED BY THE RESIDENT ENGINEER. THE TEMPORARY SIGN WILL BE AS DIMENSIONED ON STD. TC22 EXCEPT THE MESSAGE SHALL BE AS DETAILED ON THE DETOUR PLAN. THE SIGNING, WHICH INCLUDES POST AND MOUNTING, WILL BE PAID AS TEMPORARY INFORMATION SIGNING, PER EACH SIGN ERRECTED.

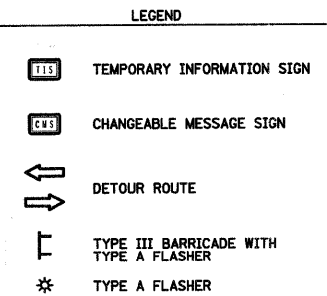
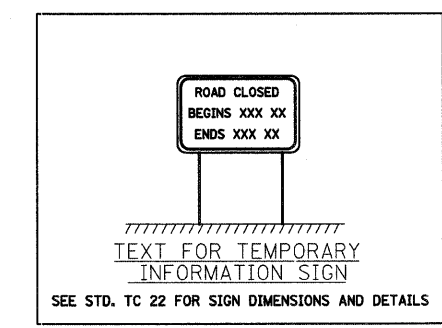

- GENERAL NOTES:**
- FURNISHING, ERRECTING, MAINTAINING AND REMOVING ALL TRAFFIC CONTROL DEVICES FOR THE CONSTRUCTION OF THE PROPOSED ROADWAY AND STRUCTURE IMPROVEMENTS, INCLUDING ALL TRAFFIC CONTROL DEVICES REQUIRED FOR THE TEMPORARY DETOUR ROUTES AS SHOWN IN THE PLANS, WILL BE MEASURED FOR PAYMENT ONE TIME ONLY AND SHALL BE PAID FOR AS TRAFFIC CONTROL AND PROTECTION FOR TEMPORARY DETOUR, LUMP SUM.
  - THE CONTRACTOR SHALL CONSTRUCT AND MAINTAIN AGGREGATE SURFACE COURSE FOR TEMPORARY ACCESS TO PRIVATE ENTRANCES AND FIELD ENTRANCES. THE TEMPORARY CLOSURE OF DRIVEWAYS WILL BE LIMITED TO THE DURATION OF THE CONSTRUCTION DIRECTLY IN FRONT OF THE DRIVEWAYS. IN ALL CASES, THE ENTRANCES SHALL BE OPEN AT THE END OF THE WORK DAY. THE CONTRACTOR SHALL COORDINATE CLOSURES WITH THE RESIDENT ENGINEER AND PROPERTY OWNER A MINIMUM OF FORTY EIGHT (48) HOURS IN ADVANCE OF THE CLOSURE.

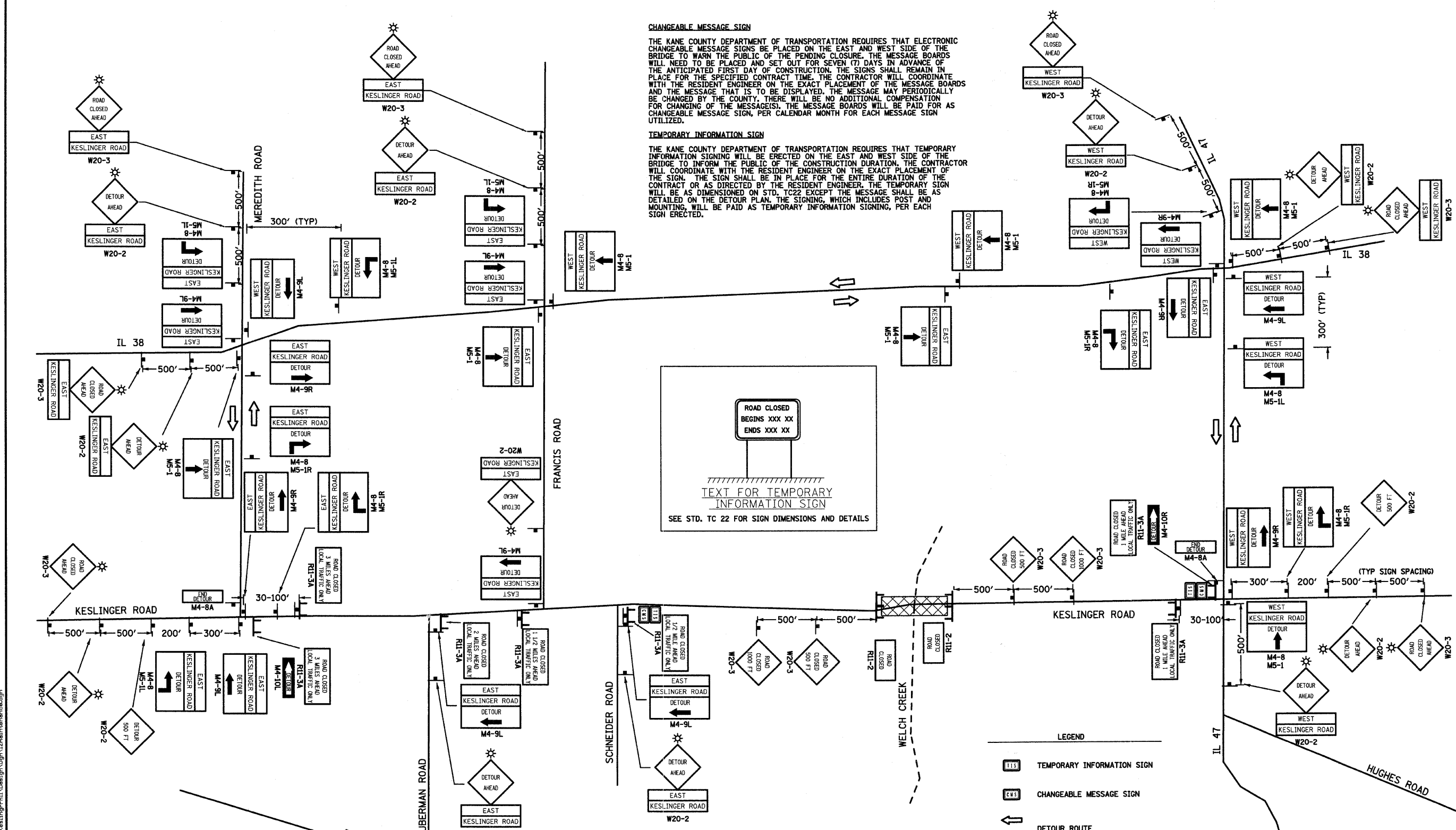

**TEMPORARY DETOUR DURATION**

THE CONTRACT DOCUMENTS WILL ALLOW THE ROADWAY CLOSURE AND TEMPORARY DETOUR DETAILED ON THIS SHEET TO BE IN PLACE FOR A DURATION OF SIXTY (60) CALENDAR DAYS. THE CONTRACTOR WILL BE EXPECTED TO COMPLETE ALL THE PROPOSED WORK RELATED TO THE CONSTRUCTION OF THE PROPOSED CULVERT AND ROADWAY DURING THIS CLOSURE. THE ROADWAY MUST HAVE THE HMA SURFACE COURSE PLACED AND THE GUARDRAIL INSTALLED BEFORE THE ROADWAY IS OPENED TO TRAFFIC. IF THE SURFACE COURSE AND GUARDRAIL ARE NOT COMPLETE IN THE ALLOWED TIME, ADDITIONAL TRAFFIC CONTROL DEVICES REQUIRED FOR THE COMPLETION OF REMAINING CONSTRUCTION OPERATIONS WILL BE AT THE CONTRACTOR COSTS.

<p>WILLS BURKE KELSEY ASSOCIATES LTD. 116 West Main Street, Suite 201 St. Charles, Illinois 60174 (630) 443-7755</p>	USER NAME = #USER#	DESIGNED - SBP	REVISED -	<b>STATE OF ILLINOIS</b> <b>DEPARTMENT OF TRANSPORTATION</b>	<b>MAINTENANCE OF TRAFFIC</b> <b>DETOUR PLAN</b>		F.A. RTE.	SECTION	COUNTY	TOTAL SHEETS	SHEET NO.
	PLOT SCALE = N.T.S.	DRAWN - TC	REVISED -		O110	01-00267-00-BR	KANE	37	12		
	PLOT DATE = 8/6/2009	CHECKED - SBP	REVISED -		SCALE: N.T.S. SHEET NO. 12 OF 37 SHEETS STA. TO STA.			CONTRACT NO. 83994			
		DATE - January 2008	REVISED -		FED. ROAD DIST. NO.		ILLINOIS FED. AID PROJECT				

FILE NAME = P:\DDBEL\WEST Proj\0809\123135\KeslingerPHITDesign\12\Maintenance.dgn