

NORTH EDGE OF SHOULDER

Location	Station	Offset	Theoretical Grade Elevations
Bk. of E. Abutment	48+70.25	-18.000	608.480
A3	48+80.25	-18.000	608.530
A4	48+90.25	-18.000	608.580
End of E. Approach Slab	49+00.25	-18.000	608.630

NORTH EDGE OF ROADWAY

Location	Station	Offset	Theoretical Grade Elevations
Bk. of E. Abutment	48+70.25	-12.000	608.500
A3	48+80.25	-12.000	608.533
A4	48+90.25	-12.000	608.567
End of E. Approach Slab	49+00.25	-12.000	608.600

℄ ROADWAY

Location	Station	Offset	Theoretical Grade Elevations
Bk. of E. Abutment	48+70.25	0.000	608.540
A3	48+80.25	0.000	608.540
A4	48+90.25	0.000	608.540
End of E. Approach Slab	49+00.25	0.000	608.540

SOUTH EDGE OF ROADWAY

Location	Station	Offset	Theoretical Grade Elevations
Bk. of E. Abutment	48+70.25	12.000	608.353
A3	48+80.25	12.000	608.353
A4	48+90.25	12.000	608.353
End of E. Approach Slab	49+00.25	12.000	608.353

SOUTH EDGE OF SHOULDER

Location	Station	Offset	Theoretical Grade Elevations
Bk. of E. Abutment	48+70.25	18.000	608.259
A3	48+80.25	18.000	608.259
A4	48+90.25	18.000	608.259
End of E. Approach Slab	49+00.25	18.000	608.259

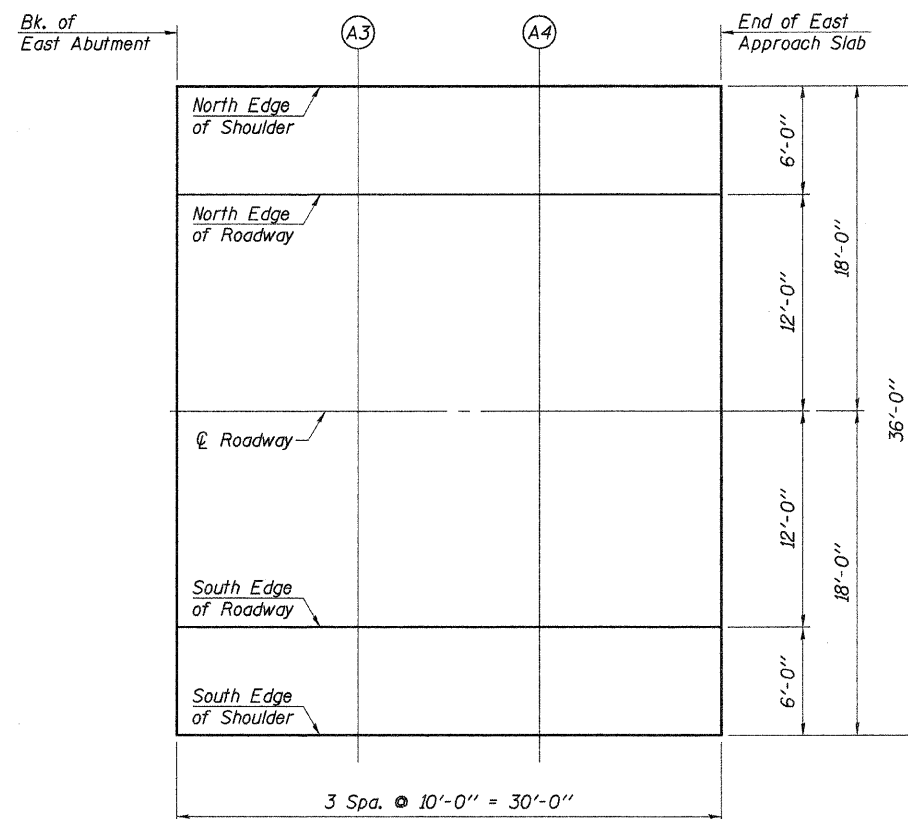

PLAN

DESIGNED -	A.L.S.
CHECKED -	A.R.K. & J.A.M.
DRAWN -	S.A.P.
CHECKED -	A.R.K.

E-AS

9-3-07

TOP OF EAST APPROACH SLAB ELEVATIONS
SECTION 07-00188-00-BR
COUNTY HIGHWAY 3
WHITESIDE COUNTY
STA. 48+02.50

4440 ASH GROVE
SPRINGFIELD, IL 62711
(217) 793-8600
www.fehr-graham.com

FEHR-GRAHAM & ASSOCIATES, LLC
ENGINEERING AND SCIENCE CONSULTANTS
PREPARED BY: RODRIGUEZ, RODRIGUEZ, RODRIGUEZ & ASSOCIATES, P.C.
SPRINGFIELD, IL

JOB NO.: 47515
FILE: APRCH_SLAB.DGN
DATE: 08/17/09