

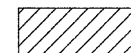



SCALE:  
PLAN: 1" = 20'

**ALIGNMENT CURVE DATA**

P.I. STA = 104+01.02  
 $\Delta = 02^\circ-23'-32''$   
 R = 9250.00'  
 T = 193.14'  
 L = 386.21'  
 E = 2.02'  
 e = N/A  
 TR = N/A  
 S.E. RUN = N/A  
 PC STA = 102+07.89  
 PRC STA = 105+94.10

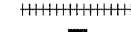
-  PAVEMENT PATCH
-  CLASS D PATCH WITH SUBGRADE REPLACEMENT
-  MEDIAN REMOVAL
-  PROPOSED SIDEWALK
-  CURB AND GUTTER REMOVAL
-  PROPOSED DETECTABLE WARNING
-  PROPOSED DETECTOR LOOP
-  EXISTING MANHOLE

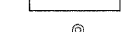
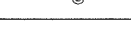
**ALIGNMENT CURVE DATA**

P.I. STA = 106+67.80  
 $\Delta = 02^\circ-24'-45''$   
 R = 3500.00'  
 T = 73.70'  
 L = 147.38'  
 E = 0.78'  
 e = N/A  
 TR = N/A  
 S.E. RUN = N/A  
 PRC STA = 105+94.10  
 IPT STA = 107+41.48

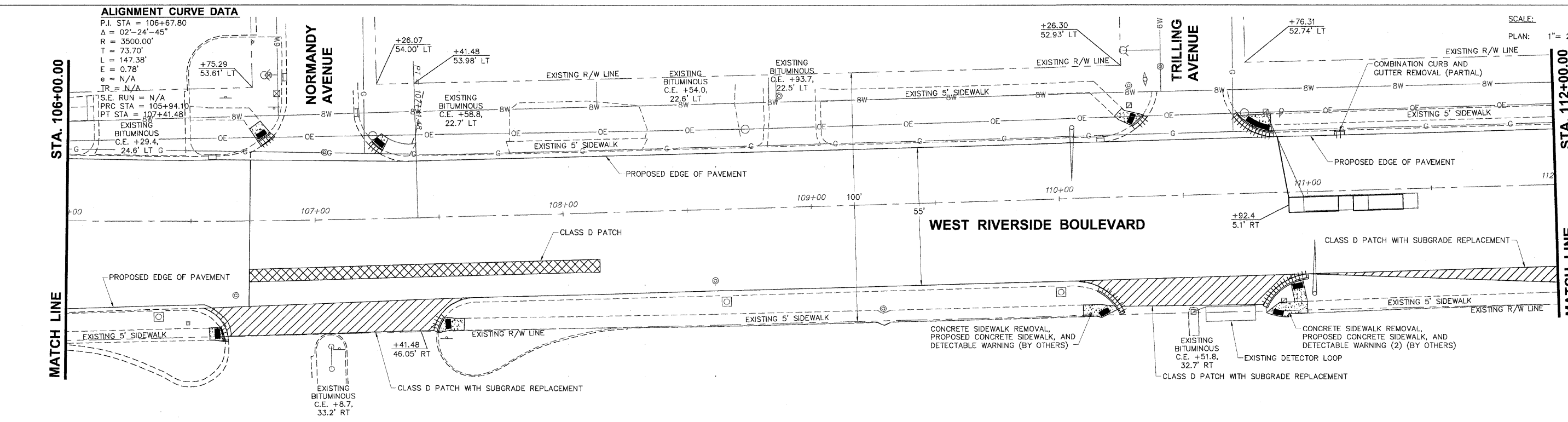

SCALE:  
PLAN: 1" = 20'

SHEET REVIEW	
AGENCY	DATE

REVISIONS		
NO.	ITEM	DATE

SCALE:	1" = 20'
DRAWN BY:	TWH
CHECKED BY:	PDS
DATE:	08/21/2009

**McClure**  
 Engineering Associates, Inc.  
 7282 Argus Drive  
 Rockford, Illinois 61107-5837  
 (815) 398-2332 FAX (815) 398-2496  
 Design Firm License: Illinois 184-000816

**ROADWAY PLAN - STA 100+00 TO 112+00**  
 RIVERSIDE ARRA (SECTION 09-00560-00-RS)  
 WEST RIVERSIDE BOULEVARD  
 ROCKFORD, ILLINOIS

FILE: H:\09-029 RIVERSIDE ARRA\DESIGN\DRAWINGS\09-029 P & P.DWG	JOB: 04-28-09-029
---	-------------------