

GERALD McCausland

JOHN ALFRED RAY AND GRACE RAY

FREEMAN UNITED COAL MINING COMPANY

PIPE CULVERTS, TYPE 1, CORRUGATED STEEL OR ALUMINUM CULVERT PIPE 18" INV. IN = 613.85 INV. OUT = 613.53 32' @ 1.00%

STA. 201+93.81 49.9' LT.

STA. 201+93.86 40.0' LT.

TEMPORARY EASEMENT

STA. 204+57.39 51.2' LT.

TEMPORARY EASEMENT

STA. 202+39.29 50.1' LT.

STA. 202+39.34 40.0' LT.

STA. 204+57.45 40.0' LT.

PIPE CULVERTS, TYPE 1, CORRUGATED STEEL OR ALUMINUM CULVERT PIPE 18" INV. IN = 611.30 INV. OUT = 611.00 30' @ 1.00%

STA. 204+88.61 51.4' LT.

STA. 204+88.55 40.0' LT.

PIPE CULVERTS, TYPE 1, CORRUGATED STEEL OR ALUMINUM EQUIVALENT ROUND-SIZE 18" INV. IN = 609.10 INV. OUT = 608.94 52' @ 0.30%

LIMITS OF CONSTRUCTION

MATCHLINE STA. 200+00.00

MATCHLINE STA. 215+00.00

PIPE CULVERT REMOVAL (14" CMP)

PIPE CULVERT REMOVAL (24" CMP)

STA. 206+00.00 60.0' RT.

LIMITS OF CONSTRUCTION

FREEMAN UNITED COAL MINING COMPANY

LEGEND		EROSION CONTROL	
	PROP PERMANENT EASEMENT (PE)		TEMPORARY DITCH CHECK
	PROP TEMPORARY EASEMENT (TE)		PIPE AND INLET PROTECTION
	PERIMETER EROSION BARRIER		STONE DUMPED RIP-RAP
	LIMITS OF CONSTRUCTION		DITCH SUMMIT
	PROPOSED DITCH LINE		DITCH FLOW ARROW
	AERIAL ELECTRIC/CABLE (AE)		

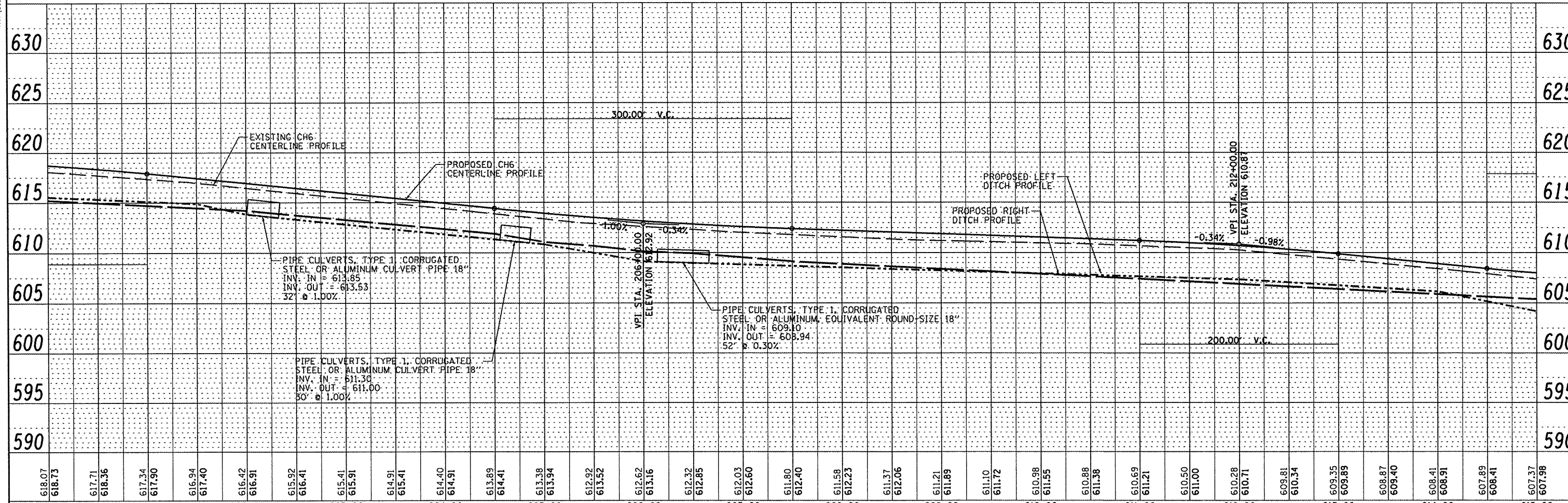
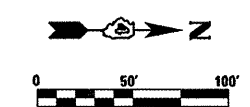

618.07	618.73	617.71	618.36	617.34	617.90	616.94	617.40	616.42	616.91	615.92	616.41	615.41	615.91	614.91	615.41	614.40	614.91	613.89	614.41	613.38	613.94	612.92	613.52	612.62	613.16	612.32	612.85	612.03	612.60	611.80	612.40	611.58	612.23	611.37	612.06	611.21	611.89	611.10	611.72	610.98	611.55	610.88	611.38	610.69	611.21	610.50	611.00	610.28	610.71	609.81	610.34	609.35	609.89	608.87	609.40	608.41	608.91	607.89	608.41	607.37	607.98
200+00	201+00	202+00	203+00	204+00	205+00	206+00	207+00	208+00	209+00	210+00	211+00	212+00	213+00	214+00	215+00																																														

PLAN	DATE
BY	
CHECKED	
NOTED	
NO.	

PROFILE	DATE
BY	
CHECKED	
NOTED	
NO.	

HAUBER & STUTZ, INC.
ENGINEERS
7615 NORTH HARKER DRIVE
PEORIA, ILLINOIS 61615
PH. (309) 693-7616
FAX (309) 693-7616

STATE OF ILLINOIS
DEPARTMENT OF TRANSPORTATION

FULTON COUNTY HIGHWAY 6
PLAN & PROFILE

F.A.S. RTE.	SECTION	COUNTY	TOTAL SHEETS	SHEET NO.
1458	03-00125-02-RS	FULTON	66	16
CONTRACT NO. 89415				

SCALE: 1" = 50' SHEET NO. 6 OF 8 SHEETS STA. 200+00 TO STA. 215+00

FED. ROAD DIST. NO. ILLINOIS FED. AID PROJECT