

TIE POINT
 STA. 102+00
 N=5025.4003
 E=4214.0368

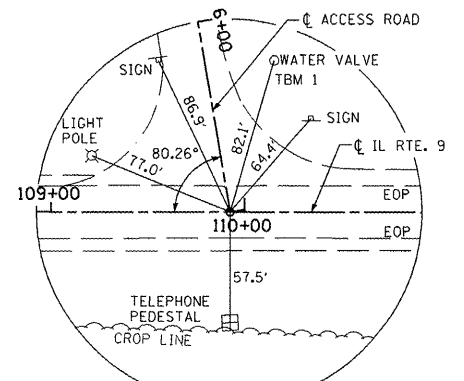

TIE POINT
 P.I. STA. 5+00.00 (ACCESS ROAD) =
 STA. 109+92.54 (IL RTE. 9)
 N=5024.0121
 E=5006.5743

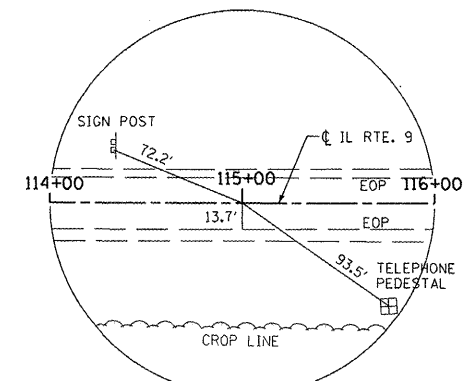

TIE POINT
 STA. 115+00
 N=5023.1232
 E=5514.0348

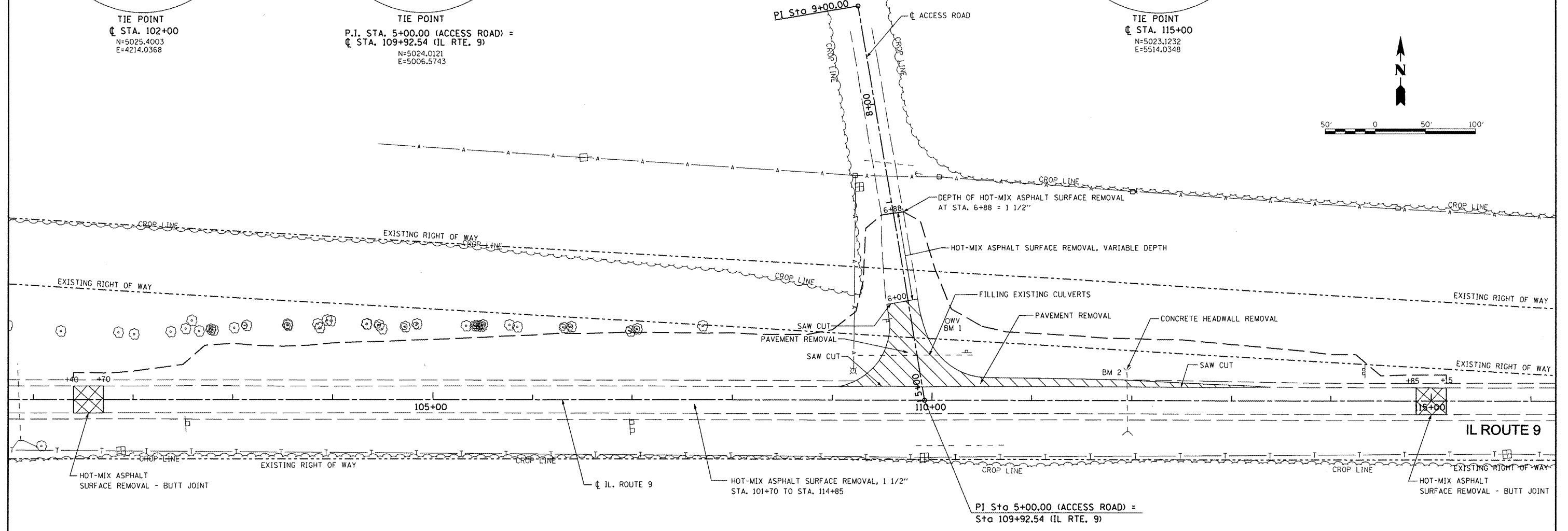
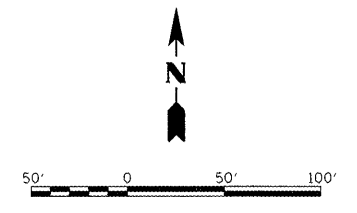

TEMPORARY BENCHMARKS
 BM 1 ELEV. 103.97 WATER VALVE STA. 5+73.6, RT. 35.9'
 BM 2 ELEV. 101.20 TOP HEADWALL STA. 111+95.0, 30.6' LT.

FILE NAME =	USER NAME =	DESIGNED -	REVISED -
X:\PROJECTS\60098851\DN\PLANS-XREFS\09-ACCESS RD RWVL.DGN		DRAWN -	REVISED -
	PLOT SCALE =	CHECKED -	REVISED -
	PLOT DATE = 08-18-09	DATE - 08-18-09	REVISED -

STATE OF ILLINOIS
 DEPARTMENT OF TRANSPORTATION

TAZEWELL COUNTY ACCESS ROAD\ILLINOIS ROUTE 9 REMOVAL PLAN			
SCALE: AS SHOWN	SHEET NO.	OF SHEETS	STA. TO STA.

F.A.P. RTE.	SECTION	COUNTY	TOTAL SHEETS	SHEET NO.
693	06-00000-00-FP	TAZEWELL	42	9
CONTRACT NO. 89531				
ILLINOIS FED. AID PROJECT				