

**TAZEWELL COUNTY  
ACCESS ROAD**

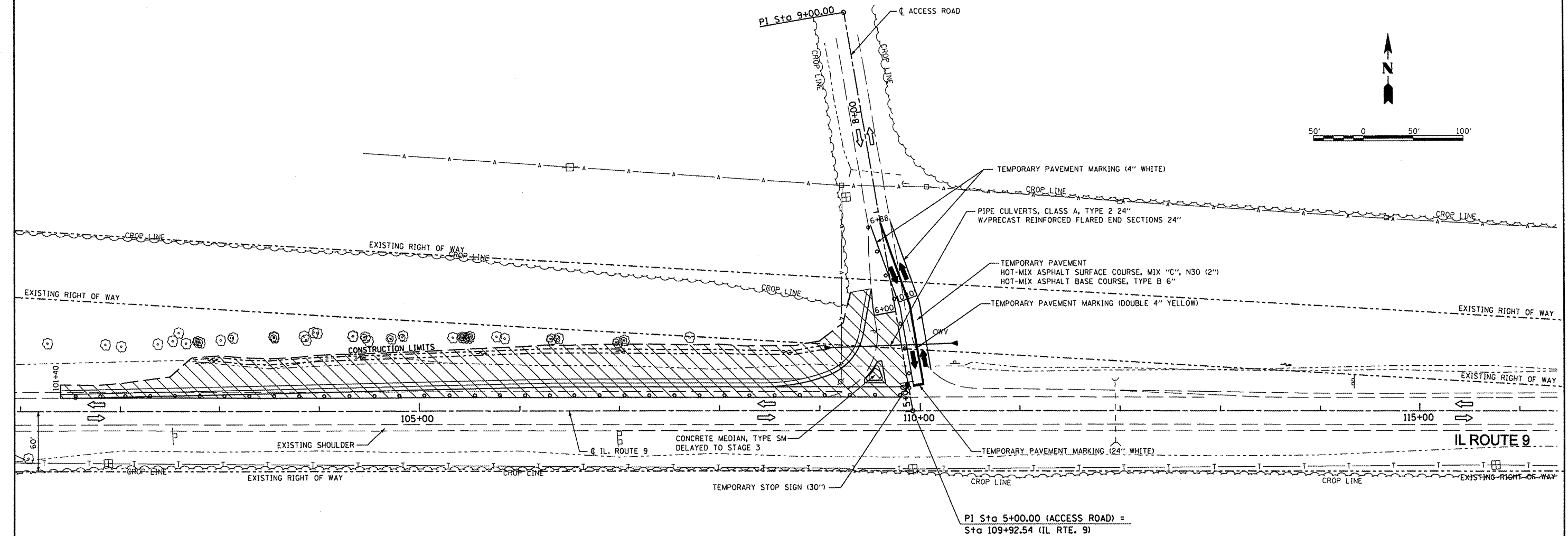

**MAINTENANCE OF TRAFFIC PLAN - STAGE 1**

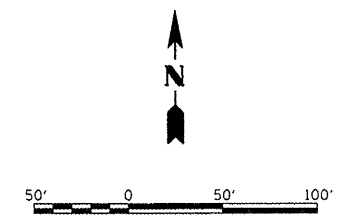
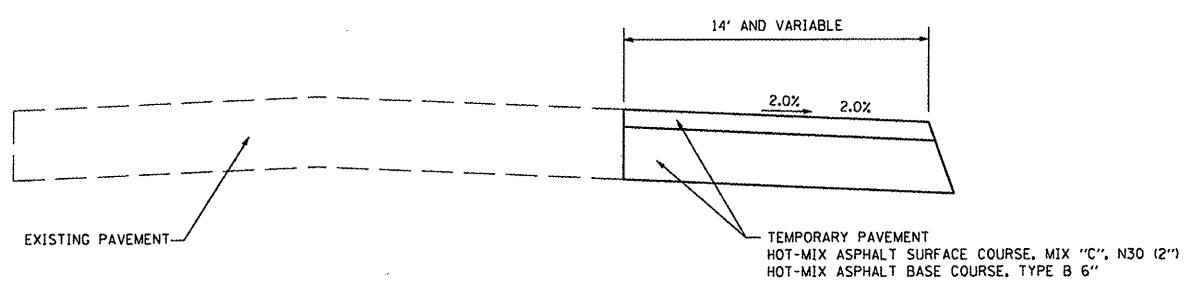
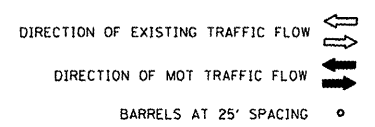

**TEMPORARY PAVEMENT SECTION**

NOT TO SCALE

**STAGE 1 CONSTRUCTION**

- CONSTRUCT CROSSROAD CULVERT STA. 5+65 (ACCESS ROAD)  
FILL EXISTING CROSSROAD CULVERT STA. 5+45 (ACCESS ROAD)
- CONSTRUCT TEMPORARY PAVEMENT RT. SIDE OF ACCESS ROAD
- CONSTRUCT TEMPORARY PAVEMENT MARKING FOR TWO 10' LANES ON ACCESS ROAD
- CONSTRUCT WIDENING LT. SIDE OF ACCESS ROAD AND LT. SIDE OF IL ROUTE 9 STA. 101+40 TO STA. 109+92.54

NOTE: MEDIAN CONSTRUCTION AND HMA SURFACE COURSE DELAYED TO STAGE 3

**STAGE 1 TRAFFIC**

- ACCESS ROAD TO USE EXISTING AND TEMPORARY PAVEMENT. TWO 10' LANES
- IL ROUTE 9 - EXISTING TWO LANE, 2-WAY TRAFFIC; FLAGMEN MAY BE USED AS REQUIRED FOR LANE CLOSURE
- HIGHWAY STANDARDS: 701001, 701006, 701201, 701306, 701326, 701901

FILE NAME =	USER NAME =	DESIGNED -	REVISED -
X:\PROJECTS\60098651\DWG\PLANS-XREFS\11-MOT STAGE 1.DWG		DRAWN -	REVISED -
	PLOT SCALE =	CHECKED -	REVISED -
	PLOT DATE = 08-18-09	DATE - 08-18-09	REVISED -

**STATE OF ILLINOIS  
DEPARTMENT OF TRANSPORTATION**

**TAZEWELL COUNTY ACCESS ROAD/ILLINOIS ROUTE 9  
MAINTENANCE OF TRAFFIC - STAGE 1**

F.A.P. RTE.	SECTION	COUNTY	TOTAL SHEETS	SHEET NO.
693	06-00000-00-FP	TAZEWELL	42	11
CONTRACT NO. 89531				
ILLINOIS FED. AID PROJECT				

SCALE: AS SHOWN SHEET NO. OF SHEETS STA. TO STA.