

**TAZEWELL COUNTY
ACCESS ROAD**

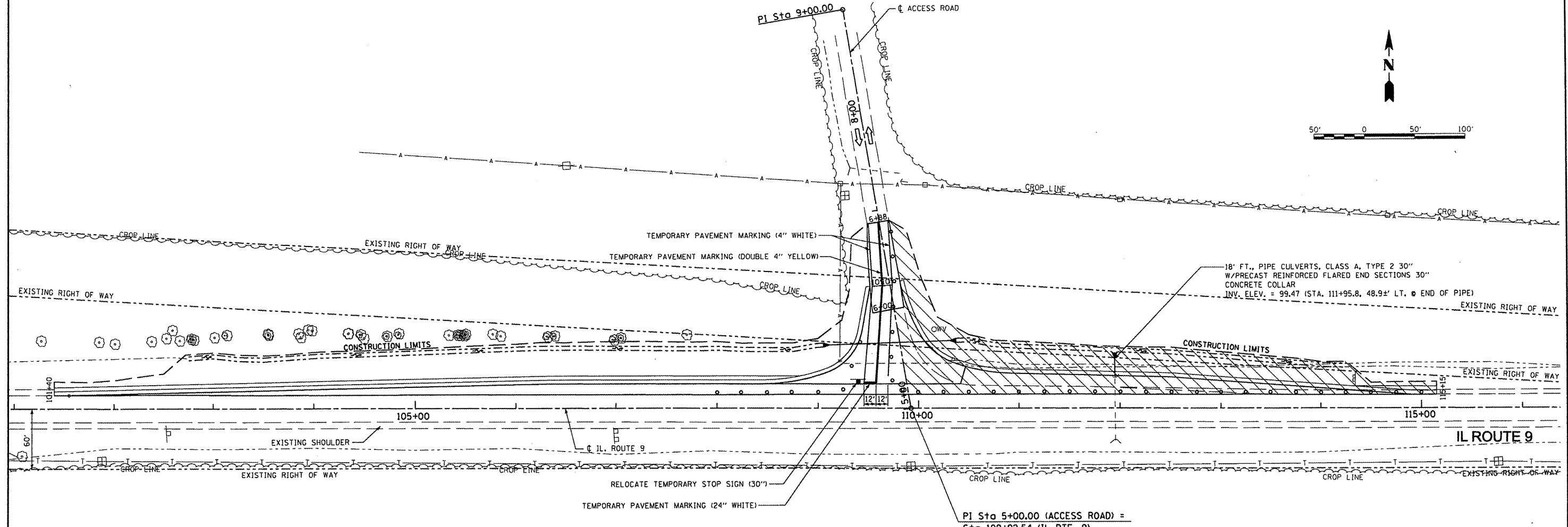

MAINTENANCE OF TRAFFIC PLAN - STAGE 2

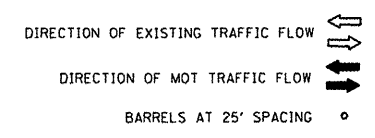

STAGE 2 CONSTRUCTION

- REMOVE TEMPORARY PAVEMENT MARKINGS FROM STAGE 1; CONSTRUCT TEMPORARY PAVEMENT MARKINGS, TEMPORARY RAMPS, RELOCATE TEMPORARY STOP SIGN TO NEW PAVEMENT AS REQUIRED TO SHIFT TRAFFIC ON THE ACCESS ROAD
 - REMOVE TEMPORARY PAVEMENT AND CONSTRUCT RT. SIDE OF ACCESS ROAD AND LT. SIDE OF IL. ROUTE 9 FROM STA. 109+92.54 TO STA. 115+15
- NOTE: HMA SURFACE COURSE DELAYED TO STAGE 3

STAGE 2 TRAFFIC

- ACCESS ROAD TO USE NEWLY CONSTRUCTED PAVEMENT LT. SIDE OF ACCESS ROAD
- IL ROUTE 9 - EXISTING TWO LANE, 2-WAY TRAFFIC; FLAGMEN MAY BE USED AS REQUIRED FOR LANE CLOSURE
- HIGHWAY STANDARDS: 701001, 701006, 701201, 701306, 701326, 701901

FILE NAME = X:\PROJECTS\60098651\DN\PLANS-XREFS\12-MOT STAGE 2.DGN	USER NAME =	DESIGNED -	REVISED -	STATE OF ILLINOIS DEPARTMENT OF TRANSPORTATION	TAZEWELL COUNTY ACCESS ROAD\ILLINOIS ROUTE 9 MAINTENANCE OF TRAFFIC - STAGE 2			F.A.P. RTE. 693	SECTION 06-00000-00-FP	COUNTY TAZEWELL	TOTAL SHEETS 42	SHEET NO. 12
	PLOT SCALE =	CHECKED -	REVISED -		SCALE: AS SHOWN	SHEET NO.	OF	SHEETS	STA.	TO STA.	CONTRACT NO. 89531 ILLINOIS FED. AID PROJECT	
	PLOT DATE = 08-18-09	DATE - 08-18-09	REVISED -									