

**TAZEWELL COUNTY
ACCESS ROAD**

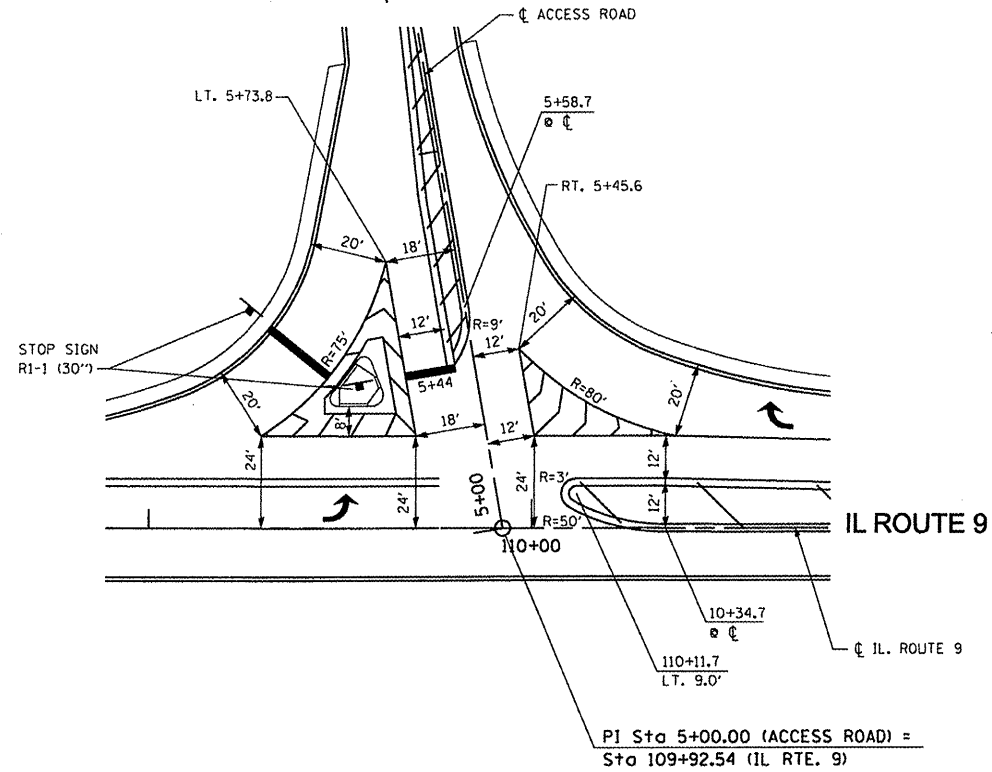

ENLARGEMENT DETAIL



**TAZEWELL COUNTY
ACCESS ROAD**

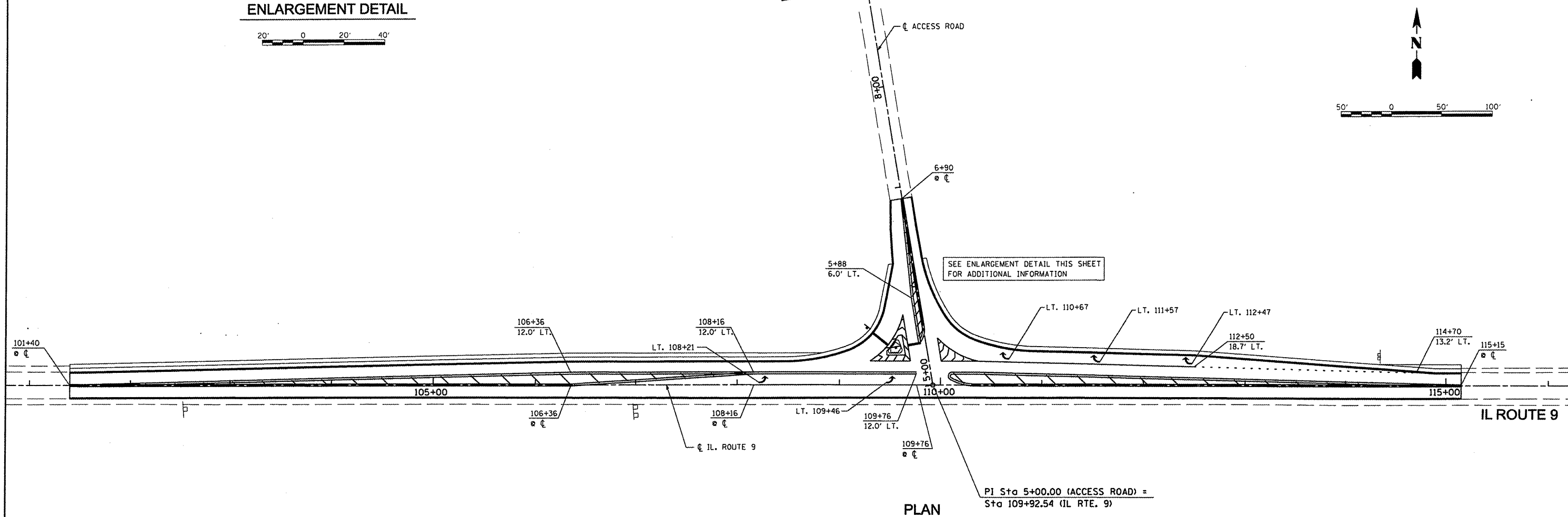

PLAN

PI Sta 5+00.00 (ACCESS ROAD) =
Sta 109+92.54 (IL RTE. 9)

FILE NAME =	USER NAME =	DESIGNED -	REVISED - 08-31-09
X:\PROJECTS\6008851\DWG\PLANS-XREFS\14-ACCESS RD PAVT MRKNG.DGN		DRAWN -	REVISED -
	PLOT SCALE =	CHECKED -	REVISED -
	PLOT DATE = 08-18-09	DATE - 08-18-09	REVISED -

**STATE OF ILLINOIS
DEPARTMENT OF TRANSPORTATION**

**TAZEWELL COUNTY ACCESS ROAD/ILLINOIS ROUTE 9
PAVEMENT MARKING PLAN**

SCALE: AS SHOWN SHEET NO. OF SHEETS STA. TO STA.

F.A.P. RTE.	SECTION	COUNTY	TOTAL SHEETS	SHEET NO.
693	06-00000-00-FP	TAZEWELL	42	14
CONTRACT NO. 89531			ILLINOIS FED. AID PROJECT	