

F.A.S. RTE.	SECTION	COUNTY	TOTAL SHEETS	SHEET NO.
367	01-00100-00-RS	WOODFORD	5	1

STATE OF ILLINOIS DEPARTMENT OF TRANSPORTATION DIVISION OF HIGHWAYS PLANS FOR PROPOSED LOCAL AGENCY IMPROVEMENT FEDERAL-AID SECONDARY PROJECT

INDEX OF SHEETS

SHEETS NO.	DESCRIPTION
1	COVER SHEET
2	SCHEDULE OF QUANTITIES
3	TYPICAL SECTIONS
4	DETAILS
5	PLAN SHEET

IDOT HIGHWAY STANDARDS

701301-03	LANE CLOSURE, 2L, 2W, SHORT TIME OPERATIONS
701306-02	LANE CLOSURE, 2L, 2W, SLOW MOVING OPERATIONS DAY ONLY, FOR SPEEDS: 45 MPH
701311-03	LANE CLOSURE, 2L, 2W, MOVING OPERATIONS-DAY ONLY
701901-01	TRAFFIC CONTROL DEVICES
780001-02	TYPICAL PAVEMENT MARKINGS
781001-03	TYPICAL APPLICATIONS, RAISED REFLECTIVE PAVEMENT MARKERS

A.R.R.A. PROGRAM
F.A.S. ROUTE 367
COUNTY HIGHWAY #23 (DOUGLAS ROAD)
PROJECT NO. ARA-0367 (105)
JOB NO. C-94-121-09
SECTION 01-00100-00-RS
WOODFORD COUNTY

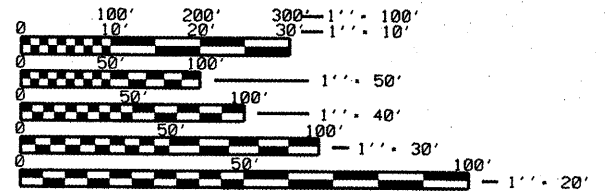
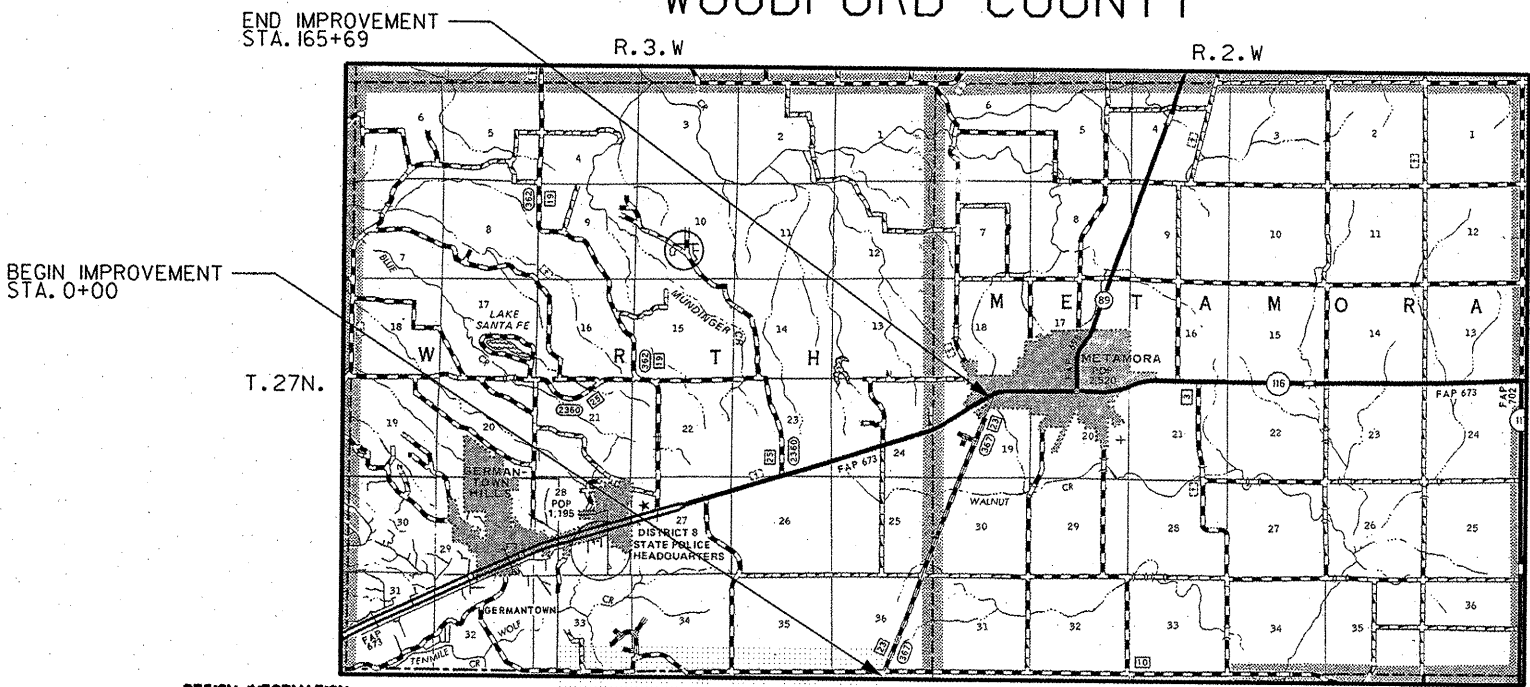
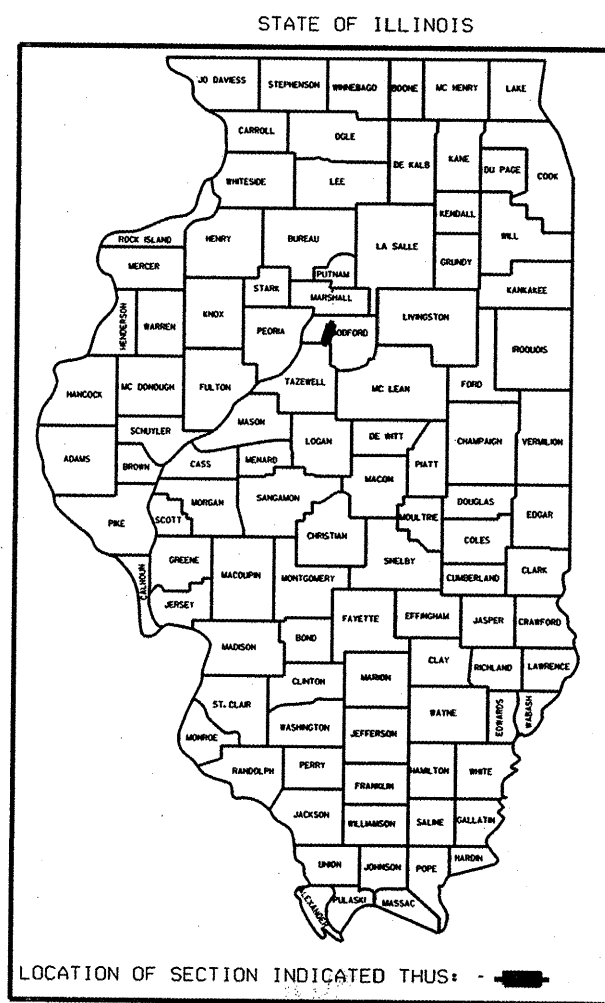

FULL SIZE PLANS HAVE BEEN PREPARED USING STANDARD ENGINEERING SCALES. REDUCED SIZED PLANS WILL NOT CONFORM TO STANDARD SCALES. IN MAKING MEASUREMENTS ON REDUCED PLANS, THE ABOVE SCALES MAY BE USED.

J.U.L.I.E.
JOINT UTILITY LOCATION INFORMATION FOR EXCAVATION
1-800-892-0123

CONTRACT NO. 89539

DESIGN INFORMATION:

LOCAL ROADS FUNCTIONAL CLASS:
MAJOR COLLECTOR
2005 ADT = 1820 (7% TRUCKS)
DESIGN SPEED: 40 MPH
DESIGN GUIDELINES: RURAL
VARIANCES GRANTED: NONE
COMMITMENTS: NONE

IMPROVEMENT CONSISTS OF THE CONSTRUCTION OF HOT-MIX ASPHALT SURFACE COURSE OVER AN EXISTING HMA ROADWAY, INCLUDING PROPOSED AGGREGATE SHOULDERS.

GROSS LENGTH OF SECTION = 16,569 FT. = 3.14 MILES
NET LENGTH OF SECTION = 16,569 FT. = 3.14 MILES

PLANS DEVELOPED IN ACCORDANCE WITH THE IDOT LOCAL ROADS MANUAL (OCT. 2008)

THESE PLANS HAVE BEEN PREPARED BY OR UNDER THE DIRECTION OF:

DATE: 8/07/09
SIGNED: Dennis Bachman
LICENSE EXPIRES: NOVEMBER 30, 2009

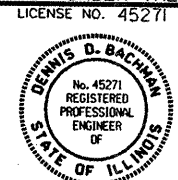

APPROVED: 8/07 20 09
Dennis Bachman
COUNTY ENGINEER

PASSED: 8-20 20 09
Dennis Bachman
DISTRICT FOUR ENGINEER OF LOCAL ROADS & STREETS

Releasing For Bid Based on Limited Review: August 20 20 09
Dennis Bachman
DEPUTY DIRECTOR OF HIGHWAYS, REGION THREE ENGINEER
STATE OF ILLINOIS
DEPARTMENT OF TRANSPORTATION

PRINTED BY THE AUTHORITY OF THE STATE OF ILLINOIS

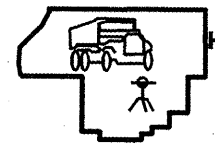

**WOODFORD COUNTY
HIGHWAY DEPARTMENT**
DENNIS BACHMAN, P.E., COUNTY ENGINEER
301 S. Main St.
Roanoke, IL 61561
TEL: 309-923-2891
FAX: 309-923-7928

F.A.S. RTE.	SECTION	COUNTY	TOTAL SHEETS	SHEET NO.
367	01-00100-00-RS	WOODFORD	5	2
STA.		TO STA.		
FED. ROAD DIST. NO. 4		ILLINOIS	FED. AID PROJECT	

SUMMARY OF QUANTITIES

ITEM #	DESCRIPTION	UNIT	QUANTITY
40600100	BITUMINOUS MATERIALS (PRIME COAT)	GAL	3,602
40600895	CONSTRUCT TEST STRIP	EACH	1
40600982	HOT-MIX ASPHALT SURFACE REMOVAL-BUTT JOINT	SO YD	378
40600990	TEMPORARY RAMP	SO YD	80
40603510	POLYMERIZED HOT-MIX ASPHALT SURFACE COURSE, MIX 'C', N50	TON	4,105
40800050	INCIDENTAL HOT-MIX ASPHALT SURFACING	TON	225
44000153	HOT-MIX ASPHALT SURFACE REMOVAL, 1"	SO YD	43,273
44000155	HOT-MIX ASPHALT SURFACE REMOVAL, 1 1/2"	SO YD	1,993
* 44000198	HOT-MIX ASPHALT SURFACE REMOVAL, VARIABLE DEPTH	SO YD	66
* 48101800	AGGREGATE SHOULDERS (SPECIAL)	SO YD	18,092
* 70103700	TRAFFIC CONTROL COMPLETE	L SUM	1
70300100	SHORT-TERM PAVEMENT MARKING	FOOT	1,657
70301000	WORK ZONE PAVEMENT MARKING REMOVAL	SO FT	552
78001100	PAINT PAVEMENT MARKING-LINE 4"	FOOT	46,112
78100100	RAISED REFLECTIVE PAVEMENT MARKER	EACH	208
78300200	RAISED REFLECTIVE PAVEMENT MARKER REMOVAL	EACH	165

* SEE SPECIAL PROVISIONS

△ SPECIALTY ITEMS

ENTRANCE #	TYPE	STATION	WIDTH (FT)	SURFACE	40800050 INCIDENTAL HMA SURFACING (TONS)	40603510 POLYMERIZED HMA SURFACE COURSE MIX 'C', N50 (TONS)
1	FIELD ENTRANCE	N/A 1100N	30	ASPH	2	N/A
2	PRIVATE ENTRANCE	2+50 R	30	ASPH	2.7	N/A
3	FIELD ENTRANCE	15+26 L	30	ASPH	1.5	N/A
4	FIELD ENTRANCE	15+50 R	30	ASPH	1.5	N/A
5	FIELD ENTRANCE	29+56 R	30	AGG	1.5	N/A
6	FIELD ENTRANCE	29+73 L	30	ASPH	1.5	N/A
7	FIELD ENTRANCE	34+95 R	30	ASPH	1.5	N/A
8	FIELD ENTRANCE	45+71 L	30	ASPH	1.5	N/A
9	PRIVATE ENTRANCE	45+71R	30	ASPH	2.7	N/A
10	FIELD ENTRANCE	61+88 R	30	ASPH	1.5	N/A
11	PRIVATE ENTRANCE	68+74 R	30	ASPH	3.1	N/A
12	FIELD ENTRANCE	68+78 L	30	ASPH	1.5	N/A
13	FIELD ENTRANCE	72+58 R	30	ASPH	1.5	N/A
14	FIELD ENTRANCE	79+16 L	30	ASPH	1.5	N/A
15	FIELD ENTRANCE	86+15 L	35	ASPH	1.6	N/A
16	FIELD ENTRANCE	86+30 R	35	ASPH	1.6	N/A
17	PRIVATE ENTRANCE	106+37 R	60	ASPH	2.7	N/A
18	FIELD ENTRANCE	106+43 L	40	ASPH	1.9	N/A
19	FIELD ENTRANCE	108+94 L	40	ASPH	1.6	N/A
20	FIELD ENTRANCE	114+46 L	30	ASPH	1.5	N/A
21	FIELD ENTRANCE	114+74 R	30	ASPH	1.5	N/A
22	PRIVATE ENTRANCE	117+00 L	30	ASPH	3.1	N/A
23	FIELD ENTRANCE	131+62 L	30	ASPH	1.5	N/A
24	PRIVATE ENTRANCE	132+85 L	24	ASPH	2.1	N/A
25	PRIVATE ENTRANCE	134+50 L	30	ASPH	3	N/A
26	PRIVATE ENTRANCE	136+33 L	30	ASPH	3	N/A
27	FIELD ENTRANCE	142+93 L	30	ASPH	1.5	N/A
28	FIELD ENTRANCE	143+00 R	30	ASPH	1.5	N/A
29	PRIVATE ENTRANCE	146+00 R	45	AGG	5.34	N/A
30	PRIVATE ENTRANCE	149+41R	80	ASPH	9.9	N/A
31	FIELD ENTRANCE	149+49 L	30	ASPH	1.5	N/A
32	PRIVATE ENTRANCE	154+85 L	45	ASPH	4.31	N/A
33	PRIVATE ENTRANCE	157+53 L	35	CONC	4	N/A
34	PRIVATE ENTRANCE	158+73 L	30	ASPH	2.6	N/A
35	PRIVATE ENTRANCE	160+26 L	55	ASPH	6.2	N/A
36	PRIVATE ENTRANCE	161+65 L	30	CONC	2.9	N/A
37	PRIVATE ENTRANCE	162+19 L	35	ASPH	3.2	N/A
	MAIN LINE	0+00 - 165+69	24	N/A	N/A	4,103.8
	MAILBOX TURNOUTS 12 @ 2 TONS EACH =				24	N/A
	SIDE ROADS (SEE TABLE)				103	N/A
	TOTAL				220.5	4,103.8
	USE				225	4,105

STATION TO STATION	78300200	70300100	70301000	78100100
	RAISED REFLECTIVE PAVEMENT MARKER REMOVAL (EACH)	SHORT-TERM PAVEMENT MARKINGS (FOOT)	WORK ZONE PAVEMENT MARKING REMOVAL (SO FT)	RAISED REFLECTIVE PAVEMENT MARKER (EACH)
0+00 - 165+69	165	1,657	552	208

SIDE ROAD	STATION	LENGTH (FT)	40800050
			INCIDENTAL HOT-MIX ASPHALT SURFACING (TON)
1100 N. LEFT	00+68	60	30
1100 N. RIGHT	00+84	60	28
1200 N. LEFT	57+84	30	13
1200 N. RIGHT	57+87	30	10
PRAIRIE HILLS SUB. LEFT	138+70	30	10
W. LOCUST ST. RIGHT	161+43	22	12
		TOTAL	103 TONS

STATION TO STATION	GALLONS
0+00 - 165+69	3,414
FIELD/PRIVATE ENTRANCES	81
MAILBOX TURNOUTS	19
SIDEROADS	88
TOTAL	3,602

STATION - STATION	(SY)
0+20 - 163+03	18,092

STATION	BITUMINOUS SURFACE REMOVAL (SO YD)	40600990 TEMPORARY RAMP (SO YD)
	44000153 HOT-MIX ASPHALT SURFACE REMOVAL-1"	00+20 - 162+82
44000155 HOT-MIX ASPHALT SURFACE REMOVAL - 1 1/2"	163+03 - 165+69	1,993
44000198 HOT-MIX ASPHALT SURFACE REMOVAL-VARIABLE DEPTH	162+82 - 163+03	66
40600982 HOT-MIX ASPHALT SURFACE REMOVAL-BUTT JOINT	00+00 - 00+20	89
	1100N	52
	1200N	52
	PRARIE HILLS	22
	W. LOCUST	47
	3 P.E.	116
	BUTT JOINT TOTAL =	378 SY
	TOTAL =	80 SY

TOTAL	78001100 PAINT PAVEMENT MARKING LINE-4" (FOOT)
YELLOW	13,376
WHITE	32,736

DATE: 8/06/09
SCALE: 1"=40'
DRAWN BY: BJB
CHECKED BY: DDB

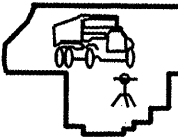

WOODFORD COUNTY
HIGHWAY DEPARTMENT
DENNIS BACHMAN, P.E., COUNTY ENGINEER
301 S. Main St.
Roanoke, IL 61561
TEL: 309-923-2891
FAX: 309-923-7928

F.A.S. RTE. 367
SECTION 01-00100-00-RS
DOUGLAS ROAD
SCHEDULE OF QUANTITIES
SCALE: DATE: 8/06/09
DRAWN BY: BJB
CHECKED BY: DDB

CONTRACT NO. 89539

F.A.S. RTE.	SECTION	COUNTY	TOTAL SHEETS	SHEET NO.
367	01-00100-00-RS	WOODFORD	5	3
STA.		TO STA.		
FED. ROAD DIST. NO. 4		ILLINOIS	FED. AID PROJECT	

EXISTING TYPICAL CROSS SECTION

STA. 0+00 - 114+69

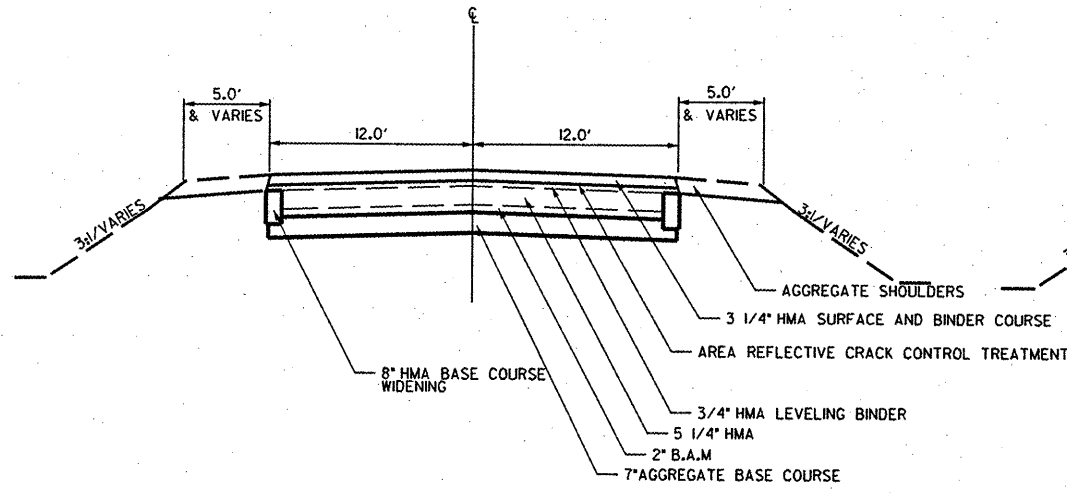

EXISTING TYPICAL CROSS SECTION

STA. 114+69 - 163+03

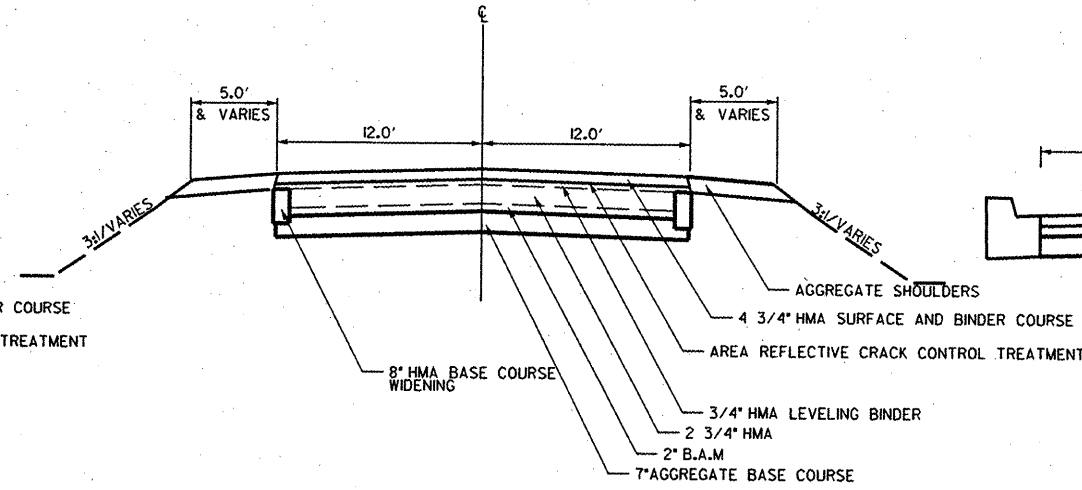

EXISTING TYPICAL CROSS SECTION

163+03 - 165+69

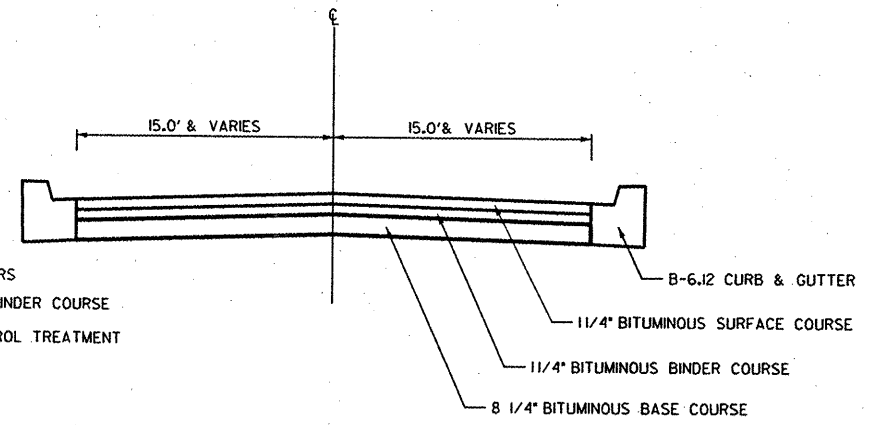

PROPOSED TYPICAL CROSS SECTION

STA. 0+20 - 162+83

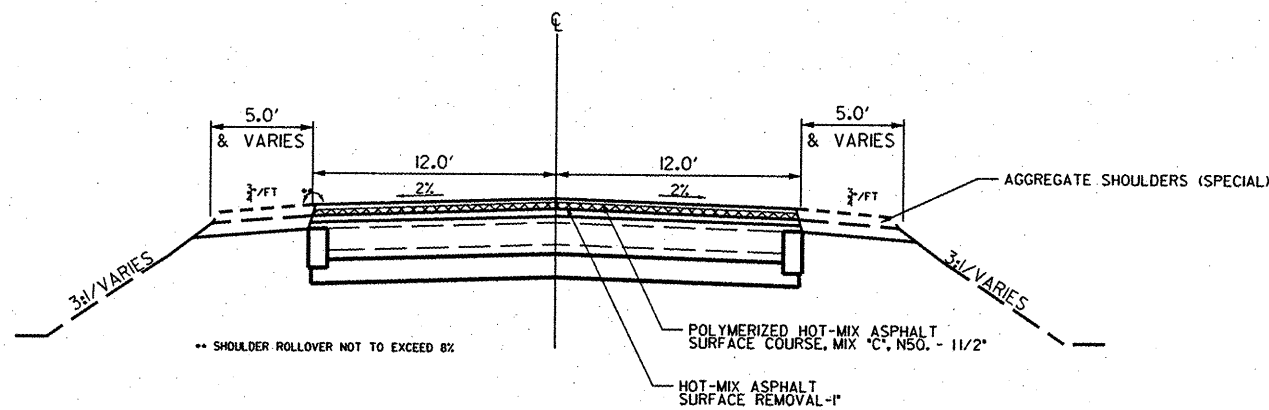

PROPOSED TYPICAL CROSS SECTION

STA. 163+03 - 165+69

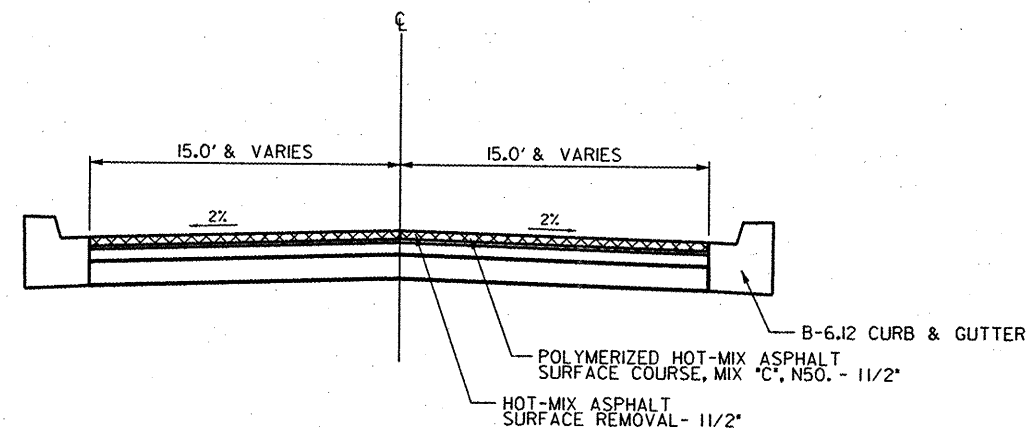

MIX DESIGN	SURFACE
PG:	SBS 70-22
RAP (%)max	10%
DESIGN AIR VOIDS	4% @ N=50
GRADATION MIXTURE	IL-9.5 OR IL-12.5
FRICTION AGGREGATE	*C*
N DESIGN	N50

DATE: 8/6/2009
 DRAWN BY: BJH
 CHECKED BY: DDB

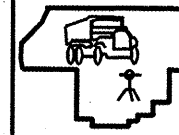

WOODFORD COUNTY
 HIGHWAY DEPARTMENT
 DENNIS BACHMAN, P.E., COUNTY ENGINEER
 301 S. Main St., P.O. Box 467
 Roonoke, IL 61561
 TEL: 309-923-2891
 FAX: 309-923-7928

F. A. S. RTE. 367
 SECTION 01-00100-00-RS
 C. H. #23

TYPICAL SECTION

SCALE: 1"=5'
 DATE: 8/6/2009
 DRAWN BY: BJH
 CHECKED BY: DDB

F.A.S. RTE.	SECTION	COUNTY	TOTAL SHEETS	SHEET NO.
367	01-00100-00-RS	WOODFORD	5	4
STA. TO STA.				
FED. ROAD DIST. NO. 4		ILLINOIS	FED. AID PROJECT	

MIX DESIGN	SURFACE
PG:	SBS 70-22
RAP (2)max	10%
DESIGN AIR Voids	4% @ N=50
GRADATION MIXTURE	IL-9.5 OR IL 12.5
FRICITION AGGREGATE	"C"
N DESIGN	N50

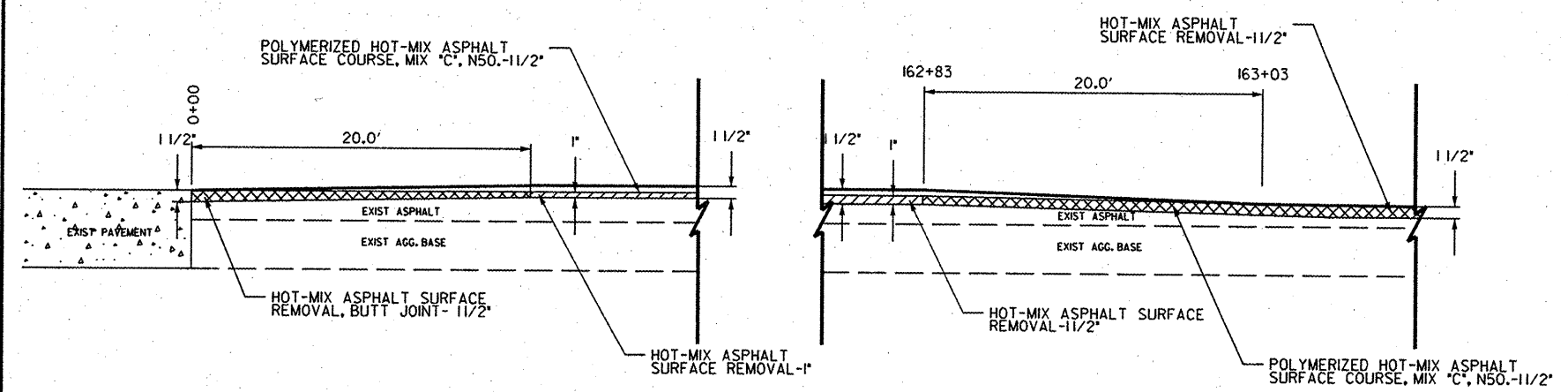

BUTT JOINT DETAIL A
STA. 0+00-0+20

SURFACE REMOVAL VARIABLE DEPTH DETAIL B
STA. 162+83 - 163+03

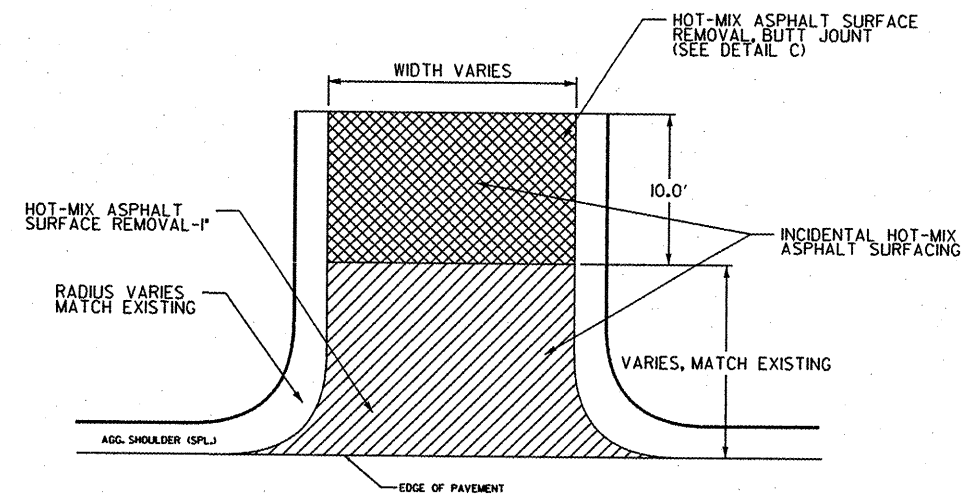

INTERSECTION DETAIL
1100 N, 1200N, PRAIRIE HILLS, LOCUST ST.

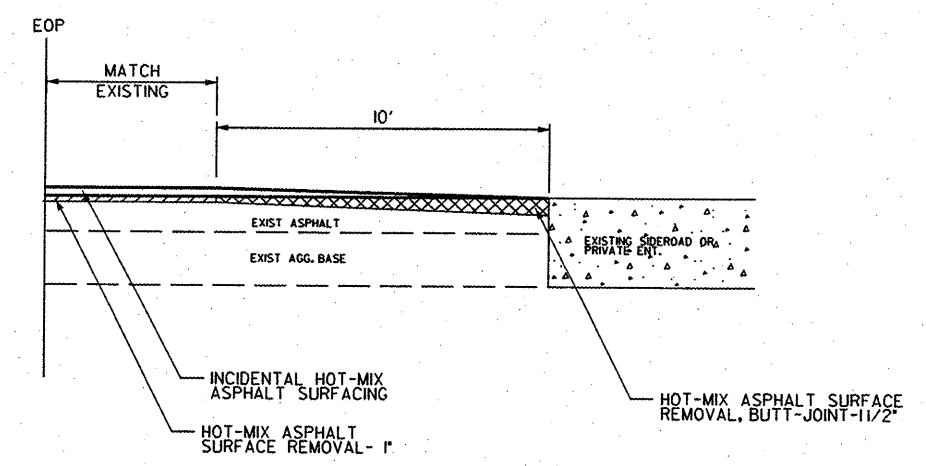

BUTT JOINT DETAIL C
PRIVATE ENTRANCES
3 TO BE CONSTRUCTED
ENT. #22,33,36
SIDEROADS
1100N, 1200N, PRAIRIE HILLS, LOCUST ST.

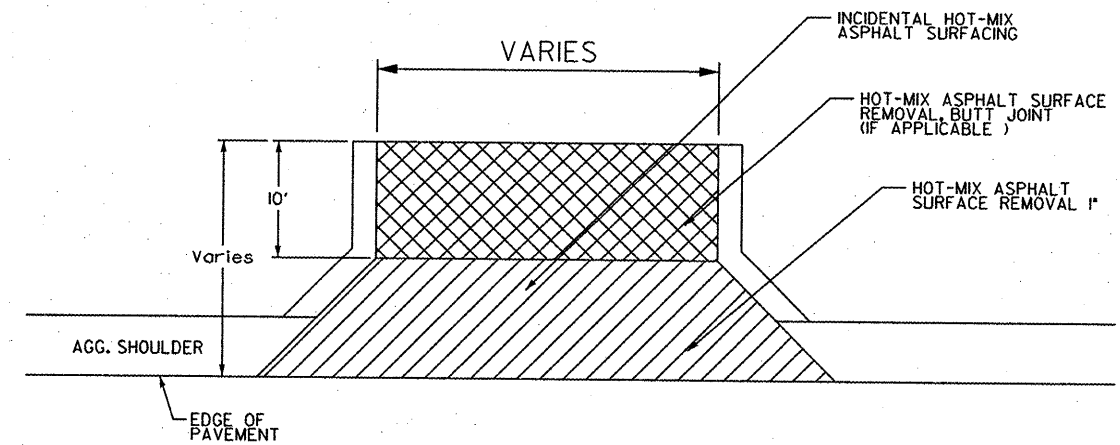

ENTRANCE DETAIL

PLOT DATE: 8/6/2009
 PLOT SCALE: 1\"/>



WOODFORD COUNTY
HIGHWAY DEPARTMENT
 DENNIS BACHMAN, P.E., COUNTY ENGINEER
 301 S. Main St., P.O. Box 467
 Roanoke, IL 61561
 TEL: 309-923-2891
 FAX: 309-923-7928

F. A. S. RTE. 367
 SECTION 01-00100-00-RS
 C. H. #23
DETAIL SHEET
 SCALE: 1"=5'
 DATE: 8/6/2009
 DRAWN BY: BJH
 CHECKED BY: DDB

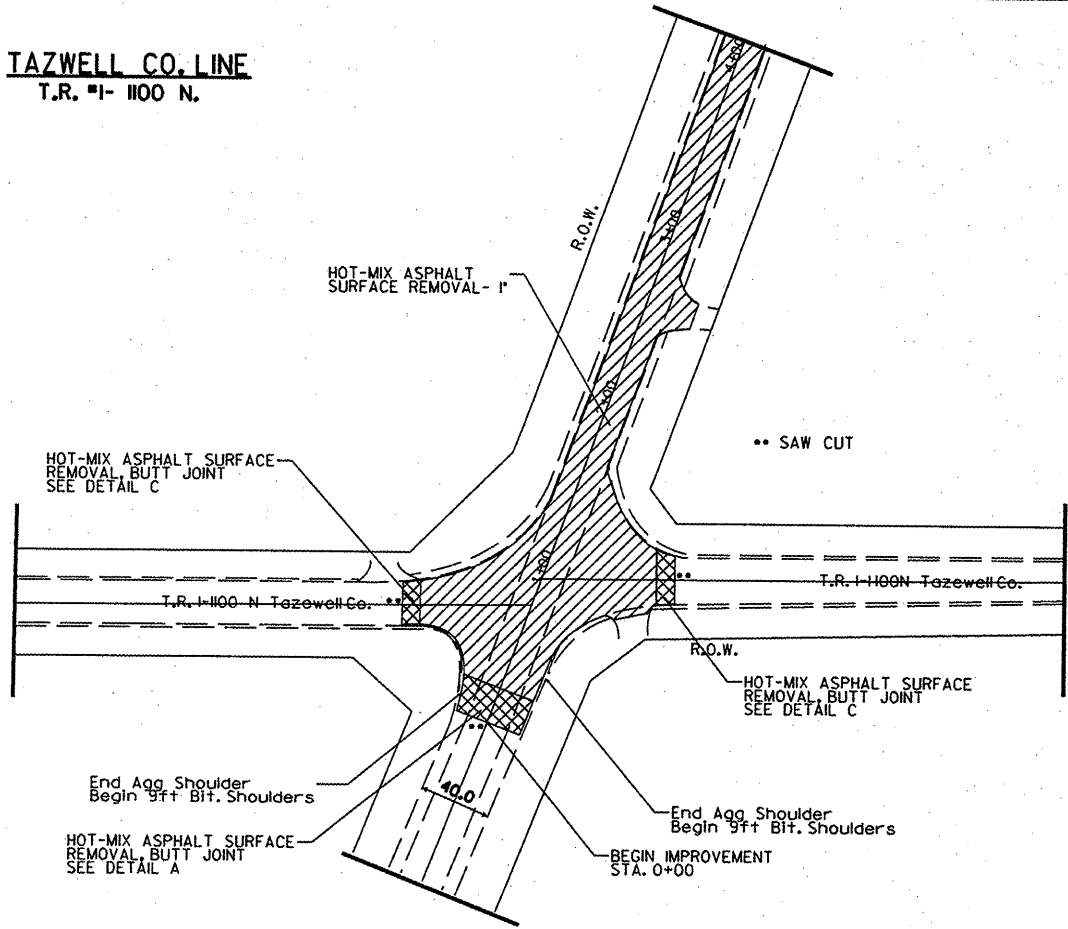
TAZWELL CO. LINE
T.R. #1- 1100 N.

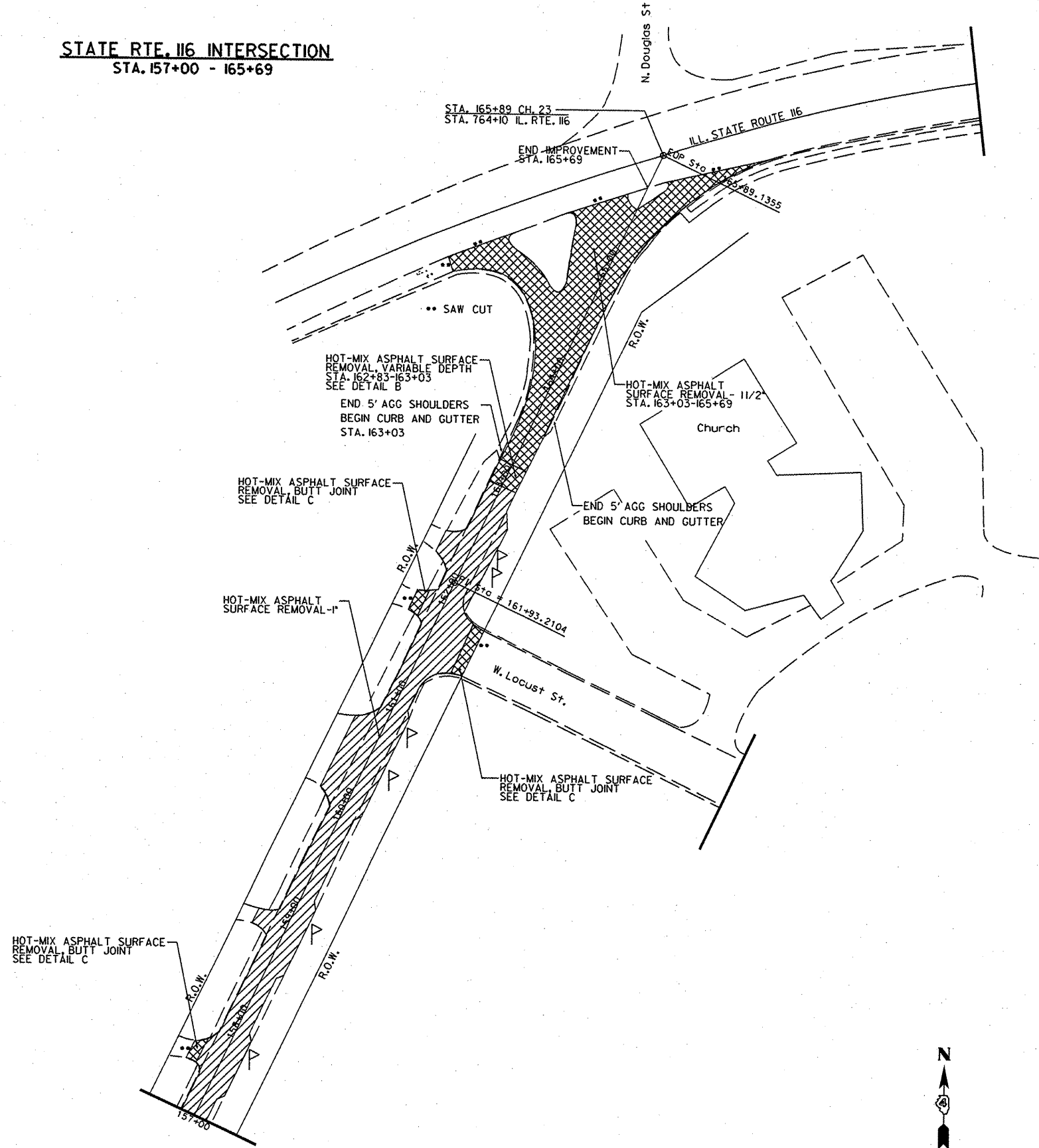

STATE RTE. 116 INTERSECTION
STA. 157+00 - 165+69



T.R. #145 - 1200 N.

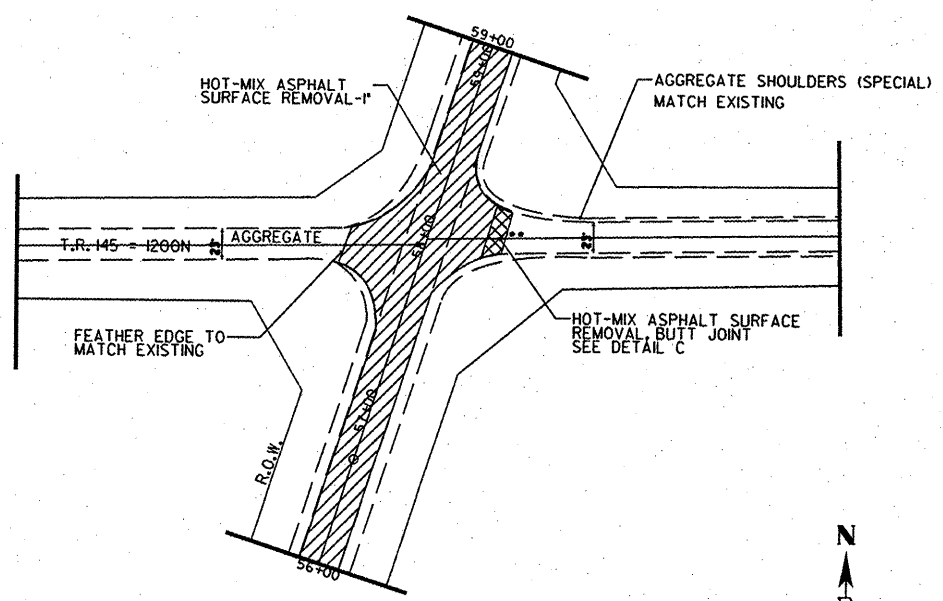

FILE NAME =	USER NAME =	DESIGNED - DDB	REVISED -
*FILE#		DRAWN - BJH	REVISED -
PLOT SCALE =		CHECKED - DDB	REVISED -
PLOT DATE =		DATE - 8/6/2009	REVISED -

WOODFORD COUNTY HIGHWAY DEPARTMENT
301 S. Main St.
Roonoke, IL 61561
TEL: 309-923-2891
FAX: 309-923-7928

PLAN SHEET
C.H. #23 DOUGLAS ROAD RD.
SCALE: _____ SHEET NO. 5 OF 5 SHEETS STA. _____ TO STA. _____

F.A.S. RTE. 367	SECTION 01-00100-00-RS	COUNTY WOODFORD	TOTAL SHEETS 5	SHEET NO. 5
CONTRACT NO. 89539			ILLINOIS FED. AID PROJECT	