

ROUTE NO.	SECTION	COUNTY	TOTAL SHEETS	SHEET NO.
MONTICELLO RD. CH 18 (FAS 531)	07-00419-00-R5	CHAMPAIGN	162	11
STA.		TO STA.		
F.H.W.A. REG.		ILLINOIS PROJECT ARA-HSIP-53K10B1		

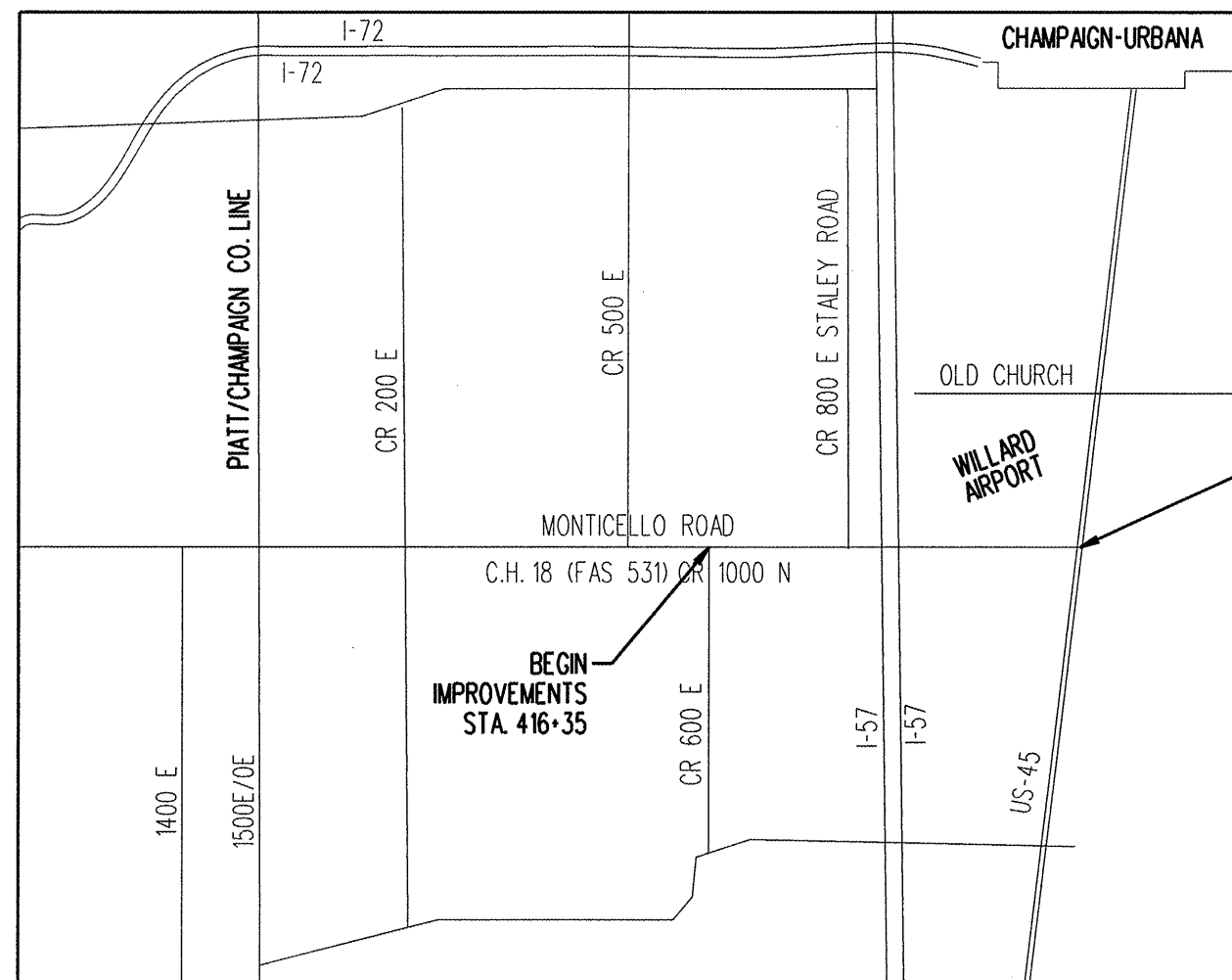

BENCHMARK DATA (NAVD 1988)

BENCHMARK *27	SET COTTON SPINDLE IN NORTH FACE OF UTILITY POLE WITH LIGHT. SOUTHWEST CORNER OF 1000N & 600E ELEVATION= 692.45 (STA. 416+53 44' RT)	BENCHMARK *38	SET COTTON SPINDLE ON NORTH FACE OF UTILITY POLE ON SOUTHWEST CORNER OF 1000N & 900E ELEVATION= 727.09 (STA. 571+48 26' RT)
BENCHMARK *28	SET CHISELED "□" ON SOUTHEAST WINGWALL OF BRIDGE APPROX. 0.2 MI. EAST OF 600E ELEVATION= 689.19 (STA. 426+71 29.5' RT)	BENCHMARK *39	SET COTTON SPINDLE IN NORTH FACE OF UTILITY POLE. APPROX. 1/4 MI. EAST OF 900E ON SOUTH SIDE OF ROAD ELEVATION= 737.90 (STA. 585+54 29.5' RT)
BENCHMARK *29	SET COTTON SPINDLE IN NORTH FACE OF UTILITY POLE ON EAST SIDE OF DRIVE FOR ADDRESS 645 1000N ELEVATION= 696.80 (STA. 440+05 58' RT)	BENCHMARK *40	SET COTTON SPINDLE IN NORTH FACE OF UTILITY POLE. 1st POLE EAST OF ADDRESS 959 1000N ON SOUTH SIDE OF ROAD ELEVATION= 744.85 (STA. 604+96 31' RT)
BENCHMARK *30	SET COTTON SPINDLE IN NORTH FACE OF UTILITY POLE APPROX. 1/4 MI. WEST OF 700E ON SOUTH SIDE OF ROAD ELEVATION= 706.27 (STA. 456+78 29' RT)	BENCHMARK *41	SET COTTON SPINDLE IN NORTH FACE OF UTILITY POLE. APPROX. 1/4 MI. WEST OF 1000E ON SOUTH SIDE OF ROAD ELEVATION= 745.71 (STA. 614+67 31' RT)
BENCHMARK *31	SET COTTON SPINDLE ON NORTH FACE OF UTILITY POLE ON SOUTHWEST CORNER OF 1000N & 700E ELEVATION= 691.11 (STA. 465+74 26' RT)	BENCHMARK *42	SET COTTON SPINDLE IN NORTH FACE OF UTILITY POLE. SOUTHWEST CORNER OF 1000N & 1000E ELEVATION= 741.70 (STA. 624+41 30' RT)
BENCHMARK *32	SET COTTON SPINDLE IN NORTH FACE OF UTILITY POLE APPROX. 1/4 MI. EAST OF 700E. 2nd POLE SOUTH SIDE OF ROAD ELEVATION= 696.02 (STA. 479+15 49' RT)	BENCHMARK *43	SET COTTON SPINDLE IN NORTH FACE OF UTILITY POLE. 5th POLE EAST OF 1000E ON SOUTH SIDE OF ROAD ELEVATION= 741.07 (STA. 636+31 28' RT)
BENCHMARK *33	SET COTTON SPINDLE IN NORTH FACE OF UTILITY POLE. 2nd POLE EAST OF ADDRESS 733 1000N ELEVATION= 700.85 (STA. 493+20 28' RT)	BENCHMARK *44	SET COTTON SPINDLE IN NORTH FACE OF UTILITY POLE. 0.5MI EAST OF 1000E ON SOUTH SIDE OF ROAD ELEVATION= 746.69 (STA. 650+40 29' RT)
BENCHMARK *34	SET COTTON SPINDLE IN NORTH FACE OF UTILITY POLE. APPROX. 1/4 MI. EAST OF 700E ON SOUTH SIDE OF ROAD ELEVATION= 691.20 (STA. 505+81 29' RT)	BENCHMARK *45	SET COTTON SPINDLE IN NORTH FACE OF UTILITY POLE. APPROX. 1/4 MI. WEST OF ROUTE 45 ON SOUTH SIDE OF ROAD ELEVATION= 747.86 (STA. 666+11 28' RT)
BENCHMARK *35	SET COTTON SPINDLE ON NORTH FACE OF UTILITY POLE ON SOUTHWEST CORNER OF 1000N & 800E ELEVATION= 691.13 (STA. 518+22 28' RT)	BENCHMARK *46	SET CHISELED "□" ON NORTH SIDE OF CONC. BASE FOR MAST ARM AT SOUTHWEST CORNER OF MONTICELLO ROAD AND ROUTE 45 ELEVATION= 743.00 (678+66 81' RT)
BENCHMARK *35B	SET COTTON SPINDLE IN NORTH FACE OF UTILITY POLE. APPROX. 1/4 MI. EAST OF 800E. 6TH POLE EAST ELEVATION= 691.06 (STA. 530+49 29' RT)		
BENCHMARK *36	FOUND BRASS TABLET IN CONCRETE STAMPED "VILLAGE OF SAVOY CONTROL STA *34" ELEVATION= 714.33 (STA. 547+36 19.5' RT)		
BENCHMARK *37	SET CHISELED "X" ON NORTHEAST ANCHOR BOLT FOR MARATHON GAS SIGN ELEVATION= 711.08 (STA. 558+39 59' LT)		



END IMPROVEMENTS STA. 674+44

BEGIN IMPROVEMENTS STA. 416+35