

ROUTE NO.	SECTION	COUNTY	TOTAL SHEETS	SHEET NO.
MONTECELLO RD, CH 18 (FAS 53)	07-00419-00-RS	CHAMPAIGN	162	24
STA.	TO STA.			
F.H.W.A. REG.	ILLINOIS PROJECT	ARA-HSP-53(K108)		

PARCEL 74
 PIN: 29-26-09-400-006
 OWNER/S:
 FIRST NATIONAL BANK OF OTTAWA, TTEE, TR #2467
 PT. SE 1/4, SEC. 9, T18N, R8E, 3RD PM

PARCEL 76
 PIN: 29-26-09-400-003
 OWNER/S: GEORGE REIFSTECK FARMS, INC.
 SE 1/4, SEC. 9, T18N, R8E, 3RD PM

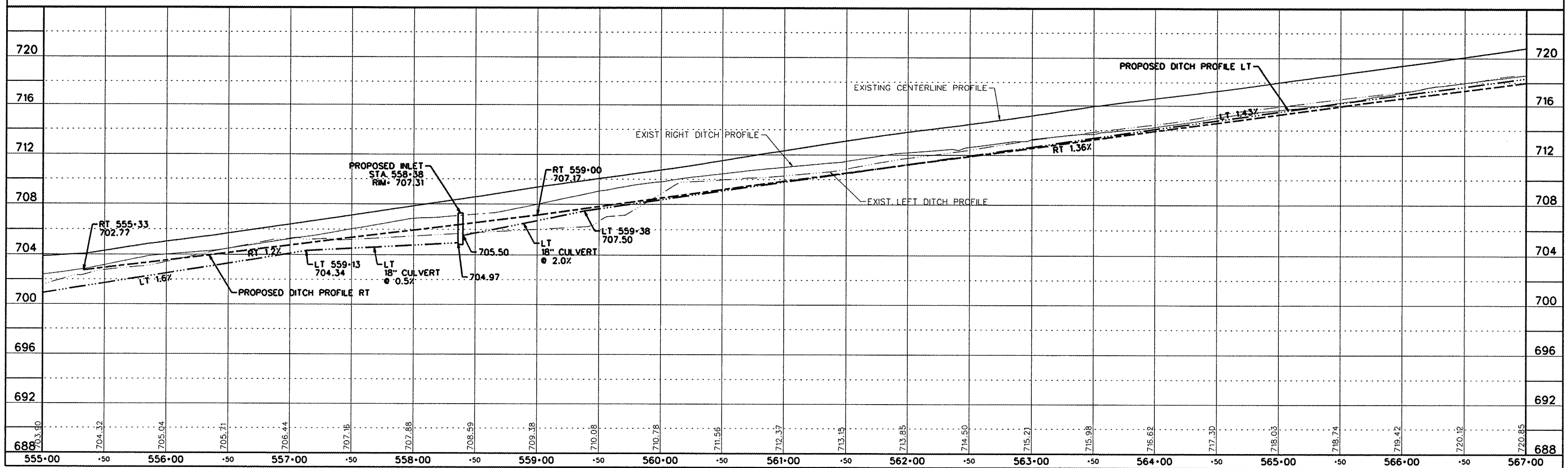
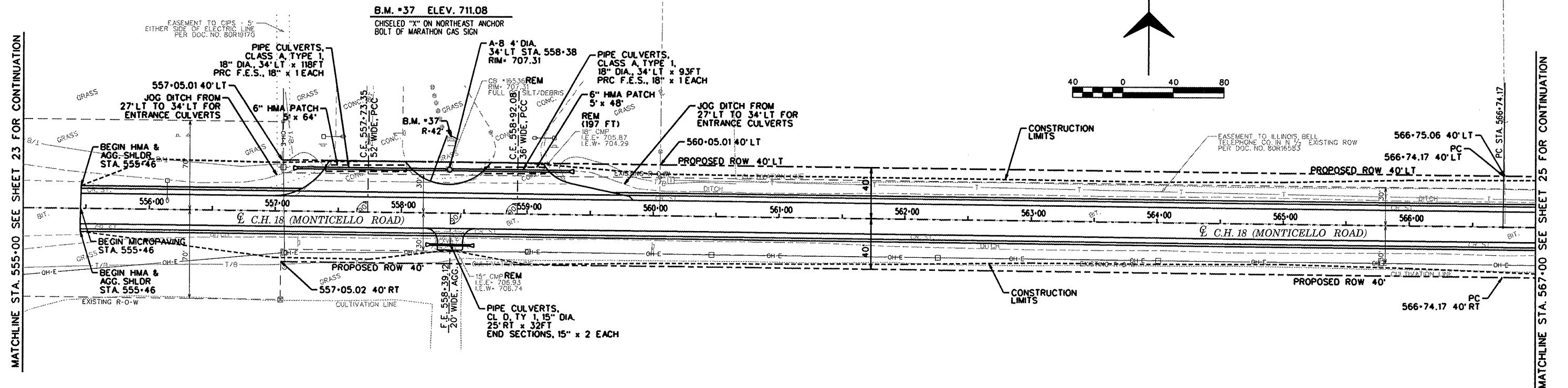

PP39.dgn 7/20/2009 8:31:35 AM