

ROUTE NO.	SECTION	COUNTY	TOTAL SHEETS	SHEET NO.
	07-00419-00-RS	CHAMPAIGN	162	127
STA.		TO STA.		750
F.H.W.A. REG.		ILLINOIS	PROJECT	ARA-HSIP-531(10B)

DATE	
BY	
FINAL SURVEY	
NOTE BOOK NO.	
DATE	
BY	
ORIGINAL SURVEY	
NOTE BOOK NO.	

DATE	
BY	
ORIGINAL SURVEY	
NOTE BOOK NO.	
DATE	
BY	
ORIGINAL SURVEY	
NOTE BOOK NO.	

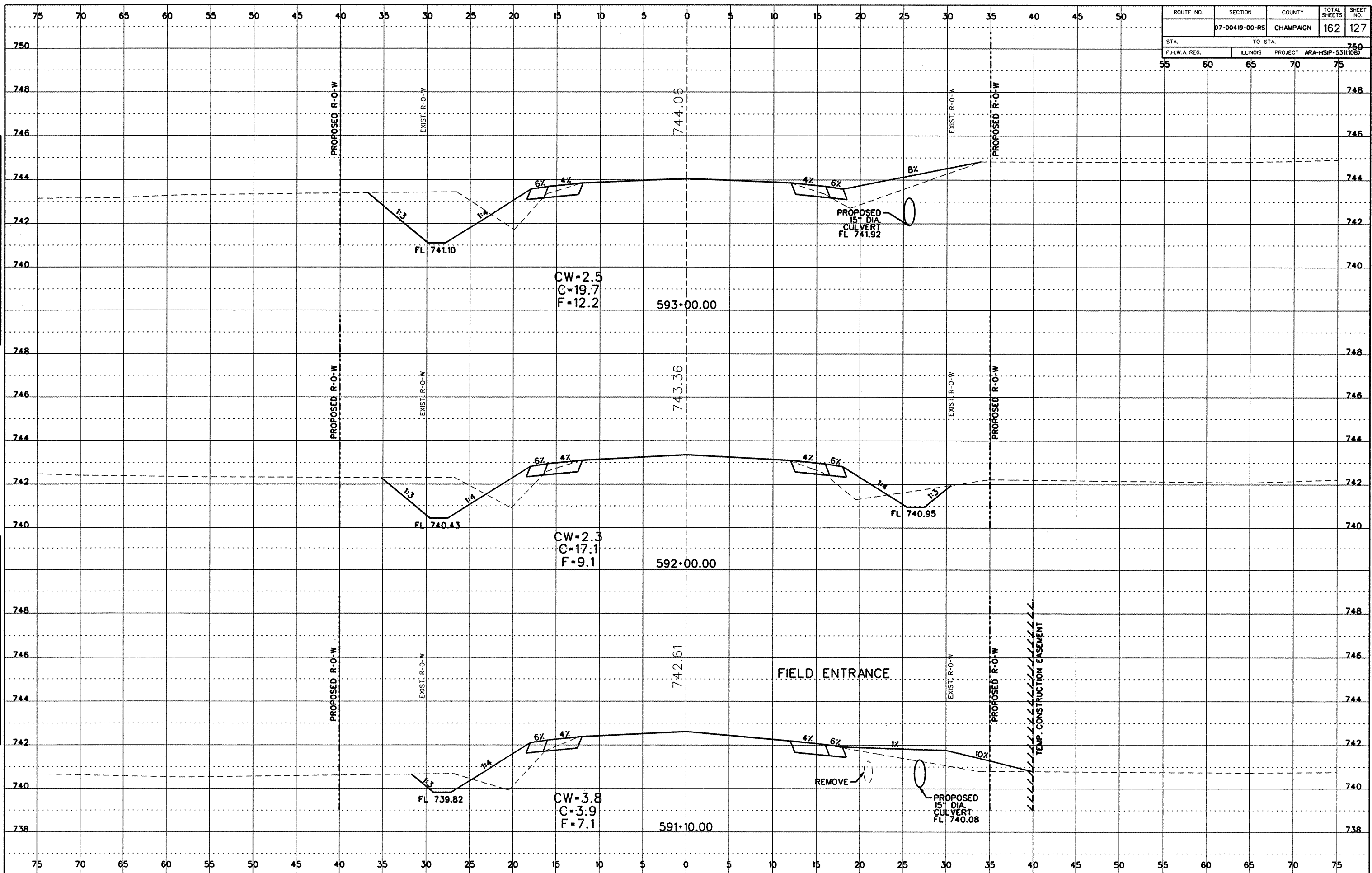

Cross Section Sheets (600E to R45).dgn 8/20/2009 12:47:25 PM