

ROUTE NO.	SECTION	COUNTY	TOTAL SHEETS	SHEET NO.
C.H. 22	05-00907-00-BR	CHAMPAIGN	36	5
STA.		TO STA.		
F.H.W.A. REG.		ILLINOIS PROJECT		

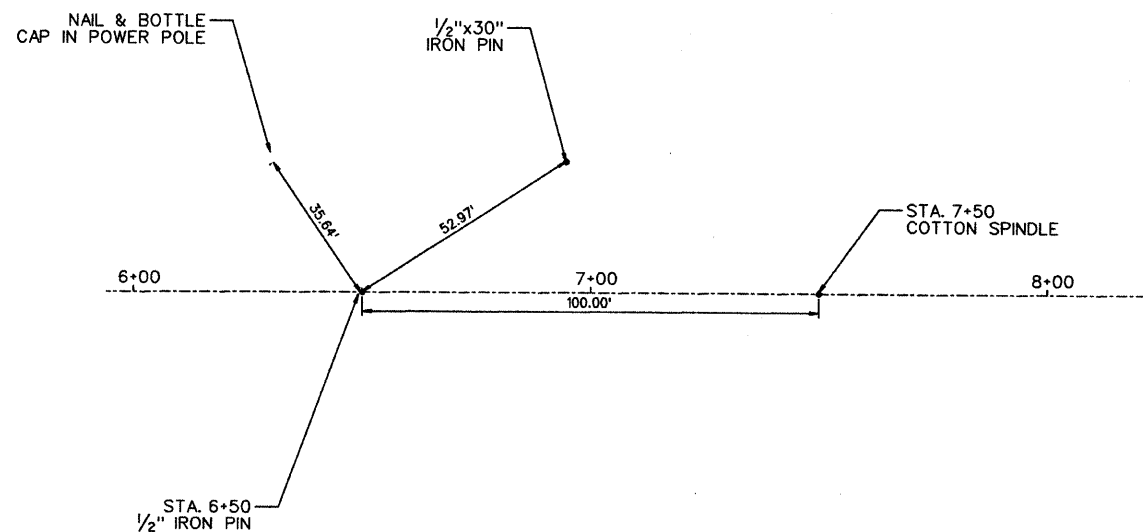

B.M. *06117-1 ELEV. 703.38
 CHROME SPIKE IN NORTH SIDE OF POWER
 POLE, 1.5' ABOVE GROUND, FIRST POLE WEST
 OF BRIDGE, NORTH SIDE OF ROADWAY
 STA. 6+29.83 29.4' LT.

STATION 6+50
COTTON SPINDLE

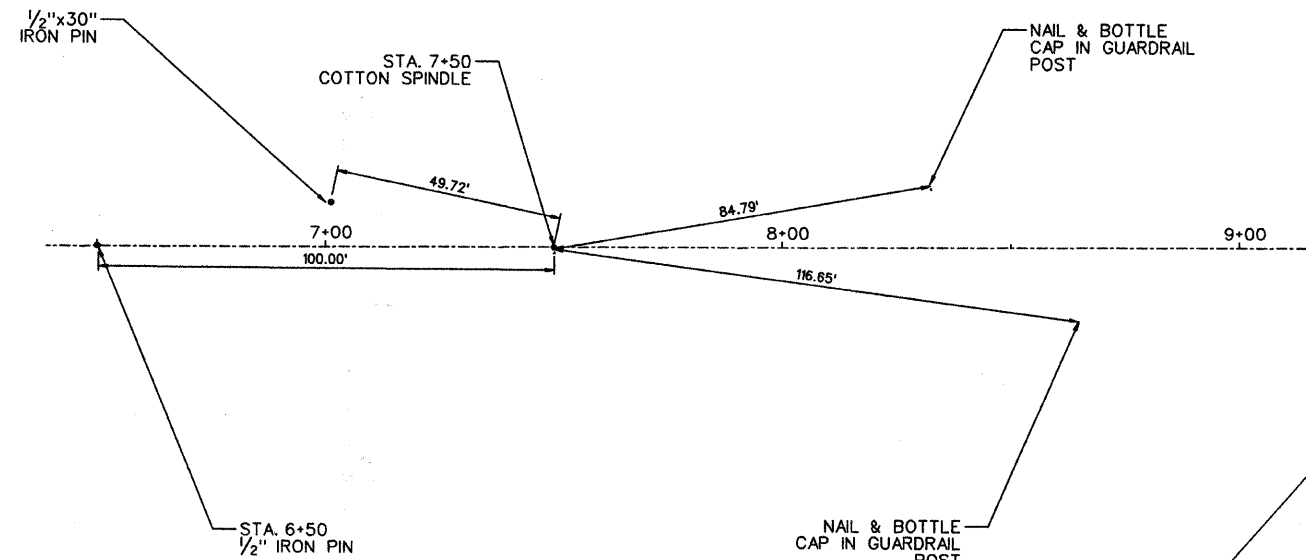
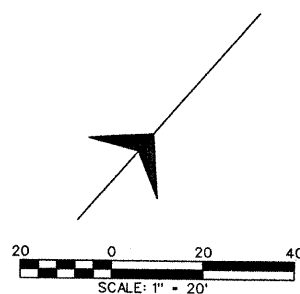

STATION 7+50
COTTON SPINDLE

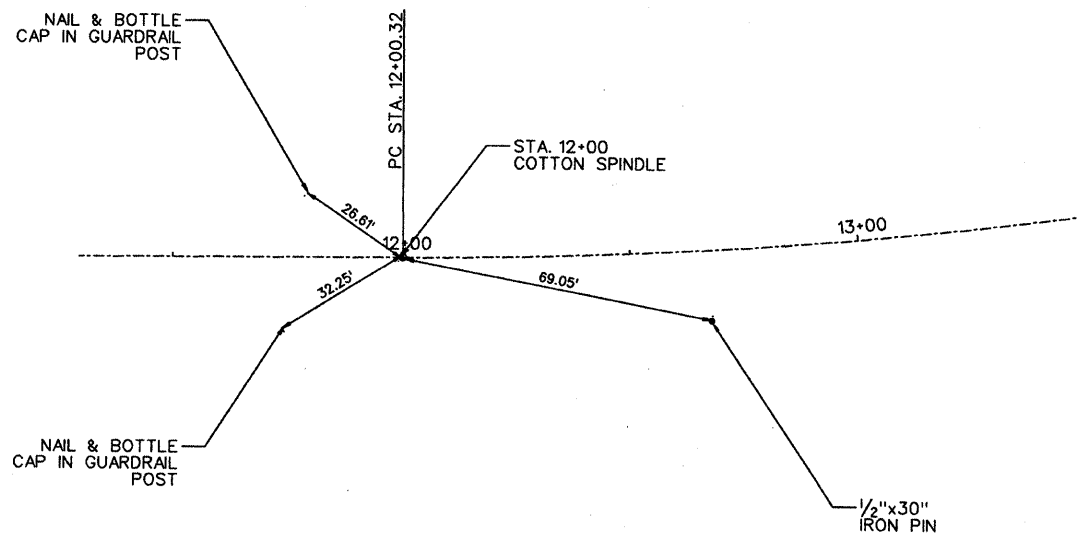
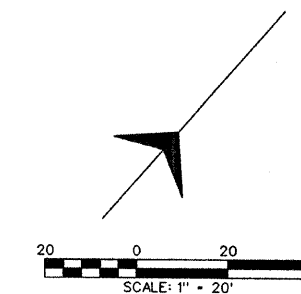

STATION 12+00
COTTON SPINDLE

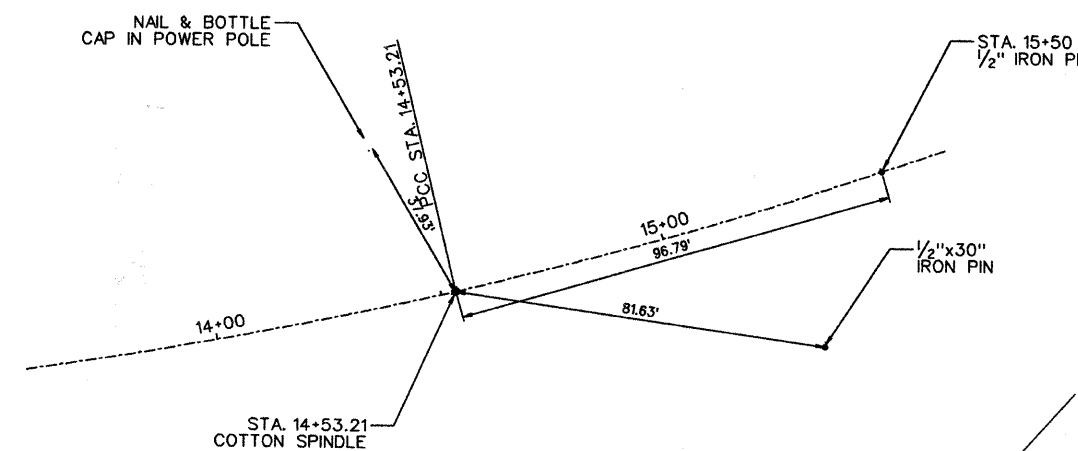
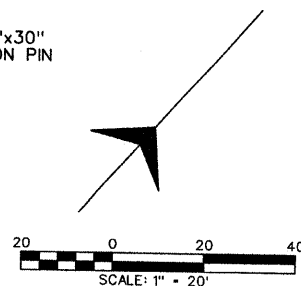

STATION 14+53.21
COTTON SPINDLE

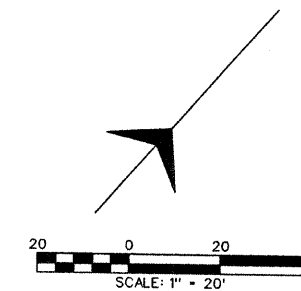

TIE POINTS
 SECTION: 05-00907-00-BR
 CHAMPAIGN COUNTY
 Q. STATION 10+00