

SEC. 14, T.19N., R.8E., 3rd P.M.
CHAMPAIGN COUNTY, ILLINOIS

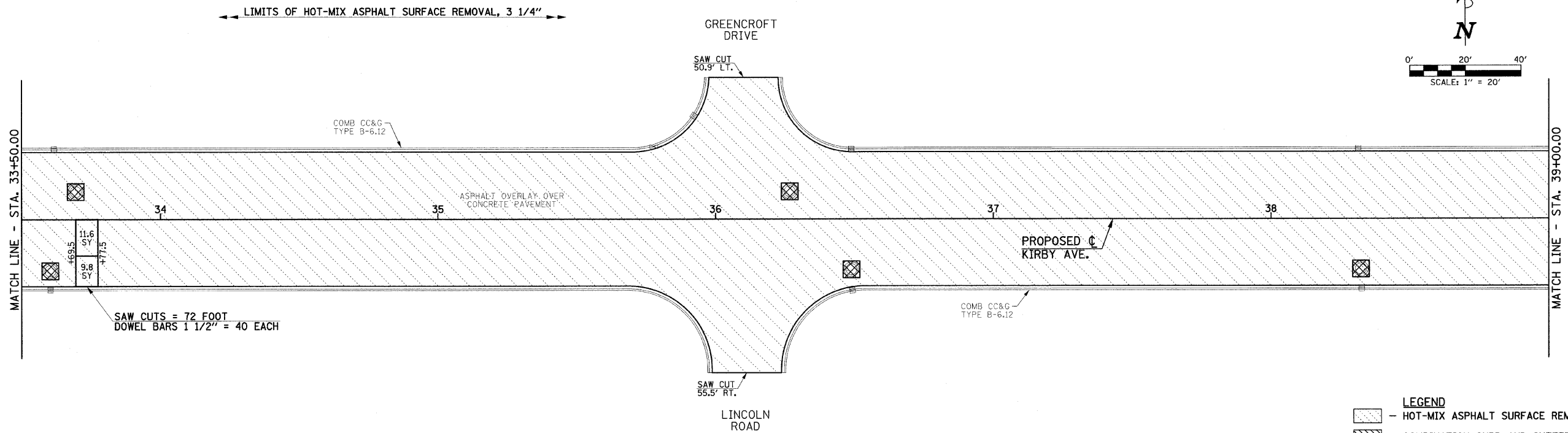

- LEGEND**
- HOT-MIX ASPHALT SURFACE REMOVAL, 3 1/4"
 - COMBINATION CURB AND GUTTER REMOVAL
 - CLASS B PATCHES, TYPE II, 12 INCH
 - PAVEMENT PATCHING SPECIAL (SEE DETAIL)

SEC. 23, T.19N., R.8E., 3rd P.M.
CHAMPAIGN COUNTY, ILLINOIS

SEC. 14, T.19N., R.8E., 3rd P.M.
CHAMPAIGN COUNTY, ILLINOIS

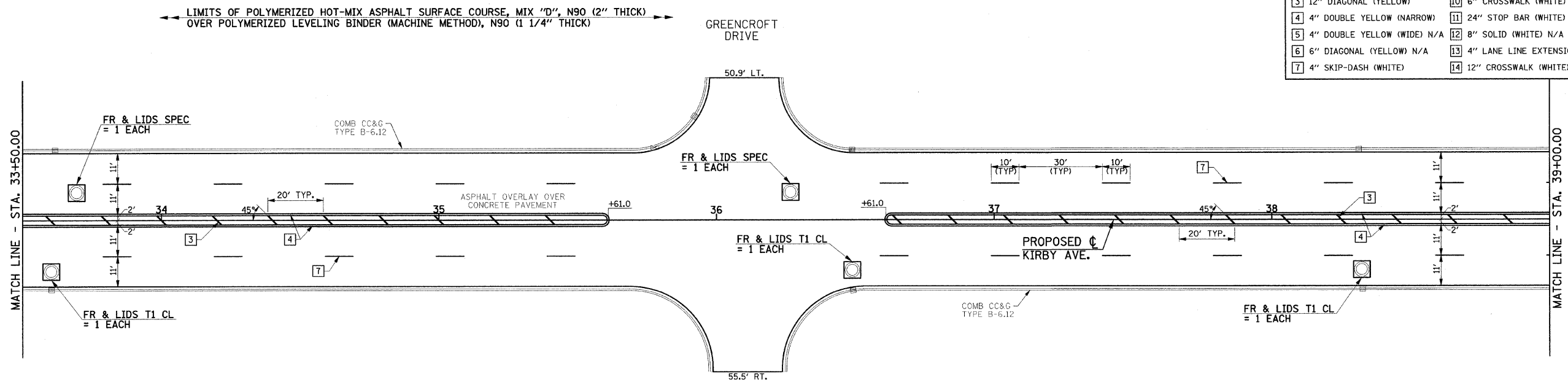

TYPICAL PAVEMENT MARKING LEGEND

| | |
|-------------------------------|--|
| 1 4" SKIP-DASH (YELLOW) | 8 4" SOLID (WHITE) |
| 2 4" SOLID (YELLOW) | 9 12" DIAGONAL (WHITE) N/A |
| 3 12" DIAGONAL (YELLOW) | 10 6" CROSSWALK (WHITE) |
| 4 4" DOUBLE YELLOW (NARROW) | 11 24" STOP BAR (WHITE) |
| 5 4" DOUBLE YELLOW (WIDE) N/A | 12 8" SOLID (WHITE) N/A |
| 6 6" DIAGONAL (YELLOW) N/A | 13 4" LANE LINE EXTENSIONS (WHITE) N/A |
| 7 4" SKIP-DASH (WHITE) | 14 12" CROSSWALK (WHITE) |

SEE SCHEDULE OF QUANTITIES AND MISCELLANEOUS DETAILS SHEET FOR ADDITIONAL INFORMATION.

FILE NAME =
p:\c0010470\plans\sheets\kirbyplan.dgn
PLOT DATE =
7/16/2009 10:44:39 AM

| | |
|-------------------|-----------|
| DESIGNED - R.L.H. | REVISED - |
| DRAWN - J.L.B. | REVISED - |
| CHECKED - J.T.P. | REVISED - |
| DATE - 6-09 | REVISED - |

STATE OF ILLINOIS
DEPARTMENT OF TRANSPORTATION

PLAN - KIRBY AVENUE

SCALE : 1"=20' SHEET NO. 16 OF 27 SHEETS STA. 33+50.00 TO STA. 39+00.00

| | | | | |
|------------------------------|------------------------|---------------------------------|-----------------|--------------|
| F.A.U. RTE. 7138 | SECTION 09-00281-00-RS | COUNTY CHAMPAIGN | TOTAL SHEETS 27 | SHEET NO. 16 |
| FED. ROAD DIST. NO. ILLINOIS | | FED. AID PROJECT ARA-5181 (046) | | |