

SEC. 14, T.19N., R.8E., 3rd P.M.
CHAMPAIGN COUNTY, ILLINOIS

SEC. 13, T.19N., R.8E., 3rd P.M.
CHAMPAIGN COUNTY, ILLINOIS

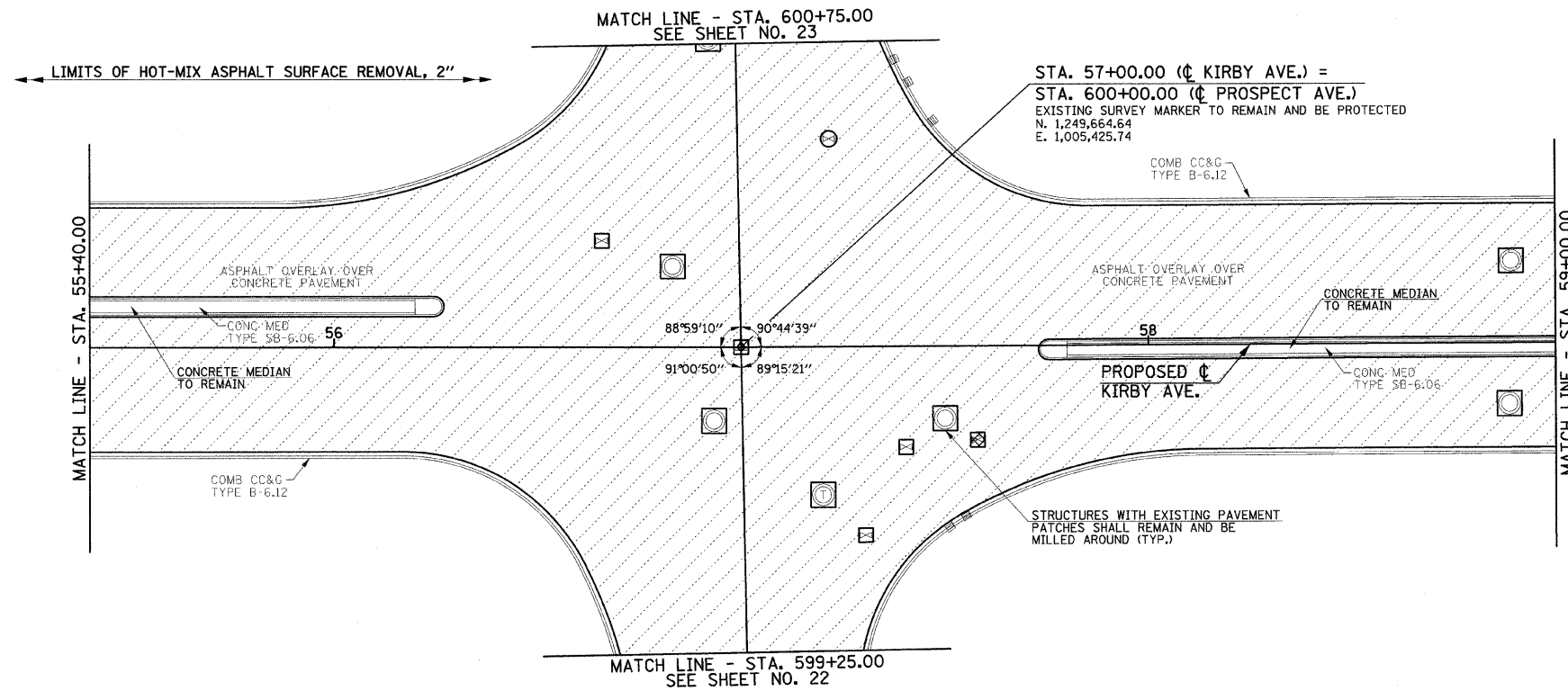
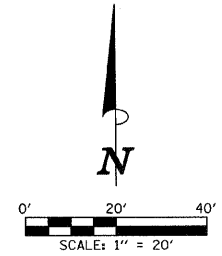

SEC. 23, T.19N., R.8E., 3rd P.M.
CHAMPAIGN COUNTY, ILLINOIS

SEC. 24, T.19N., R.8E., 3rd P.M.
CHAMPAIGN COUNTY, ILLINOIS

LEGEND

- HOT-MIX ASPHALT SURFACE REMOVAL, 2"
- COMBINATION CURB AND GUTTER REMOVAL
- CLASS B PATCHES, TYPE II, 12 INCH
- PAVEMENT PATCHING SPECIAL (SEE DETAIL)

SEC. 14, T.19N., R.8E., 3rd P.M.
CHAMPAIGN COUNTY, ILLINOIS

SEC. 13, T.19N., R.8E., 3rd P.M.
CHAMPAIGN COUNTY, ILLINOIS

TYPICAL PAVEMENT MARKING LEGEND

1 4" SKIP-DASH (YELLOW)	8 4" SOLID (WHITE)
2 4" SOLID (YELLOW)	9 12" DIAGONAL (WHITE) N/A
3 12" DIAGONAL (YELLOW)	10 6" CROSSWALK (WHITE)
4 4" DOUBLE YELLOW (NARROW)	11 24" STOP BAR (WHITE)
5 4" DOUBLE YELLOW (WIDE) N/A	12 8" SOLID (WHITE) N/A
6 6" DIAGONAL (YELLOW) N/A	13 4" LANE LINE EXTENSIONS (WHITE) N/A
7 4" SKIP-DASH (WHITE)	14 12" CROSSWALK (WHITE)

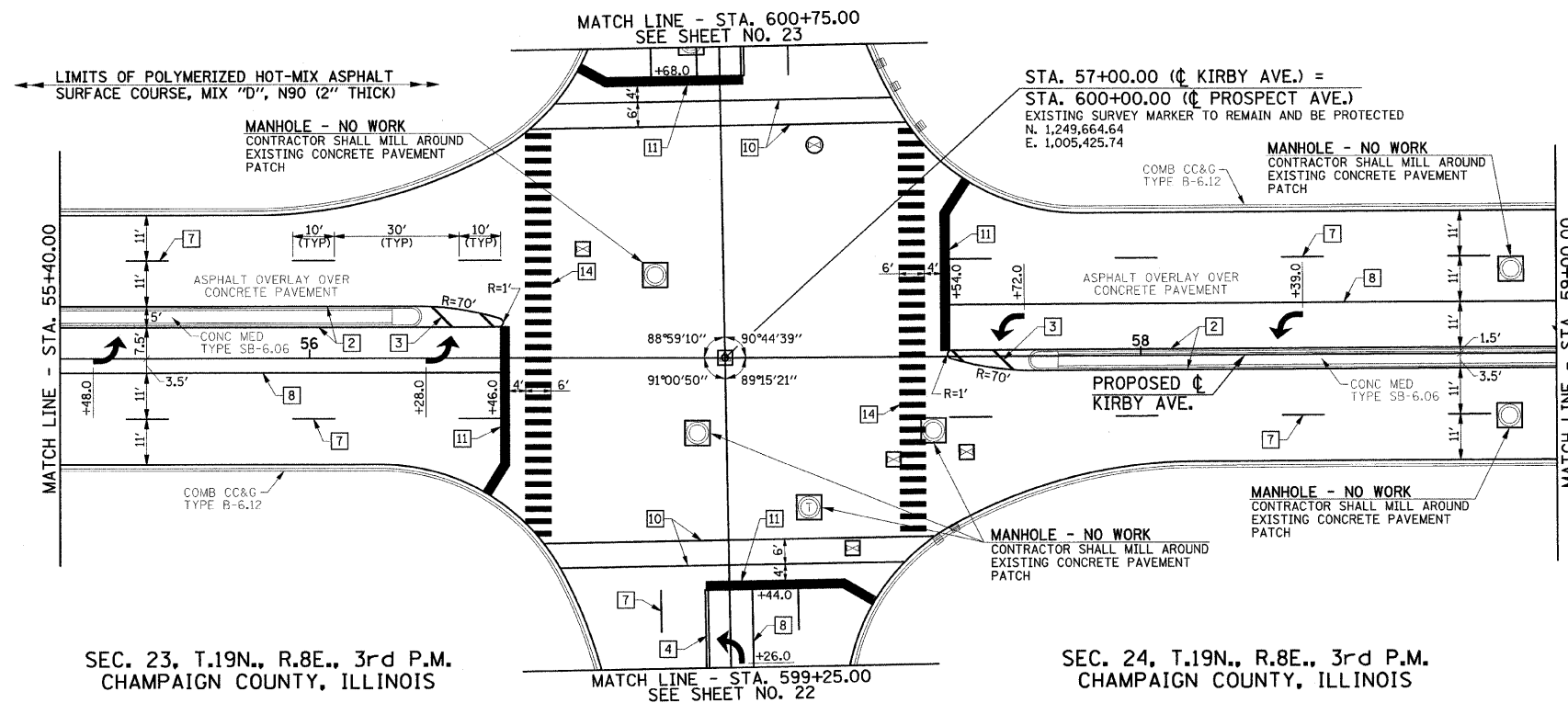

SEC. 23, T.19N., R.8E., 3rd P.M.
CHAMPAIGN COUNTY, ILLINOIS

SEC. 24, T.19N., R.8E., 3rd P.M.
CHAMPAIGN COUNTY, ILLINOIS

SEE SCHEDULE OF QUANTITIES AND MISCELLANEOUS DETAILS SHEET FOR ADDITIONAL INFORMATION.

FILE NAME = p:\c0010470\plans\sheets\kirbyplan.dgn
PLOT DATE = 7/16/2009 10:44:41 AM

DESIGNED - R.L.H.	REVISED -
DRAWN - J.L.B.	REVISED -
CHECKED - J.T.P.	REVISED -
DATE - 6-09	REVISED -

STATE OF ILLINOIS
DEPARTMENT OF TRANSPORTATION

PLAN - KIRBY AVENUE

SCALE: 1"=20' SHEET NO. 20 OF 27 SHEETS STA. 55+40.00 TO STA. 59+00.00

F.A.U. RTE.	SECTION	COUNTY	TOTAL SHEETS	SHEET NO.
7138	09-00281-00-RS	CHAMPAIGN	27	20
CONTRACT NO. 91408				
FED. ROAD DIST. NO. ILLINOIS FED. AID PROJECT ARA-5181 (046)				