

ROUTE	SECTION	COUNTY	TOTAL SHEETS	SHEET NUMBER
C.H. 20	07-00160-00-RS	VERMILION	71	1

STATE OF ILLINOIS
VERMILION COUNTY HIGHWAY DEPARTMENT
PLANS FOR PROPOSED
AMERICAN RECOVERY AND REINVESTMENT ACT PROJECT
COUNTY HIGHWAY 20 FALL RTE 6998
DENMARK ROAD
SECTION 07-00160-00-RS
JOB NO. - C-95-325-09

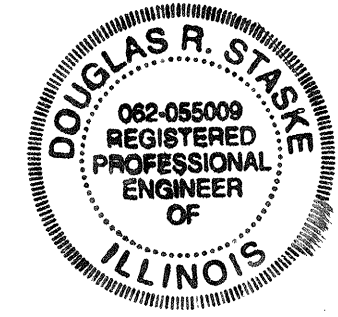

PROJECT NO. RS-ARA-5016(037)

LOCATION MAP

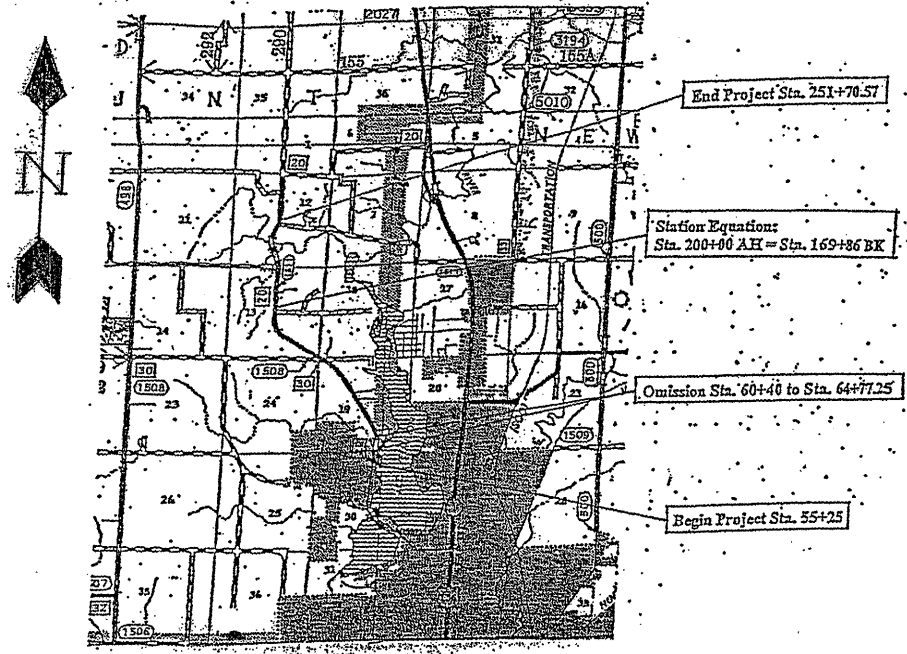

Project Length: 16631.57ft = 3.15 Miles
 Project Net Length: 16194.32ft = 3.07 Miles

Country Club Rd to Boat Club Rd
 ADT: 1950 (Current) 1950 (Design)
 Functional Classification: Minor Arterial

Boat Club Rd to CH 30
 ADT: 1600 (Current) 1600 (Design)
 Functional Classification: Minor Arterial

CH 30 to 2300N
 ADT: 1450 (Current) 1450 (Design)
 Functional Classification: Minor Arterial

2300N to West Newell Rd
 ADT: 2300 (Current) 2300 (Design)
 Functional Classification: Major Collector

INDEX OF SHEETS	
1	Cover Sheet
2	Summary of Quantities
3	General Notes/Earthwork Summary
4 - 12	Schedule of Quantities
13	Curve Data
14 - 20	Detailed Location Map
21 - 29	Existing Typical Cross Section
30 - 42	Proposed Typical Cross Section
43 - 54	Special Details
55	Temporary Erosion Control
56 - 71	Cross Sections Denmark Rd/Old Union Rd

IDOT HIGHWAY STANDARDS

- 280001-04 Temporary Erosion Control System
- 442101-07 Class B Patches
- 482001-02 HMA Shoulder Adjacent to Flexible Pavement
- 482011-03 HMA Shoulder Strips/Shoulders with Resurfacing or Widening and Resurfacing Projects
- 606101-04 Type A Gutter (Inlet, Outlet & Entrance)
- 701001-02 Off Road Operations 2L,2W, More than 15' (4.5m) Away from Pavement Edge
- 701006-03 Off Road Operations 2L, 2W, 15' (4.5m) to 24" (600mm) Away from Pavement Edge
- 701011-02 Off-Road Moving Operations, 2L, 2W, Day Only
- 701201-03 Lane Closure, 2L, 2W, Day Only, for Speeds ≥ 45 MPH
- 701301-03 Lane Closure, 2L, 2W, Short Time Operations
- 701306-02 Lane Closure, 2L, 2W, Slow Moving Operations - Day Only for Speeds ≥ 45 MPH
- 701311-03 Lane Closure, 2L, 2W, Moving Operations - Day Only
- 701326-03 Lane Closure, 2L, 2W, Pavement Widening, for Speeds ≥ 45 MPH
- 701336-05 Lane Closure, 2L, 2W, Work Areas in Series for Speeds ≥ 45 MPH
- 701901-01 Traffic Control Devices
- 780001-02 Typical Pavement Markings
- 781001-03 Typical Applications Raised Reflective Pavement Markers
- BLR 24-2 Mailbox Turnout for Local Roads

Douglas R. Staske
 Illinois Licensed Professional Engineer Number 05509
 License Expires 11/30/09

APPROVED	<i>August 5</i>	,2009
	<i>Douglas R. Staske</i>	COUNTY ENGINEER
PASSED	<i>8/10</i>	,2009
	<i>DA Staske</i>	DISTRICT 5 ENGINEER OF LOCAL ROADS & STREETS
RELEASED FOR BID BASED ON LIMITED REVIEW	<i>August 11</i>	,2009
	<i>John</i>	DEPUTY DIRECTOR OF HIGHWAYS REGION 3 ENGINEER
		STATE OF ILLINOIS DEPARTMENT OF TRANSPORTATION

PREPARED BY:
 VERMILION COUNTY HIGHWAY DEPARTMENT
 ENGINEERING DIVISION
 June 29, 2009

Contract No. 91409