

ROUTE NO.	SECTION	COUNTY	TOTAL SHEETS	SHEET NO.
FAS 496	*	Vermilion	18	9
FED. ROAD DIST. 3-3.7		FED. AID PROJECT		

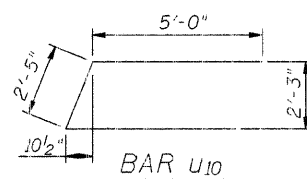

Bar	"L"	"M"	"N"
h ₁₀	8'-6"	12"	8'-6"
h ₁₁	9'-3"	12"	5'-4 1/2"
h ₁₆	6'-5"	1'-6"	1'-9"
h ₁₇	6'-5"	7"	1'-9"
h ₁₈	8'-9"	12"	8'-9"
h ₁₉	9'-2"	12"	7'-6"
h ₂₂	6'-5"	1'-1"	1'-9"

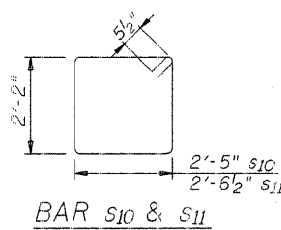
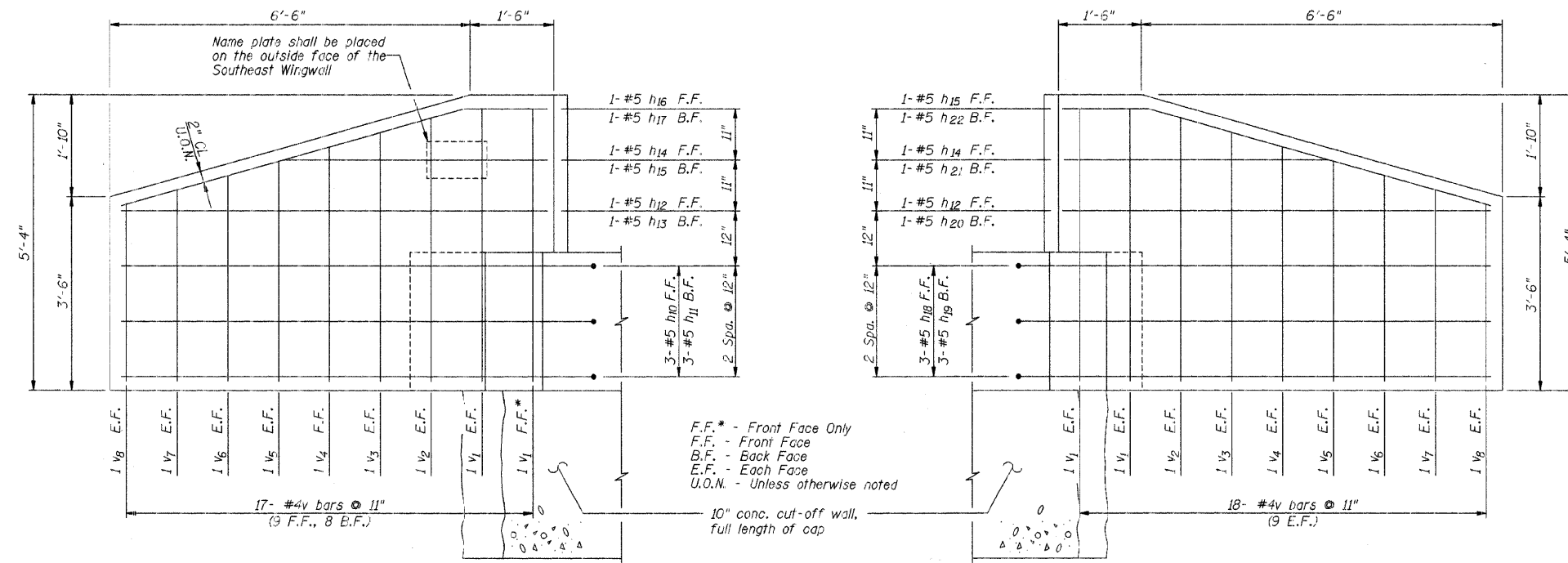
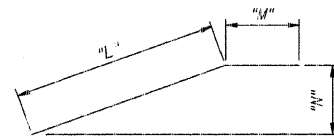

DESIGN	K.J. Hoffmann				
DR	K.J. Hoffmann				
CHK	J.R. Wolf				
APVD	J.F. Fraenhoffer	NO.	DATE	REVISION	BY

FRAUENHOFFER
 Fraenhoffer and Associates, P.C. Consulting Engineers
 3002 Crossing Court Champaign, IL 61822 217-351-6268

ABUTMENTS (SHEET 2 OF 2)		SHEET 9
FAS 496 (C.H. 14) OVER MIDDLE BRANCH OF N. FORK		DWG NO. 97051-at1.dgn
SEC. 97-00141-00-BR		DATE APR 2009
VERMILION COUNTY		PROJ. NO. 97051