

TOWN OF NORMAL, ILLINOIS

FAU RTE 6356 VIRGINIA AVENUE FROM MAIN STREET (US RTE 51) TO UNIVERSITY STREET McLEAN COUNTY

JOB NO. C-95-336-09 SECTION 04-00226-00-BR FEDERAL PROJECT ARA-5227(053)

INDEX OF SHEETS

SHEET NO.	TITLE
1	COVER SHEET
2	GENERAL NOTES, CONTROL TIES AND BENCHMARKS
3-5	SUMMARY OF QUANTITIES
6	TYPICAL CROSS SECTIONS AND LEGEND
7-8	SCHEDULE OF QUANTITIES
9	DETOUR PLAN
10	REMOVAL PLAN
11-13	PLAN AND PROFILE
14	EROSION CONTROL PLAN (SWPPP)
15	MISCELLANEOUS DETAILS
16	STORM SEWER DETAIL
17	SAW JOINT DETAILS AND ELEVATION PLAN
18	PAVEMENT MARKING PLANS
19	SIGNAL PLAN
20	CABLE PLAN
21	MAST ARM LOADING PLAN
22-44	CULVERT PLANS
45-46	SANITARY SEWER DETAILS
47-48	WATER MAIN DETAILS
49-52	CROSS SECTIONS

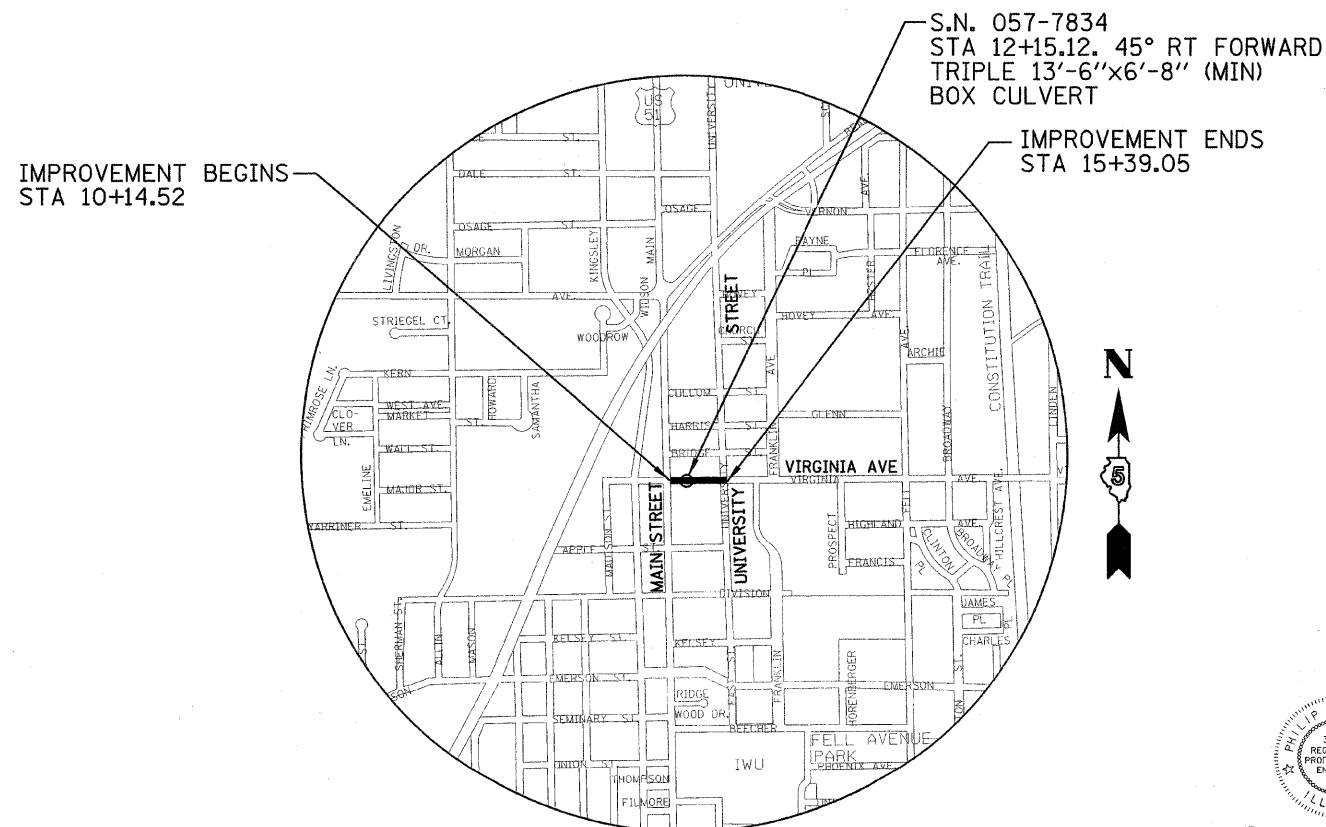
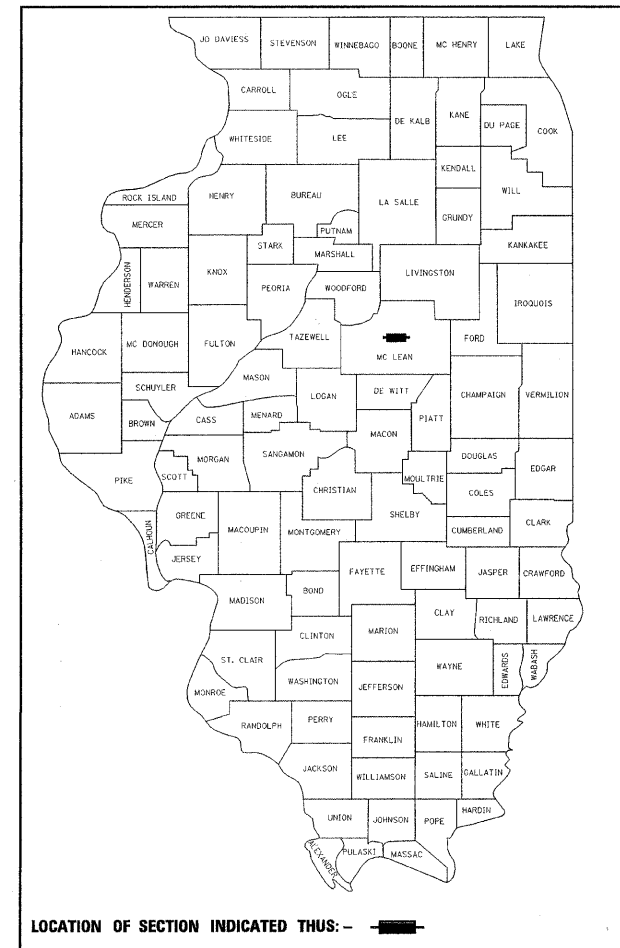

LOCATION MAP

NOT TO SCALE

TOWN OF NORMAL, ILLINOIS

GROSS AND NET LENGTH VIRGINIA AVENUE = 524.53 FT = 0.099 MILES

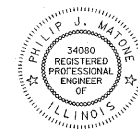

Philip Matrone 7/31/09
SIGNATURE

EXPIRATION DATE NOV. 30, 2009

Approved	<u>July 31</u> 20 <u>09</u> Gene Brown, City Engineer Town Of Normal
Passed	<u>8/24</u> 20 <u>09</u> District #5 Engineer of Local Roads & Streets
Releasing for Bid Based on Limited Review	<u>8/24/2009</u> Deputy Director of Highways, Region #3 Engineer
STATE OF ILLINOIS DEPARTMENT OF TRANSPORTATION	

J.U.L.I.E. PHONE NUMBER 1-800-982-0123

DESIGNED - JDA	REVISED -	TOWN OF NORMAL	COVER SHEET	VIRGINIA AVENUE OVER SUGAR CREEK SECTION 04-00226-00-BR McLEAN COUNTY	F.A.U.	SECTION	COUNTY	TOTAL SHEETS	SHEET NO.
DRAWN - DRR	REVISED -				6356	04-00226-00-BR	McLEAN	52	1
CHECKED - PJM	REVISED -					S.N. 057-7834			
DATE - 07/22/09	REVISED -								CONTRACT NO. 91416
						FED. ROAD DIST. NO.	ILLINOIS FED. AID PROJECT		

FARNSWORTH GROUP, INC.

CONSULTING ENGINEERS - 2709 MCGRAW DRIVE BLOOMINGTON, ILLINOIS 61704 (309) 663-8435 / (309) 663-1571 FAX