

RTE.	SECTION	COUNTY	TOTAL SHEETS	SHEET NO.
6999	08-00330-01-PV	VERMILION	77	13
VOORHEES STREET				
CONTRACT NO. 91417				

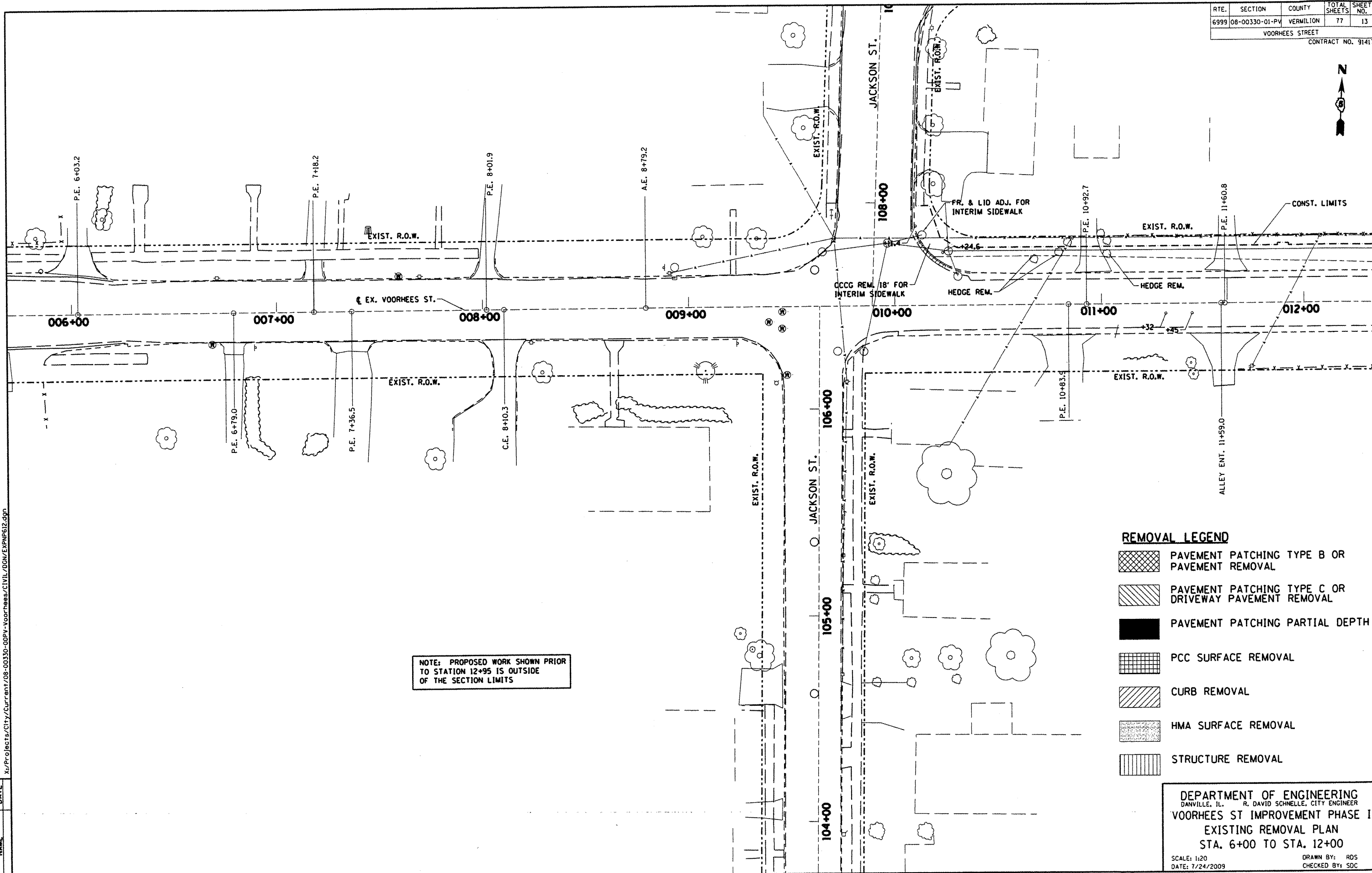

NOTE: PROPOSED WORK SHOWN PRIOR TO STATION 12+95 IS OUTSIDE OF THE SECTION LIMITS

**REMOVAL LEGEND**

- PAVEMENT PATCHING TYPE B OR PAVEMENT REMOVAL
- PAVEMENT PATCHING TYPE C OR DRIVEWAY PAVEMENT REMOVAL
- PAVEMENT PATCHING PARTIAL DEPTH
- PCC SURFACE REMOVAL
- CURB REMOVAL
- HMA SURFACE REMOVAL
- STRUCTURE REMOVAL

DEPARTMENT OF ENGINEERING  
 DANVILLE, IL. R. DAVID SCHNELLE, CITY ENGINEER  
**VOORHEES ST IMPROVEMENT PHASE I**  
**EXISTING REMOVAL PLAN**  
**STA. 6+00 TO STA. 12+00**  
 SCALE: 1:20 DRAWN BY: ROS  
 DATE: 7/24/2009 CHECKED BY: SOC

**danwill**  
 CIVIL ENGINEERS  
 1000 N. MAIN ST.  
 DANVILLE, IL 61832  
 PHONE: 618/261-1111  
 FAX: 618/261-1112  
 WWW.DANWILL.COM

X:\Projects\City\Current\08-00330-00PV-Voorhees\CIVIL\00M\EXP\F612.dgn

REVISIONS	DATE