

ROUTE NO.	SECTION	COUNTY	TOTAL SHEETS	SHEET NO.
FAU 7015	08-00026-00-RS	VERMILION	21	1

STATE OF ILLINOIS DEPARTMENT OF TRANSPORTATION PLANS FOR PROPOSED FEDERAL AID HIGHWAY VILLAGE OF WESTVILLE VERMILION COUNTY MAIN STREET

F.A.U. ROUTE: 7015
SECTION: 08-00026-00-RS
PROJECT NO. ARA-5016 (039)
CONTRACT NO. 91419
JOB NO. C-95-339-09

INDEX OF SHEETS

SHEET NO.	DESCRIPTION
1	COVER SHEET
2-3	TYPICAL SECTIONS
4	GENERAL NOTES
5	SUMMARY OF QUANTITIES
6-7	SCHEDULE OF QUANTITIES
8-15	PLAN & PROFILE SHEETS
16-17	DETAIL SHEET
18-21	STRIPING DETAIL SHEETS

**ILLINOIS DEPT. OF TRANSPORTATION
STANDARD DRAWINGS**

STANDARD NO.	DESCRIPTION
424001-05	CURB RAMPS FOR SIDEWALK
442201-03	CLASS C & D PATCHES
606001-04	CONC. CURB TYPE B & COMB. CONC. CURB & GUTTER
701501-05	TRAFFIC CONTROL - URBAN LANE CLOSURE 2L 2W UNDIVIDED
701502-03	TRAFFIC CONTROL - URBAN LANE CLOSURE 2L 2W W/ BIDIRECTIONAL LT LN
701701-06	TRAFFIC CONTROL - URBAN LANE CLOSURE MULTILANE INTERSECTION
701801-04	TRAFFIC CONTROL - SIDEWALK CLOSURE
701901-01	TRAFFIC CONTROL DEVICES
780001-02	TRYPICAL PAVEMENT MARKINGS
BLR 24-2	MAILBOX TURNOUTS - LOCAL ROADS

SCALES: PLAN 1" = 40'

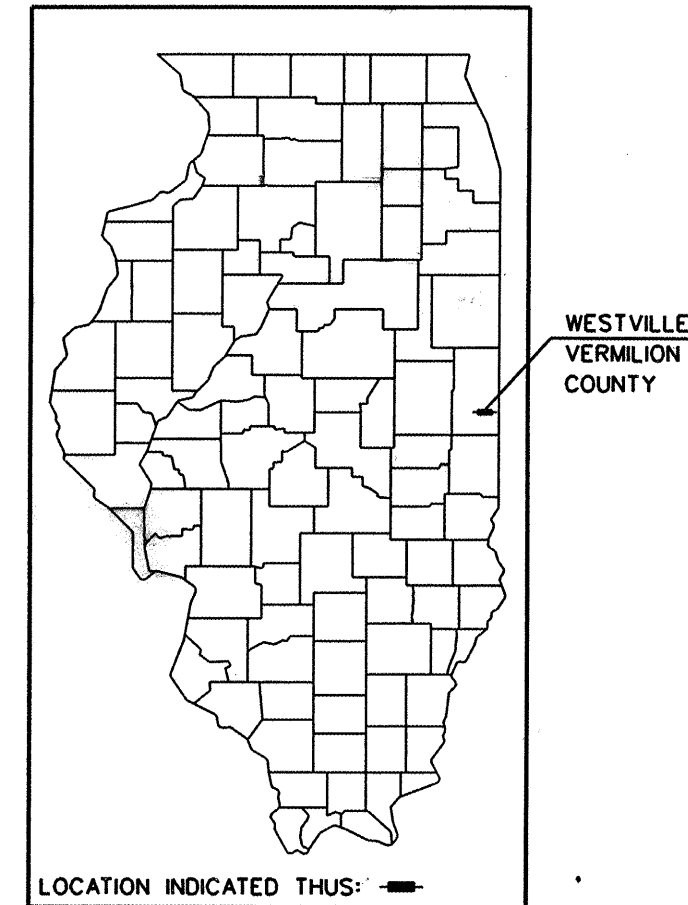

VILLAGE OF WESTVILLE

MAYOR..... JEFF ELLIS
CLERK..... VICKIE L. SMITH
TRUSTEES..... "PORKY" SANDLIN
SHELDON SMITH
JOHN BARTON
BILL COTTRELL
DENA JENKINS
RICK JONES

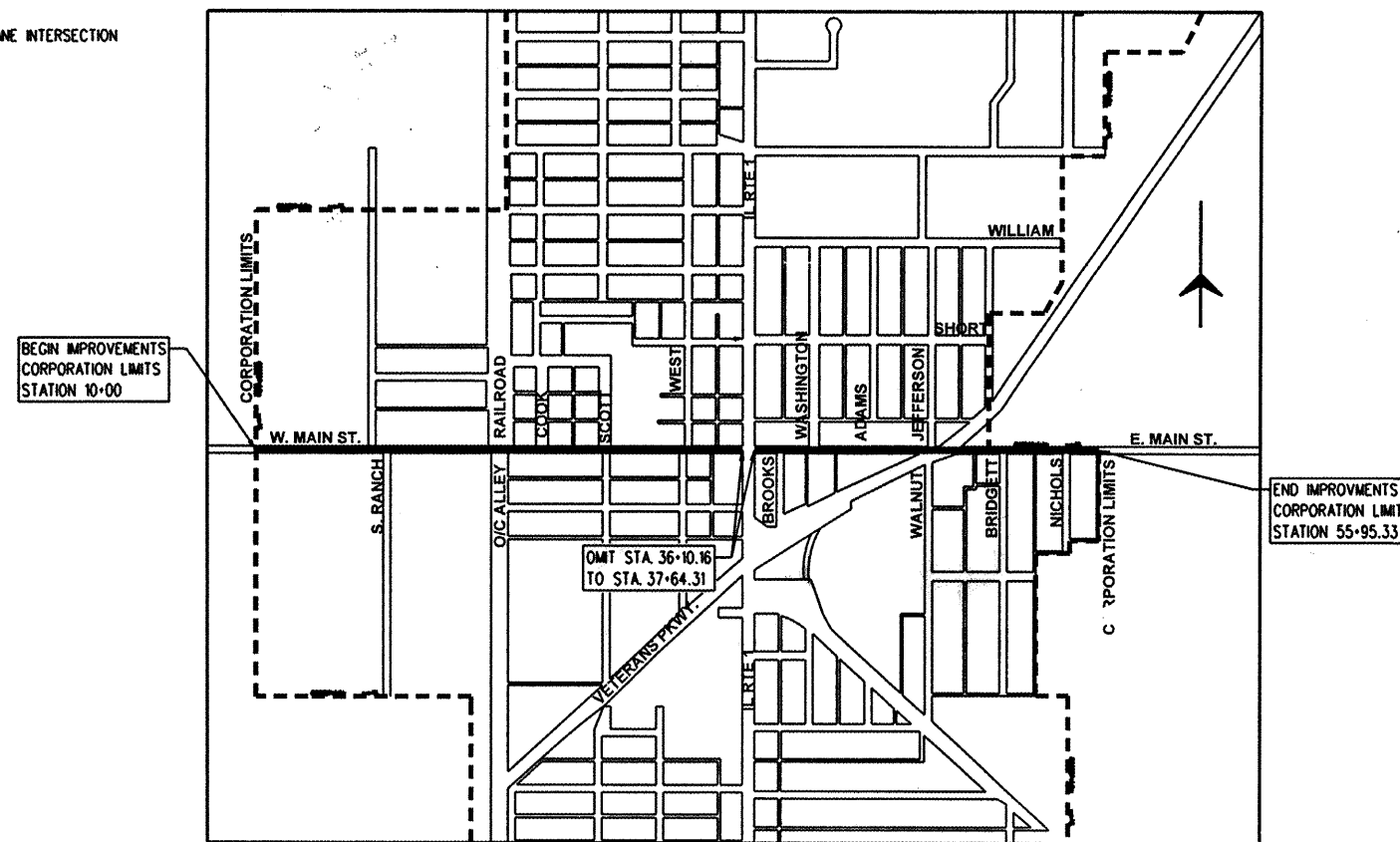

**MAIN STREET
DESIGN DATA**

DESIGN TRAFFIC	
2009 ADT	1500 TO 3400
2019 ADT	1600 TO 3600
2029 ADT	1650 TO 3750
PU & PC%	88% = 1,408 TO 3,168
SUZ	7% = 112 TO 252
MUZ	5% = 80 TO 180

FUNCTIONAL CLASSIFICATION	
MINOR ARTERIAL	
D.P. = 20 YEARS	

PAVEMENT	
2 1/4" TO 3" HMA OVERLAY ON EXISTING PCC PAVEMENT ~7" WITH HMA OVERLAY	

FOR JOINT UTILITY INFORMATION
CALL TOLL FREE 1-800-892-0123

LOCATION MAP
NOT TO SCALE

NET LENGTH OF PROJECT = 4,441.18 LIN. FT. = 0.8411 MILES

APPROVED 7/21 2009
Jeff Ellis
MAYOR OF VILLAGE OF WESTVILLE

PASSED 8/3 2009
DNA
DISTRICT FIVE ENGINEER OF
LOCAL ROADS & STREETS

Released For Bid Based on Limited Review
August 4 2009
[Signature]
DEPUTY DIRECTOR OF HIGHWAYS,
REGION THREE ENGINEER

STATE OF ILLINOIS
DEPARTMENT OF TRANSPORTATION

Ellen B. Hedrick 7/27/09
ELLEN B. HEDRICK DATE
ILLINOIS REGISTERED PROFESSIONAL ENGINEER NO. 062-049131
LICENSE EXPIRES: NOVEMBER 30, 2009



Sodemann and Associates, Inc.
340 NORTH NEIL STREET
POST OFFICE BOX 557
CHAMPAIGN, ILLINOIS 61824-0557
TEL 217 352-7688 FAX 217 352-7922
ENGINEERING / ANALYSIS / MANAGEMENT

