

ROUTE NO.	SECTION	COUNTY	TOTAL SHEETS	SHEET NO.
FAU 7015	08-00026-00-RS	VERMILION	21	14
STA.	TO STA.			
F.H.W.A. REG.	ILLINOIS PROJECT NO. ARA-5016 (039)			

PLAN	SURVEYED	DATE
	PLOTTED	
	ALIGNED	
	CHECKED	
	RT. OF WAY	
	CHECKED	
	NO.	

PROFILE	SURVEYED	DATE
	PLOTTED	
	GRADES	
	CHECKED	
	EM'S	
	NOTED	
	STRUCTURE	
	NOTATIONS	
	CYRD	
	NO.	

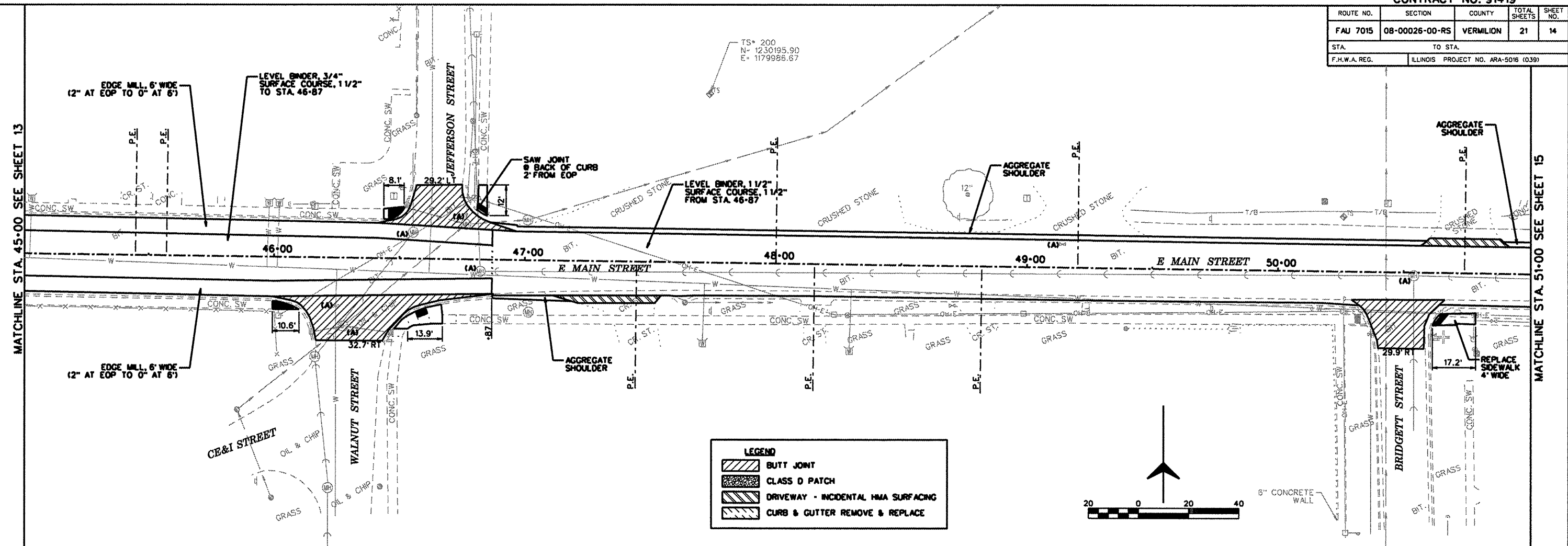

LEGEND

- BUTT JOINT
- CLASS D PATCH
- DRIVEWAY - INCIDENTAL HMA SURFACING
- CURB & GUTTER REMOVE & REPLACE

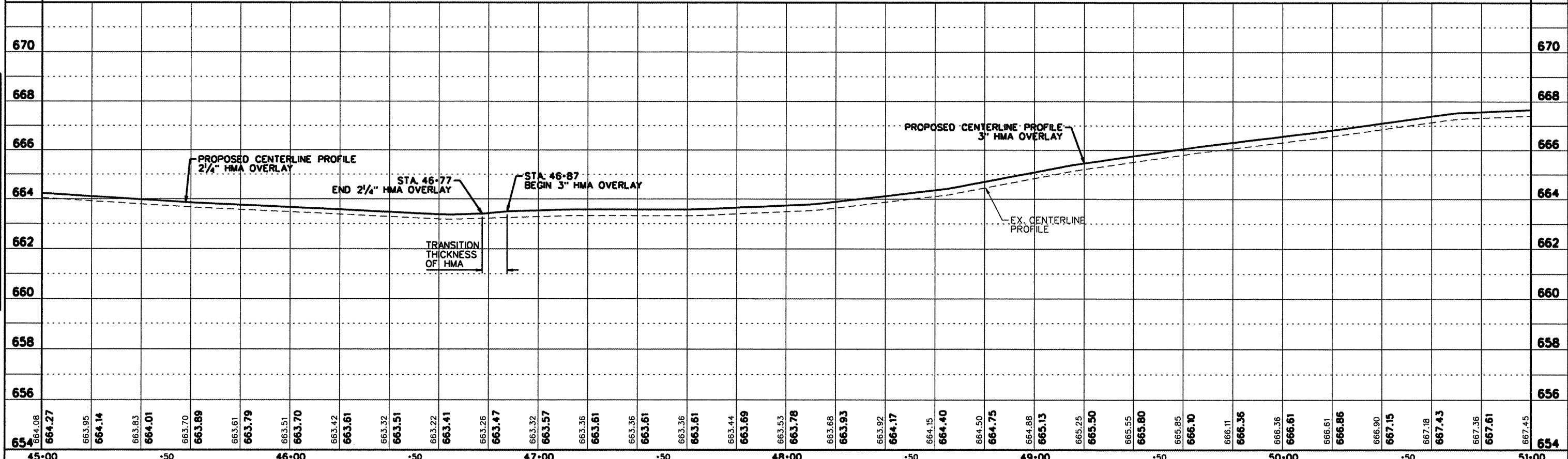
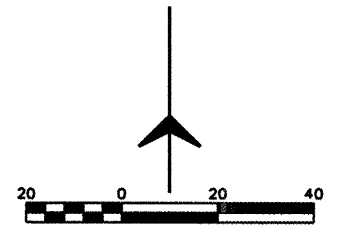

J:\09078\drawings\PP7.dgn 7/15/2009 3:37:12 PM