

DATE	
BY	
SURVEYED	
PLANNED	
NOTE BOOK	
NO. _____	
AREAS CHECKED	

DATE	
BY	
SURVEYED	
PLANNED	
NOTE BOOK	
NO. _____	
AREAS CHECKED	

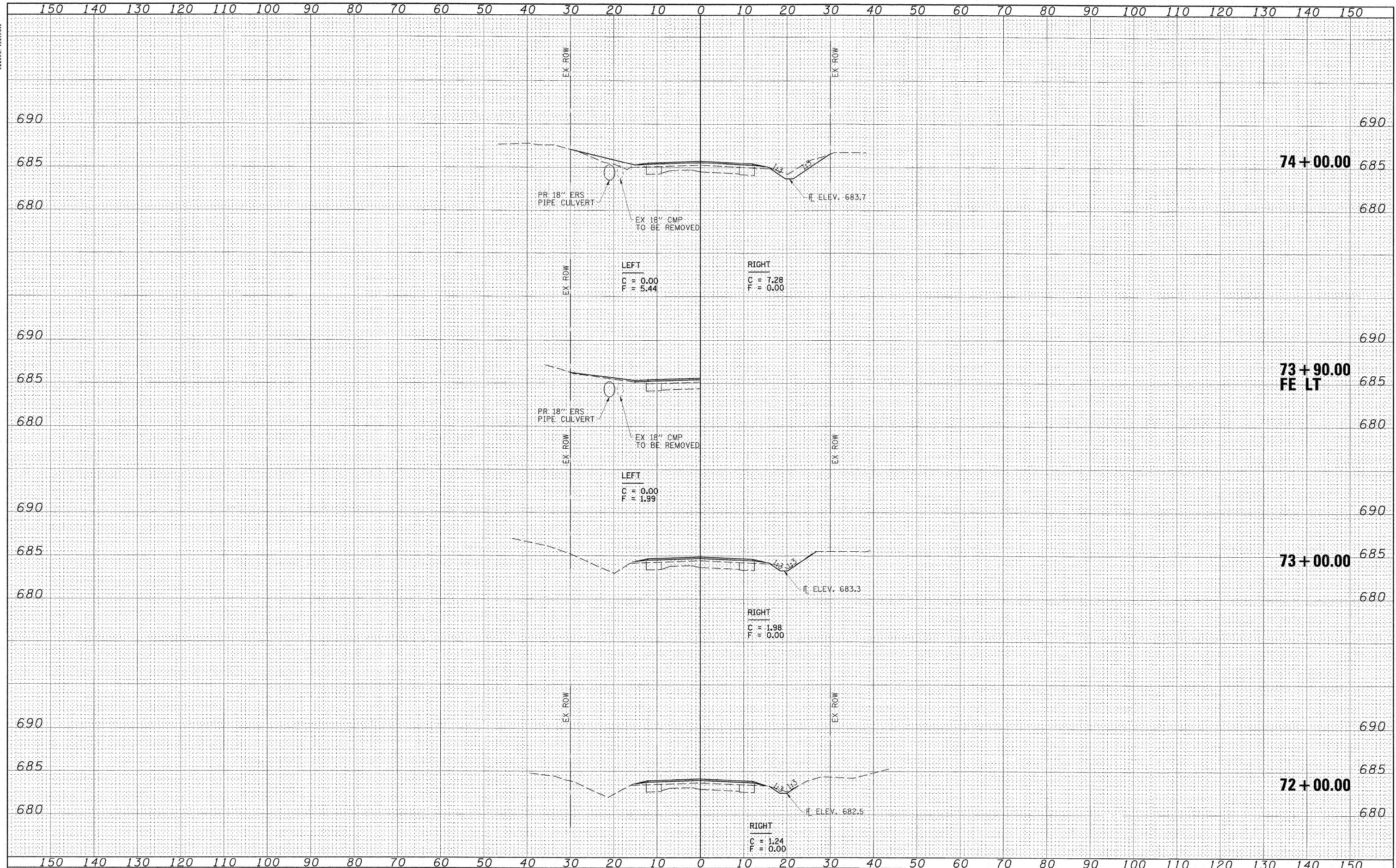

FILE NAME = Z4402X01.dgn  
 USER NAME = HAS  
 DESIGNED - ELH  
 DRAWN - RJT  
 CHECKED - ELH  
 PLOT DATE = 7/13/2009 2:34:07 PM  
 DATE - 04/03/09

DESIGNED - ELH	REVISED -
DRAWN - RJT	REVISED -
CHECKED - ELH	REVISED -
DATE - 04/03/09	REVISED -

**STATE OF ILLINOIS  
DEPARTMENT OF TRANSPORTATION**

**SHADY REST ROAD CROSS SECTIONS**

SCALE: AS SHOWN SHEET NO. 23 OF 27 SHEETS STA. 72+00.00 TO STA. 74+00.00

F.A.S. RTE. 535	SECTION 08-00115-01-RS	COUNTY PIATT	TOTAL SHEETS 53	SHEET NO. 49
FED. ROAD DIST. NO.		ILLINOIS FED. AID PROJECT		

CONTRACT NO. 91421