

ROUTE NO.	SECTION	CITY	TOTAL SHEETS	SHEET NO.
FAU 7467	99-00021-00-RP	MT. ZION	36	12
FED. ROAD DIST. NO.		ILLINOIS	PROJECT	

CONTRACT NUMBER 95603
PROJECT ARA-5169 (043)

REVISIONS	NO.	BY	DATE

BRYAN BRIDGE & ASSOCIATES, INC.
 Consulting Engineers
 1000 SOUTH TAYLORVILLE ROAD
 DECATUR, ILLINOIS
 License 184-001285

DESIGNED	MAP	SCALE
MAP	DATE	Hor. 1" = 20' Ver. 1" = 2'
Les Jenkins	July 2008	
FIELD BOOK	JOB NO.	
122	CB-0144	

VILLAGE OF MT. ZION, ILLINOIS
FLETCHER PARK BOULEVARD / BRAVES PARKWAY
ROADWAY PLAN AND PROFILE
 STATION 396+55.30 TO 398+50.00

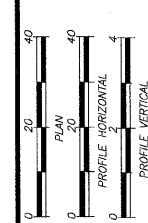

SHEET NO.
12
 OF
36

PROP. CURVE CL101
 PI STA. = 345+57.51
 $\Delta = 24^\circ 24' 55" (LT)$
 $D = 71^\circ 29' 23"$
 $R = 165.00'$
 $T = 200.16'$
 $L = 342.66'$
 $E = 25.90'$
 P.C. STA = 343+56.75
 P.T. STA = 347+49.41

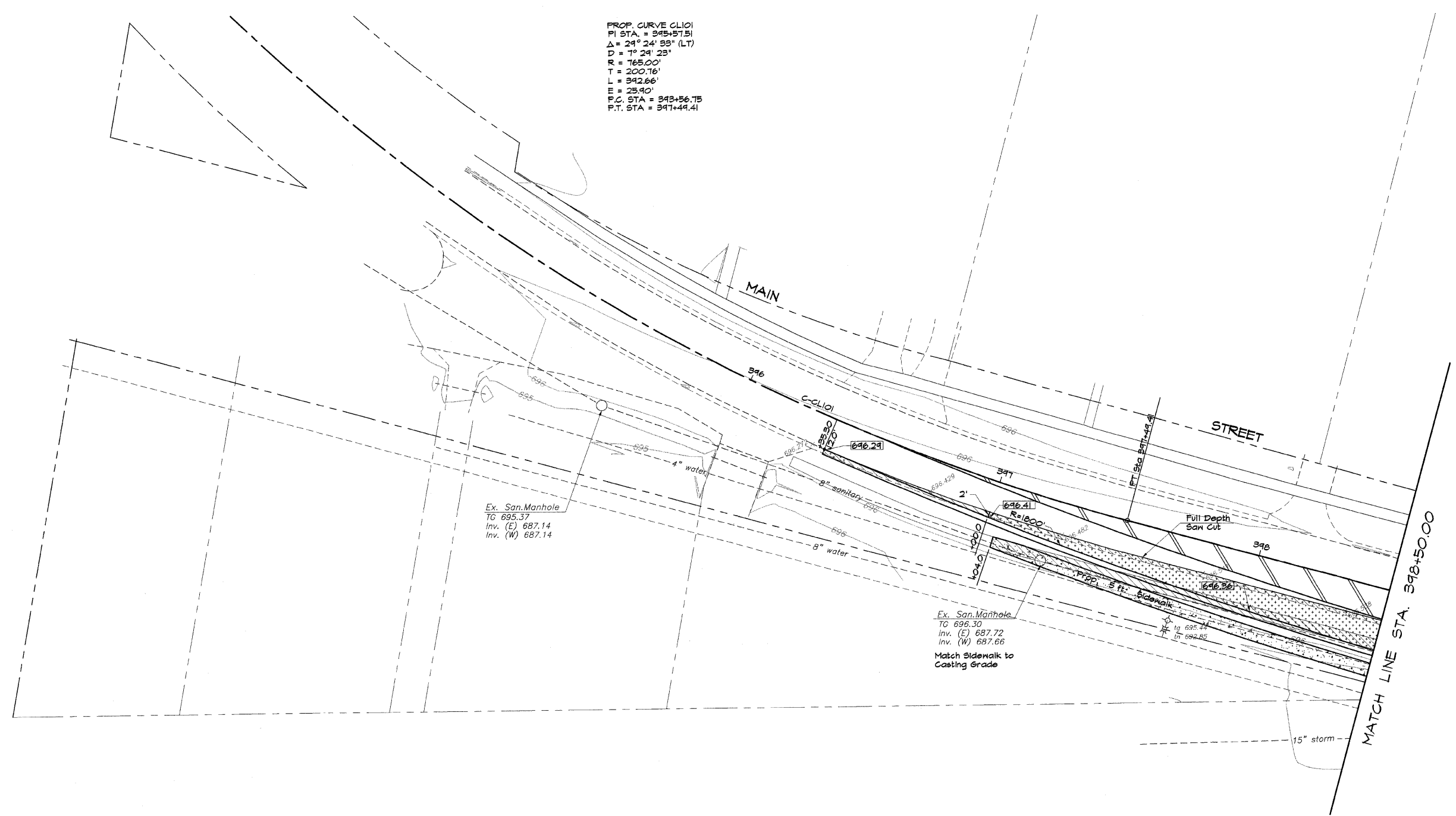

Ex. San. Manhole
 TG 695.37
 Inv. (E) 687.14
 Inv. (W) 687.14

Ex. San. Manhole
 TG 696.30
 Inv. (E) 687.72
 Inv. (W) 687.66
 Match Sidewalk to
 Casting Grade