

FOR INDEX OF SHEETS, SEE SHEET NO. 3

STATE OF ILLINOIS 11-06-2015 LETTING ITEM 062

F.A.P. RTE.	SECTION	COUNTY	TOTAL SHEETS	SHEET NO.
776	102RS-4	HAMILTON	34	1
		ILLINOIS	CONTRACT NO. 78478	

DEPARTMENT OF TRANSPORTATION

DIVISION OF HIGHWAYS

PROPOSED HIGHWAY PLANS

IL 242 ROUTE (FAP 776)  
SECTION 102RS-4  
PROJECT ACF-0776 (032)  
RESURFACE  
HAMILTON COUNTY

C-99-046-15

D-99-038-15

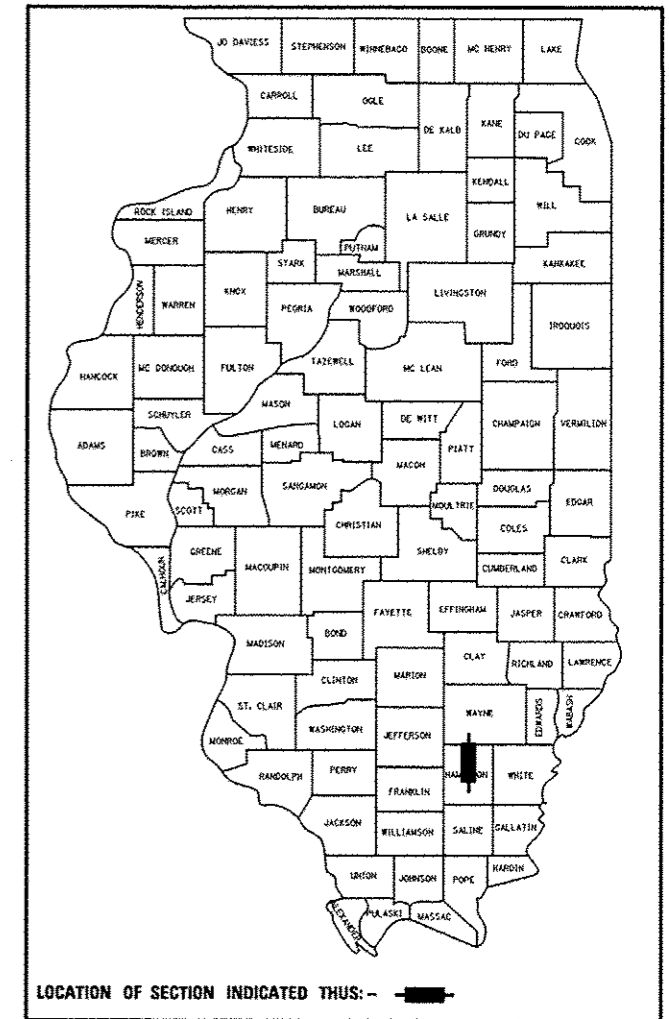

LOCATION OF SECTION INDICATED THIS: - [black rectangle] -

STATION EQUATIONS

- STA. 552+93.2 BK. = STA. 552+93.4 AH.
- STA. 569+71.1 BK. = STA. 569+71.5 AH.
- STA. 702+00.0 BK. = STA. 701+83.5 AH.
- STA. 722+07.12 BK. = STA. 722+23.62 AH.
- STA. 727+66.5 BK. = STA. 727+66.8 AH.
- STA. 944+48.2 BK. = STA. 944+59.4 AH.
- STA. 958+89.9 BK. = STA. 959+01.1 AH.
- STA. 974+25.5 BK. = STA. 105+47.7 AH.

BRIDGE OMISSIONS

- STA. 466+06.5 TO STA. 468+13.5
- STA. 469+78.08 TO STA. 471+73.92
- STA. 622+94.0 TO STA. 624+06.0
- STA. 685+78.7 TO STA. 686+81.4
- STA. 712+05.0 TO STA. 713+55.0
- STA. 737+90.8 TO STA. 739+88.8
- STA. 872+56.0 TO STA. 873+18.0

RR OMISSION

- STA. 974+15.5 TO STA. 974+25.5

TRAFFIC DATA

IL 242 (FAP 776) M.P.	LOC A:	LOC B:	LOC C:	LOC D:	LOC E:	LOC F:	LOC G:	LOC H:
	(0.00-1.00)	(1.00-2.52)	(2.52-7.01)	(7.01-8.03)	(8.03-9.98)	(9.98-10.88)	(10.88-11.03)	(11.03-11.19)
(2015)								
PV =	1,010	950	1,145	1,555	1,730	2,060	2,915	3,510
SU =	135	115	80	80	115	155	260	185
MU =	145	115	115	115	115	155	125	165
ADT =	1,290	1,180	1,340	1,750	1,950	2,370	3,300	3,860
(2036)								
PV =	1,230	1,170	1,390	1,900	2,110	2,510	3,555	4,285
SU =	165	140	100	100	140	190	315	225
MU =	175	140	140	140	140	190	150	200
ADT =	1,570	1,450	1,630	2,140	2,390	2,890	4,020	4,710

TOWNSHIPS

- CROUCH
- SOUTH CROUCH
- MC LEANSBORO

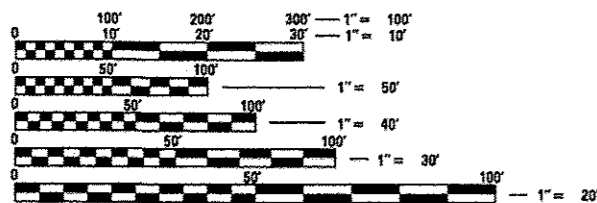

FULL SIZE PLANS HAVE BEEN PREPARED USING STANDARD ENGINEERING SCALES. REDUCED SIZED PLANS WILL NOT CONFORM TO STANDARD SCALES. IN MAKING MEASUREMENTS ON REDUCED PLANS, THE ABOVE SCALES MAY BE USED.

J.U.L.I.E.  
JOINT UTILITY LOCATION INFORMATION FOR EXCAVATION  
1-800-892-0123  
OR 811

PROJECT ENGINEER CHARLES STEIN - (618) 351-5210  
PROJECT MANAGER JOHN A. BRANDON - (618) 351-5291  
CONTRACT NO. 78478

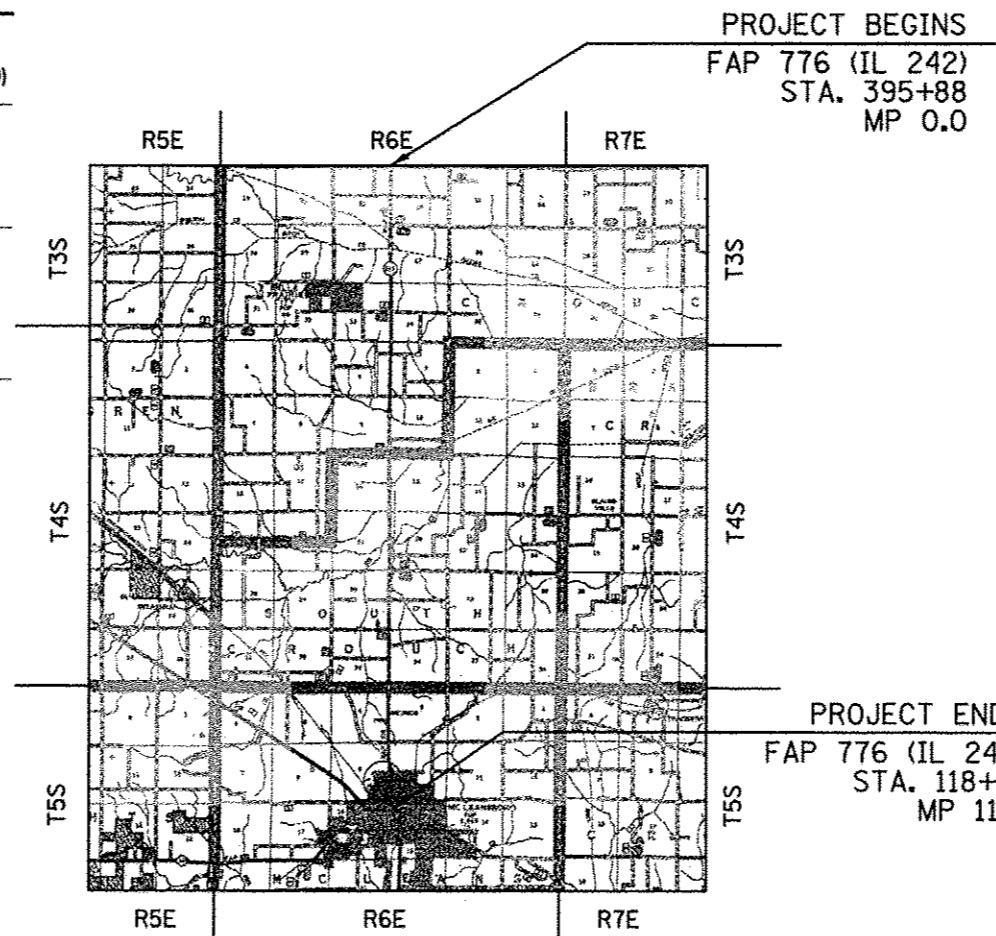

PROJECT BEGINS  
FAP 776 (IL 242)  
STA. 395+88  
MP 0.0



PROJECT ENDS  
FAP 776 (IL 242)  
STA. 118+15  
MP 11.2

GROSS LENGTH = 59,081.50 FT. = 11.190 MILE  
OMISSIONS = 1037.54 FT = 0.197 MILE  
NET LENGTH = 58,043.96 FT. = 10.993 MILE

STATE OF ILLINOIS  
DEPARTMENT OF TRANSPORTATION  
DIVISION OF HIGHWAYS

SUBMITTED August 12, 2015

*John A. Keiser*  
DEPUTY DIRECTOR OF HIGHWAYS, REGION ENGINEER

*John D. Baranzelli, P.E.*  
acting ENGINEER OF DESIGN AND ENVIRONMENT

*Amer Osman, P.E.*  
DIRECTOR OF HIGHWAYS, CHIEF ENGINEER

PRINTED BY THE AUTHORITY  
OF THE STATE OF ILLINOIS

Prepared By:

DISTRICT STUDIES & PLANS ENGINEER

Examined By:

DISTRICT LAND ACQUISITION ENGINEER

Examined By:

DISTRICT PROGRAM DEVELOPMENT ENGINEER

Examined By:

DISTRICT OPERATIONS ENGINEER

Examined By:

DISTRICT PROJECT IMPLEMENTATION ENGINEER

Examined By:

DISTRICT CONSTRUCTION ENGINEER

Examined By:

DISTRICT MATERIALS ENGINEER

FILE NAME =	USER NAME = brandonja	DESIGNED -	REVISED -
p:\11\084EBIDINTEG.illinois.gov\WIDOT\Documents\DOT Offices\District 9\Projects\78478	Documents\DOT Offices\District 9\Projects\78478	DRAWN by CAD sheets\78478-shl-cvr.sop	REVISED -
Default	PLOT SCALE = 100.0000 "/ in.	CHECKED -	REVISED -
	PLOT DATE = 8/13/2015	DATE -	REVISED -

STATE OF ILLINOIS  
DEPARTMENT OF TRANSPORTATION

SIGNATURE SHEET

SCALE: SHEET OF SHEETS STA. TO STA.

F.A.P. RTE.	SECTION	COUNTY	TOTAL SHEETS	SHEET NO.
776	102RS-4	HAMILTON	34	2
CONTRACT NO. 78478				
ILLINOIS FED. AID PROJECT				

## INDEX OF SHEETS

SHEET NO.	DESCRIPTION
1	COVER SHEET
2	SIGNATURE SHEET
3	INDEX OF SHEETS AND GENERAL NOTES
4	- CONT GENERAL NOTES, COMMITMENTS AND HIGHWAY STANDARDS
5	MIX DESIGN, MTD CROSSING RESTRICTIONS AND ADDITIONAL DEAD LOADS TABLE
6-9	SUMMARY OF QUANTITIES
10-11	TYPICAL SECTIONS
12-13	PAVEMENT AND SHOULDER SCHEDULE
14-15	ENTRANCE AND SIDEROAD SCHEDULE
16	GUARDRAIL AND CURB RAMPS SCHEDULE
17-18	PAVEMENT MARKING SCHEDULE
19	RPM'S SCHEDULE
20-29	IL 242 PAVEMENT STATIONS AND ALIGNMENT
30-35	DETAILS

## GENERAL NOTES

THE THICKNESS OF THE HOT-MIX ASPHALT MIXTURE SHOWN ON THE PLANS IS THE NOMINAL THICKNESS. DEVIATIONS FROM THE NOMINAL THICKNESS WILL BE PERMITTED WHEN SUCH DEVIATIONS OCCUR DUE TO IRREGULARITIES IN THE EXISTING SURFACE OR BASE ON WHICH THE HOT-MIX ASPHALT MIXTURE IS PLACED.

FACTORS USED FOR ESTIMATING PLAN QUANTITIES ARE AS FOLLOWS AND SHALL NOT BE USED FOR THE BASIS OF FINAL QUANTITIES.

ALL HOT-MIX ASPHALT	2.016 TON / CU YD
ALL AGGREGATE	2.05 TON / CU YD

UNLESS OTHERWISE DIRECTED BY THE ENGINEER, RESURFACING SHALL BE PLACED IN A SEQUENCE THAT WILL MINIMIZE THE TIME THE CENTERLINE EDGE IS EXPOSED TO TRAFFIC. WHEN AT THE END OF A DAY'S OPERATION THE EXPOSED CENTERLINE EDGE IS GREATER THAN 2,000 FT., THE CONTRACTOR SHALL BE REQUIRED TO PAVE IN THE ADJACENT LANE ON THE FOLLOWING WORK DAY. PRIOR TO WINTER SHUT DOWN, RESURFACING ON ADJACENT LANES IS TO BE BROUGHT UP TO THE SAME ELEVATION.

## - CONT GENERAL NOTES

THE QUANTITY OF SHORT TERM PAVEMENT MARKING SHOWN IN THE PLANS IS BASED ON ONE APPLICATION EACH FOR THE HMA SURFACE REMOVAL, SURFACE COURSE, AND BINDER COURSE.

QUANTITIES SHOWN IN THE PLANS FOR PATCHING ARE ESTIMATES. THE ACTUAL AMOUNT OF PATCHING REQUIRED SHALL BE DETERMINED BY THE ENGINEER.

CALCIUM CHLORIDE ACCELERATOR FOR PORTLAND CEMENT CONCRETE, CHECK SHEET 28 OF RECURRING SPECIAL PROVISIONS, SHALL ONLY BE USED DURING THE CLASS C PATCHING OPERATION.

THE CONTRACTOR SHALL COMPLETE ALL PATCHING PRIOR TO THE BITUMINOUS SURFACE REMOVAL.

THE CONTRACTOR SHALL STAMP STATIONING IN THE HOT-MIX ASPHALT SURFACE AT 300 FT. INTERVALS ALTERNATING SIDES ON THE OUTSIDE EDGE OF PAVEMENT AND AS DIRECTED BY THE ENGINEER. THE STATION SYMBOL STAMPS USED SHALL BE FURNISHED BY THE CONTRACTOR. THEY SHALL BE 5 1/2 IN. TALL OF A DESIGN APPROVED BY THE ENGINEER, AND SHALL REMAIN THE PROPERTY OF THE CONTRACTOR.

ATTAINMENT OF PROPER CROWN OR SUPERELEVATION SHALL BE FULLY ACCOMPLISHED WITH THE HOT-MIX ASPHALT SURFACE REMOVAL OR HOT-MIX ASPHALT BINDER COURSE, WHEN SPECIFIED.

RECLAIMED ASPHALT PAVEMENT (RAP) WILL NOT BE ALLOWED FOR USE AS AGGREGATE IN AGGREGATE SHOULDERS, TYPE B.

PRIOR TO PLACEMENT OF THE FINAL PAVEMENT MARKINGS THE RESIDENT ENGINEER SHOULD CONTACT THE BUREAU OF OPERATIONS AND ARRANGE FOR INSPECTION AND APPROVAL OF THE PAVEMENT MARKING LAYOUT.

IN ADDITION TO THE REQUIREMENTS OF ARTICLE 107.16 THE CONTRACTOR SHALL PROTECT THE SURFACE OF ALL BRIDGE DECKS AND BRIDGE APPROACH PAVEMENTS IN A MANNER SATISFACTORY TO THE ENGINEER BEFORE ANY EQUIPMENT IS ALLOWED TO CROSS THE STRUCTURE. PROTECTION SHALL BE PROVIDED FOR ALL EQUIPMENT AS DEFINED IN ARTICLE 101.17 REGARDLESS IF TRACK MOUNTED OR WHEELED.

THE LOCATION OF THE DETECTOR LOOPS, MAY BE ADJUSTED TO FIT FIELD CONDITIONS AS DIRECTED BY THE ENGINEER OF TRAFFIC OPERATIONS.

FILE NAME =	USER NAME = brendonjo	DESIGNED -	REVISED -	<b>STATE OF ILLINOIS DEPARTMENT OF TRANSPORTATION</b>	<b>INDEX OF SHEETS AND GENERAL NOTES</b>	F.A.P. RTE.	SECTION	COUNTY	TOTAL SHEETS	SHEET NO.	
p:\11\0846\BID\INTED.illinois.gov\PI\DOT\Docu\ments\DOT Offices\District 4\Projects\78478\Drawings\CAD\sheet\78478-sha-cvr-a001.dwg	DRAWN	CHECKED	REVISED			776	102RS-4	HAMILTON	35	3	
PLOT SCALE = 1/8" = 1'-0"	PLOT DATE = 8/19/2015	DATE	REVISED			CONTRACT NO. 78478					
SCALE: SHEET OF SHEETS STA. TO STA.						ILLINOIS FED. AID PROJECT					

- CONT GENERAL NOTES

DETECTOR LOOP WIRE SHALL BE PLACED IN THE EXISTING CONDUIT FROM THE LOOP SAWCUT TO THE SPLICE POINT AT THE EXISTING HANDHOLE.

ALL DETECTOR LOOPS SHALL BE PLACED PRIOR TO RESURFACING.

VIBRATORY ROLLERS WILL NOT BE ALLOWED IN THE CITY LIMITS OF MCLEANSBORO, IL.

COMMITMENTS

NONE

HIGHWAY STANDARDS

- 000001-06 Standard Symbols Abbreviations & Patterns
- 001001-02 Areas of Reinforcement Rebars
- 001006 Decimal of Inch & Foot
- 424001-08 Perpendicular Curb Ramps
- 424006-02 Diagonal Curb Ramps
- 424011-02 Corner Parallel Curb Ramps
- 424021-03 Depressed Corner
- 442201-03 Class C & D Patches
- 606001-06 Conc Curb Type B & Combo Conc C & G
- 630301-06 ShldWidenForType1GrdrailTerms
- 635006-03\_reflector&termmrkrplacemnt
- 701001-02 Off Rd Op - 2L2W - 15ft Min From EOP
- 701006-05 Off Rd Op - 2L2W - 15ft To EOP
- 701011-04 Off Rd Moving Op - 2L2W - Day Only
- 701301-04 Ln Closure 2L2W - Short Time Op
- 701306-03 Ln Closure 2L2W - Slow Move Op Day Only 45 MPH Or More
- 701311-03 Ln Closure 2L2W - Moving Op Day Only
- 701336-06 Ln Closure 2L2W - Work Areas In Series 45 MPH Or More
- 701801-05 Sidewalk Corner Or Crosswalk Closure
- 701901-04 Traf Cntrl Devices
- 780001-05 Typical Pvmt Mrkings
- 781001-03 Typical App Raised Reflc Pvmt Mrkrs
- 886001-01\_DetectorLoopInstallations
- 886006-01\_TypicalLayoutsForDetectionLoops

FILE NAME =	USER NAME = brandonje	DESIGNED -	REVISED -	<b>STATE OF ILLINOIS DEPARTMENT OF TRANSPORTATION</b>	<b>HIGHWAY STANDARDS</b>	F.A.P. RTE.	SECTION	COUNTY	TOTAL SHEETS	SHEET NO.	
pu:\IL094EBIDINTEG\illinois.gov\PMIDOT\O	Documents\DOT Offices\District 9\Projects\70478	DRAWN	REVISED			776	102RS-4	HAMILTON	35	4	
		CHECKED -	REVISED -			CONTRACT NO. 78478					
Default	PLOT DATE = 8/19/2013	DATE -	REVISED -			SCALE:	SHEET	OF	SHEETS	STA.	TO STA.

## MIX DESIGNS

Location(s):	HMA Surface Course, HMA Shoulders, and Incidental HMA Surf.
Mixture Use(s)	Hot-Mix Asphalt Surface Course, Mix C, N70
AC/PG	PG64-22
ABR % (Max):	See Special Provision
Design Air Voids:	4.0%, 70 Gyration Design
Mixture Composition: (Gradation Mixture)	IL-9.5 mm
Friction Aggregate:	C Surface
Quality Management Program:	OCP - Hot Mix Asphalt Surface Course OCPA - Incidental Hot - Mix Asphalt Surfacing

Location(s):	Pavement Patching
Mixture Use(s)	Hot-Mix Asphalt Binder Course, N70, IL-19.0mm
AC/PG	PG64-22
ABR % (Max):	See Special Provision
Design Air Voids:	4.0%, 90 Gyration Design
Mixture Composition: (Gradation Mixture)	IL-19.0 mm
Friction Aggregate:	None
Quality Management Program:	OCP/OA

Location(s):	Hot-Mix Asphalt Leveling Binder Course
Mixture Use(s)	Hot-Mix Asphalt Leveling Binder, N70, IL-9.5mm Fine Grade
AC/PG	PG64-22
ABR % (Max):	See Special Provision
Design Air Voids:	4.0%, 70 Gyration Design
Mixture Composition: (Gradation Mixture)	IL-9.5 mm Fine Grade
Friction Aggregate:	None
Quality Management Program:	OCP

### MTD CROSSING RESTRICTIONS TABLE

SN & CENTERLINE STATION IL 242 ROUTE (FAP 776)	EXISTING FILL HEIGHT OVER BOX CULVERT	THICKNESS OF EXISTING PAVEMENT OVER BOX CULVERT	MTD CROSSING RESTRICTIONS
	FOOT	FOOT	
SN 033-7022 (STA. 400+40)	1.5	1.13	PENDING
SN 033-0046 (STA. 467+10)			PENDING
SN 033-0053 (STA. 470+76)			PENDING
SN 033-7021 (STA. 594+60)	1.9	1.13	PENDING
SN 033-2007 (STA. 623+50)	0.0		PENDING
SN 033-7020 (STA. 629+18)	1.3	1.13	PENDING
SN 033-7019 (STA. 652+60)	2.7	1.13	PENDING
SN 033-2010 (STA. 659+12)	3.1	1.13	PENDING
SN 033-7018 (STA. 675+00)	1.8	1.13	PENDING
SN 033-2008 (STA. 686+30)	0.0		PENDING
SN 033-0054 (STA. 712+80)			PENDING
SN 033-0045 (STA. 738+90)			PENDING
SN 033-2000 (STA. 786+75)	1.9	1.13	PENDING
SN 033-0040 (STA. 872+87)	0.0		PENDING

### ADDITIONAL DEAD LOADS TABLE

SN & CENTERLINE STATION IL 242 ROUTE (FAP 776)	EXISTING FILL HEIGHT OVER BOX CULVERT	THICKNESS OF EXISTING PAVEMENT OVER BOX CULVERT	ADDITIONAL DEAD LOAD RESTRICTIONS
	FOOT	FOOT	
SN 033-7022 (STA. 400+40)	1.5	1.13	PENDING
SN 033-7021 (STA. 594+60)	1.9	1.13	PENDING
SN 033-7020 (STA. 629+18)	1.3	1.13	PENDING
SN 033-7019 (STA. 652+60)	2.7	1.13	PENDING
SN 033-2010 (STA. 659+12)	3.1	1.13	PENDING
SN 033-7018 (STA. 675+00)	1.8	1.13	PENDING
SN 033-2000 (STA. 786+75)	1.9	1.13	PENDING
SN 033-0040 (STA. 872+87)	0.0		PENDING

# SUMMARY OF QUANTITIES

CODE NUMBER	ITEM DESCRIPTION	UNIT	TOTAL QUANTITY	COUNTY:	HAMILTON	HAMILTON	HAMILTON
				ROUTE:	FAP 776 (IL 242)	FAP 776 (IL 242)	FAP 776 (IL 242)
				FUNDING:	80% FEDERAL 20% STATE	80% FEDERAL 20% STATE	80% FEDERAL 20% CITY
				LOCATION:	RURAL ROADWAY 0005	RURAL ROADWAY 0005	CITY ROADWAY 0005
20101400	NITROGEN FERTILIZER NUTRIENT	POUND	27			27	
20101500	PHOSPHORUS FERTILIZER NUTRIENT	POUND	27			27	
20101600	POTASSIUM FERTILIZER NUTRIENT	POUND	27			27	
25000200	SEEDING, CLASS 2	ACRE	0.3			0.3	
25000350	SEEDING, CLASS 7	ACRE	0.3			0.3	
25000700	AGRICULTURAL GROUND LIMESTONE	TON	0.6			0.6	
25100115	MULCH, METHOD 2	ACRE	0.3			0.3	
28000250	TEMPORARY EROSION CONTROL SEEDING	POUND	30			30	
40600275	BITUMINOUS MATERIALS (PRIME COAT)	POUND	115,379		107,918	6,447	1,014
40600637	LEVELING BINDER (MACHINE METHOD), IL-9.5FC, N70	TON	6,909		6,623	286	
40600982	HOT-MIX ASPHALT SURFACE REMOVAL - BUTT JOINT	SQ YD	584		584		
40600990	TEMPORARY RAMP	SQ YD	321		262	41	18
40603315	HOT-MIX ASPHALT SURFACE COURSE, MIX "C", N70	TON	14,265		13,216	574	475
40800050	INCIDENTAL HOT-MIX ASPHALT SURFACING	TON	475		370	105	

# SUMMARY OF QUANTITIES - CONT

CODE NUMBER	ITEM DESCRIPTION	UNIT	TOTAL QUANTITY	COUNTY:	HAMILTON	HAMILTON	HAMILTON
				ROUTE:	FAP 776 (IL 242)	FAP 776 (IL 242)	FAP 776 (IL 242)
				FUNDING:	80% FEDERAL 20% STATE	80% FEDERAL 20% STATE	80% FEDERAL 20% CITY
				LOCATION:	RURAL	RURAL	CITY
					ROADWAY	ROADWAY	ROADWAY
					0005	0005	0005
42001300	PROTECTIVE COAT	SO YD	28			28	
42400100	PORTLAND CEMENT CONCRETE SIDEWALK 4 INCH	SO FT	549			549	
42400800	DETECTABLE WARNINGS	SO FT	96			96	
44000155	HOT-MIX ASPHALT SURFACE REMOVAL, 1 1/2"	SO YD	163,034		150,600	10,181	2,253
44000158	HOT-MIX ASPHALT SURFACE REMOVAL, 2 1/4"	SO YD	7,669		7,669		
44000500	COMBINATION CURB AND GUTTER REMOVAL	FOOT	55			55	
44000600	SIDEWALK REMOVAL	SO FT	560			560	
44200168	PAVEMENT PATCHING, TYPE II, 14 INCH	SO YD	1,789		1,585	204	
44200172	PAVEMENT PATCHING, TYPE III, 14 INCH	SO YD	35		35		
44200174	PAVEMENT PATCHING, TYPE IV, 14 INCH	SO YD	27			27	
44300200	STRIP REFLECTIVE CRACK CONTROL TREATMENT	FOOT	116,088		108,845	7,243	
48102100	AGGREGATE WEDGE SHOULDER, TYPE B	TON	1,614		1,547	67	
48203100	HOT-MIX ASPHALT SHOULDERS	TON	213		213		
60600605	CONCRETE CURB, TYPE B	FOOT	104			104	

# SUMMARY OF QUANTITIES - CONT

COUNTY:	HAMILTON	HAMILTON	HAMILTON
ROUTE:	FAP 776 (IL 242)	FAP 776 (IL 242)	FAP 776 (IL 242)
FUNDING:	80% FEDERAL 20% STATE	80% FEDERAL 20% STATE	80% FEDERAL 20% CITY
LOCATION:	RURAL	RURAL	CITY
TOTAL QUANTITY	ROADWAY 0005	ROADWAY 0005	ROADWAY 0005

CODE NUMBER	ITEM DESCRIPTION	UNIT	TOTAL QUANTITY	HAMILTON ROADWAY 0005	HAMILTON ROADWAY 0005	HAMILTON ROADWAY 0005
60605000	COMBINATION CONCRETE CURB AND CUTTER, TYPE B-6. 24	FOOT	55		55	
* 63000370	LONG-SPAN GUARDRAIL OVER CULVERT, 25 FT SPAN	FOOT	50	50		
* 63100167	TRAFFIC BARRIER TERMINAL, TYPE 1 (SPECIAL) TANGENT	EACH	4	4		
* 63200310	GUARDRAIL REMOVAL	FOOT	200	200		
67000500	ENGINEER'S FIELD OFFICE, TYPE B	CAL MO	10	10		
67100100	MOBILIZATION	L SUM	1	1		
70100460	TRAFFIC CONTROL AND PROTECTION, STANDARD 701306	L SUM	1	0.5	0.5	
70100600	TRAFFIC CONTROL AND PROTECTION, STANDARD 701336	L SUM	1	0.5	0.5	
70106800	CHANGEABLE MESSAGE SIGN	CAL MO	2	1	1	
70300100	SHORT TERM PAVEMENT MARKING	FOOT	17,595	16,635	960	
70300210	TEMPORARY PAVEMENT MARKING LETTERS AND SYMBOLS	SQ FT	132		123	9
70300220	TEMPORARY PAVEMENT MARKING - LINE 4"	FOOT	153,670	145,495	8,175	
70300280	TEMPORARY PAVEMENT MARKING - LINE 24"	FOOT	92		92	
70301000	WORK ZONE PAVEMENT MARKING REMOVAL	SQ FT	57,404	54,043	3,361	

FILE NAME:	USER NAME: brandonja	DESIGNED: -	REVISED: -	<b>STATE OF ILLINOIS DEPARTMENT OF TRANSPORTATION</b>	<b>SUMMARY OF QUANTITIES</b>	F.A.P. RTE: 776	SECTION: 102RS-4	COUNTY: HAMILTON	TOTAL SHEETS: 35	SHEET NO.: 8
PLOT SCALE: 1/8" = 1' / in. PLOT DATE: 8/14/2018								CONTRACT NO. 78478		
				SCALE: SHEET OF SHEETS STA. TO STA.		ILLINOIS FED. AID PROJECT				

\* SPECIALTY ITEM



# SUMMARY OF QUANTITIES - CONT

CODE NUMBER	ITEM DESCRIPTION	UNIT	TOTAL QUANTITY	COUNTY:	HAMILTON	HAMILTON	HAMILTON
				ROUTE:	FAP 776 (IL 242)	FAP 776 (IL 242)	FAP 776 (IL 242)
				FUNDING:	80% FEDERAL 20% STATE	80% FEDERAL 20% STATE	80% FEDERAL 20% CITY
				LOCATION:	RURAL ROADWAY	RURAL ROADWAY	CITY ROADWAY
				0005	0005	0005	
* 78001100	PAINT PAVEMENT MARKING - LETTERS AND SYMBOLS	SO FT	132			123	9
* 78001110	PAINT PAVEMENT MARKING - LINE 4"	FOOT	153,670		145,495	8,175	
* 78001180	PAINT PAVEMENT MARKING - LINE 24"	FOOT	92			92	
* 78100100	RAISED REFLECTIVE PAVEMENT MARKER	EACH	726		681	45	
* 78200410	GUARDRAIL MARKERS, TYPE A	EACH	8		8		
* 78201000	TERMINAL MARKER - DIRECT APPLIED	EACH	4		4		
78300200	RAISED REFLECTIVE PAVEMENT MARKER REMOVAL	EACH	726		681	45	
* 88600100	DETECTOR LOOP, TYPE I	FOOT	145			145	
<input type="checkbox"/> X2503100	MOWING	UNIT	580		558	22	
Z0034105	MATERIAL TRANSFER DEVICE	TON	21,174		19,364	1,335	475
<input type="checkbox"/> Z0076600	TRAINEES	HR	500		500		
Z0048665	RAILROAD PROTECTIVE LIABILITY INSURANCE	LSUM	1			1	
<input type="checkbox"/> Z0076604	TRAINEES TRAINING PROGRAM GRADUATE	HR	500		500		

\* SPECIALTY ITEM  
 NON-PART. (100% STATE)

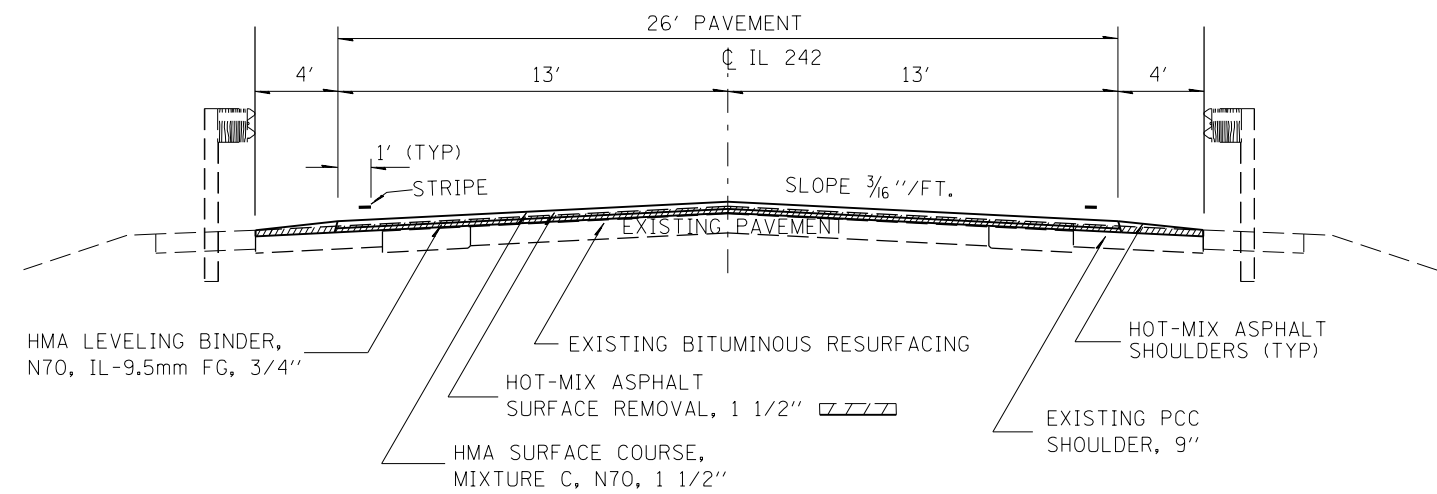
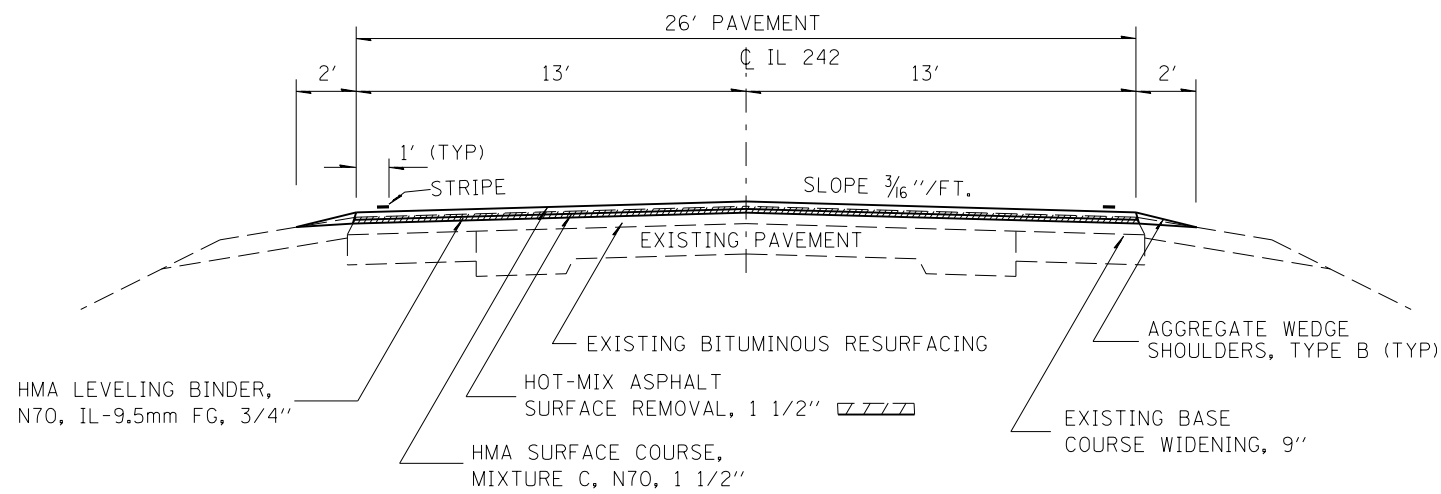

STA. 395+88 TO STA. 465+12  
 STA. 474+18 TO STA. 621+65  
 STA. 625+40 TO STA. 656+27  
 STA. 662+30.52 TO STA. 684+40  
 STA. 688+10 TO STA. 709+17.38  
 STA. 715+89.63 TO STA. 736+90  
 STA. 741+00 TO STA. 840+47  
 STA. 868+93 TO STA. 871+02  
 STA. 874+72 TO STA. 974+15.5

STA. 656+27 TO STA. 662+30.52

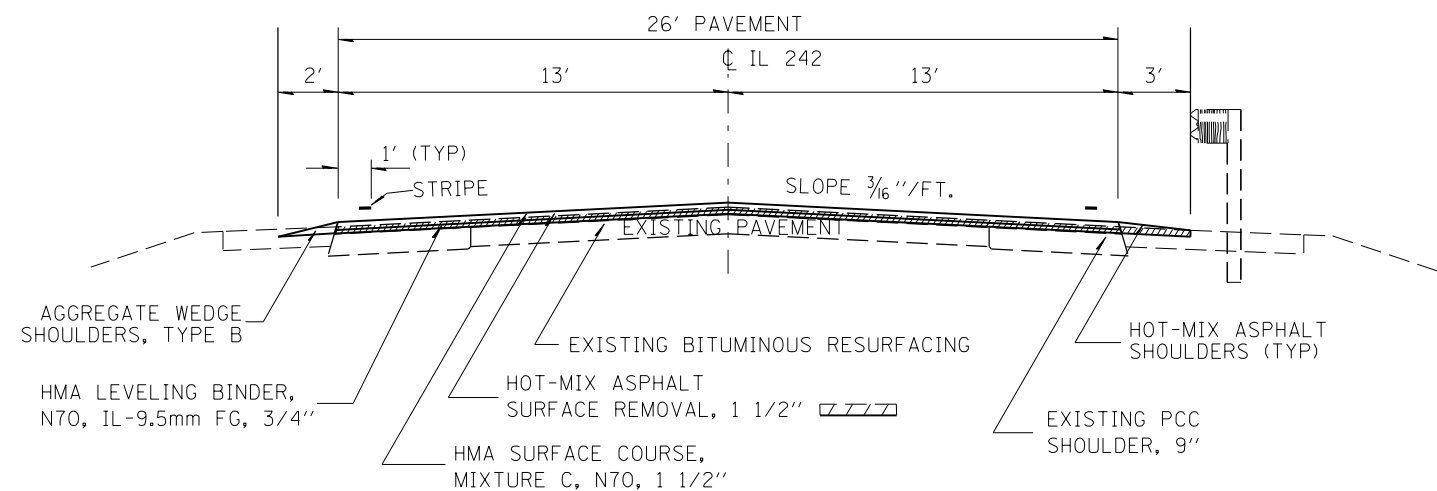
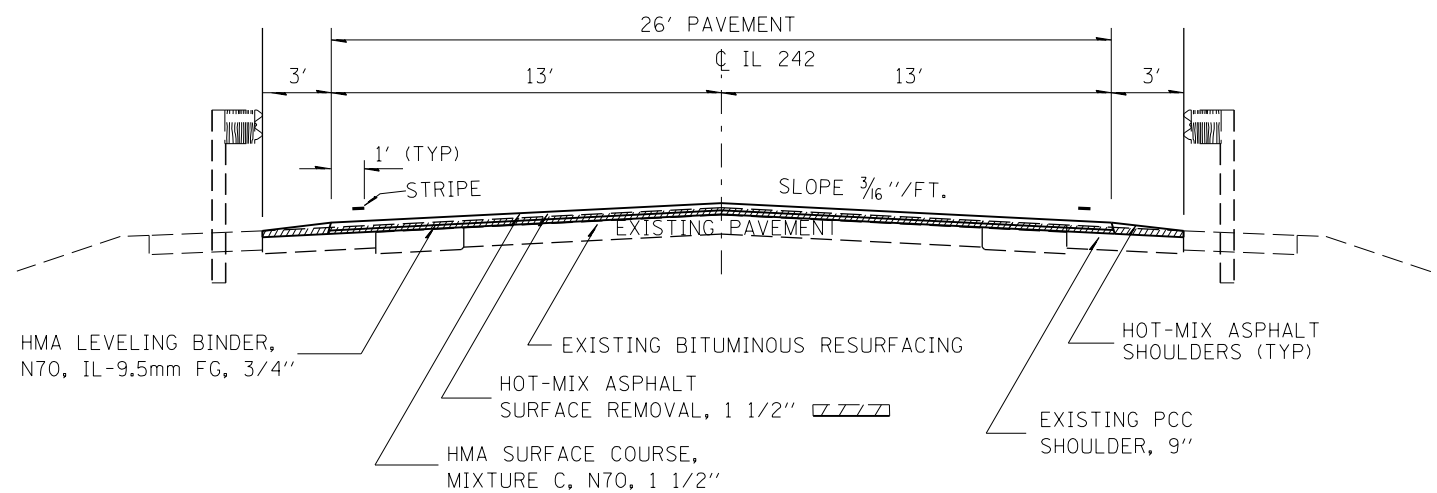

STA. 465+12 TO STA. 466+06.5  
 STA. 468+13.5 TO STA. 469+78.08  
 STA. 471+73.92 TO STA. 473+13.1  
 STA. 473+13.1 LT TO STA. 474+18 LT  
 STA. 621+65 RT TO STA. 621+85 RT  
 STA. 621+85 TO STA. 622+94  
 STA. 624+06 TO STA. 625+30  
 STA. 625+30 LT TO STA. 625+40 LT  
 STA. 684+40 RT TO STA. 684+70 RT  
 STA. 684+70 TO STA. 685+78.7  
 STA. 686+81.4 TO STA. 688+00  
 STA. 688+00 LT TO STA. 688+10 LT  
 STA. 736+90 TO STA. 737+90.8  
 STA. 739+88.8 LT TO STA. 741+00

STA. 709+17.38 RT TO STA. 710+94 RT  
 STA. 715+02.13 LT TO STA. 715+89.63 LT

FILE NAME =	USER NAME = brandonja	DESIGNED -	REVISED -
pw:\IL\084EBIDINTEG\illinois.gov\PIWIDOT\Documents\IDOT Offices\District 9\Projects\78478\Drawings\CAD\Drawings\78478-sha-cvr-seq.dwg		DRAWN -	REVISED -
Default	PLOT SCALE = 100.0000' / in.	CHECKED -	REVISED -
	PLOT DATE = 8/19/2015	DATE -	REVISED -

STATE OF ILLINOIS  
DEPARTMENT OF TRANSPORTATION

TYPICAL SECTIONS

SCALE: SHEET OF SHEETS STA. TO STA.

F.A.P. RTE.	SECTION	COUNTY	TOTAL SHEETS	SHEET NO.
776	102R5-4	HAMILTON	35	10
CONTRACT NO. 78478				
ILLINOIS FED. AID PROJECT				

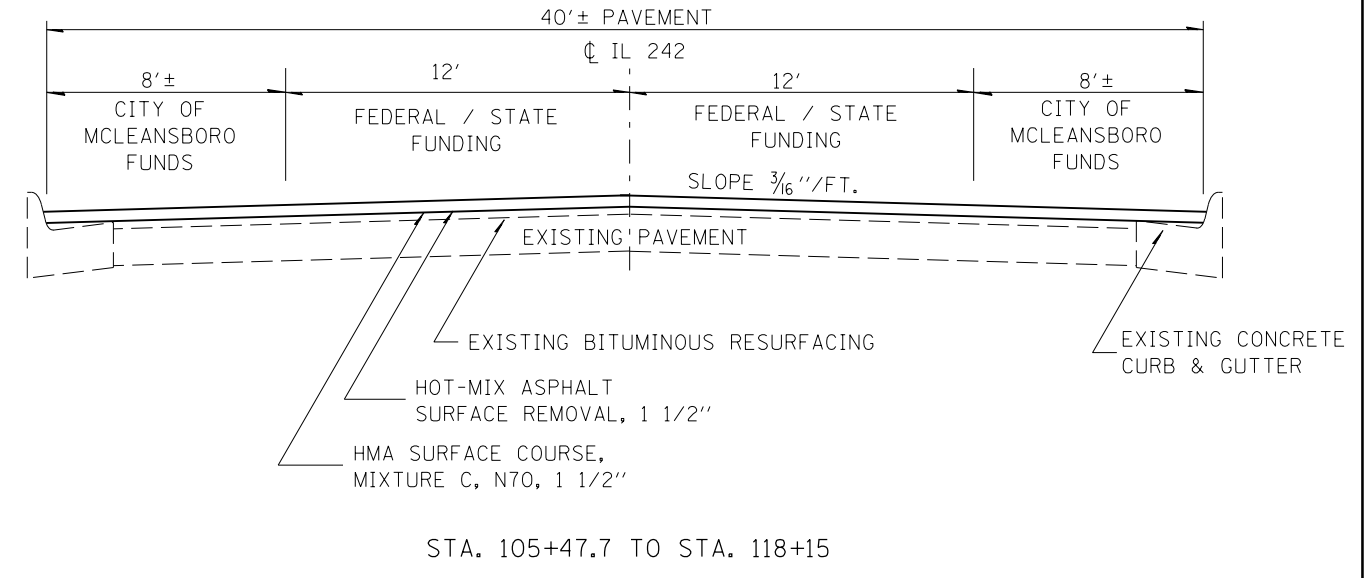
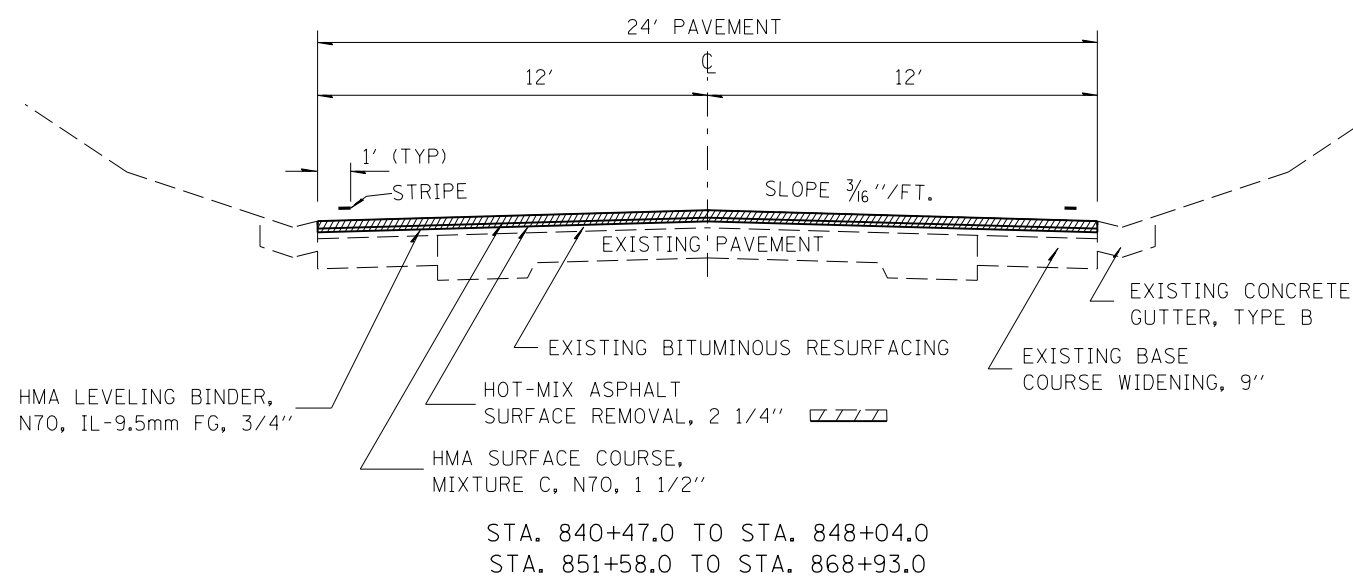
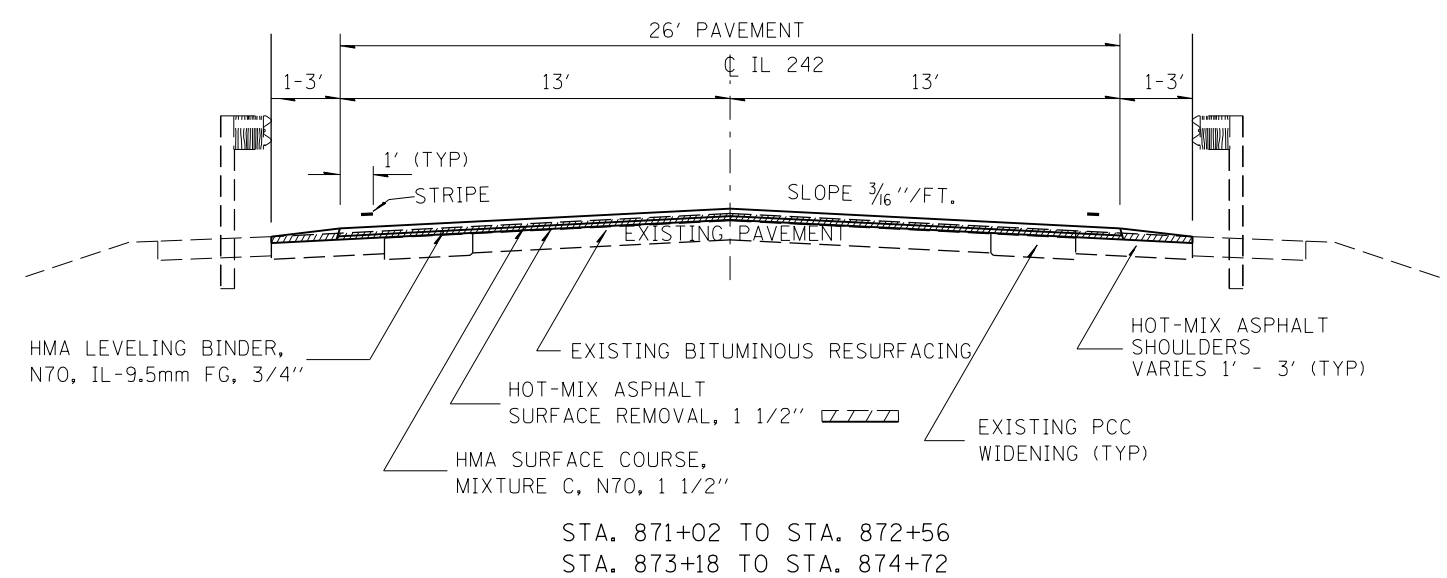
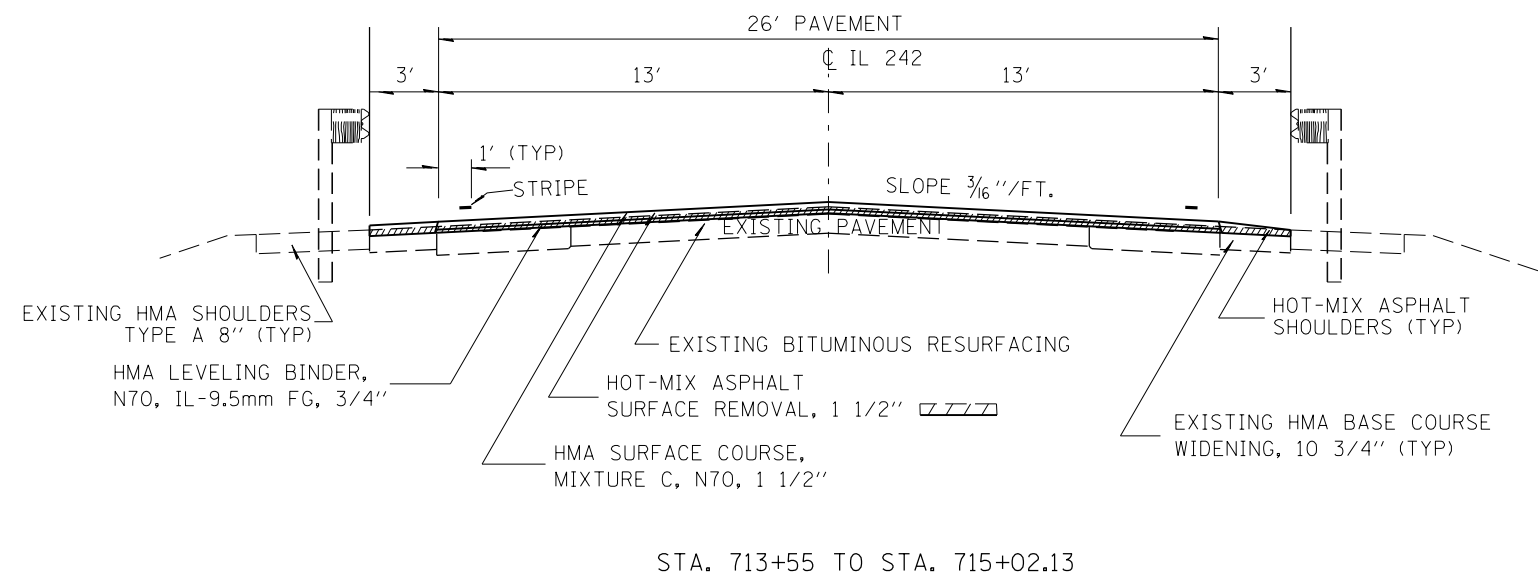
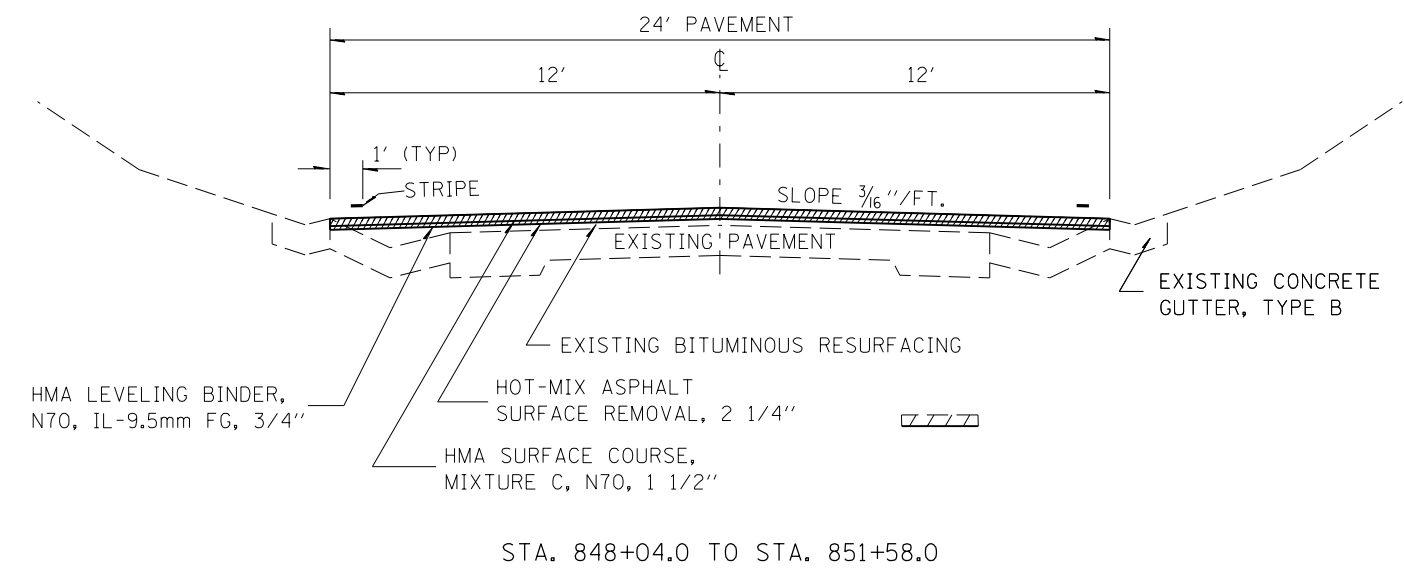
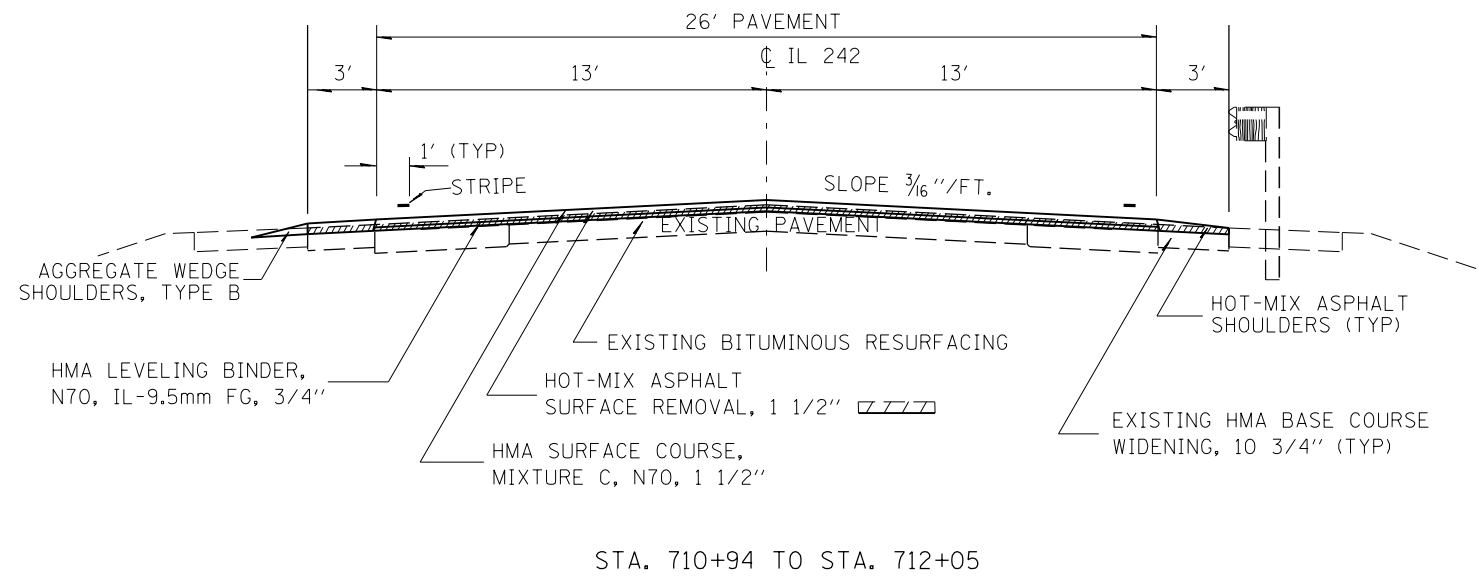

FILE NAME =	USER NAME = brandonja	DESIGNED -	REVISED -
pw:\IL\084EBIDINTEG\illinois.gov\PWIDOT\Documents\DOT Offices\District 9\Projects\78478\Drawings\CAD\Drawings\78478-sha-cvr_seq.dwg		CHECKED -	REVISED -
Default	PLOT DATE = 8/19/2015	DATE -	REVISED -

**STATE OF ILLINOIS  
 DEPARTMENT OF TRANSPORTATION**

<b>TYPICAL SECTION</b>			
SCALE:	SHEET	OF SHEETS	STA. TO STA.

F.A.P. RTE.	SECTION	COUNTY	TOTAL SHEETS	SHEET NO.
776	102R5-4	HAMILTON	35	11
CONTRACT NO. 78478				
ILLINOIS FED. AID PROJECT				

## PAVEMENT AND SHOULDER SCHEDULE

LOCATION	LENGTH	WIDTH	AREA	HMA SURFACE REMOVAL	HMA SURFACE REMOVAL	HMA SURF CSE	HMA LEVELING BINDER, N70, IL-9.5MM FG	BIT MAT PRIME COAT	HMA SHLDRS	AGG. SHLDRS TY B	STRIP REFLECTIVE CRACK CONTROL	TEMPORARY RAMP
				1 1/2"	2 1/4"	MIX "C", N70 1 1/2"	3/4"	POUND	TON	TON	TON	FOOT
FOOT	FOOT	SQ FT	SQ YD			TON	TON		TON	TON	FOOT	SQ YD
<b>IL 242</b>												
395+88. TO 466+06.5	7018.5	26	182481.0	20275.7		1711.3	854.1	13686.1		199.8	14037.0	14.4
465+12. TO 466+06.5		6	567.0	63.0				28.4	7.9			17.8
<b>SN 033-0046 - OMISSION</b>												
468+13.5 TO 469+78.08		6	987.6	109.7				49.4	13.8			17.8
468+13.5 TO 469+78.08	164.6	26	4279.1	475.5		40.1	16.4	320.9		4.7	329.2	17.8
<b>SN 033-0053 - OMISSION</b>												
471+73.92 TO 473+13.1		6	835.2	92.8				41.8	11.7			17.8
473+13.1 LT TO 474+18.00 LT		3	314.7	35.0				15.7	4.4			
471+73.92 TO 552+93.2	8119.3	26	211101.3	23455.7		1979.8	990.4	15832.6		231.2	16238.6	
552+93.2 BK = 552+93.4 AH										0.0		
552+93.4 TO 569+71.1	1677.7	26	43620.2	4846.7		409.1	205.0	3271.5		47.8	3355.4	
569+71.1 BK = 569+71.5 AH												
569+71.5 TO 622+94.	5322.5	26	138385.0	15376.1		1297.8	648.6	10378.9		151.5	10645.0	
621+65 RT TO 621+85 RT		3	60.0	6.7				3.0	0.8			
621+85. TO 622+94.		6	654.0	72.7				32.7	9.2			17.8
<b>SN 033-2007 - OMISSION</b>												
624+06. TO 625+30.		6	744.0	82.7				37.2	10.4			17.8
625+30 LT TO 625+40 LT		3	30.0	3.3				1.5	0.4			
624+06. TO 658+70.	3464.0	26	90064.0	10007.1		844.6	421.5	6754.8		98.6	6928.0	
656+27. TO 658+70.		8	1944.0	216.0				97.2	27.2			
658+70. TO 659+53.48	83.5	34	2838.3	315.4		20.4	10.2	196.2	9.3		167.0	
659+53.48 TO 662+30.52		8	2216.3	246.3				110.8	31.0			
659+53.48 TO 685+78.7	2625.2	26	68255.7	7584.0		640.1	319.0	5119.2		74.7	5250.4	
684+40 RT TO 684+70 RT		3	90.0	10.0				4.5	1.3			
684+70. TO 685+78.7		6	652.2	72.5				32.6	9.1			17.8
<b>SN 033-2008 - OMISSION</b>												
686+81.4 TO 688+00.		6	711.6	79.1				35.6	10.0			17.8
688+00 LT TO 688+10 LT		3	30.0	3.3				1.5	0.4			
686+81.4 TO 702+00.	1518.6	26	39483.6	4387.1		370.3	183.8	2961.3		43.2	3037.2	
702+00 BK = 701+83.5 AH												
701+83.5 TO 712+05.	1021.5	26	26559.0	2951.0		249.1	123.0	1991.9		29.1	2043.0	
709+17.38 RT TO 710+94 RT		3	529.9	58.9				26.5	7.4			
710+94. TO 712+05.		6	666.0	74.0				33.3	9.3			17.8
<b>SN 033-0054 - OMISSION</b>												
<b>TOTAL</b>	31015.4			90900.0	0.0	7562.6	3772.0	61065.0	163.8	880.7	62030.7	174.4

- CONT. PAVEMENT AND SHOULDER SCHEDULE

LOCATION	LENGTH	WIDTH	AREA	HMA SURFACE REMOVAL 1 1/2"	HMA SURFACE REMOVAL 2 1/4"	HMA SURF CSE MIX "C", N70 1 1/2"	HMA LEVELING BINDER, N70, IL-9.5MM FG 3/4"	BIT MAT PRIME COAT	HMA SHLDRS	AGG. SHLDRS TY B	STRIP REFLECTIVE CRACK CONTROL	TEMPORARY RAMP
	FOOT	FOOT	SQ FT	SQ YD		TON	TON	POUND	TON	TON	FOOT	SQ YD
<b>IL 242</b>												
713+55. TO 714+65.		6	660.0	73.3				33.0	9.2			17.8
714+65. TO 715+02.13		6	222.6	24.7				11.1	3.1			
715+02.13 LT TO 715+89.63 LT		3	262.5	29.2				13.1	3.7			
713+55. TO 722+07.12	852.1	26	22155.1	2461.7		207.8	102.3	1661.6		24.3	1704.2	
722+07.12 BK = 722+23.62 AH												
722+23.62 TO 727+66.5	542.9	26	14114.9	1568.3		132.4	66.3	1058.6		15.5	1085.8	
727+66.5 BK = 727+66.8 AH												
727+66.8 TO 737+90.8	1024.0	26	26624.0	2958.2		249.7	123.3	1996.8		29.2	2048.0	
736+90. TO 737+90.8		6	604.8	67.2				30.2	8.5			17.8
<b>SN 033-0045 - OMISSION</b>												
739+88.8 TO 741+00.		6	667.2	74.1				33.4	9.3			17.8
739+88.8 TO 840+32.	10043.2	26	261123.2	29013.7		2448.9	1225.5	19584.2		286.0	20086.4	
840+32. TO 869+08.	2876.0	24	69024.0		7669.3	647.6	351.5	5176.8		81.9	5752.0	
869+08. TO 872+56.	348.0	26	9048.0	1005.3		84.9	40.7	678.6		9.9	696.0	
871+02. TO 872+56.		3.5	539.0	59.9				27.0	7.5			17.2
<b>SN 033-0040 - OMISSION</b>												
873+18. TO 874+72.		3.5	539.0	59.9				27.0	7.5			17.2
873+18. TO 944+48.2	7130.2	26	185385.2	20598.4		1738.6	869.5	13903.9		203.0	14260.4	
944+48.2 BK = 944+59.4 AH												
944+59.4 TO 958+89.9	1430.5	26	37193.0	4132.6		348.8	174.8	2789.5		40.7	2861.0	
958+89.9 BK = 959+01.1 AH												
959+01.1 TO 974+15.5	1514.4	26	39374.4	4374.9		369.3	183.2	2953.1		43.1	3028.8	14.4
<b>RR - OMISSION</b>												
974+25.5 BK = 105+47.7 AH												22.2
105+47.7 TO 118+15.	1267.3	40	50692.0	5632.4		474.6		2534.6			2534.6	22.2
<b>TOTAL</b>	27028.6			72133.9	7669.3	6702.4	3137.2	52512.5	48.9	733.5	54057.2	146.7
<b>PROJECT TOTALS</b>	58044			163034	7669	14265	6909	113578	213	1614	116088	321

**ENTRANCE SCHEDULE**

LOCATION: FAP 14 ( IL 242)	ENTRANCE TYPE	EXIST. SURFACE	EOP WIDTH	WIDTH AT 4' OFFSET	ROADWAY AREA	INCIDENTAL HMA SURFACING	BIT. MAT. (PRIME COAT)
		FOR INFORMATIONAL PURPOSE ONLY					
		TYPE	(FT)	(FT)	(SQ YD)	(TON)	(POUND)
<b>ENTRANCES</b>							
395+88 LT	FIELD ENT.	DIRT			***		
397+03 RT	PRIVATE ENT.	CONC.	63	51	25.3	0.9	***
399+50 RT	COMMERCIAL ENT.	CONC.	95	61	34.7	1.2	15.6
409+60 RT	PRIVATE ENT.	AGG.	90	27	26.0	2.2	11.7
413+58 LT	PRIVATE ENT.	AGG.	33	19	11.6	1.0	5.2
423+65 RT	PRIVATE ENT.	AGG.	34	18	11.6	1.0	5.2
424+18 RT	PRIVATE ENT.	AGG.	32	19	11.3	1.0	5.1
441+91 LT	COMMERCIAL ENT.	CONC.	90	62	33.8	1.2	15.2
440+00 LT	COMMERCIAL ENT.	OIL & CHIP	90	62	33.8	1.2	15.2
449+08 RT	FIELD ENT.	AGG.			***		
480+82 RT	FIELD ENT.	DIRT			***		
491+47 LT	FIELD ENT.	DIRT			***		
491+52 RT	PRIVATE ENT.	AGG.	56	44	22.2	1.9	10.0
500+17 LT	PRIVATE ENT.	HMA	40	29	15.3	0.5	6.9
506+76 RT	PRIVATE ENT.	AGG.	58	30	19.6	1.6	8.8
515+61 RT	FIELD ENT.	DIRT			***		
520+16 LT	PRIVATE ENT.	AGG.	90	80	37.8	3.2	17.0
521+76 LT	PRIVATE ENT.	AGG.	40	30	15.6	1.3	7.0
526+82 LT	COMMERCIAL ENT.	AGG.	120	102	49.3	4.1	22.2
529+20 RT	PRIVATE ENT.	HMA	64	33	21.6	0.8	9.7
529+60 LT	PRIVATE ENT.	AGG.	120	90	46.7	3.9	21.0
531+05 LT	PRIVATE ENT.	AGG.	40	30	15.6	1.3	7.0
542+67 LT	PRIVATE ENT.	AGG.	40	30	15.6	1.3	7.0
555+43 RT	FIELD ENT.	DIRT			***		
555+48 LT	FIELD ENT.	DIRT			***		
556+39 RT	PRIVATE ENT.	AGG.	35	25	13.3	1.1	6.0
565+47 LT	COMMERCIAL ENT.	AGG.	56	50	23.6	2.0	10.6
579+12 LT	FIELD ENT.	DIRT			***		
592+72 LT	FIELD ENT.	DIRT			***		
608+90 LT	FIELD ENT.	DIRT			***		
610+68 RT	FIELD ENT.	DIRT			***		
612+00 RT	COMMERCIAL ENT.	CONC.	120	120	53.3	1.9	24.0
612+00 LT	COMMERCIAL ENT.	CONC.	120	120	53.3	1.9	24.0
619+19 LT	PRIVATE ENT.	AGG.	36	20	12.4	1.0	5.6
619+47 RT	FIELD ENT.	AGG.			***		
620+77 LT	FIELD ENT.	AGG.			***		
632+50 RT	FIELD ENT.	DIRT			***		
641+19 RT	PRIVATE ENT.	AGG.	38	22	13.3	1.1	6.0
641+24 LT	FIELD ENT.	AGG.			***		
642+98 RT	FIELD ENT.	HMA	44	40	18.7	0.7	8.4
643+94 RT	FIELD ENT.	HMA	38	33	15.8	0.6	7.1
648+05 RT	COMMERCIAL ENT.	HMA	54	32	19.1	0.7	8.6
648+72 LT	PRIVATE ENT.	HMA	54	43	21.6	0.8	9.7
649+57 RT	COMMERCIAL ENT.	HMA	44	30	16.4	0.6	7.4
657+33 RT	FIELD ENT.	AGG.			***		
659+47 LT	FIELD ENT.	DIRT			***		
672+73 LT	FIELD ENT.	DIRT			***		
678+59 RT	FIELD ENT.	DIRT			***		
697+47 LT	FIELD ENT.	AGG.			***		
698+24 RT	FIELD ENT.	AGG.			***		
717+52 LT	FIELD ENT.	AGG.			***		
728+77 RT	FIELD ENT.	DIRT			***		
737+39 RT	FIELD ENT.	HMA	44	40	18.7	0.7	8.4
752+54 RT	FIELD ENT.	DIRT			***		
<b>TOTAL</b>						41	316

**- CONT. ENTRANCE SCHEDULE**

LOCATION: FAP 14 ( IL 242)	ENTRANCE TYPE	EXIST. SURFACE	EOP WIDTH	WIDTH AT 4' OFFSET	ROADWAY AREA	INCIDENTAL HMA SURFACING	BIT. MAT. (PRIME COAT)
		FOR INFORMATIONAL PURPOSE ONLY					
		TYPE	(FT)	(FT)	(SQ YD)	(TON)	(POUND)
752+98 RT	FIELD ENT.	DIRT			***		
759+30 RT	FIELD ENT.	DIRT			***		
779+32 RT	FIELD ENT.	DIRT			***		
786+48 RT	FIELD ENT.	DIRT			***		
790+30 LT	PRIVATE ENT.	AGG	30	18	10.7	0.9	4.8
795+61 RT	PRIVATE ENT.	AGG	30	20	11.1	0.9	5.0
804+20 RT	PRIVATE ENT.	AGG	40	25	14.4	1.2	6.5
806+09 RT	PRIVATE ENT.	AGG	50	40	20.0	1.7	9.0
808+69 LT	PRIVATE ENT.	AGG	35	30	14.4	1.2	6.5
810+00 RT	PRIVATE ENT.	AGG	30	20	11.1	0.9	5.0
813+07 RT	PRIVATE ENT.	AGG	25	21	10.2	0.9	4.6
818+66 LT	COMMERCIAL ENT.	HMA	82	77	35.3	1.2	15.9
830+12 LT	PRIVATE ENT.	HMA	37	30	14.9	0.5	6.7
832+82 RT	FIELD ENT.	DIRT			***		
836+80 RT	PRIVATE ENT.	AGG	25	20	10.0	0.8	4.5
873+11 RT	FIELD ENT.	DIRT			***		
876+63 RT	PRIVATE ENT.	AGG	58	35	20.7	1.7	9.3
886+23 RT	PRIVATE ENT.	HMA	27	14	9.1	0.3	4.1
888+63 RT	PRIVATE ENT.	AGG	37	36	16.2	1.4	7.3
891+50 RT	FIELD ENT.	DIRT			***		
889+38 LT	PRIVATE ENT.	AGG	37	27	14.2	1.2	6.4
895+29 RT	PRIVATE ENT.	AGG	28	20	10.7	0.9	4.8
895+87 RT	PRIVATE ENT.	AGG	24	17	9.1	0.8	4.1
896+47 RT	PRIVATE ENT.	AGG	40	30	15.6	1.3	7.0
896+97 LT	PRIVATE ENT.	AGG	35	30	14.4	1.2	6.5
898+50 RT	PRIVATE ENT.	AGG	30	25	12.2	1.0	5.5
900+11 LT	FIELD ENT.	DIRT			***		
900+65 RT	COMMERCIAL ENT.	CONC.	90	84	38.7	1.4	17.4
901+71 LT	PRIVATE ENT.	AGG	35	21	12.4	1.0	5.6
904+28 LT	PRIVATE ENT.	AGG	66	48	25.3	2.1	11.4
905+93 RT	FIELD ENT.	DIRT			***		
907+85 LT	PRIVATE ENT.	AGG	47	29	16.9	1.4	7.6
910+75 LT	PRIVATE ENT.	AGG	35	30	14.4	1.2	6.5
910+85 RT	FIELD ENT.	DIRT			***		
915+10 RT	PRIVATE ENT.	HMA	60	50	24.4	0.9	11.0
917+99 LT	PRIVATE ENT.	AGG	40	30	15.6	1.3	7.0
918+80 RT	PRIVATE ENT.	AGG	65	36	22.4	1.9	10.1
921+35 LT	PRIVATE ENT.	AGG	34	30	14.2	1.2	6.4
923+06 RT	FIELD ENT.	DIRT			***		
927+50 LT	PRIVATE ENT.	AGG	45	35	17.8	1.5	8.0
932+93 RT	FIELD ENT.	DIRT			***		
935+00 LT	PRIVATE ENT.	AGG	50	45	21.1	1.8	9.5
945+65 RT	COMMERCIAL ENT.	AGG	83	63	32.4	2.7	14.6
949+99 LT	PRIVATE ENT.	AGG	83	63	32.4	2.7	14.6
954+80 LT	PRIVATE ENT.	AGG	84	58	31.6	2.7	14.2
954+90 LT	PRIVATE ENT.	AGG	20	15	7.8	0.7	3.5
960+54 RT	COMMERCIAL ENT.	AGG	52	32	18.7	1.6	8.4
961+52 RT	PRIVATE ENT.	AGG	45	37	18.2	1.5	8.2
962+15 RT	PRIVATE ENT.	AGG	35	27	13.8	1.2	6.2
962+99 RT	PRIVATE ENT.	AGG	48	28	16.9	1.4	7.6
964+12 RT	PRIVATE ENT.	AGG	40	30	15.6	1.3	7.0
965+29 RT	PRIVATE ENT.	AGG	40	32	16.0	1.3	7.2
966+07 LT	COMMERCIAL ENT.	HMA	52	43	21.1	0.7	9.5
966+74 LT	COMMERCIAL ENT.	HMA	59	52	24.7	0.9	11.1
967+38 RT	PRIVATE ENT.	DIRT			***		
<b>TOTAL</b>						54	336

**- CONT. ENTRANCE SCHEDULE**

LOCATION: FAP 14 ( IL 242)	ENTRANCE TYPE	EXIST. SURFACE	EOP WIDTH	WIDTH AT 4' OFFSET	ROADWAY AREA	INCIDENTAL HMA SURFACING	BIT. MAT. ( PRIME COAT)
		FOR INFORMATIONAL PURPOSE ONLY					
		TYPE	( FT)	( FT)	( SQ YD)	( TON)	( POUND)
968+81 RT	PRIVATE ENT.	AGG	20	15	7.8	0.7	3.5
968+837 LT	PRIVATE ENT.	AGG	36	27	14.0	1.2	6.3
969+07 RT	PRIVATE ENT.	AGG	25	21	10.2	0.9	4.6
969+23 RT	PRIVATE ENT.	AGG	20	13	7.3	0.6	3.3
970+01 LT	PRIVATE ENT.	AGG	31	20	11.3	1.0	5.1
970+06 RT	PRIVATE ENT.	AGG	19	13	7.1	0.6	3.2
971+43 RT	COMMERCIAL ENT.	AGG	52	39	20.2	1.7	9.1
971+75 LT	PRIVATE ENT.	AGG	40	31	15.8	1.3	7.1
971+89 LT	PRIVATE ENT.	AGG	32	28	13.3	1.1	6.0
972+29 RT	PRIVATE ENT.	AGG	28	19	10.4	0.9	4.7
TOTAL						9	53
PROJECT TOTALS						105	705

**SIDE ROAD SCHEDULE**

LOCATION: FAP 14 ( IL 3)			EXIST. SURFACE	EOP WIDTH	WIDTH AT 15' OFFSET	ROADWAY AREA	HMA SURF. REMOV. -BUTT JT.	INCIDENTAL HMA SURFACING	BIT. MAT. ( PRIME COAT)
			FOR INFORMATIONAL PURPOSE ONLY						
				( FT)	( FT)	( SQ YD)	( SQ YD)	( TON)	( POUND)
<b>SIDE ROADS</b>									
RT	County Road 000 N	395+88	OIL & CHIP	57.0	28.0	70.8		12.4	31.9
LT	CO Road 2350 N	422+30	AGGREGATE	31.0	16.0	39.2		6.6	17.6
RT	CO Road 2350 N	422+30	AGGREGATE	35.0	19.0	45.0		7.6	20.3
LT	Aden Road	449+09	HMA	110.0	61.0	142.5	142.5	15.0	64.1
LT	CO Road 2150 N	528+85	AGGREGATE	105.0	61.0	138.3		23.2	62.3
RT	CO Road 2150 N	528+85	HMA	215.0	78.0	244.2	244.2	25.6	109.9
LT	CO Road 2075 N	567+23	AGGREGATE	70.0	36.0	88.3		14.8	39.8
RT	CO Road 2075 N	567+25	AGGREGATE	42.0	16.0	48.3		8.1	21.8
RT	CO Road 2000 N	605+90	AGGREGATE	79.0	33.0	93.3		15.7	42.0
LT	CO Road 2000 N	605+90	CONCRETE	114.0	54.0	140.0		14.7	63.0
LT	CO Road 1925 N	645+96	AGGREGATE	40.0	19.0	49.2		8.3	22.1
RT	CO Road 1900 N	659+22	HMA	88.0	51.0	115.8	115.8	12.2	52.1
LT	CO Road 1725 N	752+75	AGGREGATE	49.0	28.0	64.2		10.8	28.9
LT	BLAIRVILLE RD	766+44	HMA	68.0	30.0	81.7	81.7	8.6	36.8
LT	CO Road 1650 N	792+93	AGGREGATE	46.0	23.0	57.5		9.7	25.9
RT	CO Road 1650 N	793+11	AGGREGATE	30.0	17.0	39.2		6.6	17.6
RT	CO Road 1600 N	819+74	OIL & CHIP	82.0	35.0	97.5		17.0	43.9
LT	CO Road 1575 N	834+42	AGGREGATE	43.0	19.0	51.7		8.7	23.3
LT	CO Road 1450 N	896+07	AGGREGATE	57.0	29.0	71.7		12.0	32.3
RT	CO Road 1435 N	902+76	AGGREGATE	44.0	36.0	66.7		11.2	30.0
LT	CO Road 1400 N	922+62	OIL & CHIP	43.0	25.0	56.7		10.0	25.5
RT	CO Road 1400 N	922+62	OIL & CHIP	43.0	22.0	54.2		9.5	24.4
RT	Border Street	949+99	AGGREGATE	63.0	55.0	98.3		16.5	44.3
RT	Ollie Street	953+16	OIL & CHIP	103.0	76.0	149.2		26.5	67.1
LT	Maple Avenue	955+91	OIL & CHIP	52.0	37.0	74.2		13.2	33.4
LT	Blackburn Avenue	960+38	OIL & CHIP	49.0	23.0	60.0		10.5	27.0
LT	Powell Avenue	964+64	OIL & CHIP	54.0	25.0	65.8		11.5	29.6
RT	Isabelle Pl.	966+47	OIL & CHIP	55.0	22.0	64.2		11.2	28.9
RT	W. Carpenter Street	970+92	OIL & CHIP	56.0	28.0	70.0		12.3	31.5
PROJECT TOTALS							584	370	1,097

## GUARDRAIL SCHEDULE

LEFT OR RIGHT	LOCATION STATION TO STATION			GUARDRAIL REMOVAL	TRAFFIC BARRIER TERMINAL TY 1, SPL (TANG)	L. S. GUARDRAIL OVER CULV 25' SPAN	GUARDRAIL MARKERS	TERMINAL MARKERS DIRECT APPLIED	COMMENTS
				FOOT	EACH	FOOT	EACH	EACH	
	STA.	TO	STA.						
LT	908+20		908+20	100	2	25	4	2	9' POSTS NEEDED DUE TO LACK OF SHOULDER SUPPORT
RT	909+20		909+20	100	2	25	4	2	9' POSTS NEEDED DUE TO LACK OF SHOULDER SUPPORT
	TOTAL			200	4	50	8	4	

NOTE: ANY WIDENING NECESSARY TO CONSTRUCT THE TYPE1, SPECIAL (TANGENT) GUARDRAIL TERMINAL SHALL BE INCLUDED IN THE COST OF TRAFFIC BARRIER TERMINAL, TYPE 1 SPECIAL (TANGENT)

## CURB RAMPS SCHEDULE

LOCATION	COMB CC&G, REMOVAL	DETECTABLE WARNING	CONC CURB, TY B	COMB CC&G, TY B-6.24	SIDEWALK REMOVAL	PC CONC SIDEWALK 4"	CLASS 2 SEEDING	NITROGEN FERTILIZER	PHOSPHORUS FERTILIZER	POTASSIUM FERTILIZER	AG GROUND LIMESTONE	MULCH METHOD 2	CLASS 7 SEEDING	EROSION CONTROL SEEDING	COMMENTS
	FOOT	SQ FT	FOOT	FOOT	SQ FT	SQ FT	ACRE	POUND	POUND	POUND	TON	ACRE	ACRE	POUND	
<b>IL 142</b>															
NE QUAD	0	16	0	0	16	16	0.0	0	0	0	0.0	0.0	0.0	0	USE STD 424021
NW QUAD	20	20	0	20	148	148	0.0	0	0	0	0.0	0.0	0.0	0	USE STD 424001
<b>JEFFERSON ST.</b>															
NW QUAD	11	22	38	11	110	110	0.1	9	9	9	0.2	0.1	0.1	10	USE STD 424021
NE QUAD	9	18	42	9	110	110	0.1	9	9	9	0.2	0.1	0.1	10	USE STD 424021
SE QUAD	15	20	24	15	176	165	0.1	9	9	9	0.2	0.1	0.1	10	USE STD 424011
<b>TOTAL</b>	<b>55</b>	<b>96</b>	<b>104</b>	<b>55</b>	<b>560</b>	<b>549</b>	<b>0.3</b>	<b>27</b>	<b>27</b>	<b>27</b>	<b>0.6</b>	<b>0.3</b>	<b>0.3</b>	<b>30</b>	



# PAVEMENT MARKING SCHEDULE

LOCATION			PAINT PAVEMENT MARKING						TEMPORARY PAVEMENT MARKING						SHORT-TERM PAVEMENT MARKING (*)	WORK ZONE PAVEMENT MARKING REMOVAL		
			LINE 4"			DOUBLE LINE 4"	LINE 24"	WHITE	LINE 4"			DOUBLE LINE 4"	LINE 24"	WHITE				
			WHITE	YELLOW			WHITE	LET & SYM	WHITE	YELLOW			WHITE	LET & SYM				
			SOLID	SKIP-D ASH	SOLID LT/RT	SOLID	SOLID		SOLID	SKIP-D ASH	SOLID LT/RT	SOLID	SOLID					
IL 244			FOOT	FOOT	FOOT		FOOT	FOOT	SQ FT	FOOT	FOOT	FOOT		FOOT	FOOT	SQ FT		
395+88	TO	400+46	916	115						916	115						137	389.3
400+46	TO	406+00	1108	139	554	RT				1108	139	554	RT				166	655.6
406+00	TO	411+02	1004	125						1004	125						151	426.6
411+02	TO	416+56	1109	139	554	LT				1109	139	554	LT				166	656.0
416+56	TO	419+73	634	79						634	79						95	269.3
419+73	TO	425+81	1215	152	608	RT				1215	152	608	RT				182	719.1
425+81	TO	430+30	898	112						898	112						135	381.5
430+30	TO	435+84	1109	139	554	LT				1109	139	554	LT				166	656.0
435+84	TO	484+96	9824	1228						9824	1228						1,474	4175.2
484+96	TO	491+82	1373	172	686	RT				1373	172	686	RT				206	812.2
491+82	TO	495+26	686	86						686	86						103	291.7
495+26	TO	502+12	1373	172	686	LT				1373	172	686	LT				206	812.2
502+12	TO	526+68	4913	614						4913	614						737	2087.8
526+68	TO	533+02	1267	158	634	RT				1267	158	634	RT				190	749.8
533+02	TO	537+24	845	106						845	106						127	359.0
537+24	TO	542+53	1057	132	529	LT				1057	132	529	LT				159	625.4
542+53	TO	552+93.2	2081	260						2081	260						312	884.3
552+93.2 BK	=	552+93.4 AH																
552+93.4	TO	569+71.1	3355	419						3355	419						503	1426.0
569+71.1 BK	=	569+71.5 AH																
569+71.5	TO	595+87.	5231	654						5231	654						785	2223.2
595+87	TO	603+27	1480	185	740	RT				1480	185	740	RT				222	875.7
603+27	TO	604+85	317				317			317				317			48	227.0
604+85	TO	613+04	1637	205	818	LT				1637	205	818	LT				246	968.4
613+04	TO	702+00	17792	2224						17792	2224						2,669	7561.8
702+00 BK	=	701+83.5 AH																
701+83.5	TO	722+07.12	4047	506						4047	506						607	1720.1
722+07.12 BK	=	722+23.62 AH																
722+23.62	TO	727+66.5	1086	136						1086	136						163	461.4
727+66.5 BK	=	727+66.8 AH																
727+66.8	TO	798+15.	14096	1762						14096	1762						2,114	5991.0
798+15	TO	807+66	1902	238	951	RT				1902	238	951	RT				285	1125.6
807+66	TO	808+98	264	33						264	33						40	112.2
808+98	TO	817+96	1795	224	898	LT				1795	224	898	LT				269	1062.2
817+96	TO	824+30	1268	159						1268	159						190	539.0
824+30	TO	833+54	1848	231	924	RT				1848	231	924	RT				277	1093.4
TOTAL			87530	10902	9137		317	0	0	87530	10902	9137		317	0	0	13130	40338

• ONE APPLICATION EACH FOR HMA SURFACE REMOVAL, BINDER, AND SURFACE COURSE

FILE NAME =	USER NAME = brandonja	DESIGNED -	REVISED -	<b>STATE OF ILLINOIS DEPARTMENT OF TRANSPORTATION</b>	<b>PAVEMENT MARKING SCHEDULE</b>	F.A.P. RTE.	SECTION	COUNTY	TOTAL SHEETS	SHEET NO.
pw:\IL\084EBIDINTEG.illinois.gov\PIWIDOT\Documents\DOT Offices\District 9\Projects\78478\Drawings\CAD\Sheets\78478-sha-cvr-seq.dwg		DRAWN -	REVISED -			776	102RS-4	HAMILTON	35	17
Default	PLOT SCALE = 100.0000' / in.	CHECKED -	REVISED -		SCALE:	SHEET OF SHEETS STA.		TO STA.		ILLINOIS FED. AID PROJECT
	PLOT DATE = 8/19/2015	DATE -	REVISED -							<b>CONTRACT NO. 78478</b>

# PAVEMENT MARKING SCHEDULE

LOCATION			PAINT PAVEMENT MARKING							TEMPORARY PAVEMENT MARKING							SHORT-TERM PAVEMENT MARKING (*)	WORK ZONE PAVEMENT MARKING REMOVAL			
			LINE 4"				DOUBLE LINE 4"	LINE 24"	WHITE	LINE 4"				DOUBLE LINE 4"	LINE 24"	WHITE					
			WHITE	YELLOW			WHITE	LET & SYM	WHITE	YELLOW			WHITE	LET & SYM							
			SOLID	SKIP-D ASH	SOLID LT/RT	SOLID	SOLID		SOLID	SKIP-D ASH	SOLID LT/RT	SOLID	SOLID								
IL 244			FOOT	FOOT	FOOT		FOOT	FOOT	SQ FT	FOOT	FOOT	FOOT		FOOT	FOOT	SQ FT					
833+54	TO	857+84	4860					4860						4860				729	3482.8		
857+84	TO	867+61	1954	244	977	LT								1954	244	977	LT		293	1155.9	
867+61	TO	878+43	2165	271										2165	271				325	920.0	
878+43	TO	885+83	1479	185	740	RT								1479	185	740	RT		222	875.3	
885+83	TO	897+97	2429	304	1214	LT								2429	304	1214	LT		364	1437.0	
897+97	TO	914+61	3327	416										3327	416				499	1414.2	
914+61	TO	920+69	1215	152	608	RT								1215	152	608	RT		182	719.1	
920+69	TO	924+91	845	106										845	106				127	359.0	
924+91	TO	929+40	898	112	449	LT								898	112	449	LT		135	531.1	
929+40	TO	931+77	475					475						475				475	71	340.6	
931+77	TO	939+70	1585	198	793	RT								1585	198	793	RT		238	937.8	
939+70	TO	944+48.2	957					957						957				957	143	685.6	
944+48.2 BK	=	944+59.4 AH																			
944+59.4	TO	950+50	1181					1181						1181				1181	177	846.5	
950+50	TO	956+44	1188					1188						1188				1188	178	851.4	
956+44	TO	958+89.9	491	61	246	LT								491	61	246	LT		74	290.6	
958+89.9 BK	=	959+01.1 AH																			
959+01.1	TO	964+22	1042	130	521	LT								1042	130	521	LT		156	616.4	
964+22	TO	970+82	1319	165										1319	165				198	560.7	
970+82	TO	974+16	669	84	334	RT								669	84	334	RT		100	395.7	
971+36						RT		12									RT		12		24.0
971+61 - RXR						RT			61.2								RT		61.2		61.2
971+86						RT		12									RT		12		24.0
974+00						RT		12									RT		12		24.0
RR OMISSION																					
974+25.5 BK	=	105+47.7 AH																			
105+47.7	TO	105+73	51	6	25	LT								51	6	25	LT		5		29.1
105+62						LT		12									LT		12		24.0
108+45						LT		12									LT		12		24.0
108+70 - RXR						LT			61.2								LT		61.2		61.2
108+95						LT		12									LT		12		24.0
105+73	TO	109+17		86	344	LT								86	344	LT			69		166.3
111+60 - HANDICAP PARK. SYM.						RT			4.6								RT		4.6		4.6
111+80 - HANDICAP PARK. SYM.						RT			4.6								RT		4.6		4.6
109+17	TO	118+15		224										224					180		134.7
118+00						RT		20									RT		20		40.0
TOTAL			28129	2744	6250		8661	92	132	28129	2744	6250		8661	92	132		4465		17066	
PROJECT TOTALS			153670					92	132	153670					92	132	17,595	57,404			

\* ONE APPLICATION EACH FOR HMA SURFACE REMOVAL, BINDER, AND SURFACE COURSE

# RPM' S SCHEDULE

LOCATION			RAISED REFLECTIVE PAVEMENT MARKER	RAISED REFLECTIVE PAVEMENT MARKER REMOVAL
IL 244			EACH	EACH
395+88	TO	466+06.5	88	88
<b>SN 033-0046 - OMISSION</b>				
468+13.5	TO	469+78.08	2	2
<b>SN 033-0053 - OMISSION</b>				
471+73.92	TO	552+93.2	101	101
552+93.2 BK	=	552+93.4 AH		
552+93.4	TO	569+71.1	21	21
569+71.1 BK	=	569+71.5 AH		
569+71.5	TO	622+94.	67	67
<b>SN 033-2007 - OMISSION</b>				
624+06.	TO	685+78.7	77	77
<b>SN 033-2008 - OMISSION</b>				
686+81.4	TO	702+00.	19	19
702+00.0 BK	=	701+83.5 AH		
701+83.5	TO	712+05.	13	13
<b>SN 033-0054 - OMISSION</b>				
713+55.	TO	722+07.12	11	11
722+07.12 BK	=	722+23.62 AH		
722+23.62	TO	727+66.5	7	7
727+66.5 BK	=	727+66.8 AH		
727+66.8	TO	737+90.8	13	13
<b>SN 033-0045 - OMISSION</b>				
739+88.8	TO	872+56.	166	166
<b>SN 033-0040 - OMISSION</b>				
873+18.	TO	944+48.2	89	89
944+48.2 BK	=	944+59.4 AH		
944+59.4	TO	950+50.	7	7
950+50.	TO	958+89.9	10	10
958+89.9 BK	=	959+01.1 AH		
959+01.1	TO	974+15.5	19	19
<b>R. R. OMISSION</b>				
974+25.5 BK	=	105+47.7 AH		
105+47.7	TO	118+15.	16	16
TOTAL			726	726
<b>PROJECT TOTALS</b>			<b>726</b>	<b>726</b>

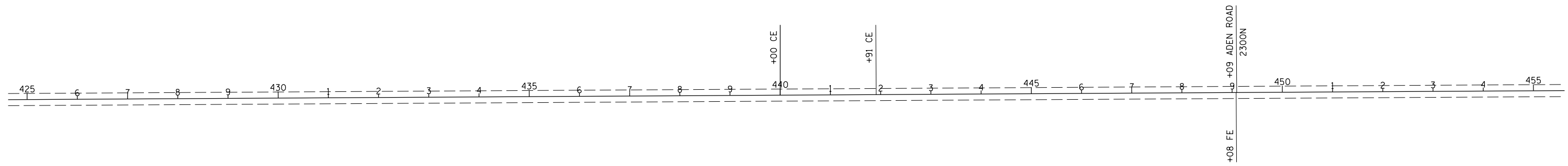
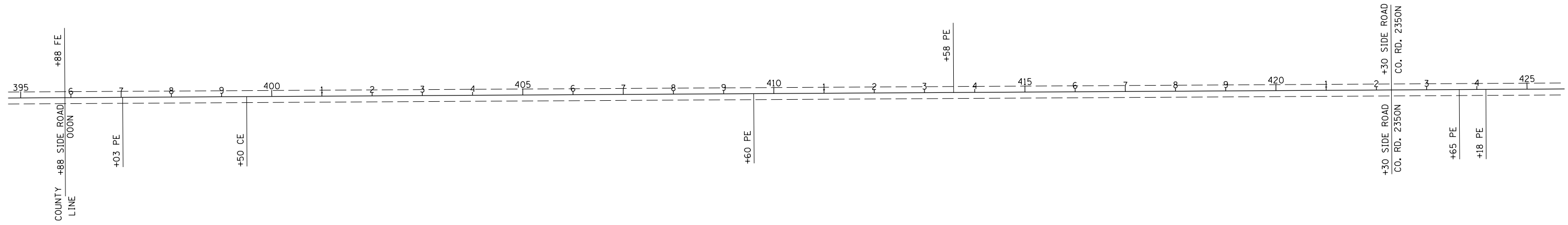

FILE NAME =	USER NAME = brandonja	DESIGNED -	REVISED -
pw:\IL\084EBIDINTEG.illinois.gov\PWIDOT\Documents\DOT Offices\District 9\Projects\78478\Drawings\CAD\Sheets\78478-sht-cvr_seq.dwg		DRAWN -	REVISED -
Default	PLOT SCALE = 200.0000' / in.	CHECKED -	REVISED -
	PLOT DATE = 8/19/2015	DATE -	REVISED -

**STATE OF ILLINOIS  
DEPARTMENT OF TRANSPORTATION**

**IL 242: STA. 395 + 00 TO STA. 495 + 00**

SCALE: SHEET OF SHEETS STA. TO STA.

F.A.P. RTE.	SECTION	COUNTY	TOTAL SHEETS	SHEET NO.
776	102R5-4	HAMILTON	35	20
<b>CONTRACT NO. 78478</b>				
ILLINOIS FED. AID PROJECT				

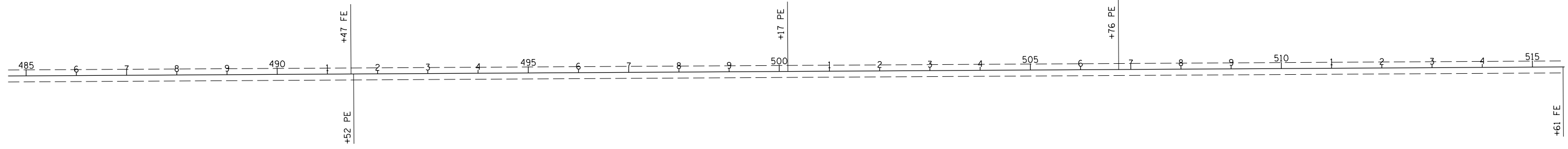
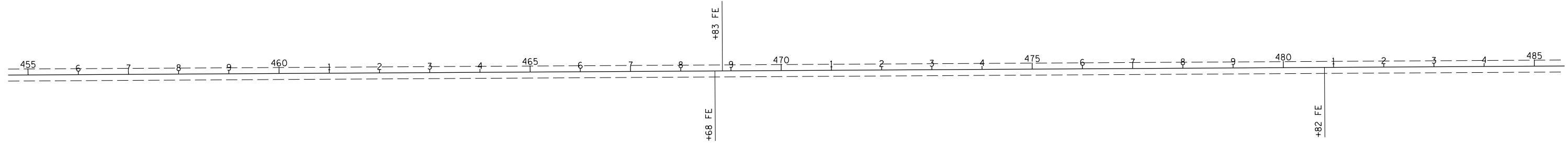

FILE NAME =	USER NAME = brandonja	DESIGNED -	REVISED -
p:\11\084EBIDINTEG.illinois.gov\PIWIDOT\Documents\DOT Offices\District 9\Projects\78478\Drawings\CADsheets\78478-shta-cvr-soq.dwg		DRAWN -	REVISED -
Default	PLOT SCALE = 200.0000' / in.	CHECKED -	REVISED -
	PLOT DATE = 8/19/2015	DATE -	REVISED -

**STATE OF ILLINOIS  
DEPARTMENT OF TRANSPORTATION**

**IL 242: STA. 895 + 00 TO STA. 895 + 00**

SCALE: SHEET OF SHEETS STA. TO STA.

F.A.P. RTE.	SECTION	COUNTY	TOTAL SHEETS	SHEET NO.
776	102R5-4	HAMILTON	35	21
ILLINOIS FED. AID PROJECT			CONTRACT NO. 78478	

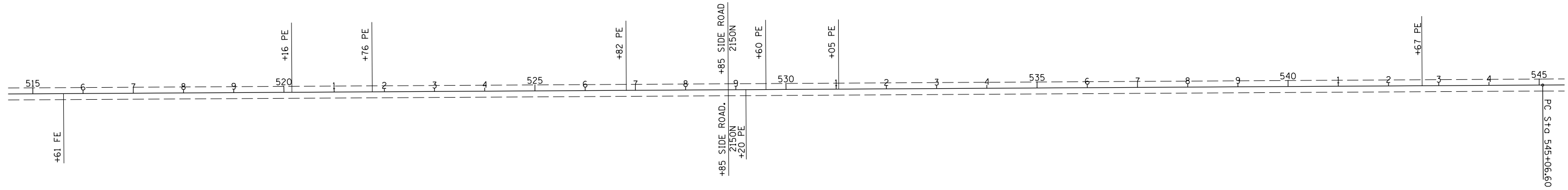

PI Sta 549+00  
 D = 3° 56' (RT)  
 L = 0° 30'  
 L = 786.6'  
 T = 393.4'  
 R = 11,460.0'  
 PC Sta 545+06.60  
 PT Sta 552+93.20  
 SE = 0.0125 FT/FT  
 SE Transition - 180'  
 Sta. 543+86.6 to Sta. 545+66.6  
 Sta. 552+33.2 to Sta. 554+13.4

EQUATION:  
 Sta 552+93.20 BK =  
 Sta 552+93.40 AH =

PI Sta 566+58.00  
 D = 3° 08' (LT)  
 L = 0° 30'  
 L = 626.6'  
 T = 313.5'  
 R = 11,460.0'  
 PC Sta 563+44.50  
 PT Sta 569+71.10  
 SE = 0.0125 FT/FT  
 SE Transition - 180'  
 Sta. 562+22.5 to Sta. 564+0.45  
 Sta. 569+11.1 to Sta. 570+91.5

EQUATION:  
 Sta 569+71.10 BK =  
 Sta 569+71.50 AH =

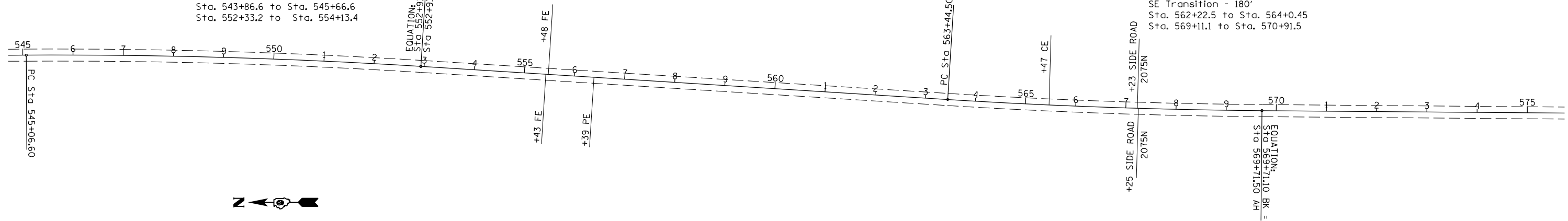

FILE NAME =	USER NAME = brandonja	DESIGNED -	REVISED -
pw:\IL\084EBIDINTEG.illinois.gov\PI\DOT\Documents\IDOT Offices\District 9\Projects\78478\Drawings\CAD\Sheets\78478-sha-cvr-soq.dwg		DRAWN -	REVISED -
Default	PLOT SCALE = 200.0000' / in.	CHECKED -	REVISED -
	PLOT DATE = 8/19/2015	DATE -	REVISED -

**STATE OF ILLINOIS  
 DEPARTMENT OF TRANSPORTATION**

**IL 242: STA. 515 + 00 TO STA. 575 + 00**

SCALE: SHEET OF SHEETS STA. TO STA.

F.A.P. RTE.	SECTION	COUNTY	TOTAL SHEETS	SHEET NO.
776	102R5-4	HAMILTON	35	22
<b>CONTRACT NO. 78478</b>				
ILLINOIS FED. AID PROJECT				

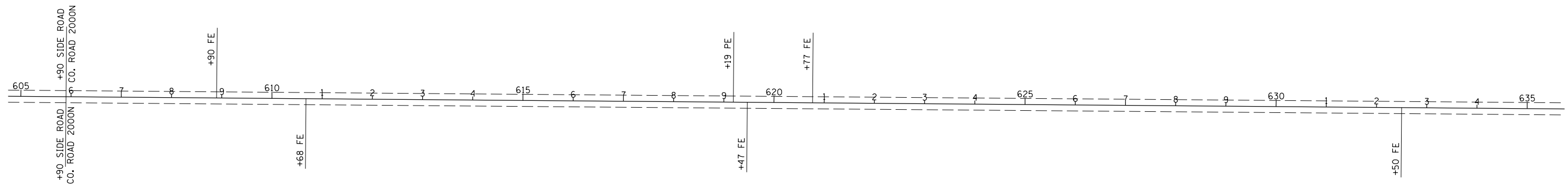
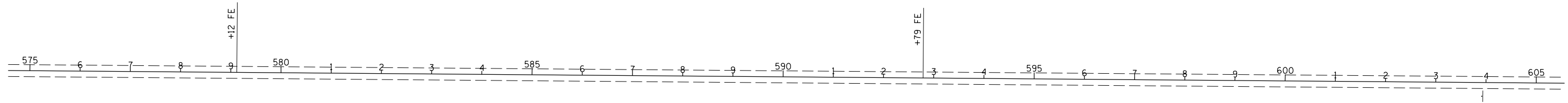

FILE NAME =	USER NAME = brandonja	DESIGNED -	REVISED -
pw:\IL\084EBIDINTEG.illinois.gov\PIWIDOT\Documents\IDOT Offices\District 9\Projects\78478\Drawings\CAD\Sheets\78478-shta-cvr-soq.dwg		DRAWN -	REVISED -
Default	PLOT SCALE = 200.0000' / in.	CHECKED -	REVISED -
	PLOT DATE = 8/19/2015	DATE -	REVISED -

**STATE OF ILLINOIS  
DEPARTMENT OF TRANSPORTATION**

**IL 242: STA. 575 + 00 TO STA. 635 + 00**

SCALE: SHEET OF SHEETS STA. TO STA.

F.A.P. RTE.	SECTION	COUNTY	TOTAL SHEETS	SHEET NO.
776	102RS-4	HAMILTON	35	23
CONTRACT NO. 78478				
ILLINOIS FED. AID PROJECT				

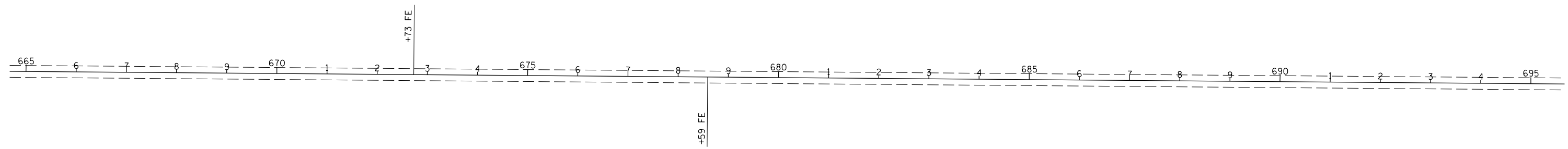
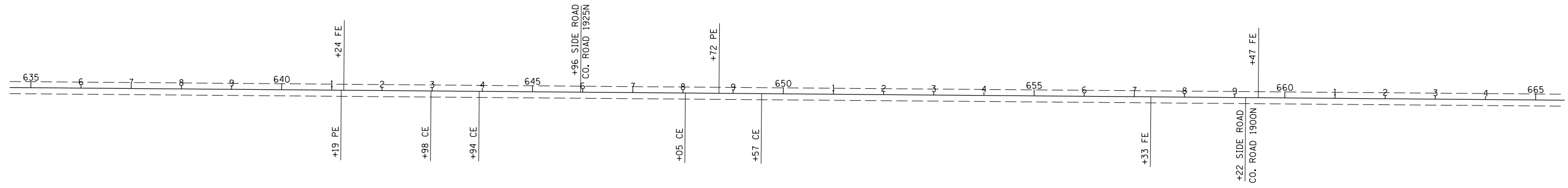

FILE NAME =	USER NAME = brandonja	DESIGNED -	REVISED -	<b>STATE OF ILLINOIS DEPARTMENT OF TRANSPORTATION</b>	<b>IL 242: STA. 635 + 00 TO STA. 695 + 00</b>			F.A.P. RTE.	SECTION	COUNTY	TOTAL SHEETS	SHEET NO.
pw:\IL\084EBIDINTEG.illinois.gov\PI\DOT\Documents\IDOT Offices\District 9\Projects\78478\Drawings\CAD\Sheets\78478-sht-cvr_seq.dwg	DESIGNED -	REVISED -	776					102RS-4	HAMILTON	35	24	
Default	PLOT SCALE = 200.0000' / in.	CHECKED -	REVISED -		CONTRACT NO. 78478			ILLINOIS FED. AID PROJECT				
	PLOT DATE = 8/19/2015	DATE -	REVISED -		SCALE:	SHEET OF SHEETS	STA. TO STA.					





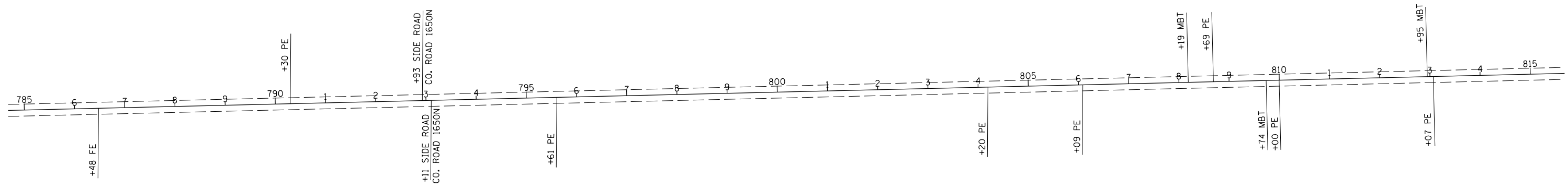
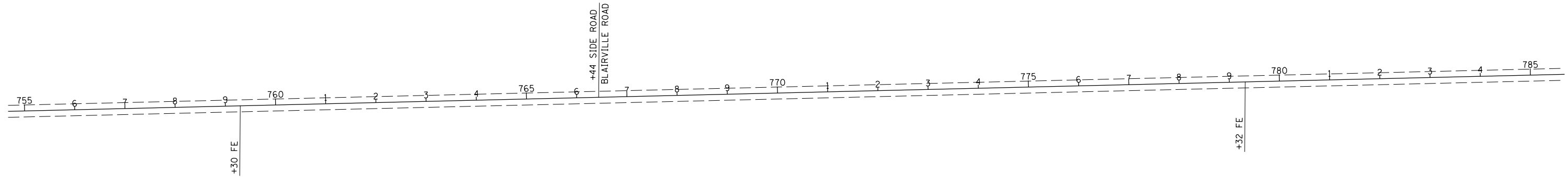

FILE NAME =	USER NAME = brandonja	DESIGNED -	REVISED -
pw:\IL\084EBIDINTEG.illinois.gov\PI\DOT\Documents\DOT Offices\District 9\Projects\78478\Drawings\CAD\Sheets\78478-sha-cvr_seq.dwg		DRAWN -	REVISED -
Default	PLOT SCALE = 200.0000' / in.	CHECKED -	REVISED -
	PLOT DATE = 8/19/2015	DATE -	REVISED -

**STATE OF ILLINOIS  
DEPARTMENT OF TRANSPORTATION**

**IL 242: STA. 755 +00 TO STA. 815 +00**

SCALE:	SHEET	OF	SHEETS	STA.	TO	STA.
--------	-------	----	--------	------	----	------

F.A.P. RTE.	SECTION	COUNTY	TOTAL SHEETS	SHEET NO.
776	102RS-4	HAMILTON	35	26
CONTRACT NO. 78478				
ILLINOIS FED. AID PROJECT				

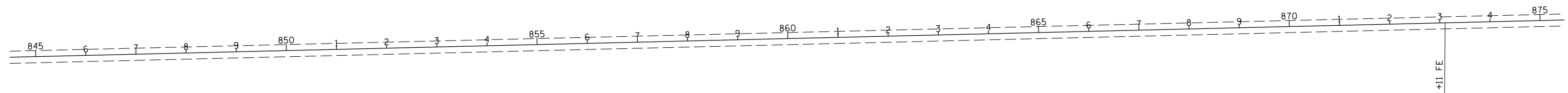
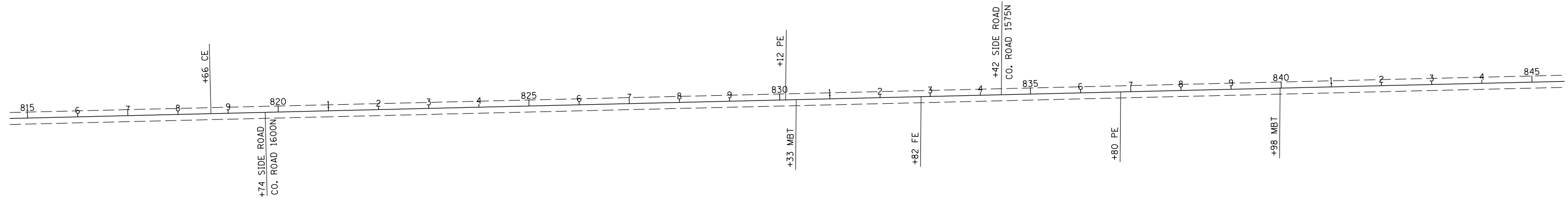

FILE NAME =	USER NAME = brandonja	DESIGNED -	REVISED -
pw:\IL\084EBIDINTEG.illinois.gov\PIWIDOT\Documents\IDOT Offices\District 9\Projects\78478\Drawings\CAD\Sheets\78478-sht-cvr_seq.dwg		DRAWN -	REVISED -
Default	PLOT SCALE = 200.0000' / in.	CHECKED -	REVISED -
	PLOT DATE = 8/19/2015	DATE -	REVISED -

**STATE OF ILLINOIS  
DEPARTMENT OF TRANSPORTATION**

**IL 242: STA. 815 + 00 TO STA. 875 + 00**

SCALE: SHEET OF SHEETS STA. TO STA.

F.A.P. RTE.	SECTION	COUNTY	TOTAL SHEETS	SHEET NO.
776	102R5-4	HAMILTON	35	27
<b>CONTRACT NO. 78478</b>				
ILLINOIS FED. AID PROJECT				

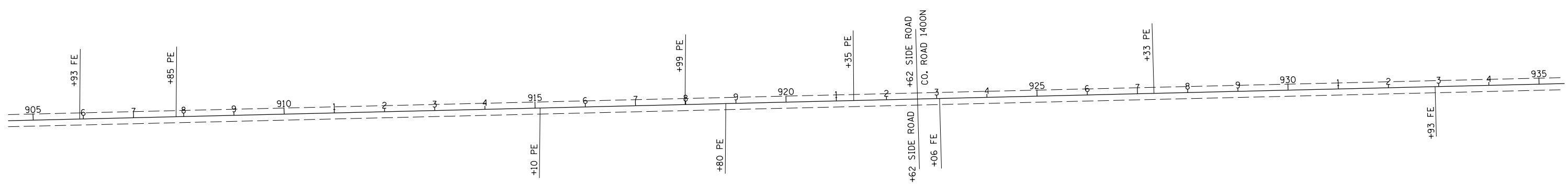
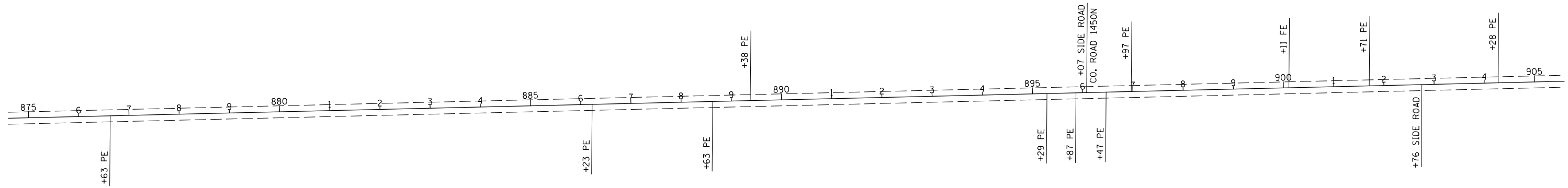

FILE NAME =	USER NAME = brandonja	DESIGNED -	REVISED -
p:\11\084EBIDINTEG.illinois.gov\PWIDOT\Documents\IDOT Offices\District 9\Projects\78478\Drawings\CAD\Sheets\78478-sht-cvr-soq.dwg		DRAWN -	REVISED -
Default	PLOT SCALE = 200.0000' / in.	CHECKED -	REVISED -
	PLOT DATE = 8/19/2015	DATE -	REVISED -

**STATE OF ILLINOIS  
DEPARTMENT OF TRANSPORTATION**

**IL 242: STA. 875 + 00 TO STA. 935 + 00**

SCALE: SHEET OF SHEETS STA. TO STA.

F.A.P. RTE.	SECTION	COUNTY	TOTAL SHEETS	SHEET NO.
776	102R5-4	HAMILTON	35	28
<b>CONTRACT NO. 78478</b>				
ILLINOIS FED. AID PROJECT				



PI Sta 941+00  
 D = 24° 46' (LT)  
 D = 3° 30'  
 L = 707.30'  
 T = 359.4'  
 R = 1,637.3'  
 PC Sta 937+40.60  
 PT Sta 944+48.20  
 SE = 0.0725 FT/FT  
 SE Transition - 180'  
 Sta. 936+20.6 to Sta. 938+00.6  
 Sta. 943+88.2 to Sta. 945+79.4

PI Sta 955+42.40  
 D = 24° 43' (RT)  
 D = 3° 30'  
 L = 706.2'  
 T = 358.7'  
 R = 1,637.30'  
 PC Sta 951+83.70  
 PT Sta 958+89.90  
 SE = 0.07251 FT/FT  
 SE Transition - 180'  
 Sta. 950+63.7 to Sta. 952+43.7  
 Sta. 958+29.9 to Sta. 960+21.1

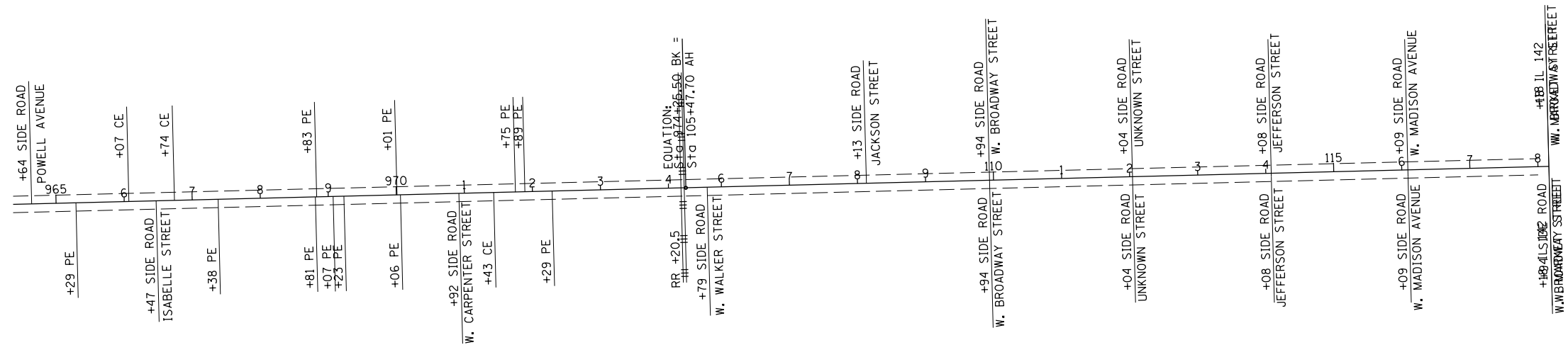
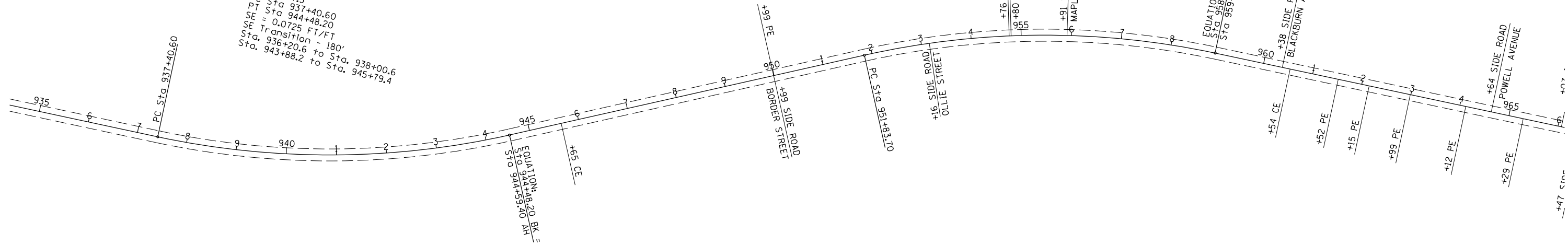

FILE NAME =	USER NAME = brandonja	DESIGNED -	REVISED -
p:\11084EBIDINTEG.illinois.gov\PIWIDOT\Documents\DOT Offices\District 9\Projects\78478\Drawings\CAD\Sheets\78478-sha-cvr-soq.dwg		DRAWN -	REVISED -
Default	PLOT SCALE = 200.0000' / in.	CHECKED -	REVISED -
	PLOT DATE = 8/19/2015	DATE -	REVISED -

**STATE OF ILLINOIS**  
**DEPARTMENT OF TRANSPORTATION**

**IL 242: STA. 935 + 00 TO STA. 118 + 15**

SCALE: SHEET OF SHEETS STA. TO STA.

F.A.P. RTE.	SECTION	COUNTY	TOTAL SHEETS	SHEET NO.
776	102RS-4	HAMILTON	35	29
CONTRACT NO. 78478				
ILLINOIS FED. AID PROJECT				

DETAIL FOR HMA SURFACE TRANSITION

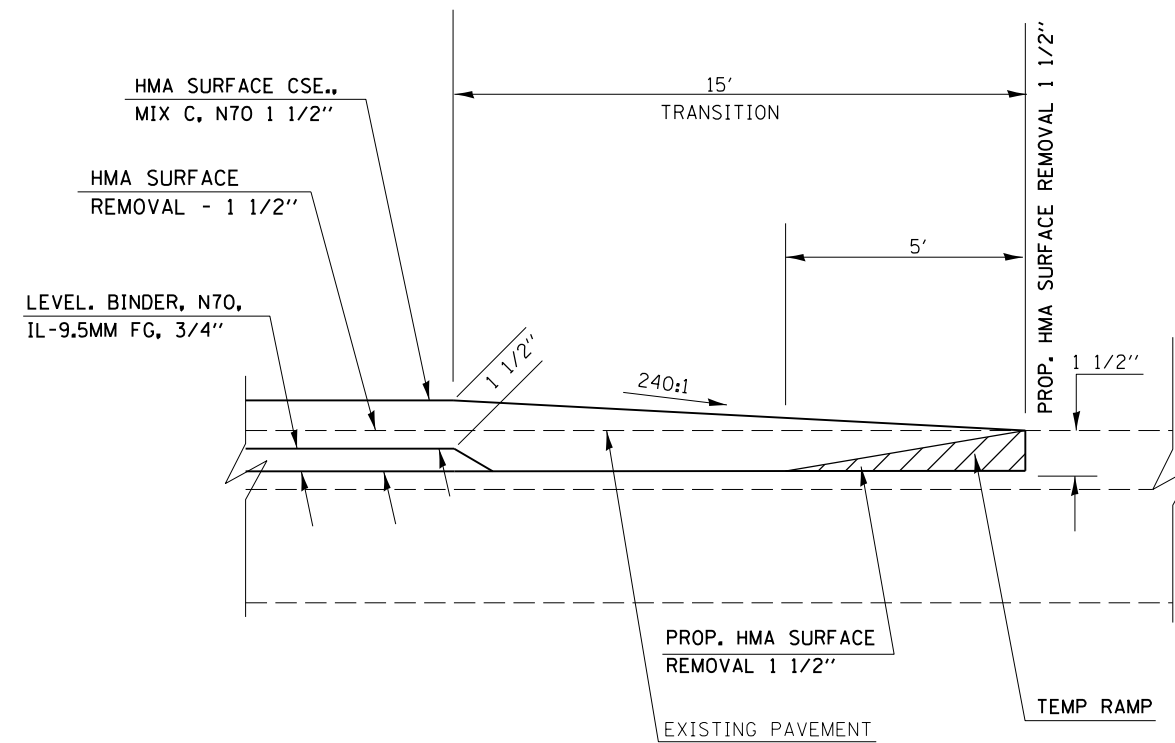

TO BE USED:

- STA. 395+88 TO STA. 396+03
- STA. 465+91.5 TO STA. 466+06.5
- STA. 468+13.5 TO STA. 468+28.5
- STA. 469+63.08 TO STA. 469+78.08
- STA. 471+73.92 TO STA. 471+88.92
- STA. 622+79 TO STA. 622+94
- STA. 624+06 TO STA. 624+21
- STA. 655+63.7 TO STA. 685+78.7
- STA. 686+81.4 TO STA. 686+96.4
- STA. 711+90 TO STA. 712+05
- STA. 713+55 TO STA. 713+70
- STA. 737+75.8 TO STA. 737+90.8
- STA. 739+88.8 TO STA. 740+03.8
- STA. 872+41 TO STA. 872+56
- STA. 873+18 TO STA. 873+33
- STA. 974+00.5 TO STA. 974+15.5

FILE NAME =	USER NAME = brandonja	DESIGNED -	REVISED -	<b>STATE OF ILLINOIS DEPARTMENT OF TRANSPORTATION</b>	<b>DETAIL: HMA SURFACE TRANSITION</b>			F.A.P. RTE.	SECTION	COUNTY	TOTAL SHEETS	SHEET NO.
pw:\IL\084EBIDINTEG.illinois.gov\PIWIDOT\Documents\IDOT Offices\District 9\Projects\78478\Drawings\CAD\Sheets\78478-sha-cvr-soq.dwg	DESIGNED -	REVISED -	776					102RS-4	HAMILTON	35	30	
Default	PLOT SCALE = 100.0000' / in.	CHECKED -	REVISED -		CONTRACT NO. 78478			ILLINOIS FED. AID PROJECT				
	PLOT DATE = 8/19/2015	DATE -	REVISED -		SCALE:	SHEET	OF	SHEETS	STA.	TO	STA.	

## PAVEMENT TRANSITION DETAIL

STA. 840+32 TO STA. 840+47

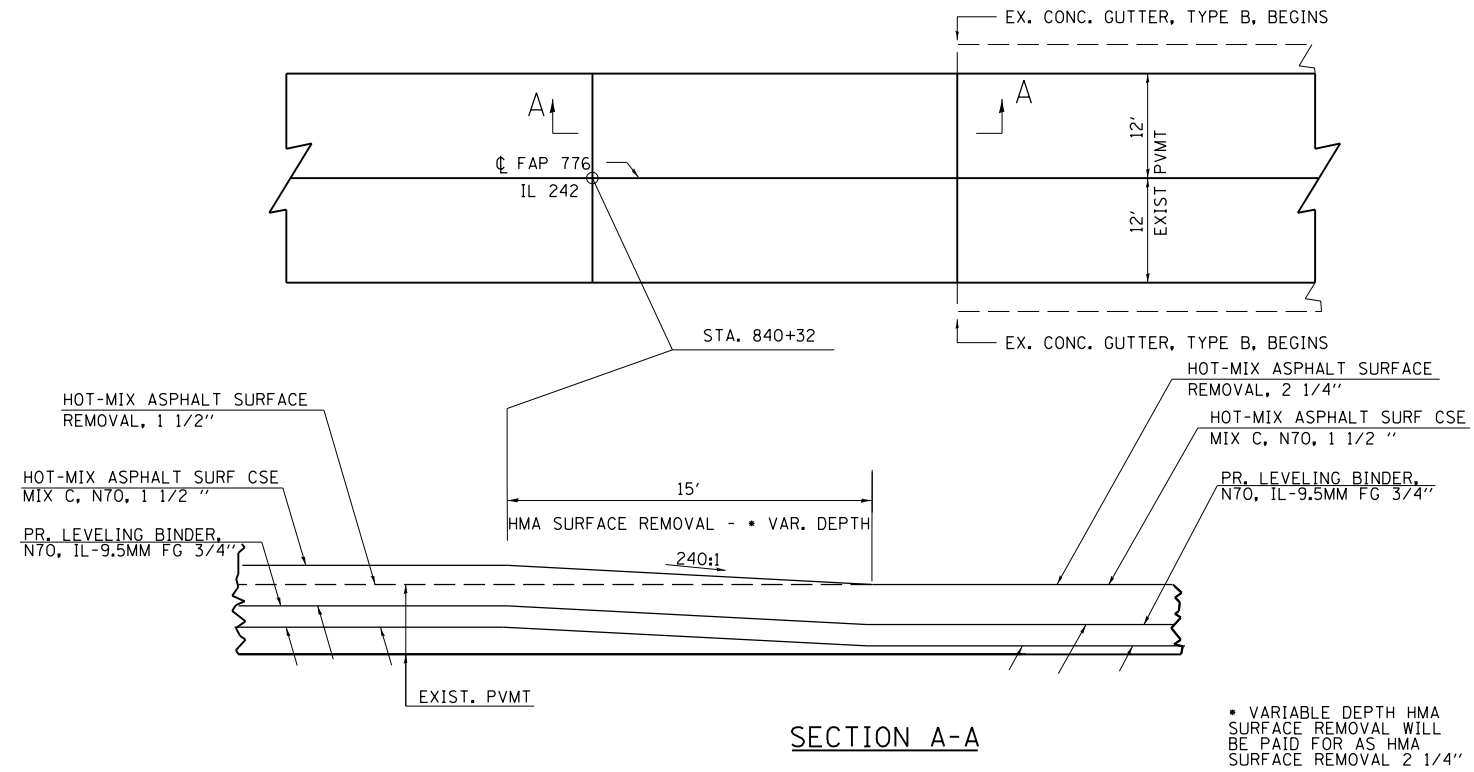

## PAVEMENT TRANSITION DETAIL

STA. 868+93 TO STA. 869+08

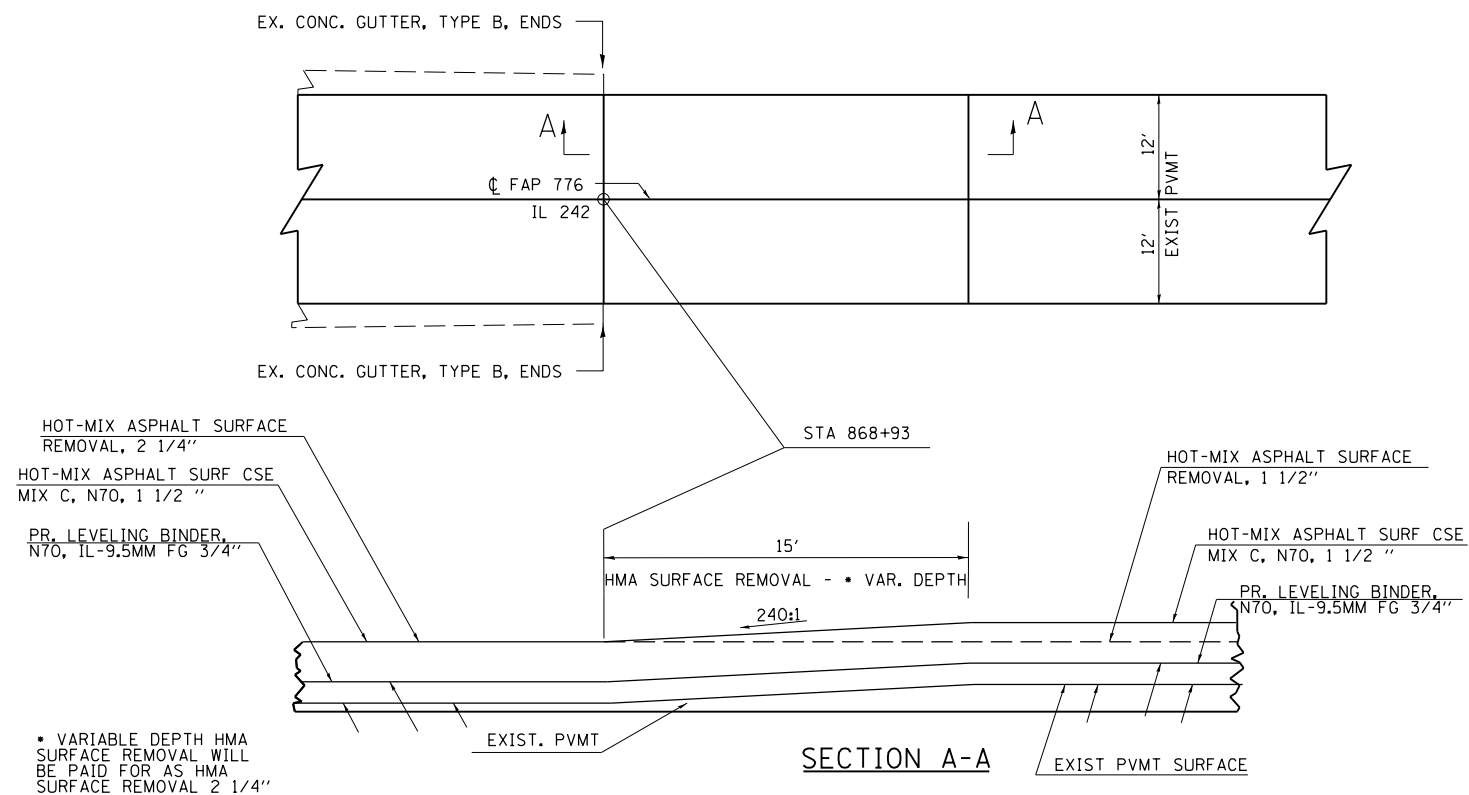

FILE NAME =	USER NAME = brandon.ja	DESIGNED -	REVISED -	<b>STATE OF ILLINOIS DEPARTMENT OF TRANSPORTATION</b>	<b>DETAIL: PAVEMENT TRANSITION</b>	F.A.P. RTE.	SECTION	COUNTY	TOTAL SHEETS	SHEET NO.
pw:\IL\084EBIDINTEG.illinois.gov\PIDOT\Documents\IDOT Offices\District 9\Projects\78478\Drawings\CAD\Sheets\78478-sht-cvr_seq.dwg		BRANDON	REVISED -			776	102R5-4	HAMILTON	35	31
Default	PLOT SCALE = 100.0000' / in.	CHECKED -	REVISED -		SCALE:	SHEET OF SHEETS		STA.	TO STA.	
	PLOT DATE = 8/19/2015	DATE -	REVISED -			ILLINOIS FED. AID PROJECT				
						<b>CONTRACT NO. 78478</b>				

# SIDEROAD AND ENTRANCE DETAILS

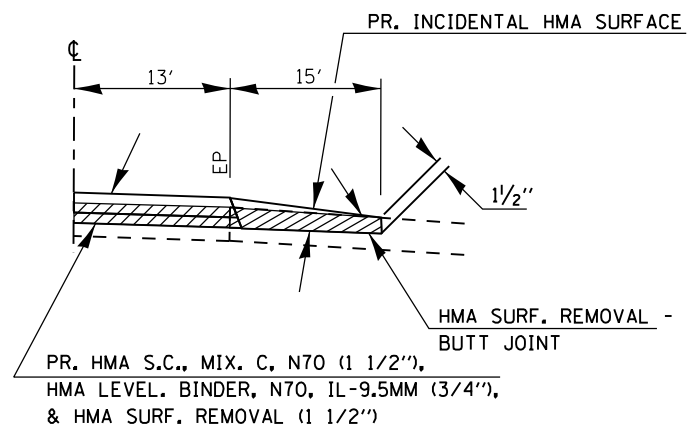

SIDE ROAD SEC. B-B  
EX. BIT. OR CONC. SURFACE

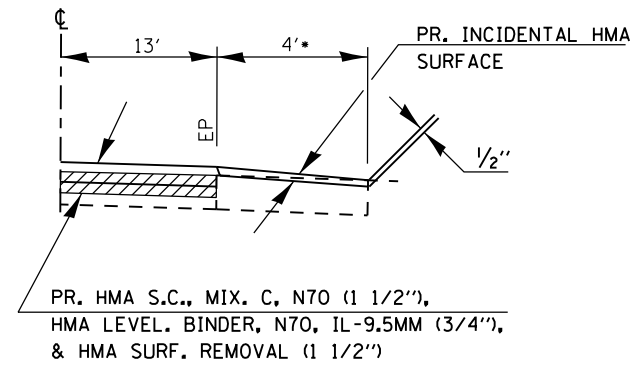

PE OR CE SEC. A-A  
EX. BIT. OR CONC. SURFACE  
•OR END OF BIT. APRON

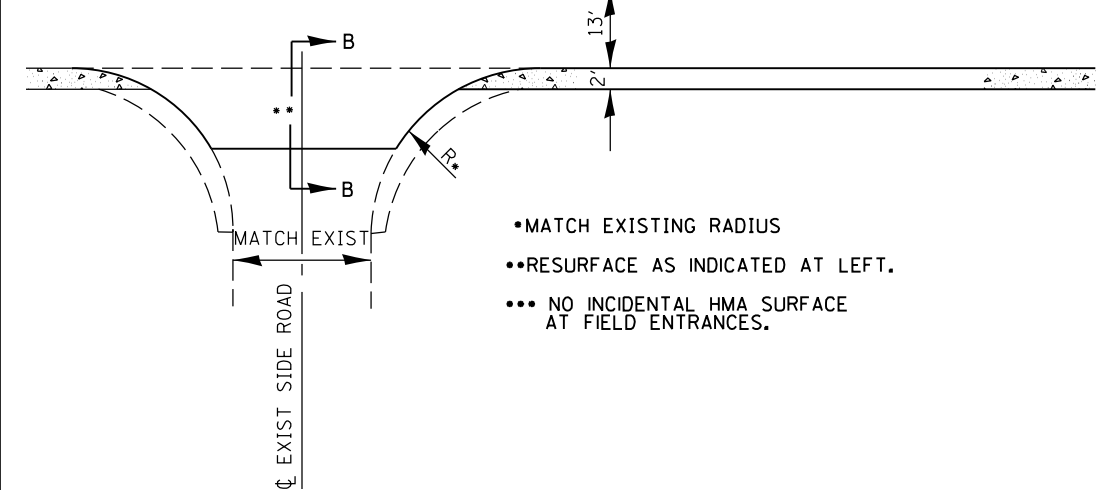
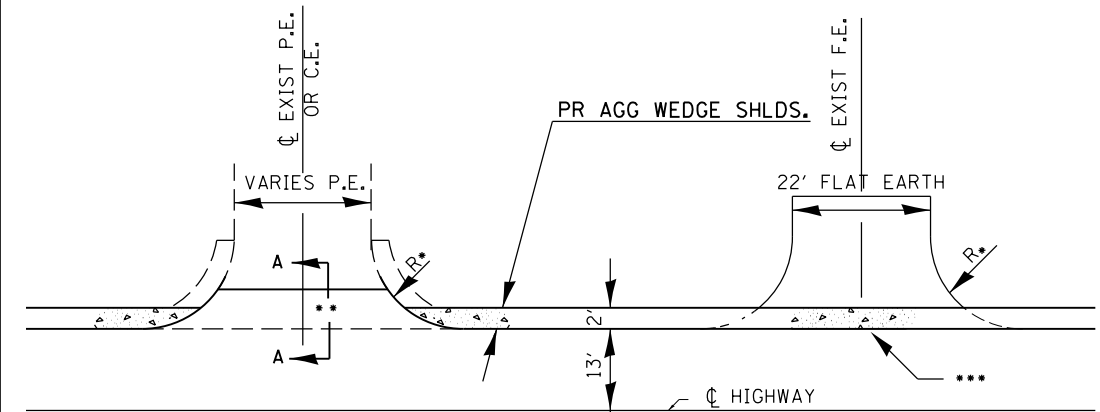

- MATCH EXISTING RADIUS
- RESURFACE AS INDICATED AT LEFT.
- NO INCIDENTAL HMA SURFACE AT FIELD ENTRANCES.

SEE SIDE ROAD AND ENTRANCE SCHEDULES

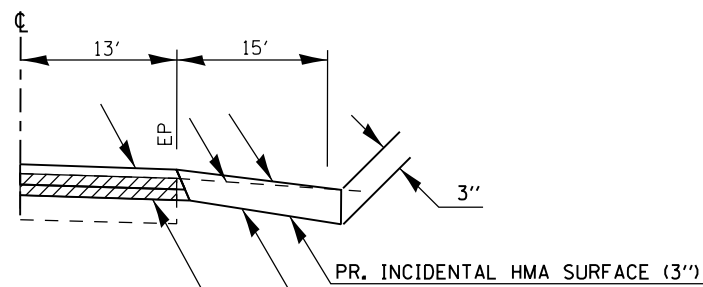

VAR. SHAPING AS DIRECTED BY THE ENGINEER (SEE NOTE 2)

SIDE ROAD SEC. B-B  
EX. AGGREGATE SURFACE  
(SEE NOTE 1)

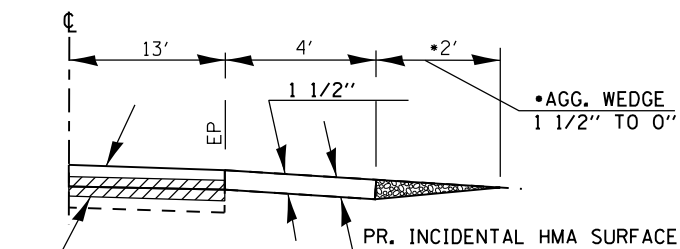

PE, CE SEC. A-A  
EX. AGGREGATE SURFACE WITH BIT. APRON  
•SEE ENTRANCE SCHEDULE FOR QUANTITY.

## NOTES

1. IF EXISTING SUBBASE IS INADEQUATE, AS DETERMINED BY THE ENGINEER, THE SIDE ROADS SHALL BE CORED OUT AND AGGREGATE SUBBASE, TYPE B SHALL BE PLACED FOR BASE. THE COST OF CORING OUT THE SIDE ROAD AND ANY AGGREGATE BASE COURSE SHALL BE PAID FOR AS SPECIFIED IN ART. 109.04 OF THE STANDARD SPECIFICATIONS FOR ROAD AND BRIDGE CONSTRUCTION. IF EXISTING SUBBASE IS DETERMINED TO BE ADEQUATE, THE PREPARATION OF THE BASE SHALL BE CONSTRUCTED ACCORDING TO ARTICLE 406.09.
2. VARIABLE SHAPING IS INCLUDED IN THE COST OF INCIDENTAL HOT-MIX ASPHALT SURFACE.

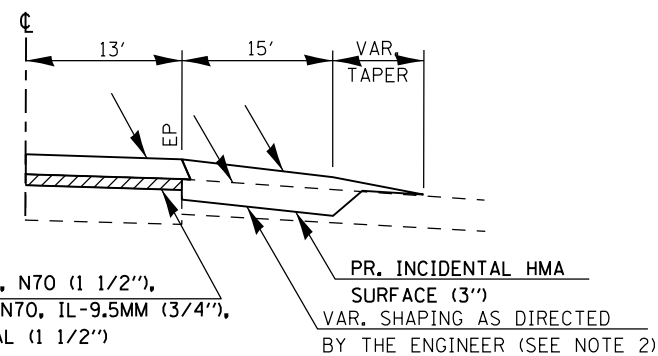

SIDE ROAD SEC. B-B  
EX. OIL & CHIP SURFACE  
(SEE NOTE 1)

FILE NAME =	USER NAME = brandonja	DESIGNED -	REVISED -
pw:\IL\084EBIDINTEG\illinois.gov\PIWIDOT\Documents\DOT Offices\District 9\Projects\78478\Drawings\CAD\Sheets\78478-sha-cvr-seq.dwg		CHECKED -	REVISED -
Default	PLOT DATE = 8/19/2015	DATE -	REVISED -

**STATE OF ILLINOIS  
DEPARTMENT OF TRANSPORTATION**

**DETAIL: SIDE ROAD AND ENTRANCES**

SCALE: SHEET OF SHEETS STA. TO STA.

F.A.P. RTE.	SECTION	COUNTY	TOTAL SHEETS	SHEET NO.
776	102R5-4	HAMILTON	35	32
CONTRACT NO. 78478				
ILLINOIS FED. AID PROJECT				



# TEMPORARY HOT-MIX ASPHALT TRANSITIONS

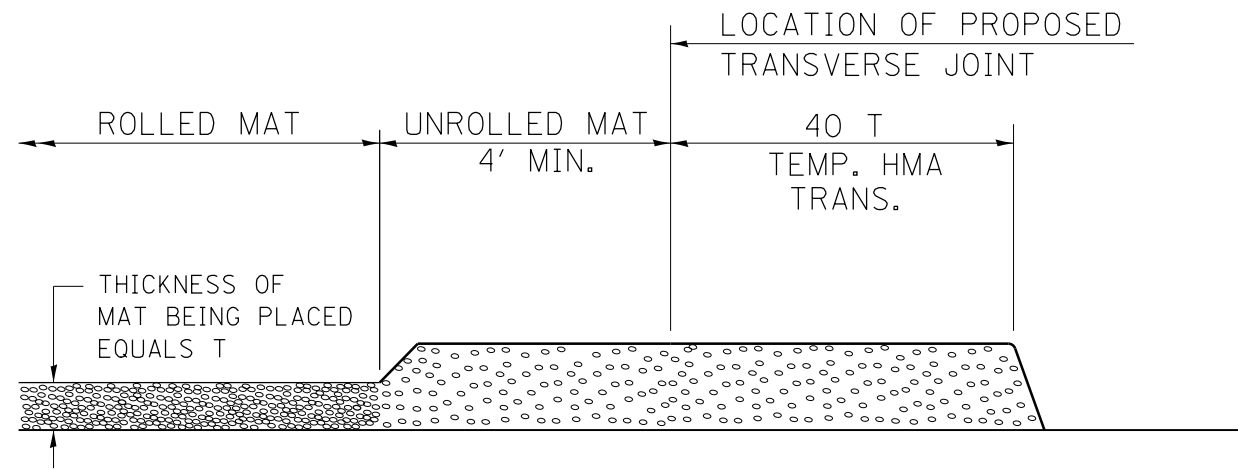

## STEP I

1. PLACE HOT-MIX ASPHALT MAT, LENGTH 40 TIMES THE THICKNESS OF THE MAT BEING PLACED PAST THE PROPOSED TRANSVERSE JOINT LOCATION USING NORMAL OPERATING PROCEDURES.
2. EXTREME CARE SHOULD BE TAKEN TO MAINTAIN ENOUGH MATERIAL IN FRONT OF THE SCREED TO MAINTAIN REQUIRED PAVING DEPTH.

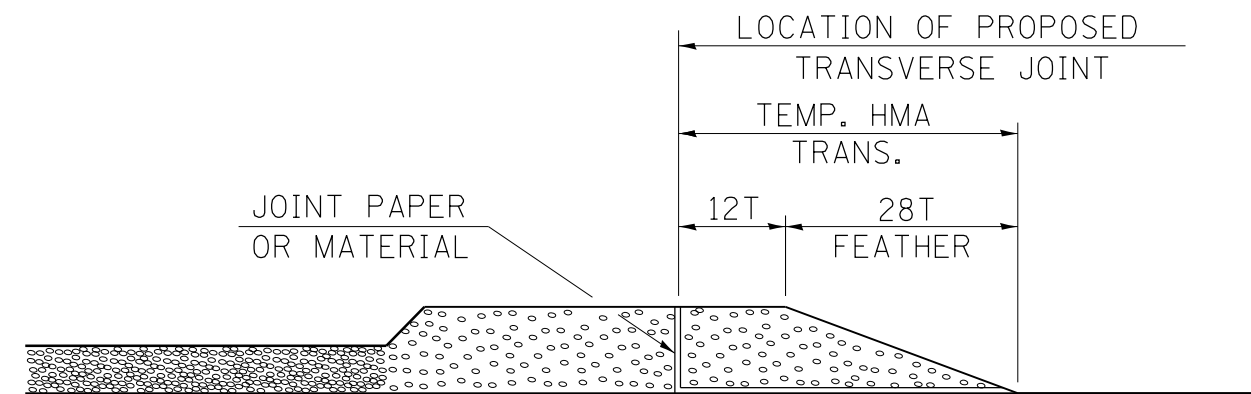

## STEP III

1. JOINT PAPER OR OTHER PRESELECTED JOINT MATERIAL IS THEN PLACED IN THE CLEARED AREA AND THE EXCESS ASPHALT USED TO HAND FORM A TRANSITION TO THE DIMENSIONS SHOWN ABOVE.
2. NOTE THAT IN CONSTRUCTING THE TRANSITION, THE MAT DEPTH IS CONTINUED AS PART OF THE TRANSITION BEFORE FORMING THE FEATHER.

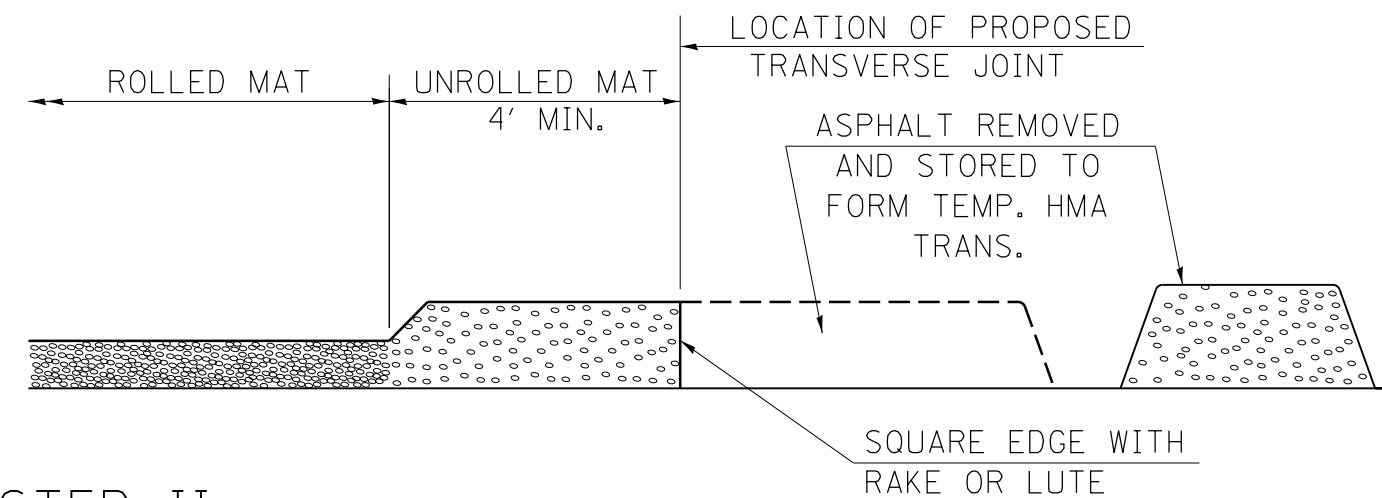

## STEP II

1. MOVE THE PAVER OUT OF THE WAY AND REMOVE THE ASPHALT FROM THE AREA OF THE PROPOSED TEMPORARY HOT-MIX ASPHALT TRANSITION.
2. SQUARE UP THE END OF THE MAT WITH A RAKE OR LUTE.
3. NOTE THAT THE MAT WITHIN 4' OF THE END OF JOINT IS NOT TO BE ROLLED AT THIS TIME.

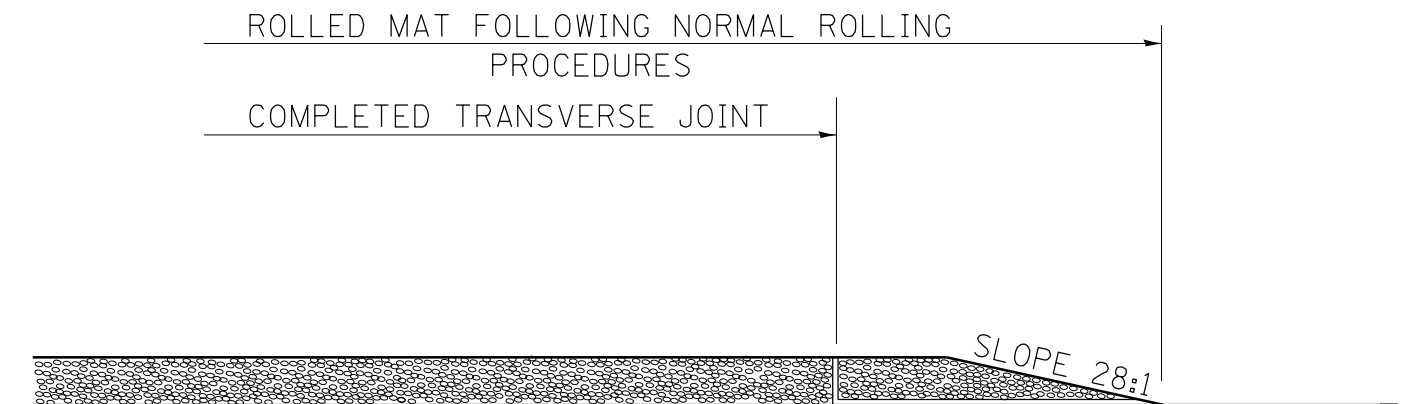

## STEP IV

1. COMPLETE TEMPORARY TRANSITION BY ROLLING.
2. TO RESUME PAVING, AT THE JOINT, REMOVE TEMPORARY TRANSITION AND DISPOSE OF THE MATERIAL ACCORDING TO ART. 202.03 OF THE STD. SPECS. (COST INCLUDED IN THE CONTRACT).
3. CONSTRUCTING THE TEMPORARY TRANSITIONS WILL NOT BE PAID FOR SEPARATELY IN ACCORDANCE WITH ARTICLE 406.14 OF THE STANDARD SPECIFICATIONS.

STD. 9-26

### REVISIONS

REDRAWN	2-15-89
REVISED	8-16-94
REVISED	01-09-07
RESIZED	05-8-08
REVISED	05-16-13

FILE NAME =	USER NAME = brandonja	DESIGNED -	REVISED -
pw:\IL\084EBIDINTEG.illinois.gov\PIWIDOT\Documents\IDOT Offices\District 9\Projects\78478\Drawings\CAD\Sheets\78478-shta-cvr_sq.dwg		DRAWN -	REVISED -
Default	PLOT SCALE = 100.0000' / in.	CHECKED -	REVISED -
	PLOT DATE = 8/19/2015	DATE -	REVISED -

STATE OF ILLINOIS  
DEPARTMENT OF TRANSPORTATION

TEMPORARY HOT-MIX ASPHALT TRANSITIONS

SCALE: SHEET OF SHEETS STA. TO STA.

F.A.P. RTE.	SECTION	COUNTY	TOTAL SHEETS	SHEET NO.
776	102R5-4	HAMILTON	35	33
CONTRACT NO. 78478				
ILLINOIS FED. AID PROJECT				

# UNEVEN LANES SIGN

W8-11 (48'' x 48'')

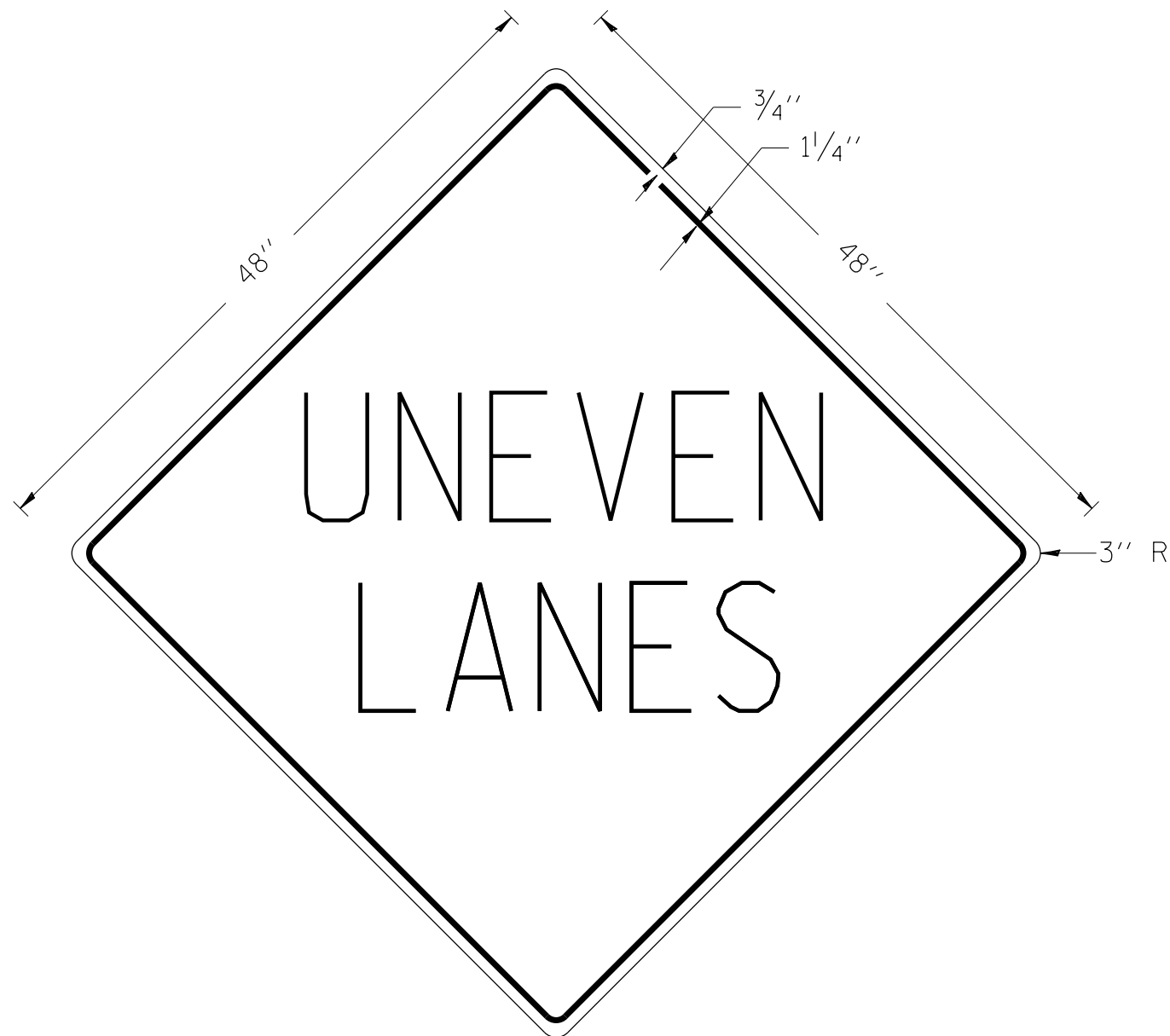

**COLORS:**

LEGEND AND BORDER - BLACK NON-REFLECTORIZED  
 BACKGROUND - ORANGE REFLECTORIZED

**NOTE:** PRIOR TO ALLOWING TRAFFIC ON ANY PORTION OF THE ROADWAY THAT HAS BEEN COLDMILLED OR BEFORE RESURFACING OPERATIONS BEGIN, THE CONTRACTOR SHALL HAVE ERECTED "UNEVEN PAVEMENT" SIGNS THAT CONFORM TO THE ABOVE DETAILS. A MINIMUM OF ONE SIGN AT EACH END OF THE IMPROVEMENT WILL BE REQUIRED. THE CONTRACTOR SHALL MAINTAIN THE "UNEVEN PAVEMENT" SIGNS UNTIL THE RESURFACING OPERATIONS ARE COMPLETED.

IF AT ANY TIME THE SIGNS ARE IN PLACE BUT NOT APPLICABLE, THEY SHALL BE TURNED FROM THE VIEW OF MOTORISTS OR COVERED AS DIRECTED BY THE ENGINEER.

THE COST OF FURNISHING, ERECTING, MAINTAINING, AND REMOVING THE REQUIRED SIGNS SHALL BE INCLUDED IN THE CONTRACT.

REVISIONS

DRAWN	2-15-89
REVISED	4-06-93
REDSIGNED	7-23-04
RESIZED	5-08-08
REVIEWED	5-17-13

STD. 9-41

FILE NAME =	USER NAME = brandonja	DESIGNED -	REVISED -	<b>STATE OF ILLINOIS DEPARTMENT OF TRANSPORTATION</b>	<b>UNEVEN LANES SIGN</b>			F.A.P. RTE.	SECTION	COUNTY	TOTAL SHEETS	SHEET NO.
pw:\IL\084EBIDINTEG\illinois.gov\PIDOT\Documents\IDOT Offices\District 9\Projects\78478\Drawings\CAD\Sheets\78478-sht-cvr_seq.dwg		DRAWN -	REVISED -					776	102RS-4	HAMILTON	35	34
Default	PLOT SCALE = 100.0000' / in.	CHECKED -	REVISED -		SCALE: SHEET OF SHEETS STA. TO STA.			CONTRACT NO. 78478				
	PLOT DATE = 8/19/2015	DATE -	REVISED -		ILLINOIS FED. AID PROJECT							

# ILLINOIS STANDARD

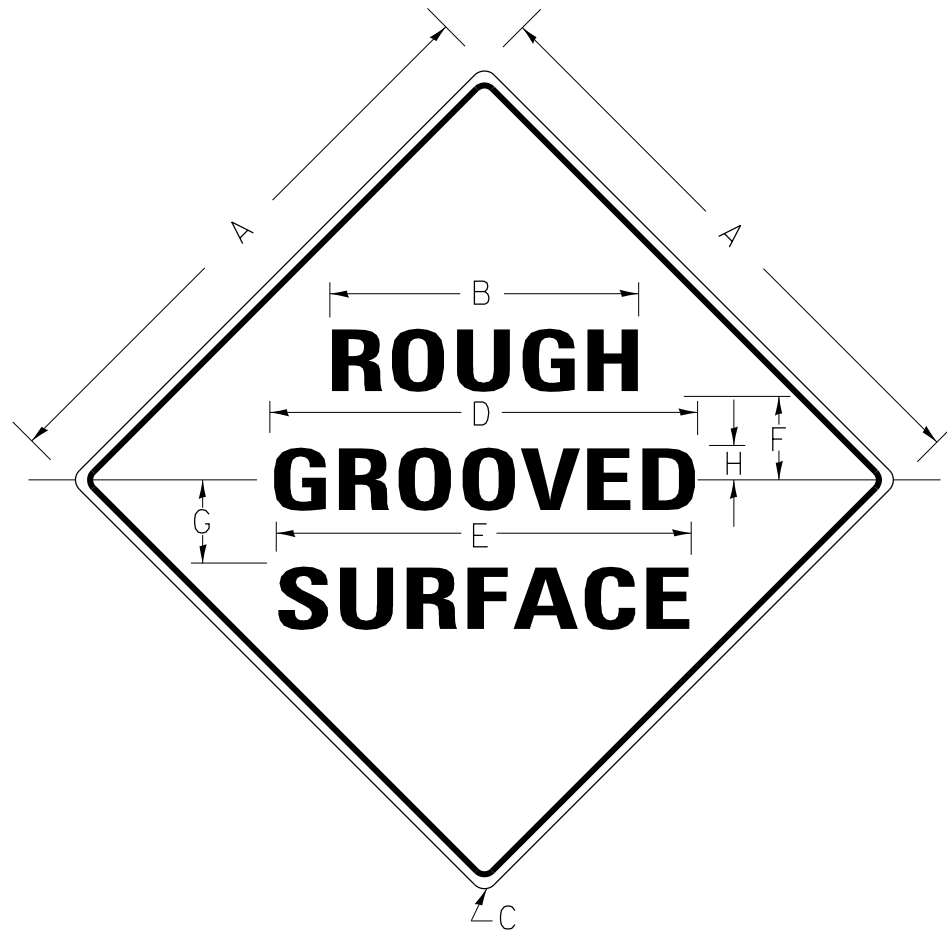

## COLORS:

LEGEND AND BORDER- BLACK NON-REFLECTORIZED  
 BACKGROUND- ORANGE REFLECTORIZED

SIGN SIZE	DIMENSIONS							
	A	B	C	D	E	F	G	H
48X48	48.0	24.1	3.0	34.0	33.0	6.0	13.0	3.5

SIGN SIZE	SERIES LINES			MARGIN	BORDER	BLANK STD.
	1	2	3			
48X48	7C	7C	7C	0.8	1.2	B4-48D

ALL DIMENSIONS IN INCHES

## NOTES:

PRIOR TO ALLOWING TRAFFIC ON ANY PORTION OF THE ROADWAY THAT HAS BEEN COLDMILLED, THE CONTRACTOR SHALL HAVE ERECTED "ROUGH GROOVED SURFACE" SIGNS THAT CONFORM TO THE ABOVE DETAILS. A MINIMUM OF ONE SIGN AT EACH END OF THE IMPROVEMENT WILL BE REQUIRED. THE CONTRACTOR SHALL MAINTAIN THE "ROUGH GROOVED SURFACE" SIGNS UNTIL THE COLDMILLED SURFACE IS COVERED WITH LEVELING BINDER OR SURFACE COURSE.

IF AT ANY TIME THE SIGNS ARE IN PLACE BUT NOT APPLICABLE, THEY SHALL BE TURNED FROM THE VIEW OF MOTORISTS OR COVERED AS DIRECTED BY THE ENGINEER.

THE COST OF FURNISHING, ERECTING, MAINTAINING, AND REMOVING THE REQUIRED SIGNS SHALL BE INCLUDED IN THE CONTRACT.

### REVISIONS

REDRAWN	2-15-89
REVISED	4-6-93
REVISED	3-27-08
REVIEWED	5-17-13

STD. 9-39

FILE NAME =	USER NAME = brandonja	DESIGNED -	REVISED -	<b>STATE OF ILLINOIS DEPARTMENT OF TRANSPORTATION</b>	<b>ROUGH GROOVED SURFACE SIGN</b>				F.A.P. RTE.	SECTION	COUNTY	TOTAL SHEETS	SHEET NO.
pw:\IL\084EBIDINTEG.illinois.gov\PWIDOT\Documents\IDOT Offices\District 9\Projects\78478\Drawings\CAD\Sheets\78478-sht-cvr_seq.dwg	DESIGNED -	REVISED -	REVISED -						776	102R5-4	HAMILTON	35	35
Default	PLOT SCALE = 100.0000' / in.	CHECKED -	REVISED -		SCALE: SHEET OF SHEETS STA. TO STA.				CONTRACT NO. 78478				
	PLOT DATE = 8/19/2015	DATE -	REVISED -		ILLINOIS FED. AID PROJECT								