

STATE OF ILLINOIS  
DEPARTMENT OF TRANSPORTATION

F.A.P. ROUTE	SECTION	COUNTY	TOTAL SHEETS	SHEET NO.
339	2020-094-1	COOK	22	1
		ILLINOIS	CONTRACT NO. 62L72	

FOR INDEX OF SHEETS, SEE SHEET NO. 2

PROPOSED  
HIGHWAY PLANS

FAP ROUTE 339: IL 62 (ALGONQUIN RD.)  
PENNY RD. TO PORT CENTER DR.

SECTION 2020-094-1

CRACK & JOINT SEALING  
COOK COUNTY

C-91-291-20

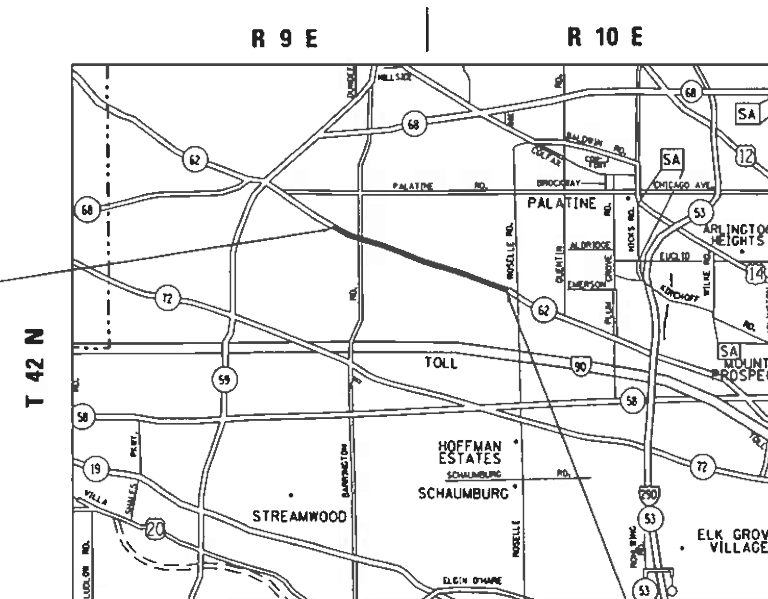
PROJECT LOCATED IN THE VILLAGE OF:  
SOUTH BARRINGTON, PALATINE  
AND HOFFMAN ESTATES

TRAFFIC DATA

ADT 2019: 24700 - 30100 VPD

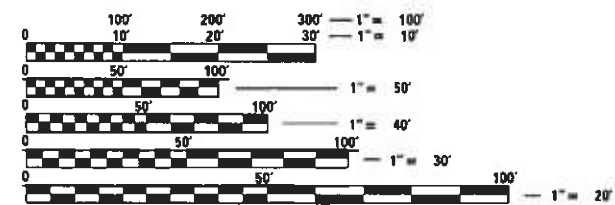
SPEED LIMIT: 45 MPH

PROJECT BEGINS:  
STA. 18 + 35



PROJECT ENDS:  
STA. 207 + 69

GROSS LENGTH = 18,934 FT. = 3.59 MILE  
NET LENGTH = 18,424 FT. = 3.49 MILE



FULL SIZE PLANS HAVE BEEN PREPARED USING STANDARD ENGINEERING SCALES. REDUCED SIZED PLANS WILL NOT CONFORM TO STANDARD SCALES. IN MAKING MEASUREMENTS ON REDUCED PLANS, THE ABOVE SCALES MAY BE USED.

J.U.L.I.E.  
JOINT UTILITY LOCATION INFORMATION FOR EXCAVATORS  
1-800-892-0123  
OR 811

PROJECT ENGINEER: DAN WILGREEN (847) 705-4240  
PROJECT MANAGER: FAWAD AQUEEL (847) 705-4247

CONTRACT NO. 62L72

D-91-493-20



LOCATION OF SECTION INDICATED THIS: - [shaded area]

OMISSIONS:  
STA 135+38 - STA 140+48

STATE OF ILLINOIS  
DEPARTMENT OF TRANSPORTATION

SUBMITTED July 28 20 20  
Anthony J. Danzig/CAB REGIONAL ENGINEER  
October 2, 2020

Scott A. Elk  
ENGINEER OF DESIGN AND ENVIRONMENT  
October 2, 2020  
James J. Gu 13  
DIRECTOR OF HIGHWAYS PROJECT IMPLEMENTATION

PRINTED BY THE AUTHORITY  
OF THE STATE OF ILLINOIS

**INDEX OF SHEETS**

SHEET NO.	DESCRIPTION
1	TITLE SHEET
2	INDEX OF SHEETS, STATE STANDARDS AND GENERAL NOTES
3-4	SUMMARY OF QUANTITIES
5-6	EXISTING CROSS SECTIONS
7-13	PROPOSED PLANS AND PAVEMENT MARKING PLANS
14	CRACK & JOINT SEALING DETAIL
15	CURB OR CURB AND GUTTER REMOVAL AND REPLACEMENT DETAIL (BD-24)
16	TRAFFIC CONTROL AND PROTECTION FOR SIDE ROADS, INTERSECTIONS, AND DRIVEWAYS (TC-10)
17	TYPICAL APPLICATIONS - RAISED REFLECTIVE PAVEMENT MARKERS (SNOW PLOW RESISTANT) (TC-11)
18	DISTRICT ONE TYPICAL PAVEMENT MARKINGS (TC-13)
19	TRAFFIC CONTROL AND PROTECTION AT TURN BAYS (TO REMAIN OPEN TO TRAFFIC) (TC-14)
20	SHORT-TERM PAVEMENT MARKING LETTERS AND SYMBOLS (TC-16)
21	ARTERIAL ROAD INFORMATION SIGNING (TC-22)
22	DRIVEWAY ENTRANCE SIGNING (TC-26)

**STANDARDS**

000001-07	STANDARD SYMBOLS, ABBREVIATIONS AND PATTERNS
442101-09	CLASS B PATCHES
701006-05	OFF ROAD OPERATIONS, 2L, 2W, 15' (4.5 M) TO 24' (600 MM) FROM PAVEMENT EDGE
701101-05	OFF-RD OPERATIONS, MULTILANE, 15' (4.5 m) TO 24" (600 mm) FROM PAVEMENT EDGE
701301-04	LANE CLOSURE, 2L, 2W, SHORT TIME OPERATIONS
701311-03	LANE CLOSURE, 2L, 2W MOVING OPERATIONS- DAY ONLY
701426-09	LANE CLOSURE, MULTILANE, INTERMITTENT OR MOVING OPERATION, FOR SPEEDS > 45 MPH
701427-05	LANE CLOSURE, MULTILANE, INTERMITTENT OR MOVING OPERATIONS, FOR SPEEDS < 40 MPH
701501-06	URBAN LANE CLOSURE, 2L, 2W, UNDIVIDED
701601-09	URBAN LANE CLOSURE, MULTILANE 1W OR 2W WITH NONTRANSVERSABLE MEDIAN
701602-10	URBAN LANE CLOSURE, MULTILANE, 2W WITH BIDIRECTIONAL LEFT TURN LANE
701606-10	URBAN SINGLE LANE CLOSURE, MULTILANE, 2W WITH MOUNTABLE MEDIAN
701701-10	URBAN SINGLE LANE CLOSURE, MULTILANE INTERSECTION
701801-06	SIDEWALK, CORNER OR CROSSWALK CLOSURE
701901-08	TRAFFIC CONTROL DEVICES

**GENERAL NOTES**

- BEFORE STARTING ANY EXCAVATION, THE CONTRACTOR SHALL CALL "J.U.L.I.E.". AT (800) 892-0123 OR 811 FOR FIELD LOCATIONS OF BURIED ELECTRIC, TELEPHONE AND GAS UTILITIES. 48 HOUR NOTIFICATION IS REQUIRED.
- THE CONTRACTOR SHALL COORDINATE CONSTRUCTION ACTIVITIES WITH UTILITY COMPANIES OF THE VILLAGE OF SOUTH BARRINGTON AND VILLAGE OF HOFFMAN ESTATES.
- ALL DAMAGE TO EXISTING PAVEMENT MARKINGS OR RAISED REFLECTIVE PAVEMENT MARKERS OUTSIDE THE REMOVAL LINE SHOWN ON THE PLANS SHALL BE REPLACED AT NO ADDITIONAL COST TO THE DEPARTMENT.
- THE CONTRACTOR WILL NOT BE ALLOWED TO SET UP A YARD OR FIELD OFFICE ON STATE PROPERTY WITHOUT WRITTEN PERMISSION FROM THE DEPARTMENT.
- IT SHALL BE THE CONTRACTOR'S RESPONSIBILITY TO VERIFY ALL DIMENSIONS AND CONDITIONS EXISTING IN THE FIELD PRIOR TO CONSTRUCTION AND ORDERING OF MATERIALS.
- THE CONTRACTOR SHALL CONTACT THE DISTRICT ONE TRAFFIC CONTROL SUPERVISOR VIA EMAIL [Kalpana.Kannan-Hosadurga@illinois.gov](mailto:Kalpana.Kannan-Hosadurga@illinois.gov) (FOR ARTERIALS) AND (847) 705-4151 (FOR EXPRESSWAYS) A MINIMUM OF 72 HOURS IN ADVANCE OF BEGINNING WORK.
- ALL CRACK ROUTING & CRACK SEALING LOCATIONS WILL BE DETERMINATED IN THE FIELD BY TH ENGINEER.
- CRACK ROUTING SHALL BE OMITTED WHERE VEHICLE DETECTOR LOOPS AND RAISED REFLECTIVE PAVEMENT MARKERS ARE PRESENT IN THE FIELD.
- MODIFIED URETHANE PAVEMENT MARKING SHALL BE PLACED IMMEDIATELY AFTER CRACK & SEALER TEMPERATURE HAS COOLED DOWN AND DOES NOT AFFECT THE APPLICATION OF MODIFIED PAVEMENT MARKERS
- THE ENGINEER SHALL CONTACT JOE ECKERT AREA TRAFFIC FIELD ENGINEER AT (847) 705-4412 A MINIMUM OF TWO (2) WEEKS PRIOR TO THE PLACEMENT OF PERMANENT PAVEMENT MARKINGS.
- THE CONTRACTOR SHALL BE REQUIRED TO PROVIDE ACCESS TO ABUTTING PROPERTY AT ALL TIMES DURING THE CONSTRUCTION OF THIS PROJECT.
- DO NOT SCALE PLANS FOR CONSTRUCTION DIMENSIONS.

STATE OF ILLINOIS  
DEPARTMENT OF TRANSPORTATION

INDEX OF SHEETS, STATE STANDARDS AND GENERAL NOTES  
IL ROUTE 62 (ALGONQUIN RD.) (PENNY RD. TO PORT CENTER DR.)

SCALE: SHEET OF SHEETS STA. TO STA.

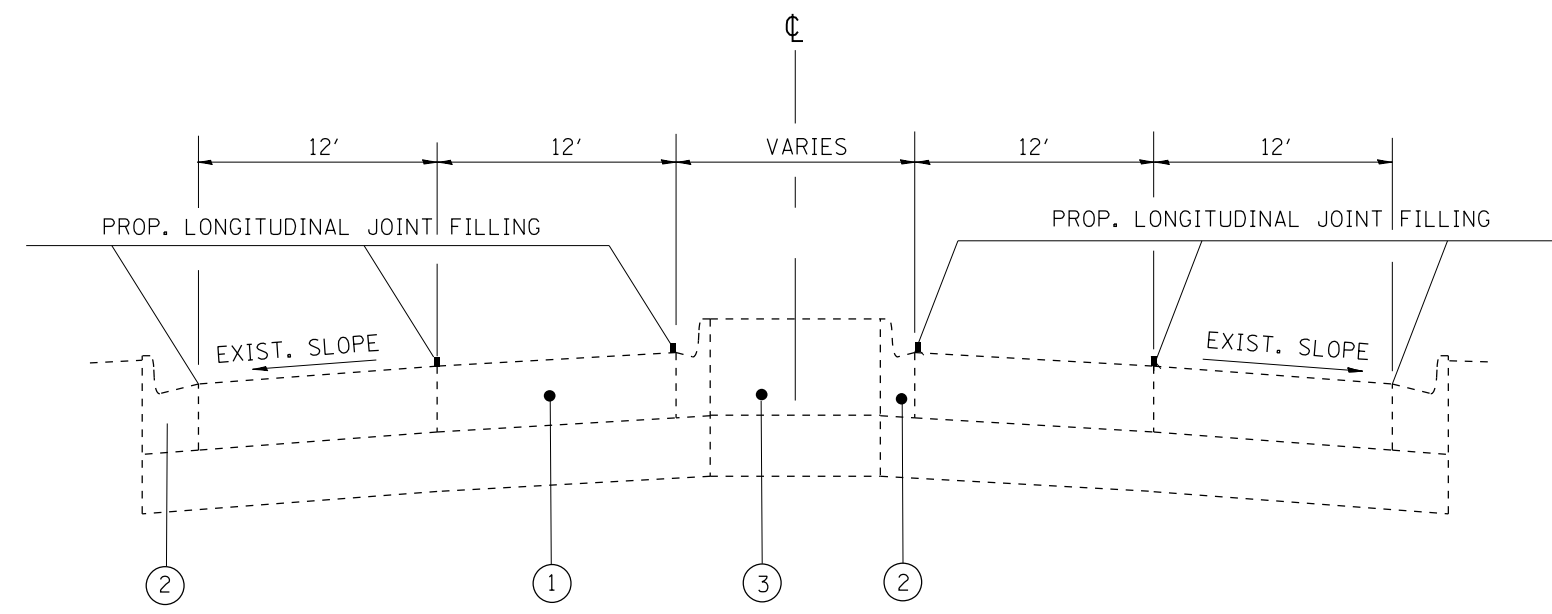
F.A.P. RTE.	SECTION	COUNTY	TOTAL SHEETS	SHEET NO.
393	2020-094-I	COOK	22	2
CONTRACT NO. 62L72				
ILLINOIS FED. AID PROJECT				

SUMMARY OF QUANTITIES				CONSTRUCTION TYPE CODE						SUMMARY OF QUANTITIES				CONSTRUCTION TYPE CODE					
CODE NO	ITEM	UNIT	TOTAL QUANTITIES URBAN	0005						CODE NO	ITEM	UNIT	TOTAL QUANTITIES URBAN	0005					
				100% STATE										100% STATE					
20101400	NITROGEN FERTILIZER NUTRIENT	POUND	16	16						70102625	TRAFFIC CONTROL AND PROTECTION,	L SUM	1	1					
20101500	PHOSPHORUS FERTILIZER NUTRIENT	POUND	16	16						70102630	TRAFFIC CONTROL AND PROTECTION,	L SUM	1	1					
20101600	POTASSIUM FERTILIZER NUTRIENT	POUND	16	16							STANDARD 701601								
20101700	SUPPLEMENTAL WATERING	UNIT	8	8						70102632	TRAFFIC CONTROL AND PROTECTION,	L SUM	1	1					
											STANDARD 701602								
21101615	TOPSOIL FURNISH AND PLACE, 4"	SO YD	800	800						70102635	TRAFFIC CONTROL AND PROTECTION,	L SUM	1	1					
											STANDARD 701701								
25200110	SODDING, SALT TOLERANT	SO YD	800	800						70102640	TRAFFIC CONTROL AND PROTECTION,	L SUM	1	1					
44200970	CLASS B PATCHES, TYPE II, 10 INCH	SO YD	307	307							STANDARD 701801								
44200974	CLASS B PATCHES, TYPE III, 10 INCH	SO YD	307	307					*	78009000	MODIFIED URETHANE PAVEMENT MARKING -	SO FT	1607	1607					
											LETTERS AND SYMBOLS								
44200976	CLASS B PATCHES, TYPE IV, 10 INCH	SO YD	307	307					*	78009004	MODIFIED URETHANE PAVEMENT MARKING -	FOOT	52666	52666					
44201299	DOWEL BARS 1 1/2"	EACH	960	960							LINE 4"								
44213200	SAW CUTS	FOOT	4900	4900					*	78009006	MODIFIED URETHANE PAVEMENT MARKING -	FOOT	8314	8314					
											LINE 6"								
45200100	JOINT OR CRACK ROUTING (PC CONCRETE PAVEMENT AND SHOULDER)	FOOT	12707	12707					*	78009012	MODIFIED URETHANE PAVEMENT MARKING -	FOOT	1673	1673					
											LINE 12"								
45200300	JOINT OR CRACK FILLING	POUND	36303	36303					*	78009024	MODIFIED URETHANE PAVEMENT MARKING -	FOOT	1067	1067					
											LINE 24"								
67000400	ENGINEER'S FIELD OFFICE, TYPE A	CAL MO	12	12						X4400501	COMBINATION CURB AND GUTTER REMOVAL AND	FOOT	1800	1800					
67100100	MOBILIZATION	L SUM	1	1							REPLACEMENT LESS THAN OR EQUAL TO 10 FEET								
																			REV-SEP
																			• = SPECIALTY ITEMS

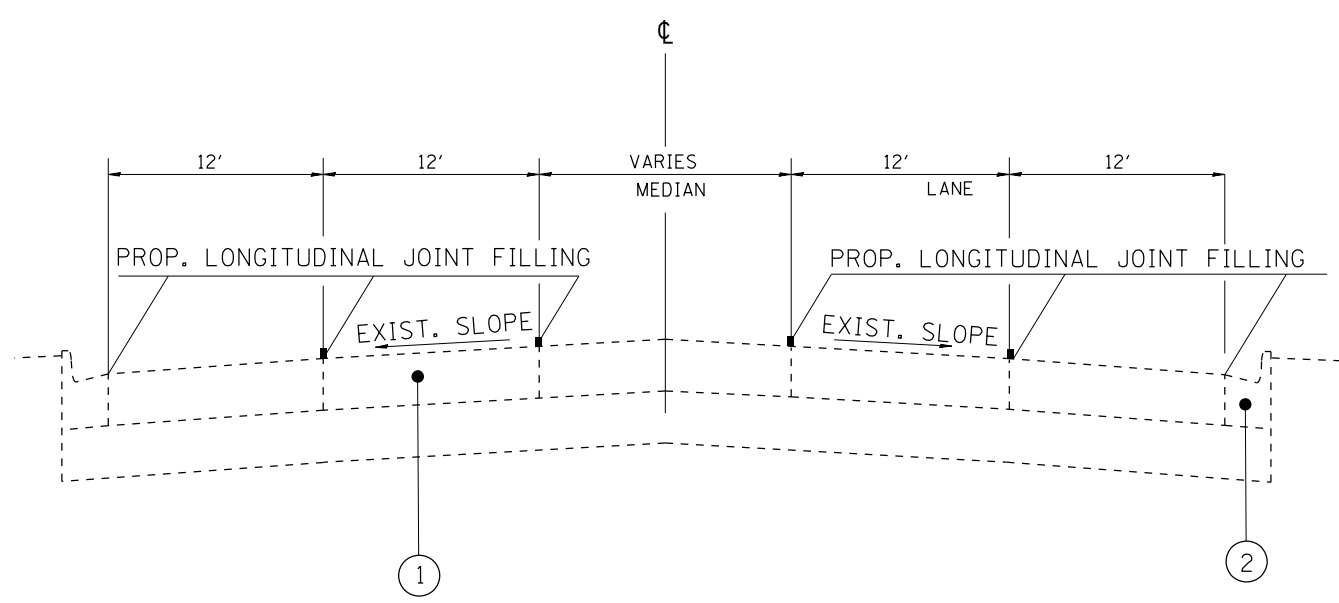


**LEGEND**

- ① EXISTING PORTLAND CEMENT CONCRETE PAVEMENT - 9 3/4"
- ② EXISTING CURB AND GUTTER
- ③ EXISTING CONCRETE MEDIAN



**TYPICAL SECTION  
WITH CONCRETE MEDIAN**



**TYPICAL SECTION  
WITH PAINTED MEDIAN**

MODEL: Default  
 FILE: h:\mfc\_p\pub\harcourt\dot\Documents\DOT\_Offices\Draft\1\Project\149270\CADD\Drawings\149270-sh-cv-pla.dgn

USER NAME = abunaimtm	DESIGNED -	REVISED -
PLOT SCALE = 100.0000' / in.	DRAWN -	REVISED -
PLOT DATE = 8/14/2020	CHECKED -	REVISED -
	DATE -	REVISED -

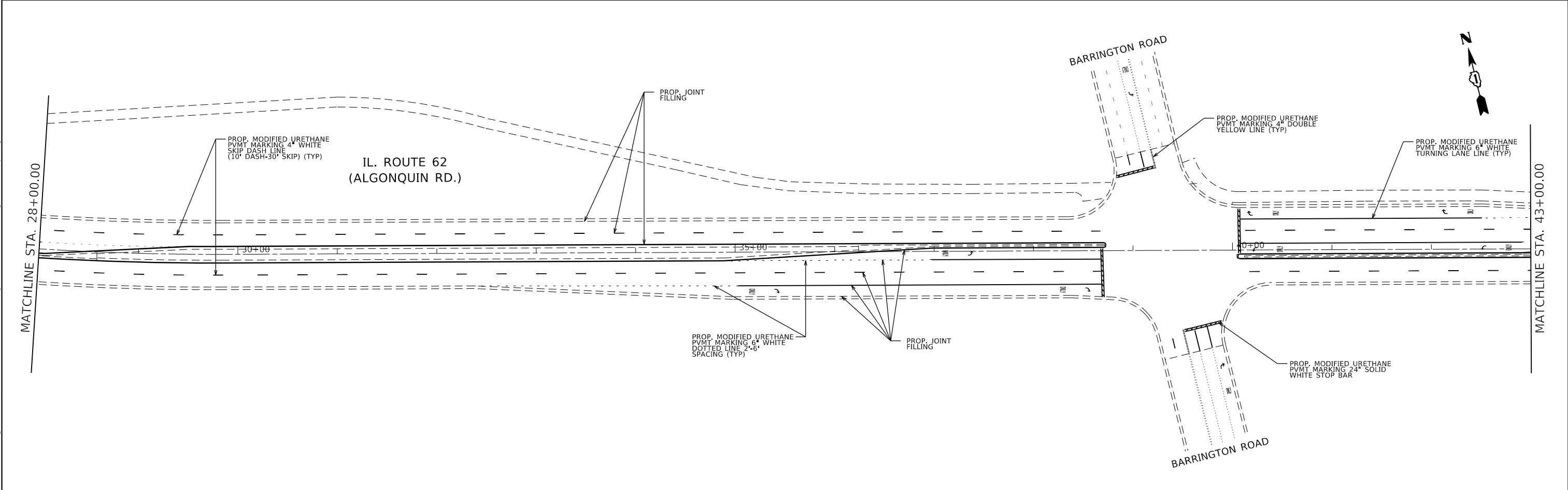
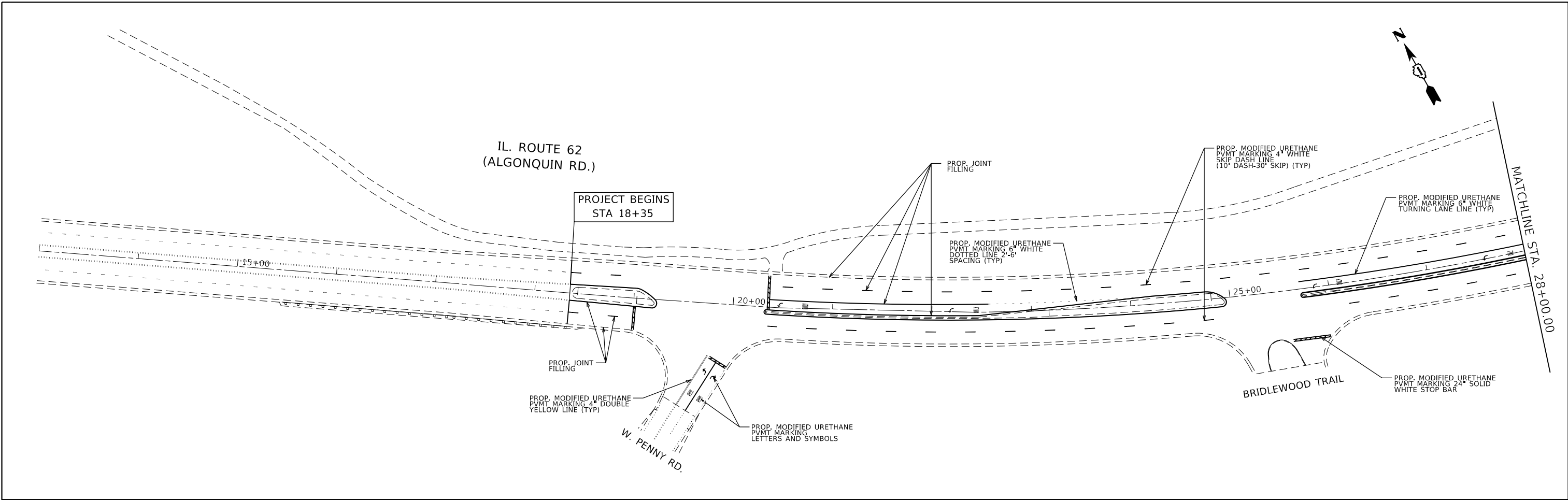
**STATE OF ILLINOIS  
DEPARTMENT OF TRANSPORTATION**

**EXISTING ROADWAY CROSS SECTION  
IL ROUTE 62 (ALGONQUIN RD.) (PENNY RD. TO PORT CENTER DR.)**

SCALE: SHEET OF SHEETS STA. TO STA.

F.A.P. RTE.	SECTION	COUNTY	TOTAL SHEETS	SHEET NO.
	2020-094-I	COOK	22	5
CONTRACT NO. 62L72				
ILLINOIS FED. AID PROJECT				





MODEL: Default  
 FILE: \\blm\c:\pub\blm\room\dat\illinois\pwr\pww\DOT\Documents\DOT\_Offices\Dat\refc\_1\Projects\149220\CADD\Drawings\149220-sh-4-lb-5.dgn

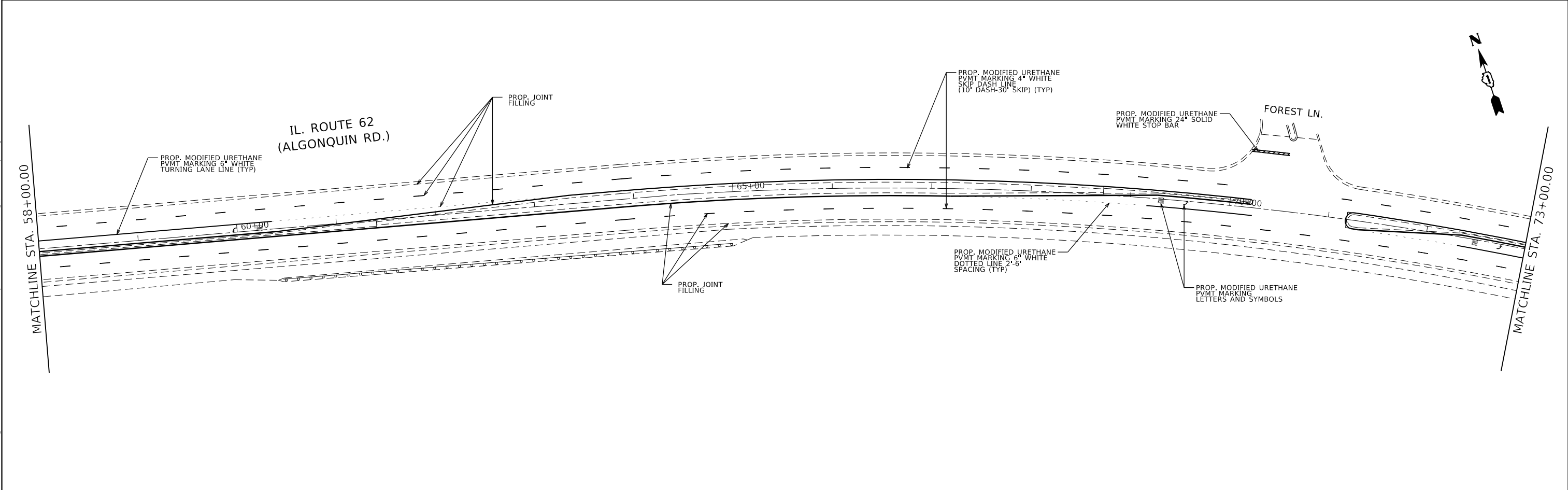
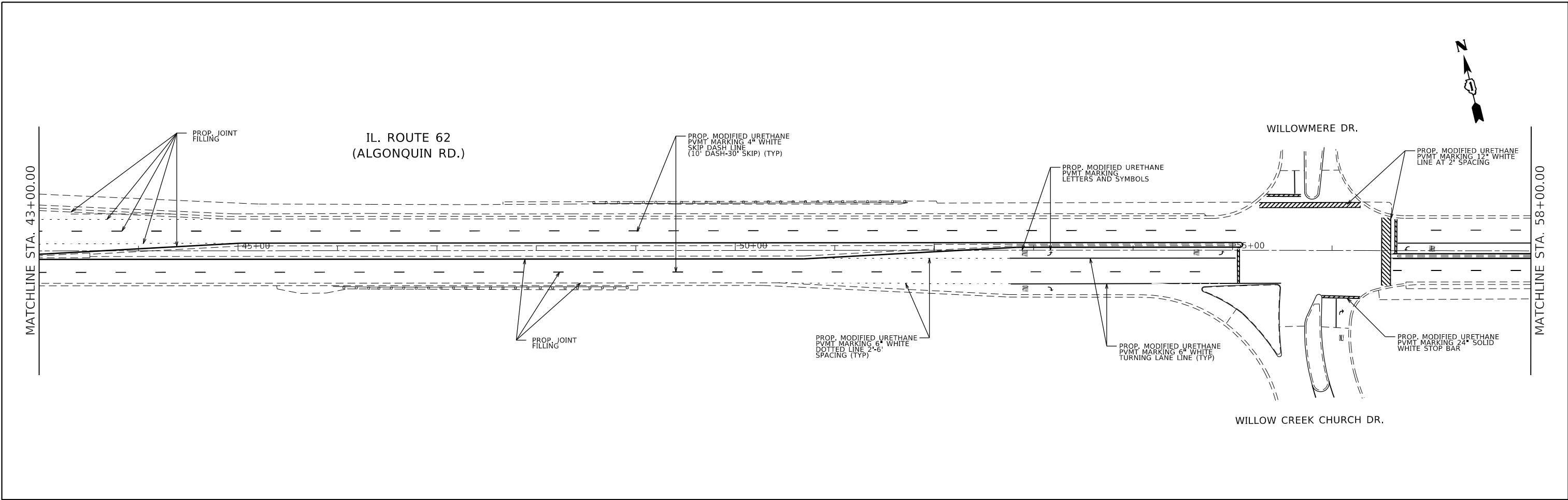
USER NAME = abunaimtm	DESIGNED -	REVISED -
PLOT SCALE = 100,0000' / in.	DRAWN -	REVISED -
PLOT DATE = 8/14/2020	CHECKED -	REVISED -
	DATE -	REVISED -

**STATE OF ILLINOIS**  
**DEPARTMENT OF TRANSPORTATION**

**EXISTING AND PROPOSED PLAN**  
**IL. ROUTE 62 (ALGONQUIN RD.) (PENNY RD. TO PORT CENTER DR.)**

SCALE: 1" = 50'      SHEET      OF 7      SHEETS      STA.      TO STA.

F.A.P. RTE. 339	SECTION 2020-094-I	COUNTY COOK	TOTAL SHEETS 22	SHEET NO. 7
CONTRACT NO. 62L72				
ILLINOIS FED. AID PROJECT				



MODEL: Default  
 FILE: h:\mhc\p\pub\barroom.dwg  
 PROJECT: 149220\CaddData\Design\149220-sh-1-bar.dwg

USER NAME = abunaimtm	DESIGNED -	REVISED -
PLOT SCALE = 100,0000' / in.	DRAWN -	REVISED -
PLOT DATE = 8/14/2020	CHECKED -	REVISED -
	DATE -	REVISED -

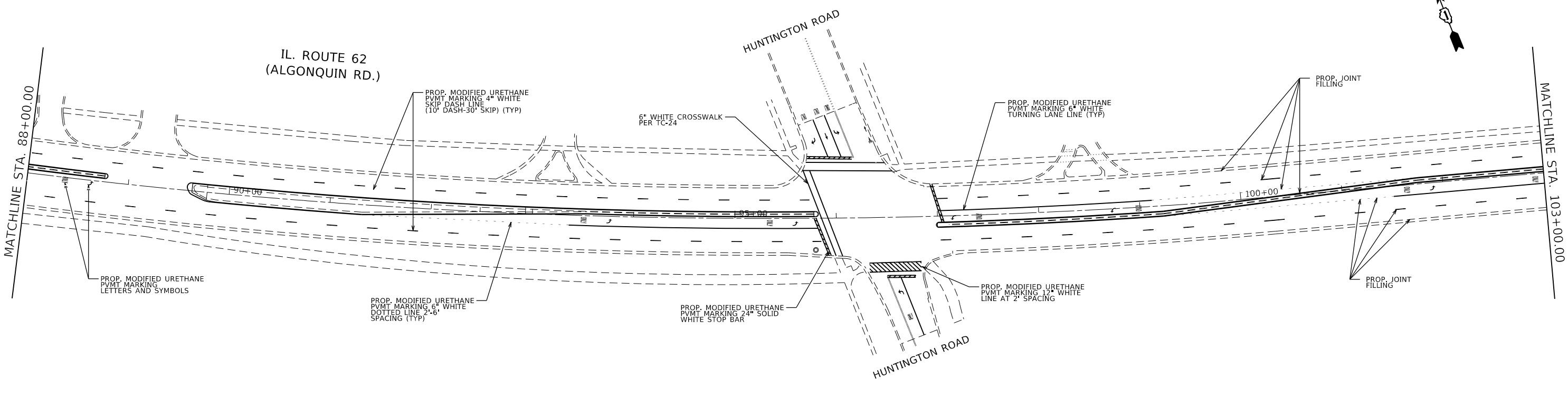
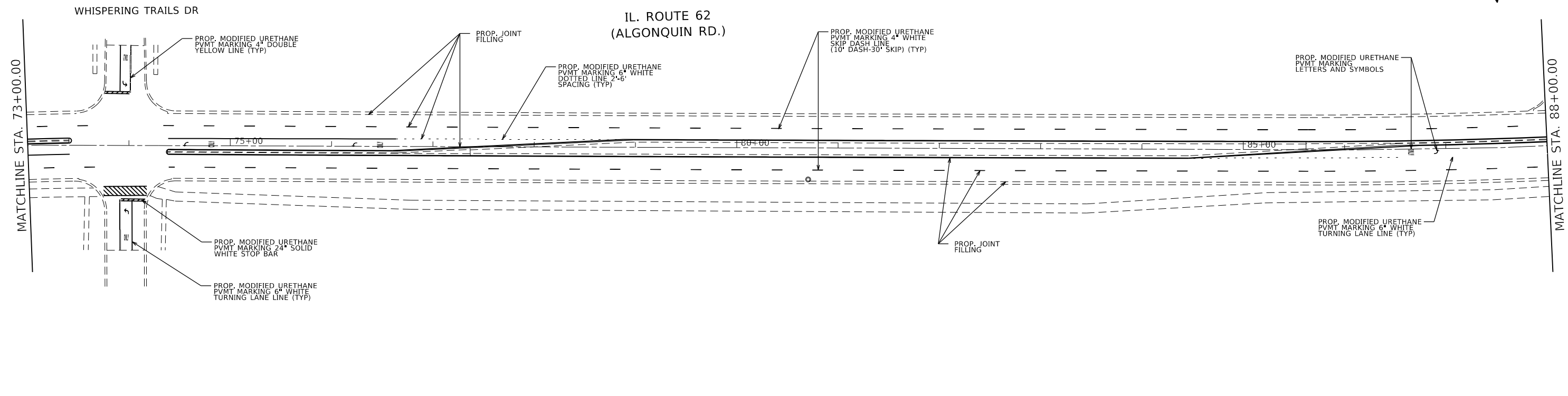
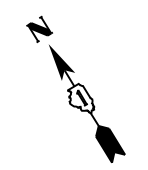
**STATE OF ILLINOIS**  
**DEPARTMENT OF TRANSPORTATION**

**EXISTING AND PROPOSED PLAN**  
**IL. ROUTE 62 (ALGONQUIN RD.) (PENNY RD. TO PORT CENTER DR.)**

F.A.P. RTE. 339	SECTION 2020-094-I	COUNTY COOK	TOTAL SHEETS 22	SHEET NO. 8
CONTRACT NO. 62L72				
ILLINOIS FED. AID PROJECT				

SCALE: 1"= 50'    SHEET    OF    SHEETS    STA.    TO    STA.





MODEL: Default  
 FILE: h:\mhc\p\suplanroom\dat\illroads\gov\PIWIDOT\Documents\IBOT\_Offices\IBOT\1\Projects\149220\CADD\Drawings\149220-sh-c-lb-01.dgn

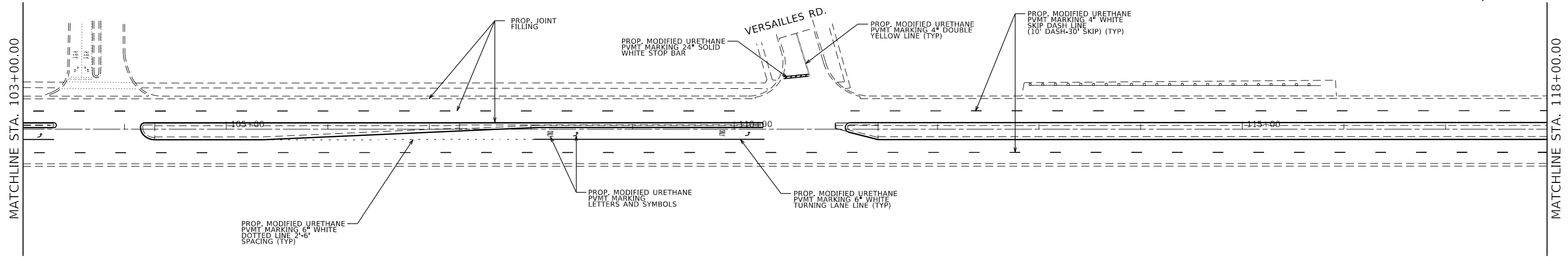
USER NAME = abunaimtm	DESIGNED -	REVISED -
	DRAWN -	REVISED -
PLOT SCALE = 100,0000' / in.	CHECKED -	REVISED -
PLOT DATE = 8/14/2020	DATE -	REVISED -

**STATE OF ILLINOIS**  
**DEPARTMENT OF TRANSPORTATION**

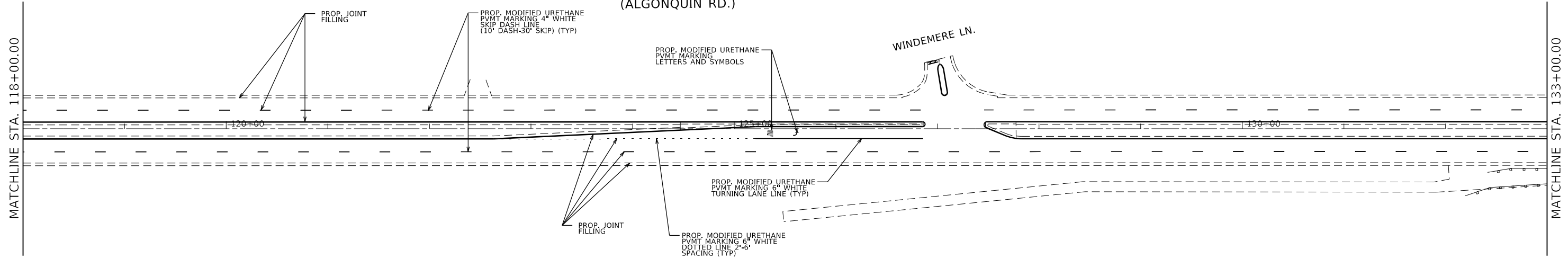
**EXISTING AND PROPOSED PLAN**  
**IL. ROUTE 62 (ALGONQUIN RD.) (PENNY RD. TO PORT CENTER DR.)**  
 SCALE: 1" = 50'    SHEET    OF    SHEETS    STA.    TO    STA.

F.A.P. RTE.	SECTION	COUNTY	TOTAL SHEETS	SHEET NO.
339	2020-094-I	COOK	22	9
CONTRACT NO. 62L72				
ILLINOIS FED. AID PROJECT				

IL. ROUTE 62  
(ALGONQUIN RD.)



IL. ROUTE 62  
(ALGONQUIN RD.)



MODEL: Default  
 FILE: Abunai\GIS\_Plan\planroom.dwg  
 PROJECT: 149220\CD\Drawings\DOT\_Offices\Drawings\149220\Sheet\plan.dwg

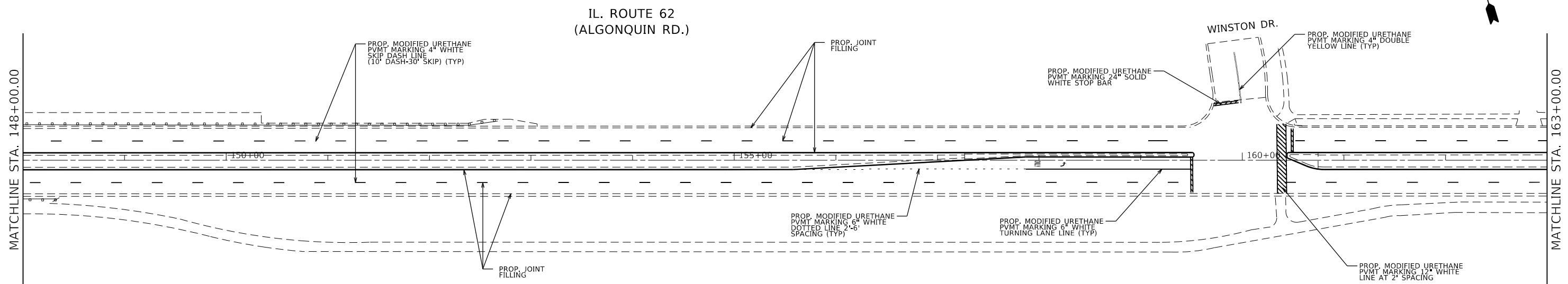
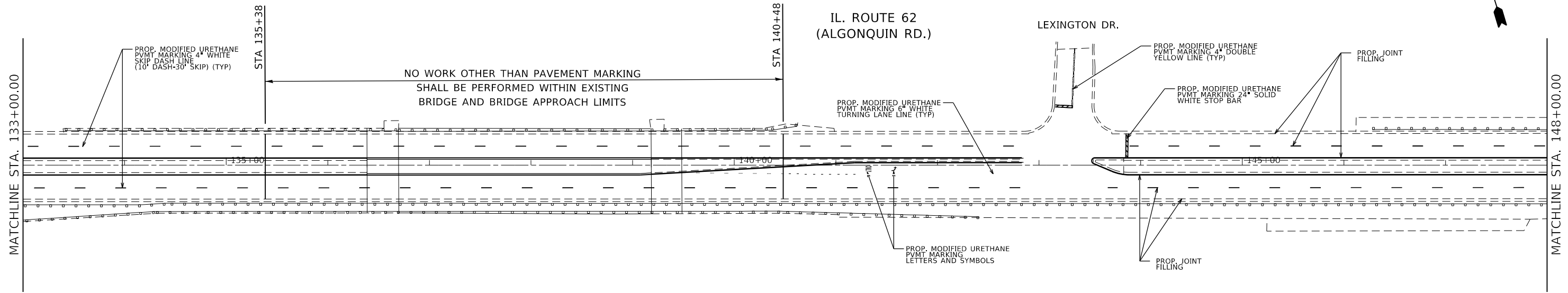
USER NAME = abunaimtm	DESIGNED -	REVISED -
	DRAWN -	REVISED -
PLOT SCALE = 100,0000 ' / in.	CHECKED -	REVISED -
PLOT DATE = 8/14/2020	DATE -	REVISED -

**STATE OF ILLINOIS  
DEPARTMENT OF TRANSPORTATION**

**EXISTING AND PROPOSED PLAN  
IL. ROUTE 62 (ALGONQUIN RD.) (PENNY RD. TO PORT CENTER DR.)**

SCALE: 1" = 50'    SHEET    OF    SHEETS    STA.    TO    STA.

F.A.P. RTE.	SECTION	COUNTY	TOTAL SHEETS	SHEET NO.
339	2020-094-I	COOK	22	10
CONTRACT NO. 62L72				
ILLINOIS FED. AID PROJECT				



MODEL: Default  
 FILE: h:\mhc\p\pub\harcam\dot\office\dot\Documents\DOT\_Offices\dot\1\Projects\149220\CADD\Drawings\149220-sh-1-bn.dgn

USER NAME = abunaimtm	DESIGNED -	REVISED -
DRAWN -	REVISED -	
PLOT SCALE = 100.0000' / in.	CHECKED -	REVISED -
PLOT DATE = 8/14/2020	DATE -	REVISED -

**STATE OF ILLINOIS**  
**DEPARTMENT OF TRANSPORTATION**

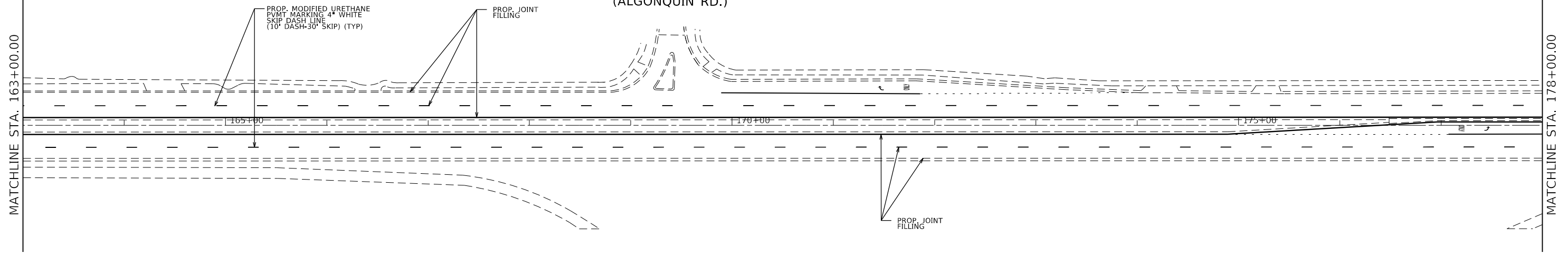
**EXISTING AND PROPOSED PLAN**  
**IL. ROUTE 62 (ALGONQUIN RD.) (PENNY RD. TO PORT CENTER DR.)**

SCALE: 1" = 50'      SHEET      OF      SHEETS      STA.      TO      STA.

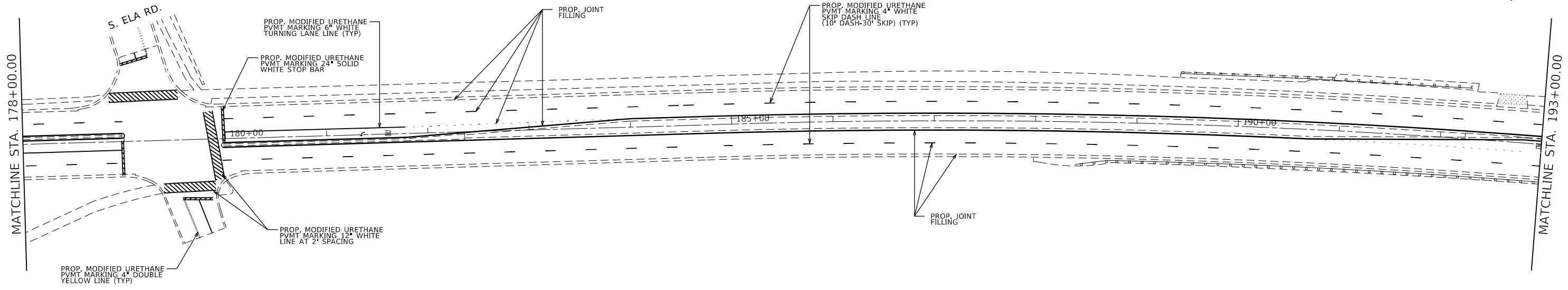
F.A.P. RTE.	SECTION	COUNTY	TOTAL SHEETS	SHEET NO.
339	2020-094-I	COOK	22	11
CONTRACT NO. 62L72				
ILLINOIS FED. AID PROJECT				



IL. ROUTE 62  
(ALGONQUIN RD.)



IL. ROUTE 62  
(ALGONQUIN RD.)



MODEL: Default  
 FILE: Abunaitm.ctb  
 PROJECT: 149220\CD\DOT\Documents\DOT\_Offices\District\_1\Projects\149220\CD\DOT\Design\149220-sh-4-lb.dgn

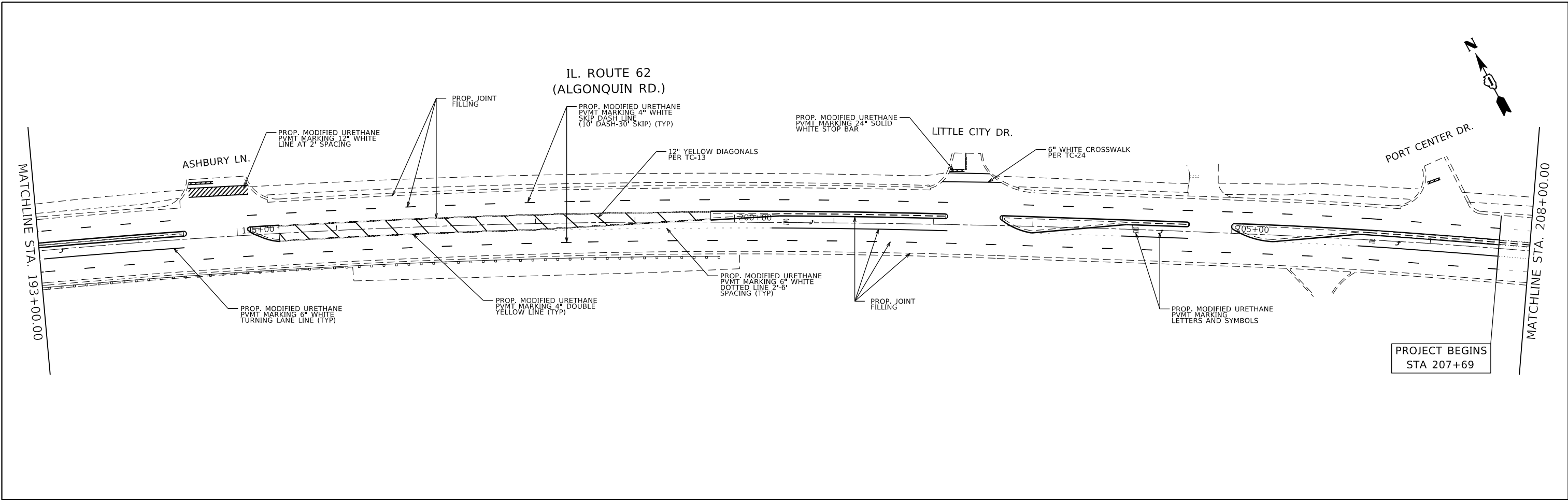
USER NAME = abunaitm	DESIGNED -	REVISED -
PLOT SCALE = 100,0000' / in.	DRAWN -	REVISED -
PLOT DATE = 8/14/2020	CHECKED -	REVISED -
	DATE -	REVISED -

STATE OF ILLINOIS  
DEPARTMENT OF TRANSPORTATION

EXISTING AND PROPOSED PLAN  
IL. ROUTE 62 (ALGONQUIN RD.) (PENNY RD. TO PORT CENTER DR.)

SCALE: 1" = 50'      SHEET      OF      SHEETS      STA.      TO      STA.

F.A.P. RTE. 339	SECTION 2020-094-I	COUNTY COOK	TOTAL SHEETS 22	SHEET NO. 12
CONTRACT NO. 62L72				ILLINOIS FED. AID PROJECT



MODEL: Default  
 FILE: \\blm1c1.pw.uspbarn.com\data\illinois.gov\PW\DOT\Documents\DOT\_Offices\District\_1\Projects\149220\CADD\Design\149220-sh-01-lb-01.dgn

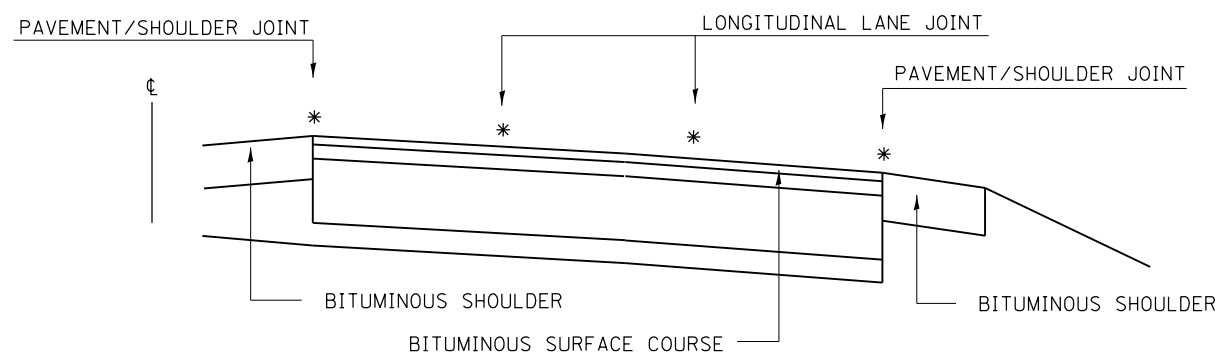
USER NAME = abunaimtm	DESIGNED -	REVISED -
	DRAWN -	REVISED -
PLOT SCALE = 100,0000' / in.	CHECKED -	REVISED -
PLOT DATE = 8/14/2020	DATE -	REVISED -

**STATE OF ILLINOIS  
DEPARTMENT OF TRANSPORTATION**

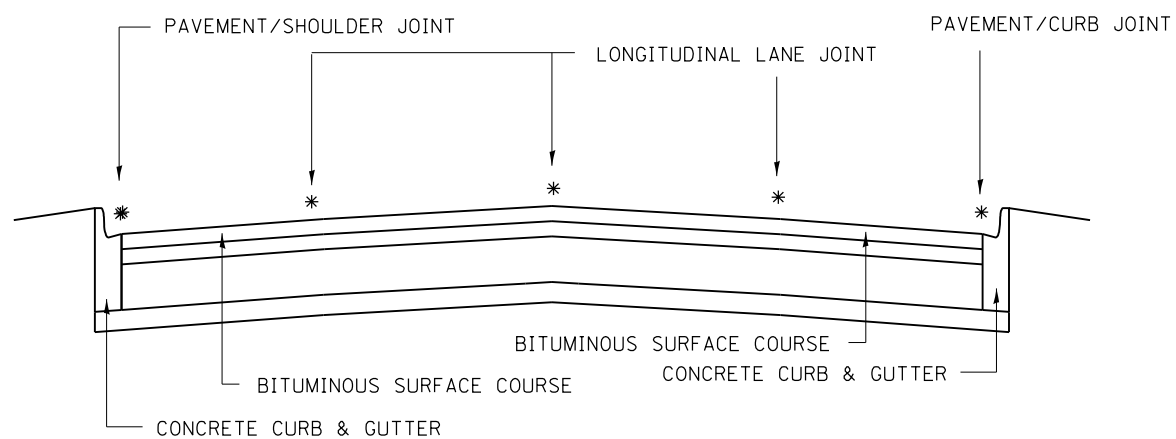
**EXISTING AND PROPOSED PLAN  
IL. ROUTE 62 (ALGONQUIN RD.) (PENNY RD. TO PORT CENTER DR.)**

SCALE: 1" = 50'      SHEET      OF      SHEETS      STA.      TO      STA.

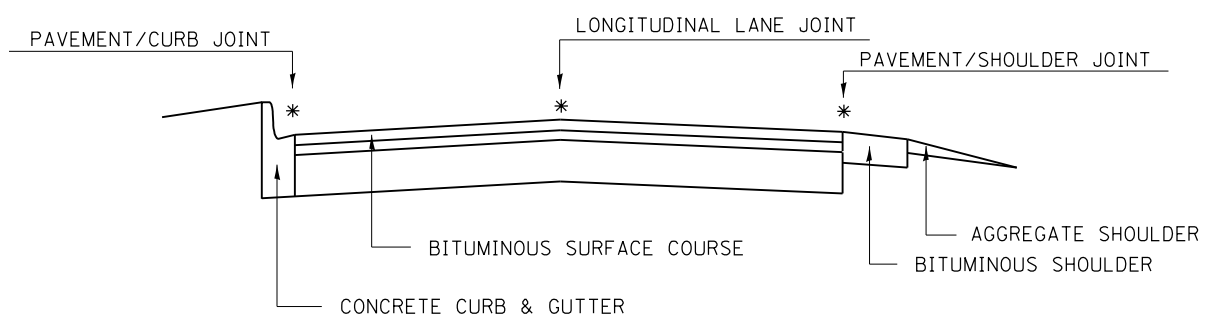
F.A.P. RTE.	SECTION	COUNTY	TOTAL SHEETS	SHEET NO.
339	2020-094-I	COOK	22	13
CONTRACT NO. 62L72				
ILLINOIS FED. AID PROJECT				



MULTI-LANE DIVIDED PAVEMENT



MULTI-LANE UNDIVIDED PAVEMENT

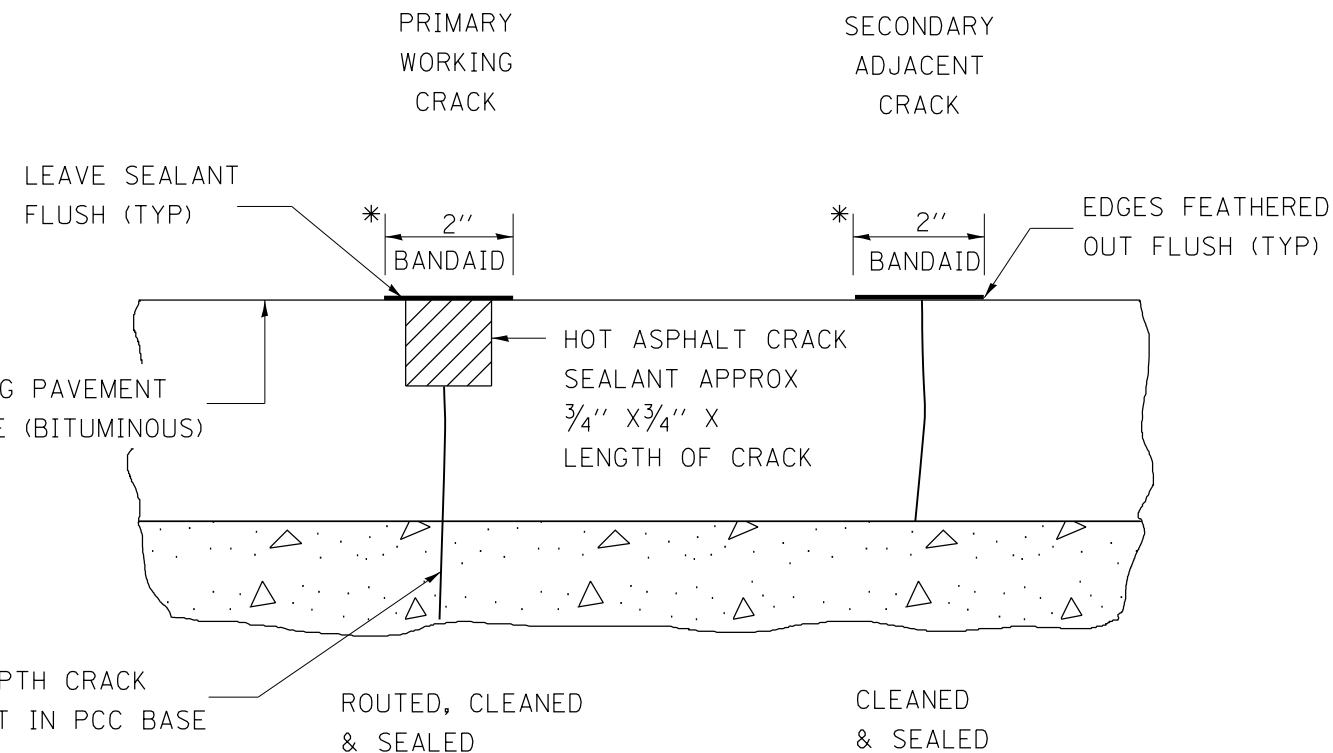


TWO-LANE PAVEMENT

PROPOSED TRANSVERSE CRACK ROUTING (PAVEMENT) & CRACK FILLING LOCATIONS NOT SHOWN

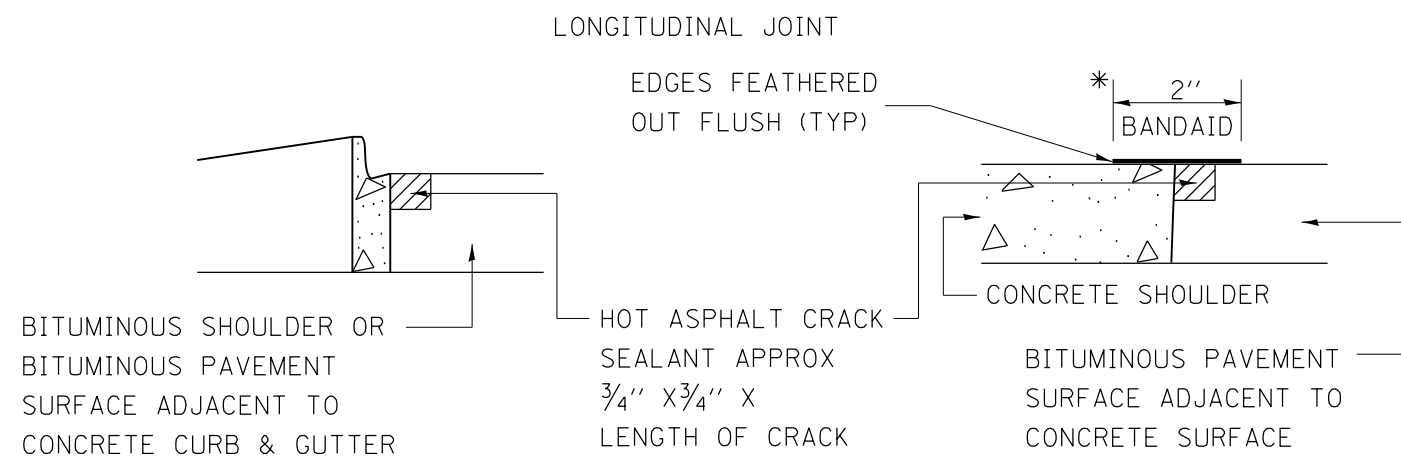
\* PROPOSED LONGITUDINAL CRACK ROUTING (PAVEMENT) & CRACK FILLING LOCATIONS

GENERAL EXISTING TYPICAL SECTIONS



\*

IN ALL LOCATIONS WHERE THE LONGITUDINAL CRACK CONFLICTS WITH EXISTING PAVEMENT MARKINGS (EITHER EDGE LINE OR LANE LINE) THE CRACK SHALL BE ROUTED & THE RESULTING RESERVOIR FILLED WITH SEALANT. ALL DAMAGES TO EXISTING RAISED REFLECTIVE PAVEMENT MARKERS SHALL BE REPLACED AT THE EXPENSE OF THE CONTRACTOR. ALL EXISTING PAVEMENT MARKINGS WITHIN THE PROJECT LIMITS SHALL BE RESTORED WITH HOT SPRAY THERMOPLASTIC PAVEMENT MARKINGS.



CRACK & JOINT SEALING DETAIL

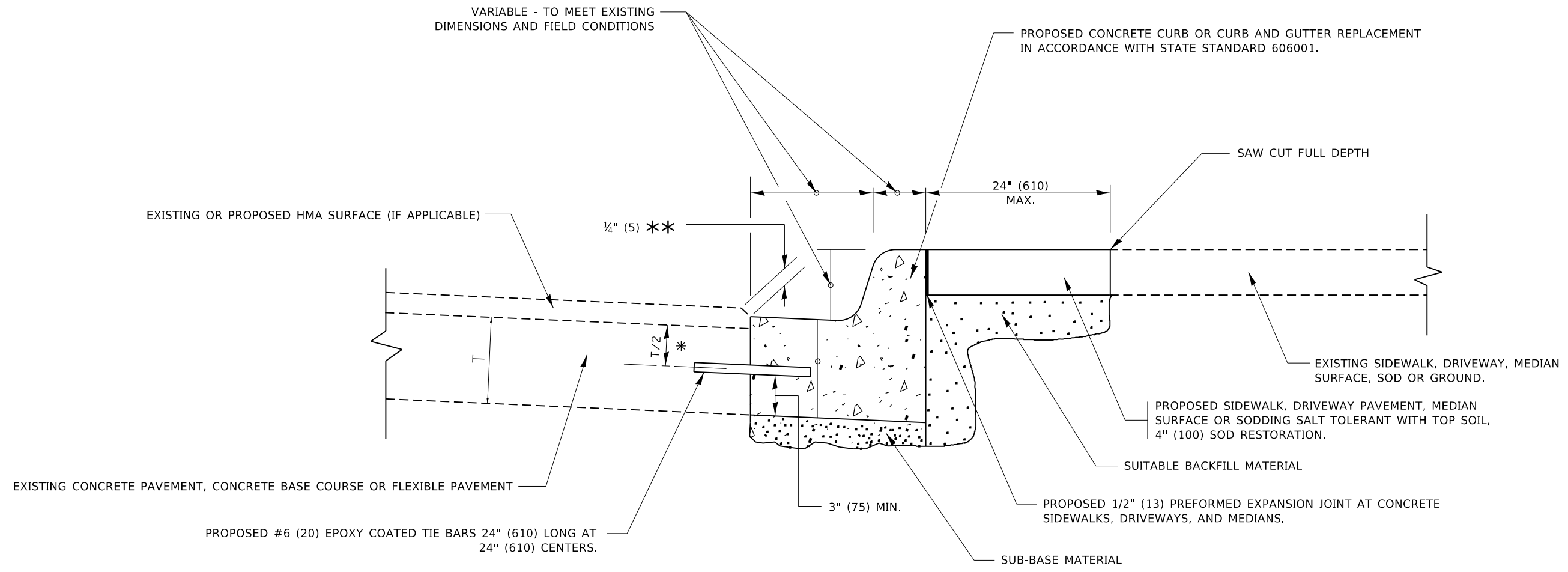
FILE NAME = D149320-shr-plan.dgn	USER NAME = abunestm	DESIGNED -	REVISED -
		DRAWN -	REVISED -
		CHECKED -	REVISED -
		DATE -	REVISED -

STATE OF ILLINOIS  
DEPARTMENT OF TRANSPORTATION

CRACK & JOINT SEALING DETAIL

SCALE: SHEET NO. OF SHEETS STA. TO STA.

F.A.P. RTE. 393	SECTION 2020-094-I	COUNTY COOK	TOTAL SHEETS 22	SHEET NO. 14
CONTRACT NO. 62L72				
ILLINOIS FED. AID PROJECT				



- \* 3" (75) MINIMUM FROM TOP AND BOTTOM OF THE CONCRETE PAVEMENT OR BASE COURSE.
- \*\* IF THE FINAL SURFACE OF THE PAVEMENT IS CONCRETE, THE GUTTER IS TO BE FLUSH WITH THE PAVEMENT.

# CURB OR CURB AND GUTTER REMOVAL AND REPLACEMENT

ALL DIMENSIONS ARE IN INCHES (MILLIMETERS) UNLESS OTHERWISE SHOWN.

MODEL: Default  
FILE: \\nas101.pw.state.il.us\pub\harcourt\dot\illinois\pwr\DOT\Documents\DOT\_Offices\Director\_1\Projects\149270\CaddData\Design\DESIGN.dgn

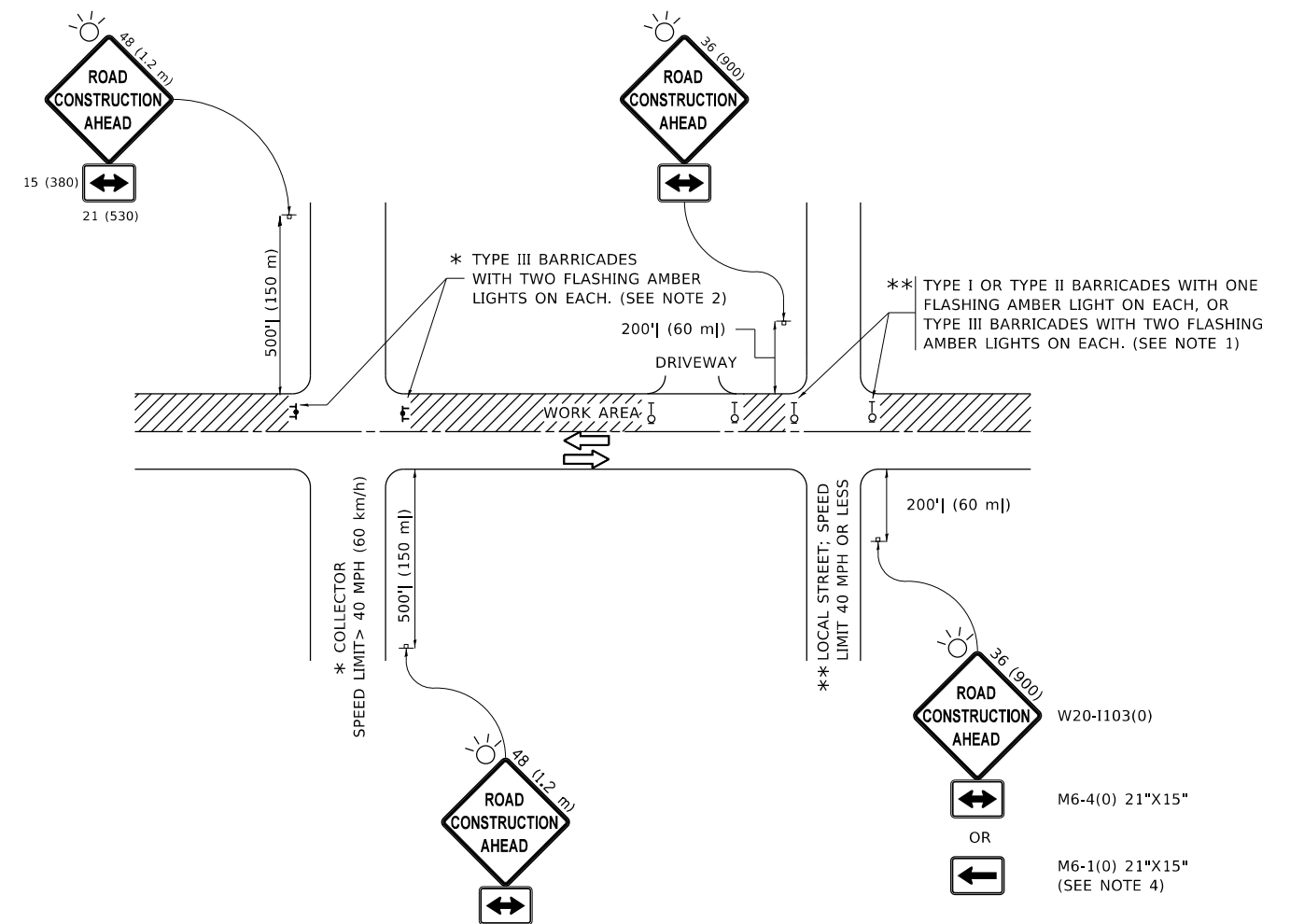
USER NAME = abunaimtm	DESIGNED - A. HOUSEH	REVISED - A. ABBAS 03-21-97
	DRAWN -	REVISED - M. GOMEZ 01-22-01
PLOT SCALE = 100.0000' / in.	CHECKED -	REVISED - R. BORO 12-15-09
PLOT DATE = 8/14/2020	DATE - 03-11-94	REVISED - K. SMITH 07-11-19

**STATE OF ILLINOIS  
DEPARTMENT OF TRANSPORTATION**

**CURB OR CURB AND GUTTER  
REMOVAL AND REPLACEMENT**

SCALE: NONE    SHEET 1 OF 1 SHEETS    STA.    TO STA.

F.A.P. RTE.	SECTION	COUNTY	TOTAL SHEETS	SHEET NO.
339	2020-904-I	COOK	22	15
<b>BD600-06 (BD-24)</b>			CONTRACT NO. 62L72	
ILLINOIS FED. AID PROJECT				



**NOTES:**

1. SIDE ROAD WITH A SPEED LIMIT OF 40 MPH (60 km/h) OR LESS AS SHOWN ON THE DRAWING AND AS DIRECTED BY THE ENGINEER:
  - a) ONE "ROAD CONSTRUCTION AHEAD" SIGN 36 x 36 (900x900) WITH A FLASHER MOUNTED ON IT APPROXIMATELY 200' (60 m) IN ADVANCE OF THE MAIN ROUTE.
  - b) THE CLOSED PORTION OF THE MAIN ROUTE SHALL BE PROTECTED BY BLOCKING WITH TYPE I, TYPE II OR TYPE III BARRICADES, 1/3 OF THE CROSS SECTION OF THE CLOSED PORTION.
2. SIDE ROAD WITH A SPEED LIMIT GREATER THAN 40 MPH (60 km/h) AS SHOWN ON THE DRAWING AND AS DIRECTED BY THE ENGINEER:
  - a) ONE "ROAD CONSTRUCTION AHEAD" SIGN 48 x 48 (1.2 m x 1.2 m) WITH A FLASHER MOUNTED ON IT APPROXIMATELY 500' (150 m) IN ADVANCE OF THE MAIN ROUTE.
  - b) BLOCKING WITH TYPE III BARRICADES, 1/2 OF THE CROSS SECTION OF THE CLOSED PORTION.
3. CONES MAY BE SUBSTITUTED FOR BARRICADES OR DRUMS AT HALF THE SPACING DURING DAY OPERATIONS. CONES SHALL BE A MINIMUM OF 28 (710) IN HEIGHT.
4. SIGNING AND THE WORK ZONE, A SINGLE HEADED ARROW (M6-1) SHALL BE USED IN LIEU OF THE DOUBLE HEADED ARROW (M6-4).
5. WHEN WORK IS BEING PERFORMED ON A SIDE ROAD OR DRIVEWAY, FOLLOW THE APPLICABLE STANDARD(S). THE DIRECTIONAL ARROW (M6-1 OR M6-4) SHALL BE COVERED OR REMOVED WHEN NO LONGER CONSISTENT WITH THE TRAFFIC CONTROL SET-UP.
6. ADVANCE WARNING SIGNS ARE TO BE OMITTED ON DRIVEWAYS UNLESS OTHERWISE SPECIFIED IN THE PLANS OR BY THE ENGINEER.
7. THE TRAFFIC CONTROL AND PROTECTION FOR SIDE ROADS, INTERSECTIONS, AND DRIVEWAYS SHALL BE INCLUDED IN THE COST OF SPECIFIED TRAFFIC CONTROL STANDARDS OR ITEMS.

All dimensions are in inches (millimeters) unless otherwise shown.

MODEL: Default  
FILE: \\nas101.psu.edu\public\p1000000\dot\Documents\DOT\_Offices\Director\_1\Projects\119220\CADD\Design\Design\DCS.dgn

USER NAME = abunaimtm	DESIGNED - L.H.A.	REVISED - A. HOUSEH 10-15-96
PLOT SCALE = 100.0000' / in.	CHECKED -	REVISED - T. RAMMACHER 01-06-00
PLOT DATE = 8/14/2020	DATE - 06-89	REVISED - A. SCHUETZE 07-01-13
		REVISED - A. SCHUETZE 09-15-16

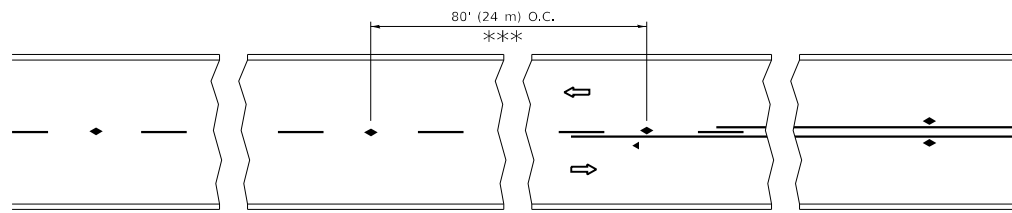
**STATE OF ILLINOIS  
DEPARTMENT OF TRANSPORTATION**

**TRAFFIC CONTROL AND PROTECTION FOR  
SIDE ROADS, INTERSECTIONS, AND DRIVEWAYS**

SCALE: NONE SHEET 1 OF 1 SHEETS STA. TO STA.

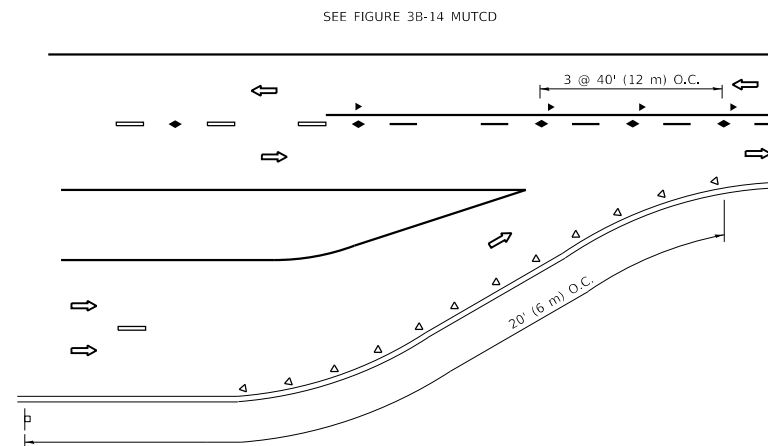
F.A.P. RTE.	SECTION	COUNTY	TOTAL SHEETS	SHEET NO.
339	2020-904-I	COOK	22	16
<b>TC-10</b>			CONTRACT NO. 62L72	
ILLINOIS FED. AID PROJECT				



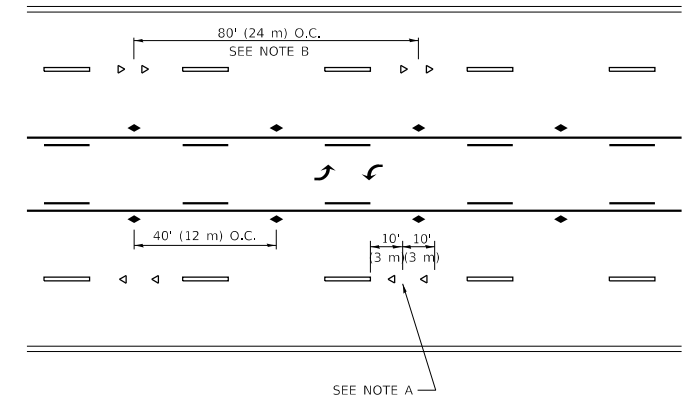


\*\*\* REDUCE TO 40' (12 m) O.C. ON CURVES WITH POSTED OR ADVISORY SPEED 45 M.P.H. (70 km/h) OR LESS.

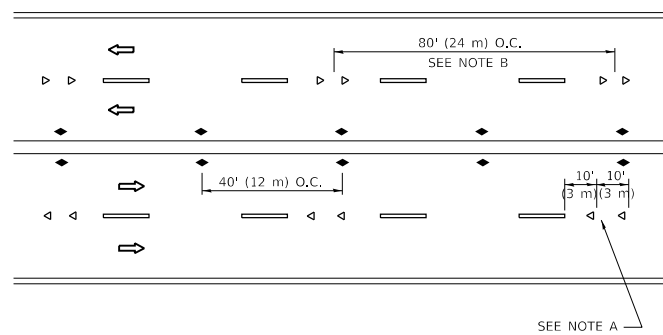
**TWO-LANE/TWO-WAY**



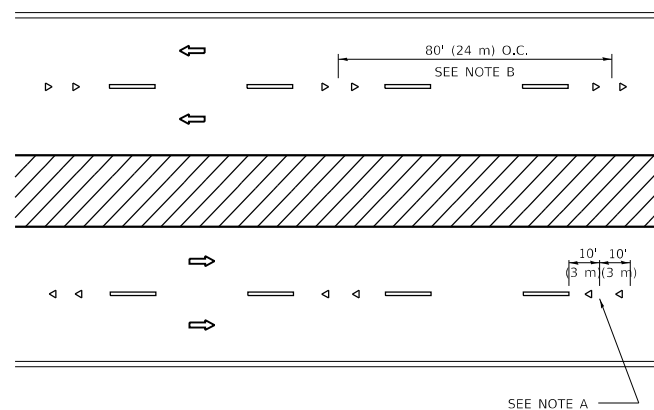
**LANE REDUCTION TRANSITION**



**TWO-WAY LEFT TURN**



**MULTI-LANE/UNDIVIDED**



**MULTI-LANE/DIVIDED**

**GENERAL NOTES**

1. MARKERS USED WITH DASHED LINES SHALL BE CENTERED IN THE GAP BETWEEN SEGMENTS.
2. MARKERS USED ADJACENT TO SOLID LINES SHALL BE OFFSET 2 TO 3 (50 TO 75) TOWARD TRAFFIC AS SHOWN.
3. MARKERS THROUGH TANGENTS LESS THAN 500' (150 m) IN LENGTH BETWEEN CURVES SHALL BE INSTALLED AT THE LESSER OF THE TWO CURVE SPACINGS.
4. MARKERS ARE TO BE USED ADJACENT TO BOTH SOLID WHITE LINES IN DUAL LEFT TURN LANES

**SYMBOLS**

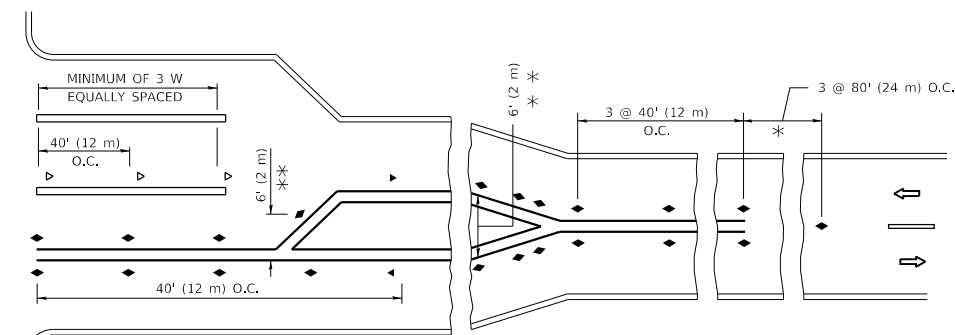
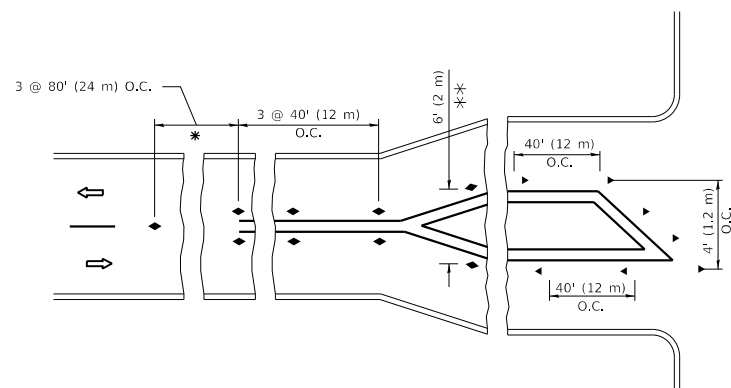
- YELLOW STRIPE
- WHITE STRIPE
- ◀ ONE-WAY AMBER MARKER
- ◀ ONE-WAY CRYSTAL MARKER (W/O)
- ◆ TWO-WAY AMBER MARKER

**LANE MARKER NOTES**

- A. USE DOUBLE LANE LINE MARKERS SPACED AS SHOWN.
- B. REDUCE TO 40' (12 m) O.C. ON CURVES WHERE ADVISORY SPEEDS ARE 10 M.P.H. (20 km/h) LOWER THAN POSTED SPEEDS.

**DESIGN NOTES**

1. DOUBLE LANE LINE MARKERS SHALL BE USED UNLESS SPECIFIED OTHERWISE.
2. EXCEPT AS SHOWN ON THE LANE REDUCTION TRANSITION AND FREEWAY EXIT RAMP DETAIL, MARKERS ARE NOT TO BE SPECIFIED ON RIGHT EDGE LINES.
3. THE EXACT MARKER LIMITS, SPACING, AND COLOR SHALL BE INCLUDED IN THE PLANS WHEN STANDARD SPECIFICATIONS ARE NOT BEING USED.
4. MARKERS SHOULD NOT BE USED ALONGSIDE CURBS EXCEPT FOR EXTREMELY SHORT SECTIONS OF CURBS WHERE NOT MORE THAN TWO MARKERS WOULD BE INVOLVED.



\* SEE TWO-LANE/TWO-WAY WHERE MARKERS CONTINUE  
 \*\* WHERE THE MEDIAN WIDTH IS 6' (2 m) OR LESS USE TWO-WAY MARKERS.

**TURN LANES**

All dimensions are in inches (millimeters) unless otherwise shown.

MODEL: Default  
 FILE: \\nrcs-pub\pubroom\dat\illinois.gov\PI\DOT\Documents\DOT\_Offices\Illindec\_1\Projects\149270\CADD\Drawings\Design\DES\54.dgn

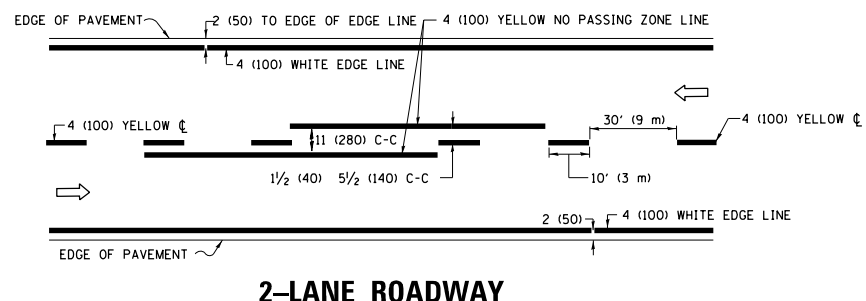
USER NAME = abunaimtm	DESIGNED -	REVISED - T. RAMMACHER 03-12-99
	DRAWN -	REVISED - T. RAMMACHER 01-06-00
PLOT SCALE = 100.0000' / in.	CHECKED -	REVISED - C. JUCIUS 09-09-09
PLOT DATE = 8/14/2020	DATE -	REVISED - C. JUCIUS 07-01-13

**STATE OF ILLINOIS  
 DEPARTMENT OF TRANSPORTATION**

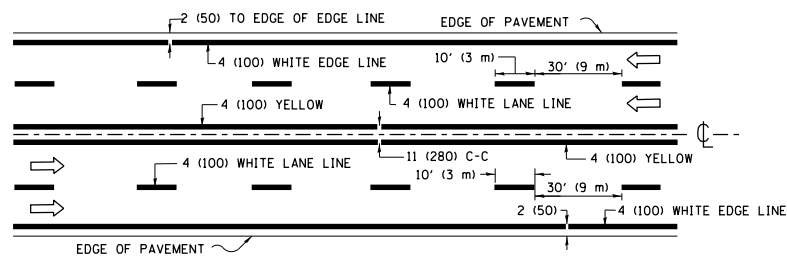
**TYPICAL APPLICATIONS  
 RAISED REFLECTIVE PAVEMENT MARKERS (SNOW-PLOW RESISTANT)**

SCALE: NONE SHEET 1 OF 1 SHEETS STA. TO STA.

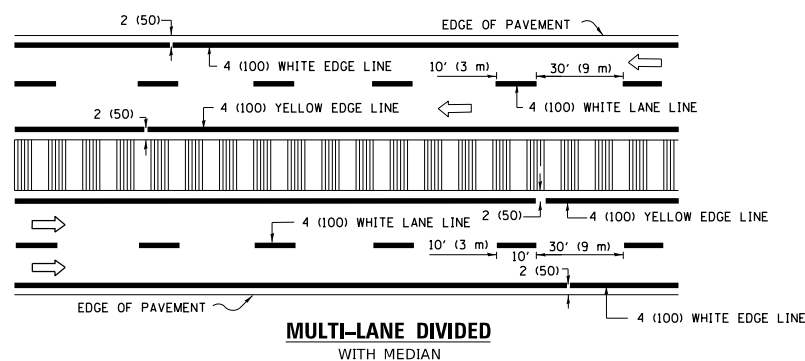
F.A.P. RTE. 339	SECTION 2020-904-I	COUNTY COOK	TOTAL SHEETS 22	SHEET NO. 17
TC-11		CONTRACT NO. 62L72		
ILLINOIS		FED. AID PROJECT		



**2-LANE ROADWAY**

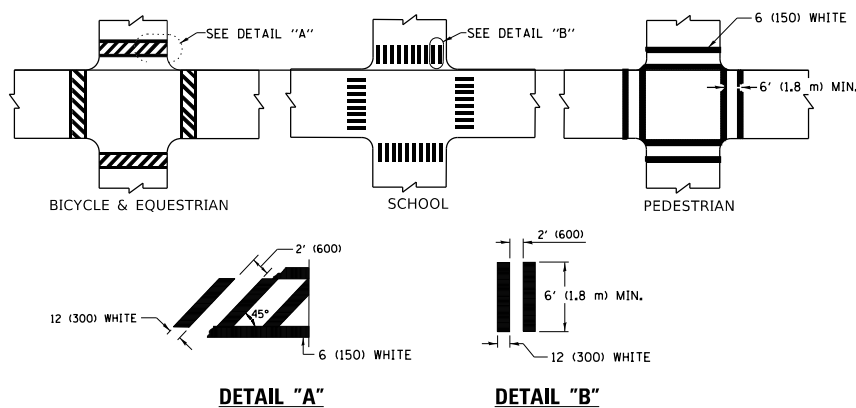


**MULTI-LANE UNDIVIDED**



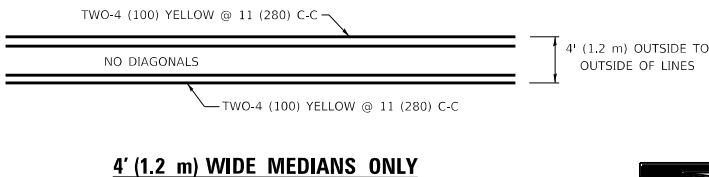
**MULTI-LANE DIVIDED WITH MEDIAN**

**TYPICAL LANE AND EDGE LINE MARKING**

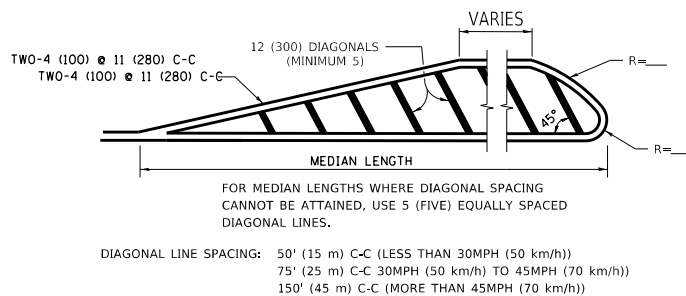


**TYPICAL CROSSWALK MARKING**

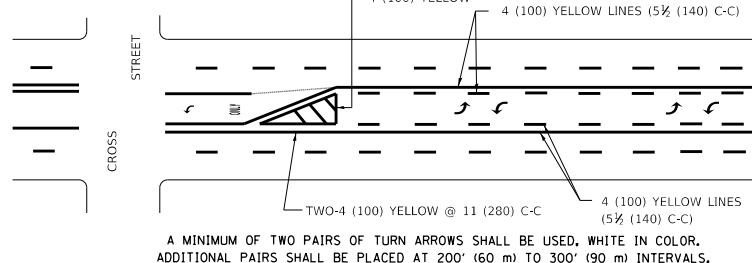
\* MARKINGS SHALL BE INSTALLED PARALLEL TO THE CENTERLINE OF THE ROAD WHICH IT CROSSES



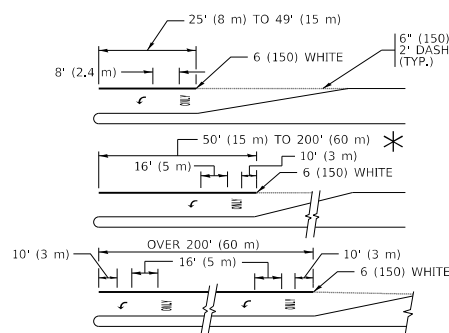
**4' (1.2 m) WIDE MEDIANS ONLY**



**MEDIANS OVER 4' (1.2 m) WIDE**

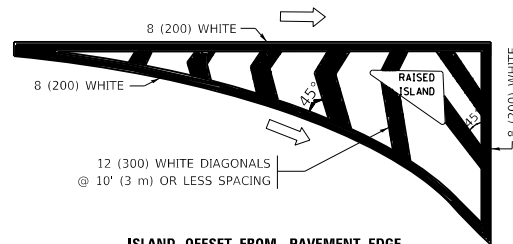


**MEDIAN WITH TWO-WAY LEFT TURN LANE TYPICAL PAINTED MEDIAN MARKING**

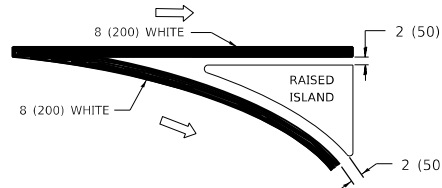


**TYPICAL LEFT (OR RIGHT) TURN LANE**

**TYPICAL TURN LANE MARKING**

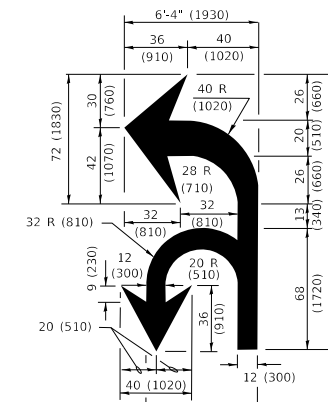


**ISLAND OFFSET FROM PAVEMENT EDGE**

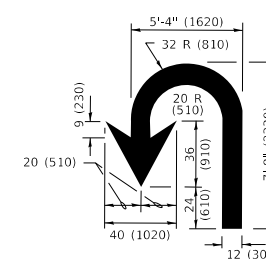


**ISLAND AT PAVEMENT EDGE**

**TYPICAL ISLAND MARKING**



**COMBINATION LEFT AND U-TURN**



**U-TURN**

**LANE REDUCTION TRANSITION**  
\* LANE REDUCTION ARROWS REQUIRED AT SPEEDS OF 45 MPH OR GREATER OR WHEN SPECIFIED IN PLANS.

D(FT)	SPEED LIMIT
345	30
425	35
500	40
580	45
665	50
750	55

TYPE OF MARKING	WIDTH OF LINE	PATTERN	COLOR	SPACING / REMARKS
CENTERLINE ON 2 LANE PAVEMENT	4 (100)	SKIP-DASH	YELLOW	10' (3 m) LINE WITH 30' (9 m) SPACE
CENTERLINE ON MULTI-LANE UNDIVIDED PAVEMENT	2 @ 4 (100)	SOLID	YELLOW	11 (280) C-C
NO PASSING ZONE LINES: FOR ONE DIRECTION FOR BOTH DIRECTIONS	4 (100) 2 @ 4 (100)	SOLID SOLID	YELLOW YELLOW	5½ (140) C-C FROM SKIP-DASH CENTERLINE 11 (280) C-C OMIT SKIP-DASH CENTERLINE BETWEEN
LANE LINES	4 (100) 5 (125) ON FREEWAYS	SKIP-DASH SKIP-DASH	WHITE WHITE	10' (3 m) LINE WITH 30' (9 m) SPACE
DOTTED LINES (EXTENSIONS OF CENTER, LANE OR TURN LANE MARKINGS)	SAME AS LINE BEING EXTENDED	SKIP-DASH	SAME AS LINE BEING EXTENDED	2' (600) LINE WITH 6' (1.8 m) SPACE
EDGE LINES	4 (100)	SOLID	YELLOW-LEFT WHITE-RIGHT	OUTLINE MEDIANS IN YELLOW
TURN LANE MARKINGS	6 (150) LINE; FULL SIZE LETTERS & SYMBOLS (8' (2.4m))	SOLID	WHITE	SEE TYPICAL TURN LANE MARKING DETAIL
TWO WAY LEFT TURN MARKING	2 @ 4 (100) EACH DIRECTION 8' (2.4m) LEFT ARROW	SKIP-DASH AND SOLID IN PAIRS	YELLOW WHITE	10' (3 m) LINE WITH 30' (9 m) SPACE FOR SKIP-DASH; 5½ (140) C-C BETWEEN SOLID LINE AND SKIP-DASH LINE SEE TYPICAL TWO-WAY LEFT TURN MARKING DETAIL
CROSSWALK LINES (PEDESTRIAN) A. DIAGONALS (BIKE & EQUESTRIAN) B. LONGITUDINAL BARS (SCHOOL)	2 @ 6 (150) 12 (300) @ 45° 12 (300) @ 90°	SOLID SOLID SOLID	WHITE WHITE WHITE	NOT LESS THAN 6' (1.8 m) APART 2' (600) APART 2' (600) APART SEE TYPICAL CROSSWALK MARKING DETAILS.
STOP LINES	24 (600)	SOLID	WHITE	PLACE 4' (1.2 m) IN ADVANCE OF AND PARALLEL TO CROSSWALK, IF PRESENT, OTHERWISE, PLACE AT DESIRED STOPPING POINT, PARALLEL TO CROSSROAD CENTERLINE, WHERE POSSIBLE
PAINTED MEDIANS	2 @ 4 (100) WITH 12 (300) DIAGONALS @ 45° NO DIAGONALS USED FOR 4' (1.2 m) WIDE MEDIANS	SOLID	YELLOW: TWO WAY TRAFFIC WHITE: ONE WAY TRAFFIC	11 (280) C-C FOR THE DOUBLE LINE SEE TYPICAL PAINTED MEDIAN MARKING.
GORE MARKING AND CHANNELIZING LINES	8 (200) WITH 12 (300) DIAGONALS @ 45°	SOLID	WHITE	DIAGONALS: 15' (4.5 m) C-C (LESS THAN 30MPH (50 km/h)) 20' (6 m) C-C 30MPH (50 km/h) TO 45MPH (70 km/h) 30' (9 m) C-C (OVER 45MPH (70 km/h))
RAILROAD CROSSING	24 (600) TRANSVERSE LINES *RR* IS 6' (1.8 m) LINE FOR *X*	SOLID	WHITE	SEE STATE STANDARD 780001 AREA OF: *R*=3.6 SQ. FT. (0.33 m <sup>2</sup> EACH *X*=54.0 SQ. FT. (5.0 m <sup>2</sup> )
SHOULDER DIAGONALS (REQUIRED FOR SHOULDERS > 8')	12 (300) @ 45°	SOLID	WHITE - RIGHT YELLOW - LEFT	50' (15 m) C-C (LESS THAN 30MPH (50 km/h)) 75' (22 m) C-C (30 MPH (50 km/h) TO 45MPH (70 km/h)) 150' (45 m) C-C (OVER 45MPH (70 km/h))
U TURN ARROW	SEE DETAIL	SOLID	WHITE	16.3 SF
2 ARROW COMBINATION LEFT AND U TURN	SEE DETAIL	SOLID	WHITE	30.4 SF

FOR FURTHER DETAILS ON PAVEMENT MARKING REFER TO STANDARD SPECIFICATIONS FOR ROAD AND BRIDGE CONSTRUCTION AND STATE STANDARD 780001.

All dimensions are in inches (millimeters) unless otherwise shown.

MODEL: Default FILE: h:\chicago\pavmarkroom\dat\illinois.gov\PWIDDOT\Documents\DOT-Office\Dist1.ctb... PROJECTID:149270\CADDData\Design\DRS54.dgn

USER NAME	DESIGNED	REVISION
= abunaimtm	- EVERS	- C. JUCIUS 09-09-09
	-	- C. JUCIUS 07-01-13
PLOT SCALE = 100,0000' / in.	CHECKED -	REVISOR - C. JUCIUS 12-21-15
PLOT DATE = 8/14/2020	DATE - 03-19-90	REVISOR - C. JUCIUS 04-12-16

**STATE OF ILLINOIS  
DEPARTMENT OF TRANSPORTATION**

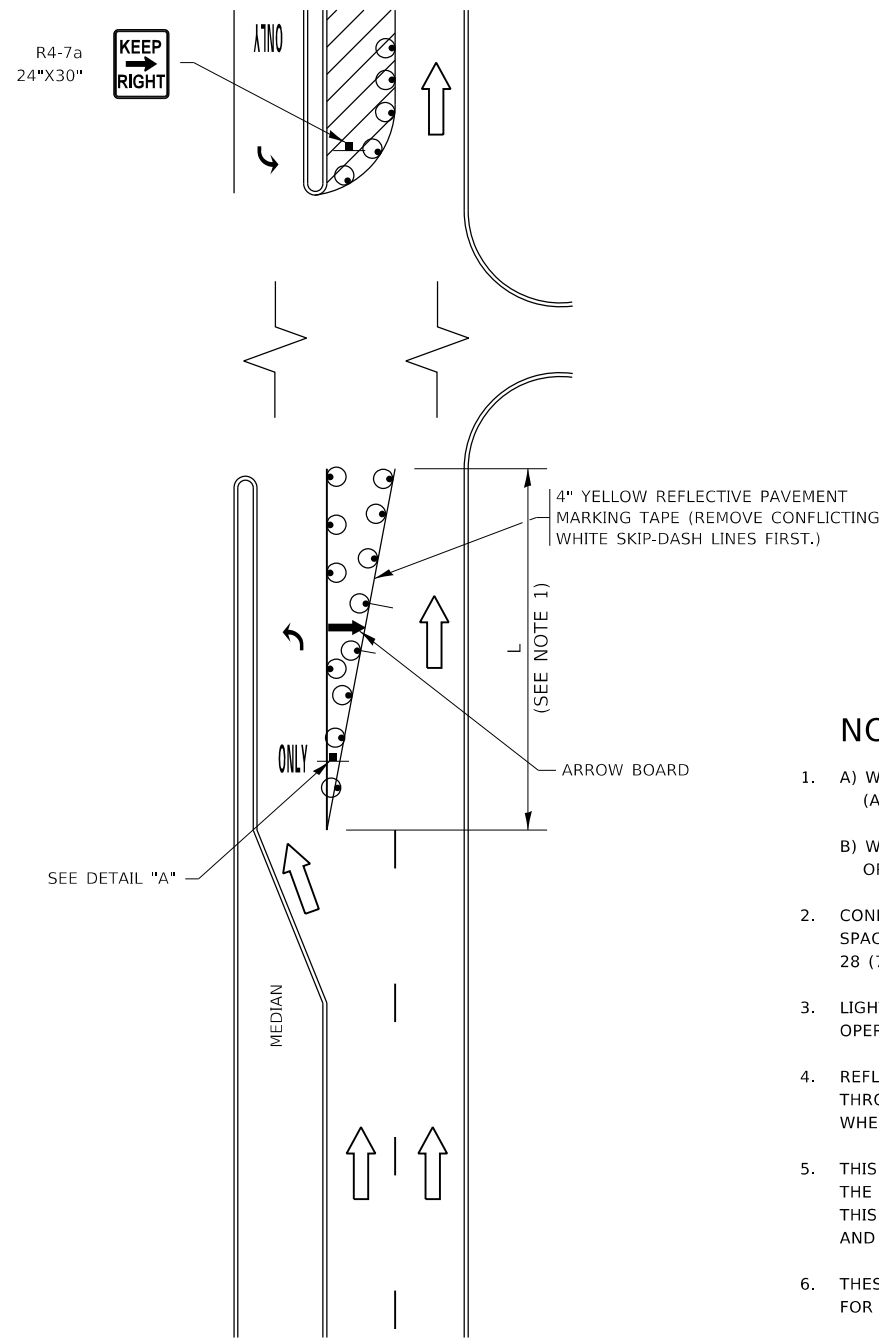
**DISTRICT ONE  
TYPICAL PAVEMENT MARKINGS**

F.A.P. RTE.	SECTION	COUNTY	TOTAL SHEETS	SHEET NO.
339	2020-904-I	COOK	22	18

SCALE: NONE SHEET 1 OF 2 SHEETS STA. TO STA.

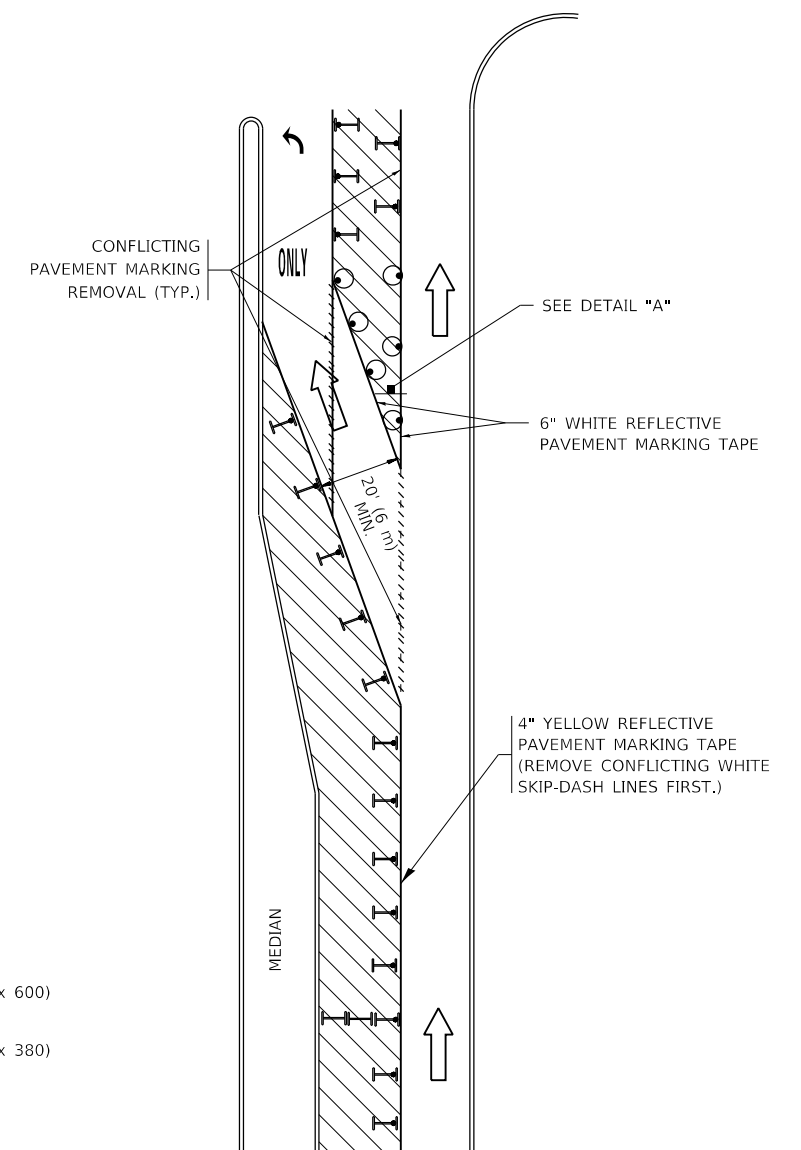
**TC-13** CONTRACT NO. 62L72 ILLINOIS FED. AID PROJECT

# TURN BAY ENTRANCE AT START OF LANE CLOSURE TAPER

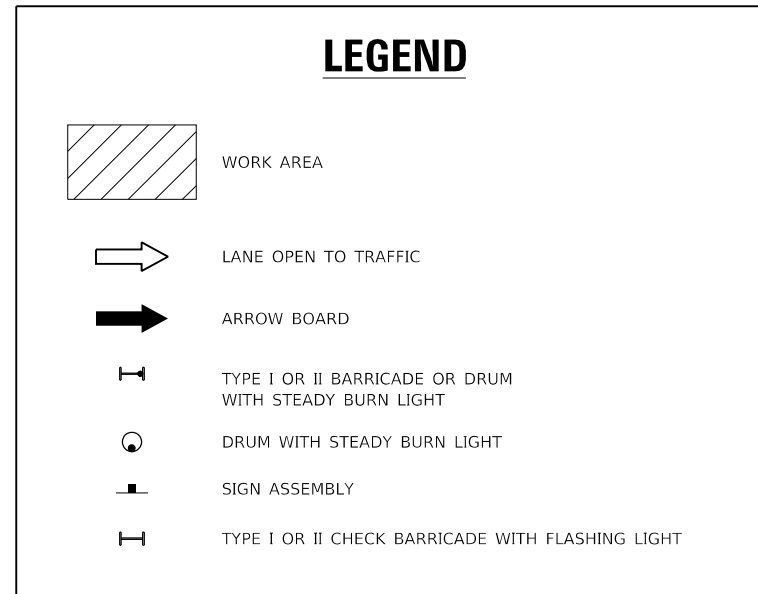


**FIGURE 1**

# TURN BAY ENTRANCE WITHIN A LANE CLOSURE

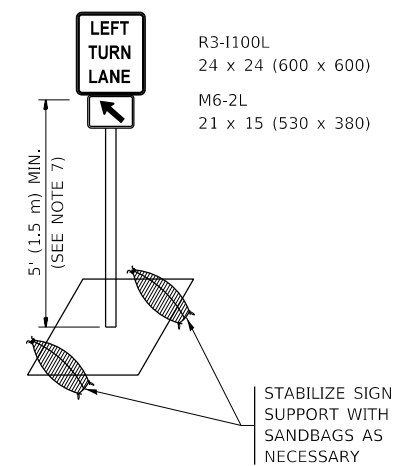


**FIGURE 2**



### NOTES:

1. A) WHEN "L" IS ≤ THE STORAGE LENGTH OF THE TURN LANE (AS SHOWN IN FIG. 1), USE FIGURE 1.  
B) WHEN "L" IS > THE STORAGE LENGTH OF THE TURN LANE OR THE TURN LANE IS WITHIN THE LANE CLOSURE, USE FIGURE 2.
2. CONES MAY BE SUBSTITUTED FOR BARRICADES OR DRUMS AT HALF THE SPACING DURING DAY OPERATIONS. CONES SHALL BE A MINIMUM OF 28 (710) IN HEIGHT.
3. LIGHTS WILL NOT BE REQUIRED ON BARRICADES OR DRUMS FOR DAY OPERATIONS. ALL LIGHTS SHALL BE MONODIRECTIONAL.
4. REFLECTIVE TEMPORARY PAVEMENT MARKINGS SHALL BE PLACED THROUGHOUT THE BARRICADED AREAS OF EACH TURN BAY AS SHOWN WHERE THE CLOSURE TIME IS GREATER THAN FOURTEEN (14) DAYS.
5. THIS APPLICATION ALSO APPLIES WHEN WORK IS BEING PERFORMED IN THE RIGHT LANE(S) AND THE RIGHT TURN BAY IS TO REMAIN OPEN. UNDER THIS CONDITION, "RIGHT TURN LANE" R3-1100R 24 x 24 (600 x 600) AND M6-2R 21 x 15 (530 x 380) SHALL BE USED.
6. THESE CONTROLS SHALL SUPPLEMENT MAINLINE TRAFFIC CONTROL FOR LANE CLOSURES.
7. THE SIGNS SHALL BE MOUNTED ABOVE THE BARRICADES/DRUMS ON SEPARATE SIGN SUPPORTS THAT MEET NCHRP 350 OR MASH REQUIREMENTS.
8. TRAFFIC CONTROL AND PROTECTION AT TURN BAYS (TO REMAIN OPEN TO TRAFFIC) SHALL BE INCLUDED IN THE COST OF SPECIFIED TRAFFIC CONTROL STANDARDS OR ITEMS.



**DETAIL A**

All dimensions are in inches (millimeters) unless otherwise shown.

MODEL: Default  
FILE: h:\mhc\_p\pub\p1800000.dwg  
PROJECT: 119220\CaddData\Design\DESIGN.dgn

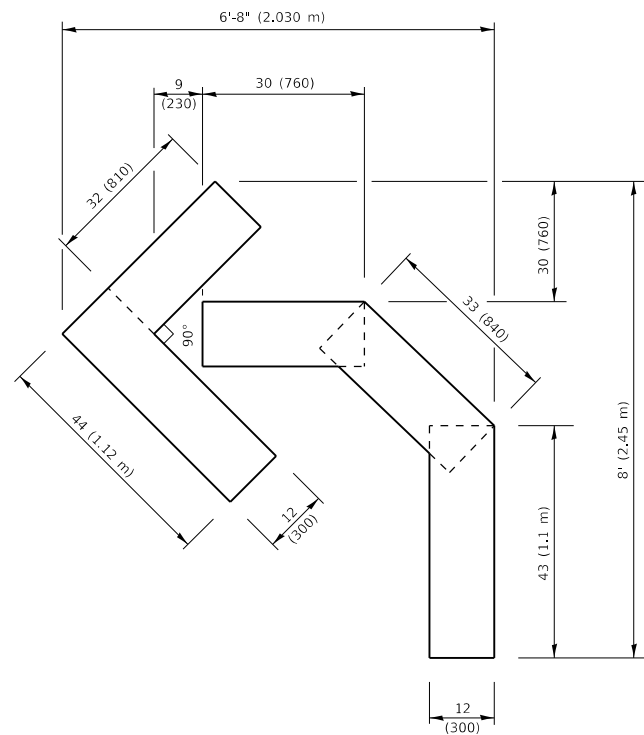
USER NAME = abunaimtm	DESIGNED - T. RAMMACHER 09-08-94	REVISED - R. BORO 09-14-09
	DRAWN - A. HOUSEH 11-07-95	REVISED - A. SCHUETZE 07-01-13
PLOT SCALE = 100,0000' / in.	CHECKED - A. HOUSEH 10-12-96	REVISED - A. SCHUETZE 09-15-16
PLOT DATE = 8/14/2020	DATE - T. RAMMACHER 01-06-00	REVISED -

**STATE OF ILLINOIS  
DEPARTMENT OF TRANSPORTATION**

**TRAFFIC CONTROL AND PROTECTION AT TURN BAYS  
(TO REMAIN OPEN TO TRAFFIC)**

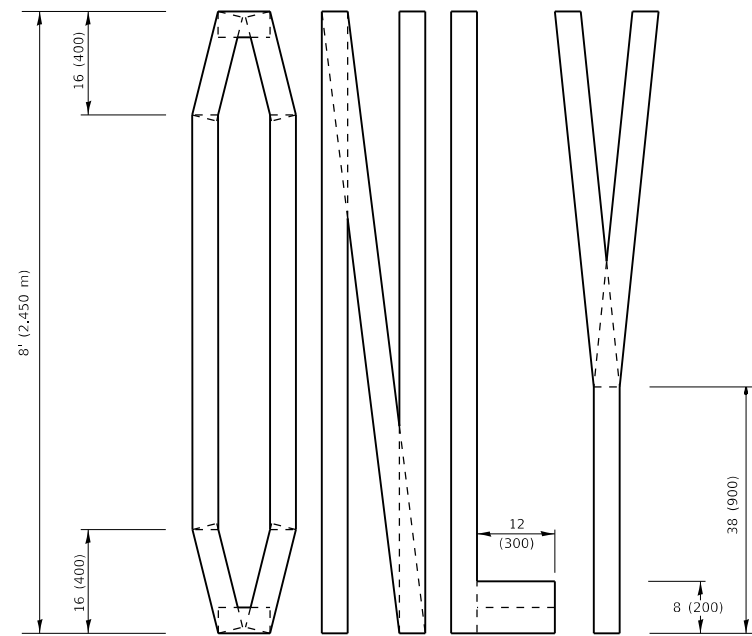
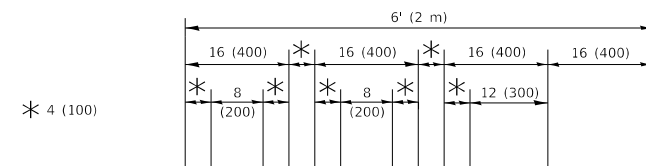
SCALE: NONE SHEET 1 OF 1 SHEETS STA. TO STA.

F.A.P. RTE. 339	SECTION 2020-904-I	COUNTY COOK	TOTAL SHEETS 22	SHEET NO. 19
TC-14		CONTRACT NO. 62L72		
ILLINOIS FED. AID PROJECT				



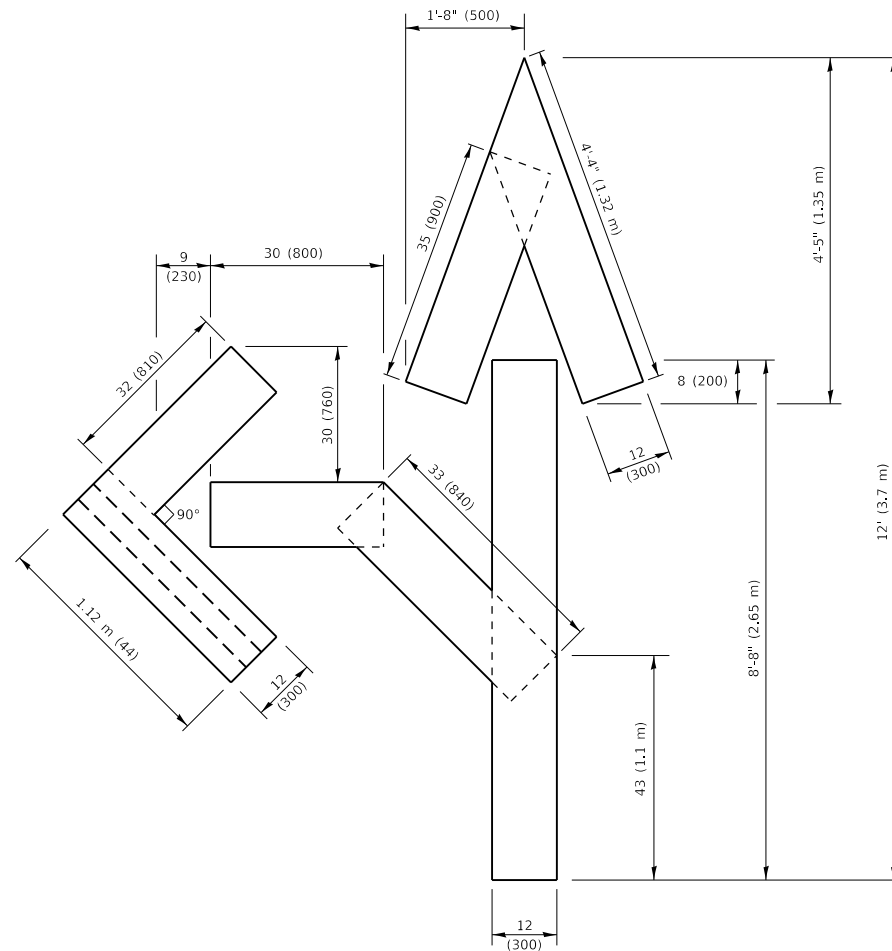
**QUANTITY**

4 (100) LINE = 45.5 ft. (13.9 m)  
15.2 sq. ft. (1.41 sq. m)



**QUANTITY**

4 (100) LINE = 64.1 ft. (19.5 m)  
21.4 sq. ft. (1.99 sq. m)

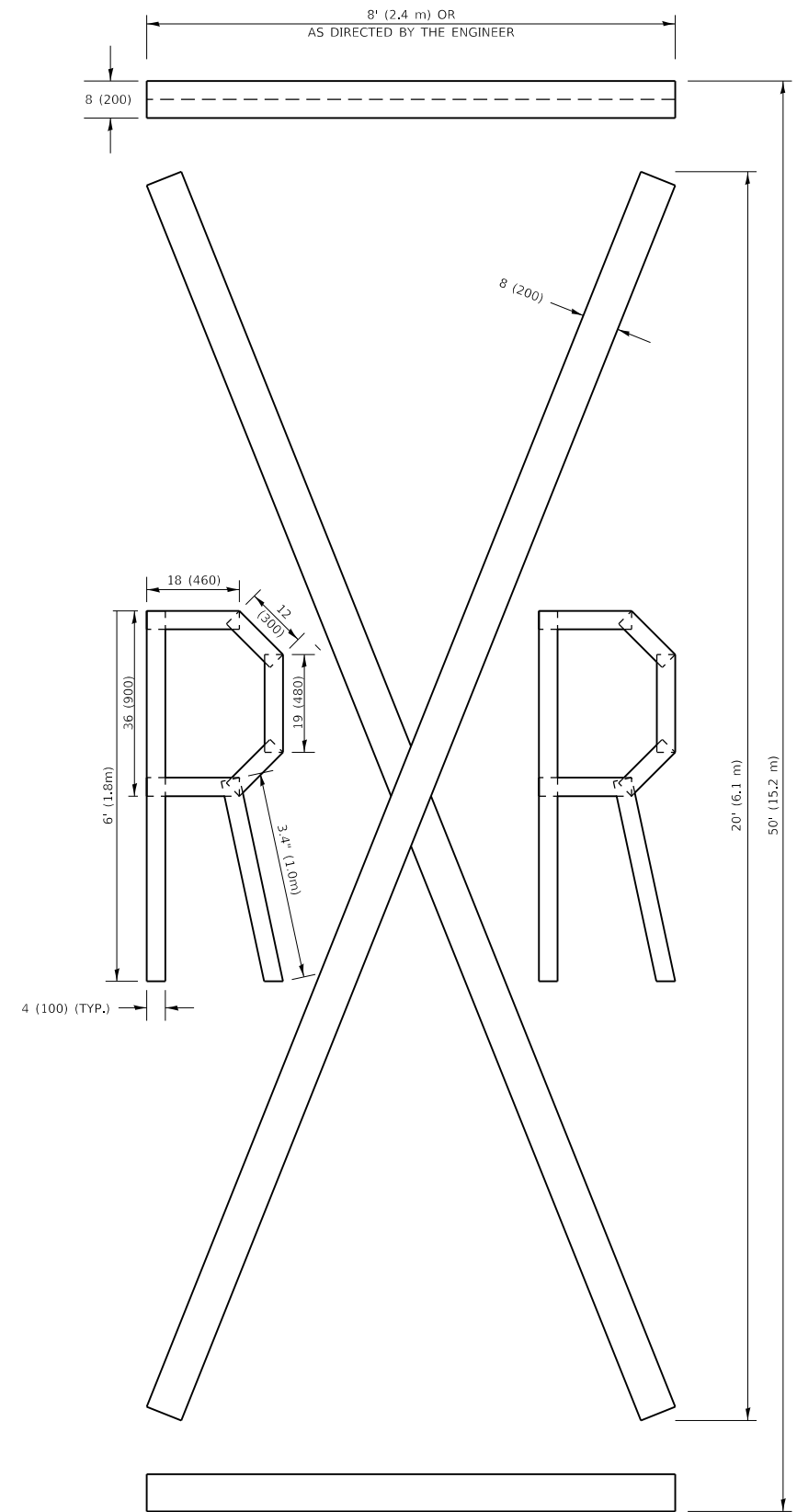


**QUANTITY**

4 (100) LINE = 82.5 ft. (25.1 m)  
27.5 sq. ft. (2.53 sq. m)

**NOTE:**

ALL QUANTITIES OF PLACEMENT ARE REPRESENTED IN LINEAR FEET OF 4" LINES TO MATCH THE 4" TEMPORARY TAPE PAY ITEM AND REPRESENTS THE TOTAL QUANTITY OF 4" TAPE REQUIRED.



**QUANTITY**

4 (100) LINE = 225.9 ft. (68.9 m)  
75.3 sq. ft. (6.99 sq. m)

All dimensions are in inches (millimeters) unless otherwise shown.

MODEL: Default  
FILE NAME: P:\pub\harcam.com.edu\illinois\poc\p\WIDOT\Documental\DOT\_Offices\Dir\trt 1\Projects\CD149220\CADD\data\Design\BIS\Std.dgn

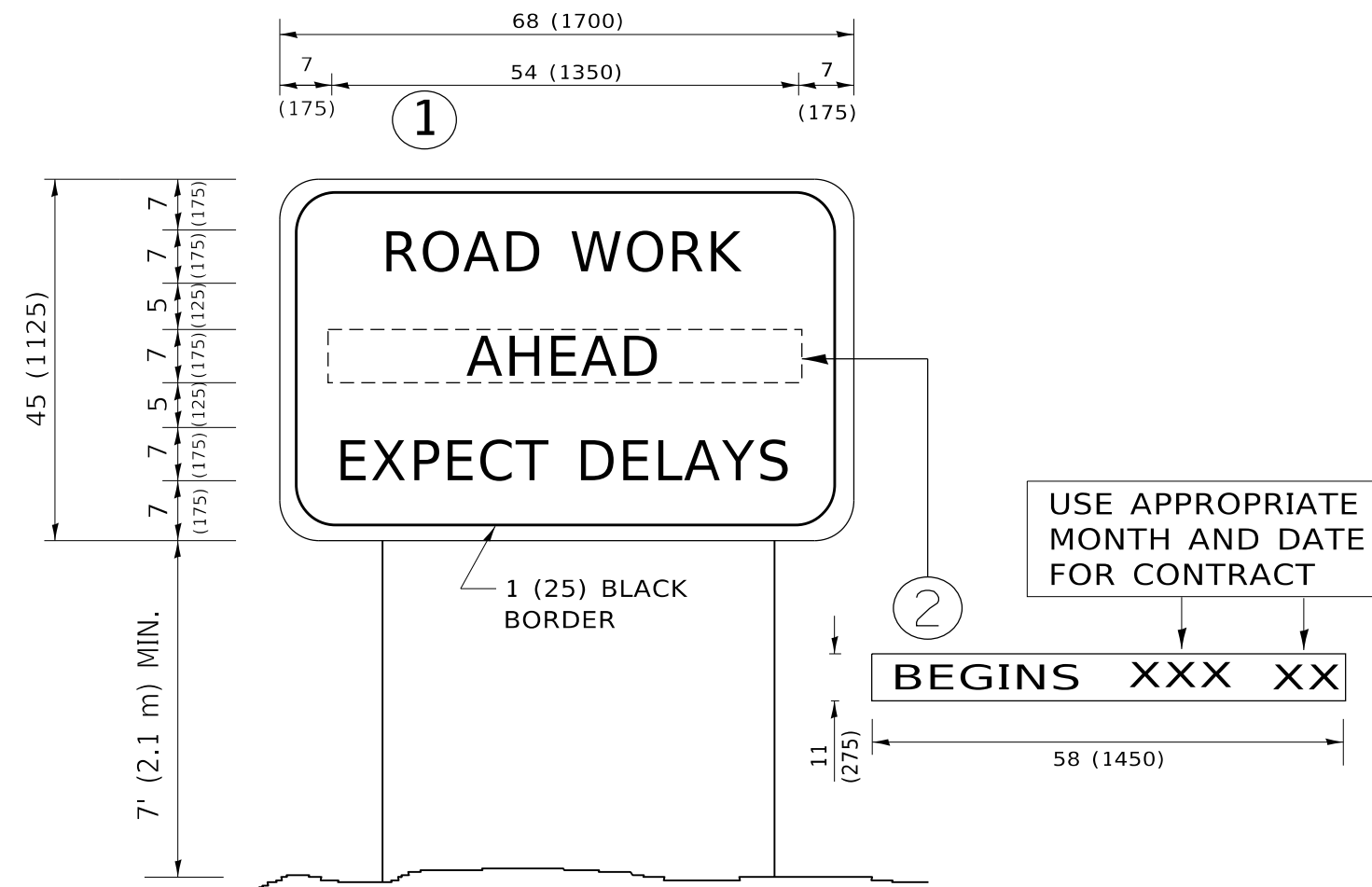
USER NAME = abunalmtn	DESIGNED -	REVISED - T. RAMMACHER 03-02-98
	DRAWN -	REVISED - E. GOMEZ 08-28-00
PLOT SCALE = 100,0010 ' / In.	CHECKED -	REVISED - E. GOMEZ 08-28-00
PLOT DATE = 8/14/2020	DATE - 09-18-94	REVISED - A. SCHUETZE 09-15-16

**STATE OF ILLINOIS  
DEPARTMENT OF TRANSPORTATION**

**SHORT TERM PAVEMENT MARKING LETTERS AND SYMBOLS**

SCALE: NONE SHEET 1 OF 1 SHEETS STA. TO STA.

F.A.P. RTE. 339	SECTION 2020-904-I	COUNTY COOK	TOTAL SHEETS 22	SHEET NO. 20
TC-16		CONTRACT NO. 62L72		
ILLINOIS FED. AID PROJECT				



**NOTES:**

1. USE BLACK LETTERING ON ORANGE BACKGROUND.
2. ERECT SIGNS IN ADVANCE OF THE LOCATION FOR THE "ROAD CONSTRUCTION AHEAD" SIGN AT LOCATIONS AS DIRECTED BY THE ENGINEER.
3. ERECT SIGN ① WITH INSTALLED PANEL ② ONE WEEK PRIOR TO THE START OF CONSTRUCTION.
4. REMOVE PANEL ② SOON AFTER THE START OF CONSTRUCTION.
5. SEE SPECIAL PROVISION FOR "TEMPORARY INFORMATION SIGNING" FOR ADDITIONAL INFORMATION.
6. ONE SIGN ASSEMBLY EQUALS 25.70 SQ. FT. (2.3 SQ. M.)
7. SHALL BE PAID FOR AS TEMPORARY INFORMATION SIGNING.

ALL DIMENSIONS ARE IN INCHES (MILLIMETERS) UNLESS OTHERWISE SHOWN.

MODEL: Default  
 FILE: \\nas01c.psu.edu\lanroom\data\illinois.gov\PWIDOT\Documents\DOT\_Offices\District\_1\Projects\149220\CADD\Design\Design\DES.dgn

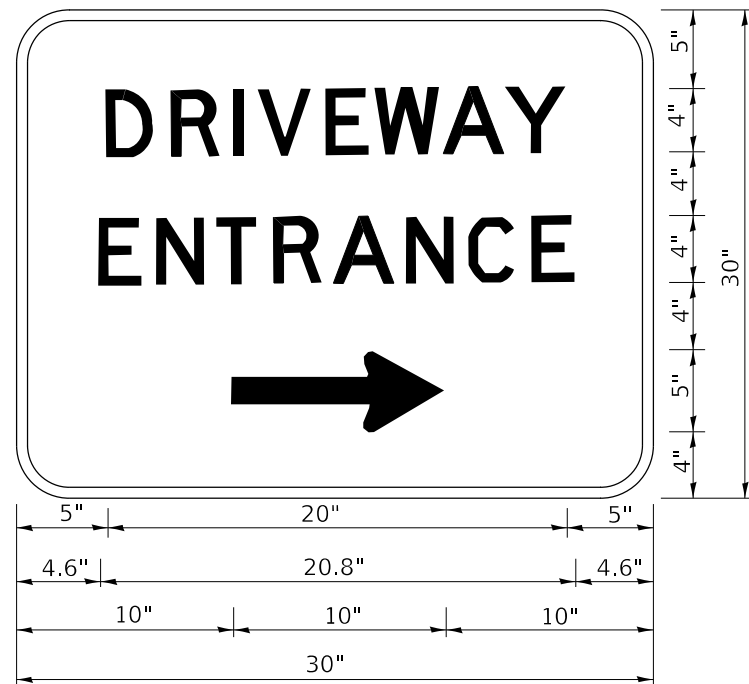
USER NAME = abunaimtm	DESIGNED -	REVISED - R. MIRS 09-15-97
	DRAWN -	REVISED - R. MIRS 12-11-97
PLOT SCALE = 100.0000' / in.	CHECKED -	REVISED - T. RAMMACHER 02-02-99
PLOT DATE = 8/14/2020	DATE -	REVISED - C. JUCIUS 01-31-07

**STATE OF ILLINOIS  
DEPARTMENT OF TRANSPORTATION**

**ARTERIAL ROAD  
INFORMATION SIGN**

SCALE: NONE SHEET 1 OF 1 SHEETS STA. TO STA.

F.A.P. RTE.	SECTION	COUNTY	TOTAL SHEETS	SHEET NO.
339	2020-904-I	COOK	22	21
<b>TC-22</b>			CONTRACT NO. 62L72	
ILLINOIS FED. AID PROJECT				



3.0" RADIUS, 0.5" BORDER, WHITE ON GREEN; REFLECTORIZED  
 "DRIVEWAY" D; "ENTRANCE" D; STANDARD ARROW CUSTOM 12.0" x 5.0"

NOTES:

1. HALF OF THE SIGNS WILL REQUIRE A LEFT HAND FACING ARROW.
2. TWO SIGNS SHALL BE USED AT EACH COMMERCIAL ENTRANCE PLACED BACK-TO-BACK: ONE WITH A RIGHT HAND ARROW (SHOWN) SHALL BE PLACED ON THE NEAR RIGHT SIDE THE DRIVEWAY AND ONE WITH A LEFT HAND ARROW SHALL BE PLACED ON THE FAR LEFT SIDE OF THE DRIVEWAY.
3. SIGNS TO BE PAID FOR AS ITEM "TEMPORARY INFORMATION SIGNING".

MODEL: Default  
 FILE: h:\mfc\_p\pub\planroom.dwg  
 PROJECT: 149220\CADD\DATA\Design\DRIVEWAY.dgn  
 PROJECT: 149220\CADD\DATA\Design\DRIVEWAY.dgn

USER NAME = abunaimtm	DESIGNED -	REVISED - C. JUCIUS 02-15-07
	DRAWN -	REVISED -
PLOT SCALE = 100.0000' / in.	CHECKED -	REVISED -
PLOT DATE = 8/14/2020	DATE -	REVISED -

**STATE OF ILLINOIS**  
**DEPARTMENT OF TRANSPORTATION**

**DRIVEWAY ENTRANCE SIGNING**

SCALE: NONE SHEET 1 OF 2 SHEETS STA. TO STA.

F.A.P. RTE.	SECTION	COUNTY	TOTAL SHEETS	SHEET NO.
339	2020-904-I	COOK	22	22
<b>TC-26</b>			CONTRACT NO. 62L72	
ILLINOIS FED. AID PROJECT				