

PROFILE	SUPERVISED	DATE
NOTE BOOK	DESIGNED	
NO.	CHECKED	
	BY	
	DATE	
	NO.	
	BY	
	DATE	
	NO.	

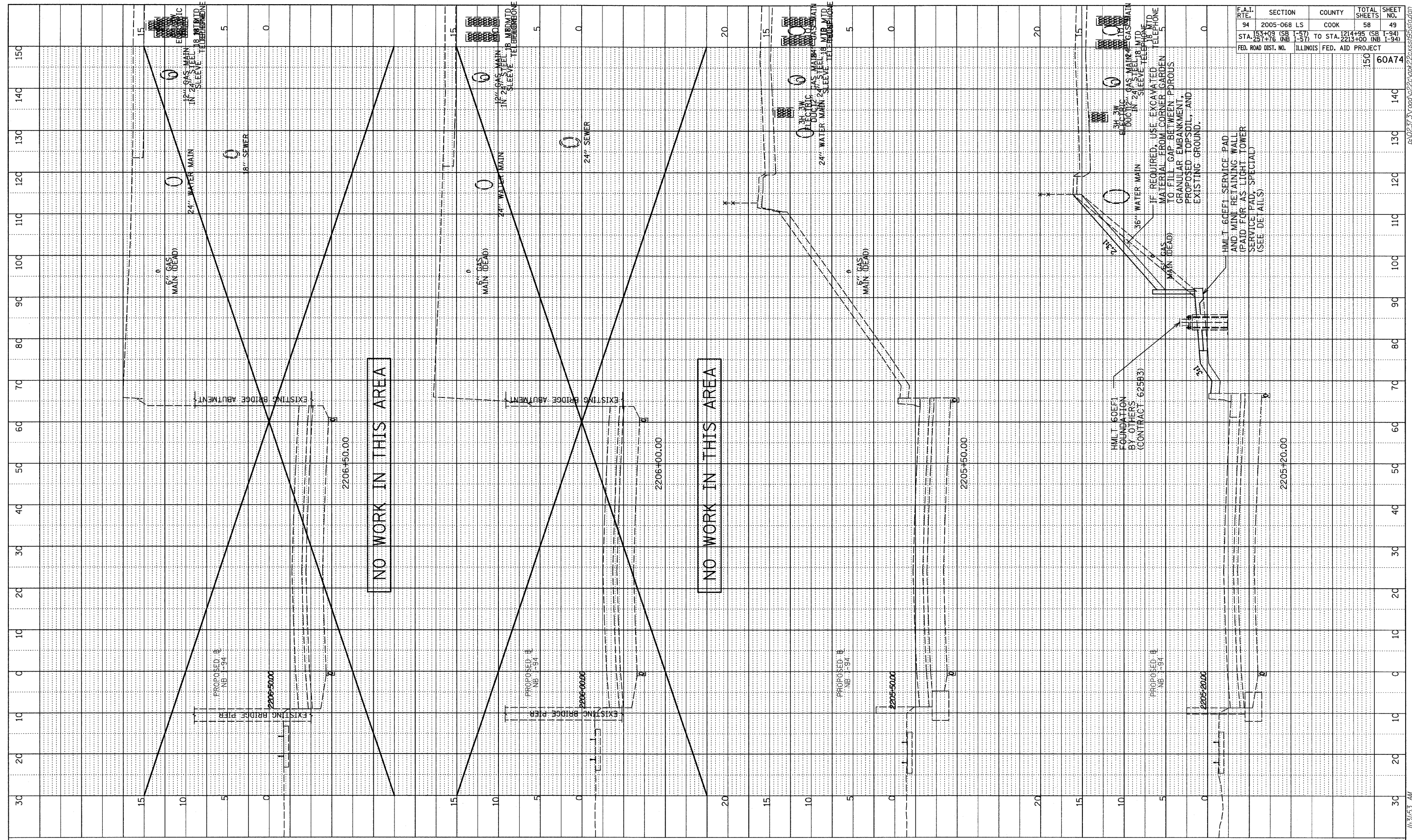

F.A.I. RTE.	SECTION	COUNTY	TOTAL SHEETS	SHEET NO.
94	2005-068 LS	COOK	58	49
STA. 153+09 (SB I-57) TO STA. 257+76 (NB I-57)	TO STA. 1214+95 (SB I-94) TO STA. 2213+00 (NB I-94)			
FED. ROAD DIST. NO.	ILLINOIS FED. AID PROJECT			
			150	60A74

TYLIN INTERNATIONAL

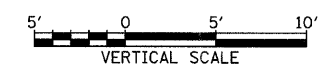
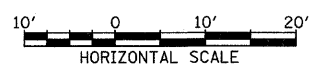

NB I-94 (DAN RYAN EXPRESSWAY)
STA. 2205+20 TO STA. 2206+50

6/20/2008 11:31:53 AM