

PROFILE SURVEYED	BY	DATE
DESIGNED		
CHECKED		
NOTE BOOK		
NO.		
STRUCTURE NOTATIONS CHRD		

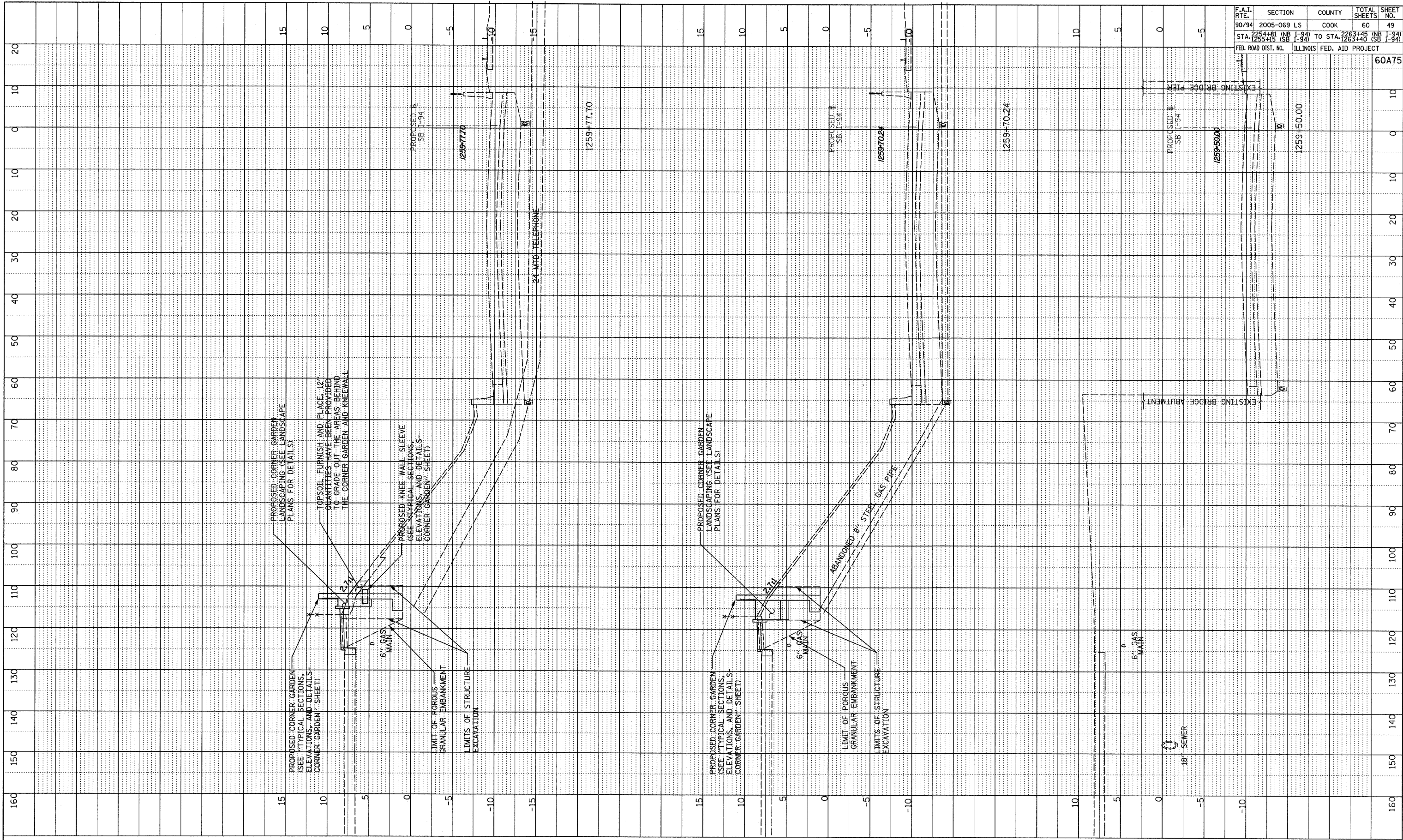

F.A.I. RTE.	SECTION	COUNTY	TOTAL SHEETS	SHEET NO.
90/94	2005-069 LS	COOK	60	49
STA. 1255+00 (SB I-94)	TO STA. 1263+40 (SB I-94)			
FED. ROAD DIST. NO.	ILLINOIS	FED. AID PROJECT		60A75

TYLIN INTERNATIONAL

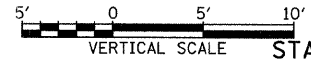
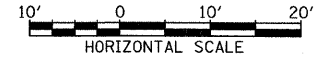

SB I-94 (DAN RYAN EXPRESSWAY)
STA. 1259+50.00 TO STA. 1259+77.70