

PROFILE	REVIEWED	DATE
NOTE BOOK	GRADES CHECKED	
NO.	BY	
	DATE	
	NO.	
	DATE	

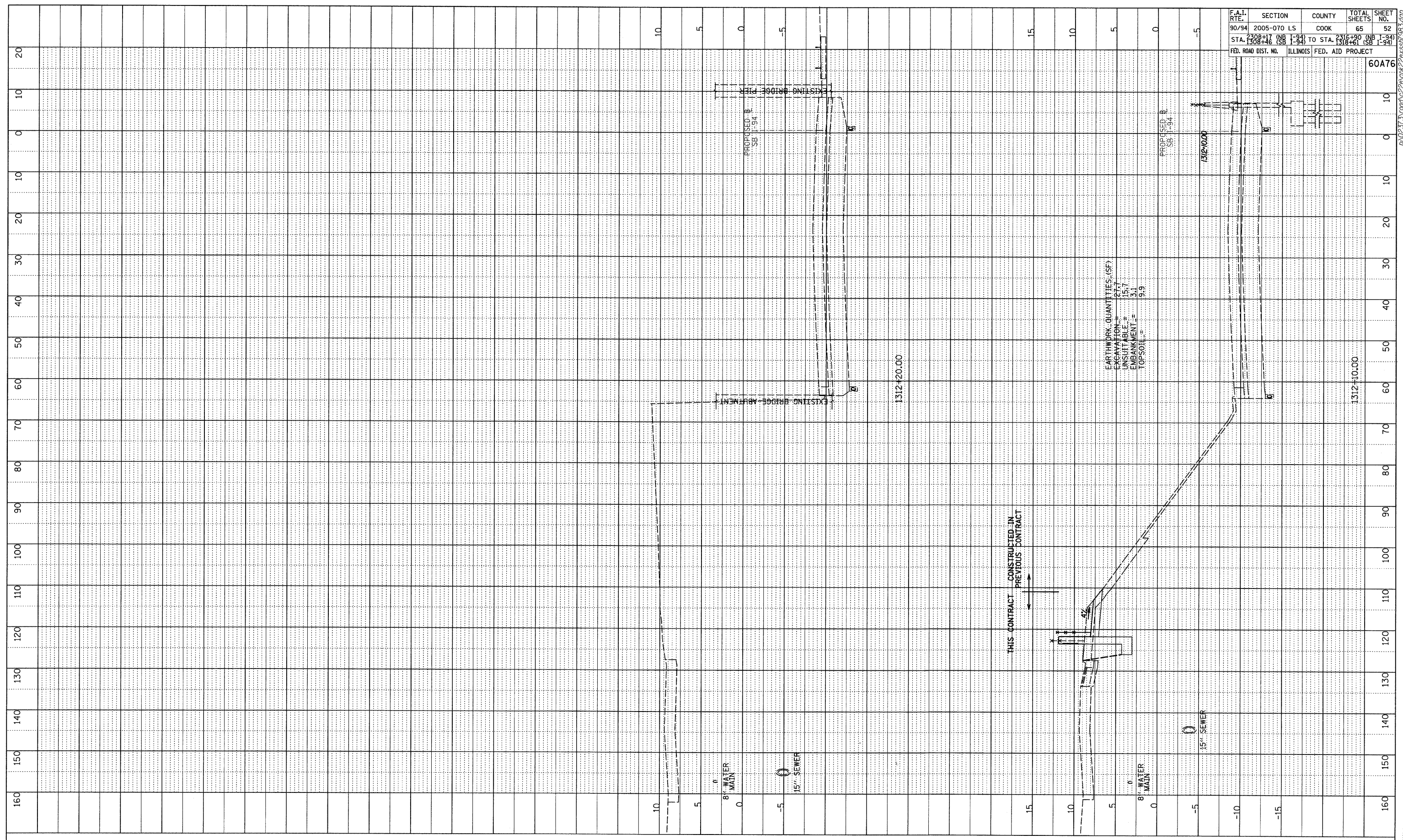

F.A.I. RTE.	SECTION	COUNTY	TOTAL SHEETS	SHEET NO.
90/94	2005-070 LS	COOK	65	52
STA. 1308+46	TO STA. 1316+61			
FED. ROAD DIST. NO.	ILLINOIS	FED. AID PROJECT		

60A76

TYLIN INTERNATIONAL

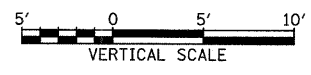
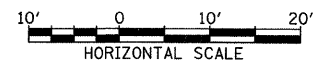

SB I-94 (DAN RYAN EXPRESSWAY)
STA. 1312+10 TO STA. 1312+20