

F.A.I. RTE.	SECTION	COUNTY	TOTAL SHEETS	SHEET NO.
90/94	2005-071 LS	COOK	39	4
STA. TO STA.		FED. ROAD DIST. NO. 1 ILLINOIS FED. AID PROJECT		
60A77				

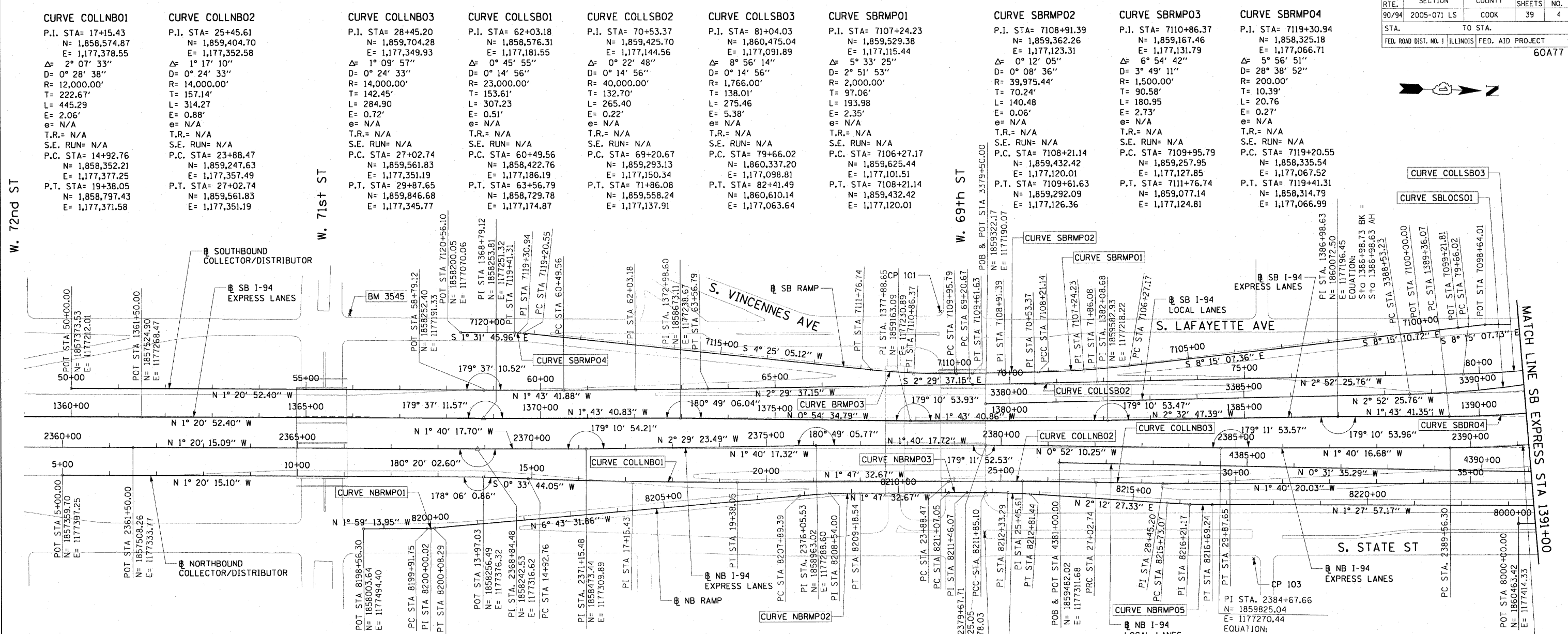

- BENCH MARK NO. 3528 ELEV. 16.20**  
DESCRIPTION: CROSS CUT ON NORTHWESTERLY BOLT OF FIRE HYDRANT AT THE NORTHWEST CORNER OF 45TH ST AND WENTWORTH AVE
- BENCH MARK NO. 3530 ELEV. 18.18**  
DESCRIPTION: CROSS CUT ON SOUTHEAST BOLT OF LIGHT POLE BASE AT THE NORTHWEST CORNER OF 51ST ST AND WELLS ST
- BENCH MARK NO. 3531 ELEV. 17.55**  
DESCRIPTION: CROSS CUT ON NORTHEASTERLY FLANGE BOLT OF FIRE HYDRANT AT THE NORTHEAST CORNER OF GARFIELD BLVD AND WELLS ST
- BENCH MARK NO. 3532 ELEV. 18.84**  
DESCRIPTION: HORIZONTAL BOLT ON CTA "EL" STRUCTURE, EAST SIDE OF WELLS ST ABOUT 50 FEET NORTH OF 59TH PL.
- BENCH MARK NO. 3533 ELEV. 19.71**  
DESCRIPTION: BRASS DISK (CTA MONUMENT) AT THE SOUTHWEST CORNER OF 63RD ST AND HARVARD ST

- BENCH MARK NO. 3535 ELEV. 19.31**  
DESCRIPTION: FOUND CROSS CUT ON SOUTHERLY FLANGE BOLT OF FIRE HYDRANT AT THE NORTHEAST CORNER OF 59TH ST AND WENTWORTH AVE
- BENCH MARK NO. 3536 ELEV. 18.37**  
DESCRIPTION: CROSS CUT ON SOUTHEASTERLY FLANGE BOLT OF FIRE HYDRANT AT THE SOUTHEAST CORNER OF GARFIELD BLVD AND WENTWORTH AVE
- BENCH MARK NO. 3537 ELEV. 17.71**  
DESCRIPTION: CROSS CUT ON NORTHEASTERLY FLANGE BOLT OF FIRE HYDRANT AT THE NORTHEAST CORNER OF 51ST ST AND WENTWORTH AVE
- BENCH MARK NO. 3538 ELEV. 17.31**  
DESCRIPTION: CROSS CUT ON EASTERLY FLANGE BOLT OF FIRE HYDRANT AT THE NORTHEAST CORNER OF 47TH ST AND LASALLE ST
- BENCH MARK NO. 3544 ELEV. 19.38**  
DESCRIPTION: CROSS CUT ON WESTERLY FLANGE BOLT OF FIRE HYDRANT AT THE NORTHWEST CORNER OF 67TH ST AND LAFAYETTE AVE
- BENCH MARK NO. 3545 ELEV. 10.53**  
DESCRIPTION: CROSS CUT ON NORTHWEST BOLT OF LIGHT POLE BASE AT THE NORTHWEST CORNER OF 71ST ST AND LAFAYETTE AVE

- CURVE NBRMPO1**  
P.I. STA= 8200+00.02  
N= 1,858,147.27  
E= 1,177,489.42  
Δ= 4° 44' 18"  
D= 28° 38' 52"  
R= 200.00'  
T= 8.27'  
L= 16.54'  
E= 0.17'  
e= N/A  
T.R.= N/A  
S.E. RUN= N/A  
P.C. STA= 8199+91.75  
N= 1,858,139.01  
E= 1,177,489.70  
P.T. STA= 8200+08.29  
N= 1,858,155.49  
E= 1,177,488.45
- CURVE NBRMPO2**  
P.I. STA= 8208+54.00  
N= 1,858,995.39  
E= 1,177,389.40  
Δ= 4° 55' 59"  
D= 3° 49' 11"  
R= 1,500.00'  
T= 64.61'  
L= 129.15'  
E= 1.39'  
e= N/A  
T.R.= N/A  
S.E. RUN= N/A  
P.C. STA= 8211+07.05  
N= 1,858,931.22  
E= 1,177,396.97  
P.T. STA= 8209+18.54  
N= 1,859,059.97  
E= 1,177,387.38
- CURVE NBRMPO3**  
P.I. STA= 8211+46.07  
N= 1,859,287.39  
E= 1,177,380.27  
Δ= 0° 19' 12"  
D= 0° 24' 36"  
R= 13,976.00'  
T= 39.03'  
L= 78.05'  
E= 0.05'  
e= N/A  
T.R.= N/A  
S.E. RUN= N/A  
P.C. STA= 8211+07.05  
N= 1,859,248.39  
E= 1,177,381.49  
P.T. STA= 8211+85.10  
N= 1,859,326.41  
E= 1,177,379.26
- CURVE NBRMPO4**  
P.I. STA= 8212+33.29  
N= 1,859,374.58  
E= 1,177,378.02  
Δ= 3° 40' 48"  
D= 3° 49' 11"  
R= 1,500.00'  
T= 48.10'  
L= 96.17'  
E= 0.77'  
e= N/A  
T.R.= N/A  
S.E. RUN= N/A  
P.C. STA= 8211+85.10  
N= 1,859,326.41  
E= 1,177,379.26  
P.T. STA= 8212+81.44  
N= 1,859,422.73  
E= 1,177,379.88

- CURVE NBRMPO5**  
P.I. STA= 8216+21.17  
N= 1,859,762.21  
E= 1,177,392.97  
Δ= 3° 40' 25"  
D= 3° 49' 11"  
R= 1,500.00'  
T= 48.10'  
L= 96.17'  
E= 0.77'  
e= N/A  
T.R.= N/A  
S.E. RUN= N/A  
P.C. STA= 8215+73.07  
N= 1,859,714.14  
E= 1,177,391.11  
P.T. STA= 8216+69.24  
N= 1,859,810.29  
E= 1,177,391.74
- CURVE SBLOCS01**  
P.I. STA= 3391+35.61  
N= 1,860,506.29  
E= 1,177,130.62  
Δ= 15° 38' 54"  
D= 2° 47' 17"  
R= 2,055.00'  
T= 282.39'  
L= 561.26'  
E= 19.31'  
e= 5.5'  
T.R.= 41'  
S.E. RUN= 196'  
P.C. STA= 3388+53.23  
N= 1,860,224.26  
E= 1,177,144.78  
P.T. STA= 3394+14.48  
N= 1,860,774.05  
E= 1,177,040.92

NOTES:  
1. AVERAGE GRID TO GROUND CONVERSION FACTOR = 1.000010988654360



REVISIONS	
NAME	DATE

ILLINOIS DEPARTMENT OF TRANSPORTATION  
F.A.I. 90/94 (DAN RYAN EXPRESSWAY)  
63RD STREET GATEWAY LANDSCAPING AND IRRIGATION

**ALIGNMENT PLAN**

SCALE: 1"=100'  
DATE: MAY 02, 2008

DRAWN BY: NJH/AMM  
CHECKED BY: JAL/MS

F:\P\40468\Civil\29\_gateway\_1\irrigations\122F\_63RD\24\22F00121.dwg 03/10/2008 03:49:05 PM