

F.A.I. RTE.	SECTION	COUNTY	TOTAL SHEETS	SHEET NO.
90/94	2005-071 LS	COOK	39	26
STA. 3418+00		TO STA. 3428+00		
FED. ROAD DIST. NO. 1		ILLINOIS	FED. AID PROJECT	
60A77				

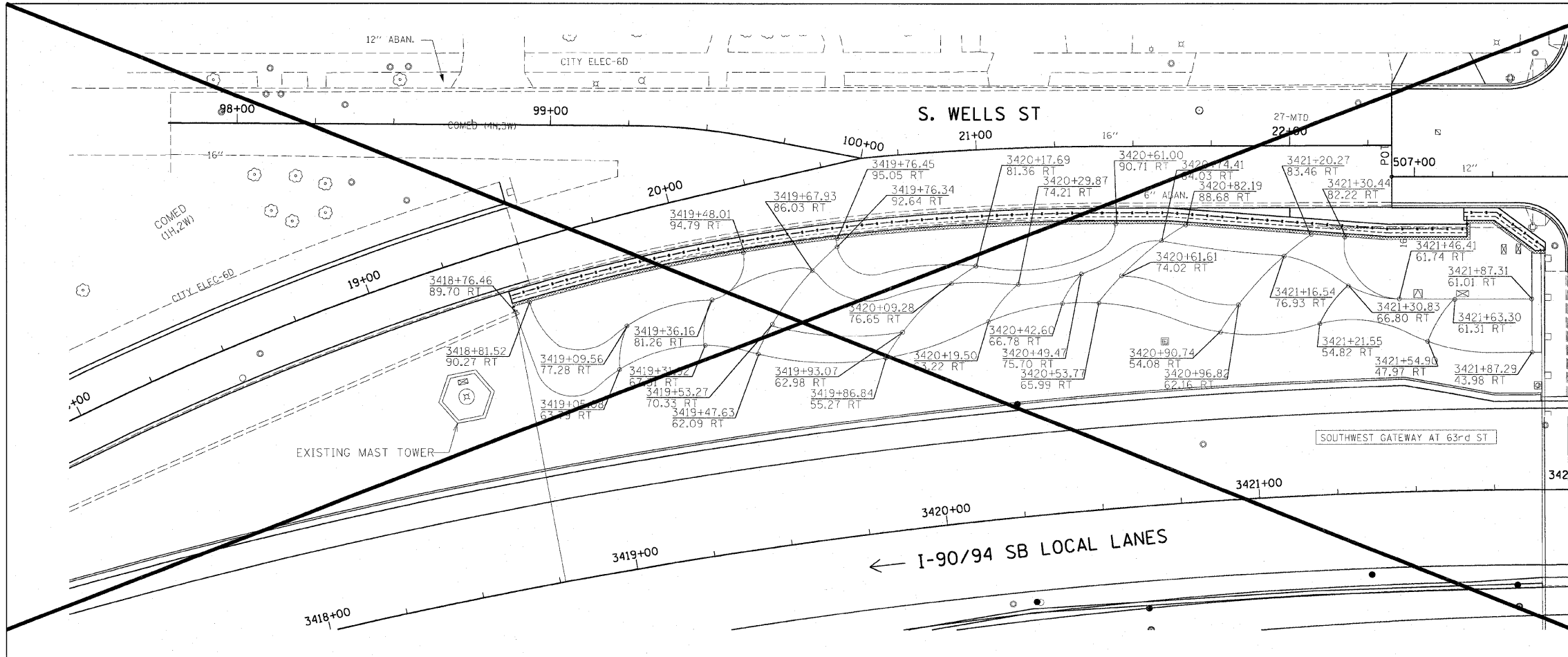

X NOT INCLUDED IN THIS CONTRACT

NOTE: THE LOCATION OF ALL PLANT MATERIAL SHALL BE STAKED BY CONTRACTOR FOR APPROVAL BY ENGINEER IN FIELD, PRIOR TO INSTALLATION. INDIVIDUAL TREES SHALL BE STAKED WITH IDENTITIES WRITTEN ON STAKES. SHRUB AND PERENNIAL BEDS SHALL BE OUTLINED WITH STAKES AND PAINTED LINES.

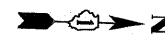
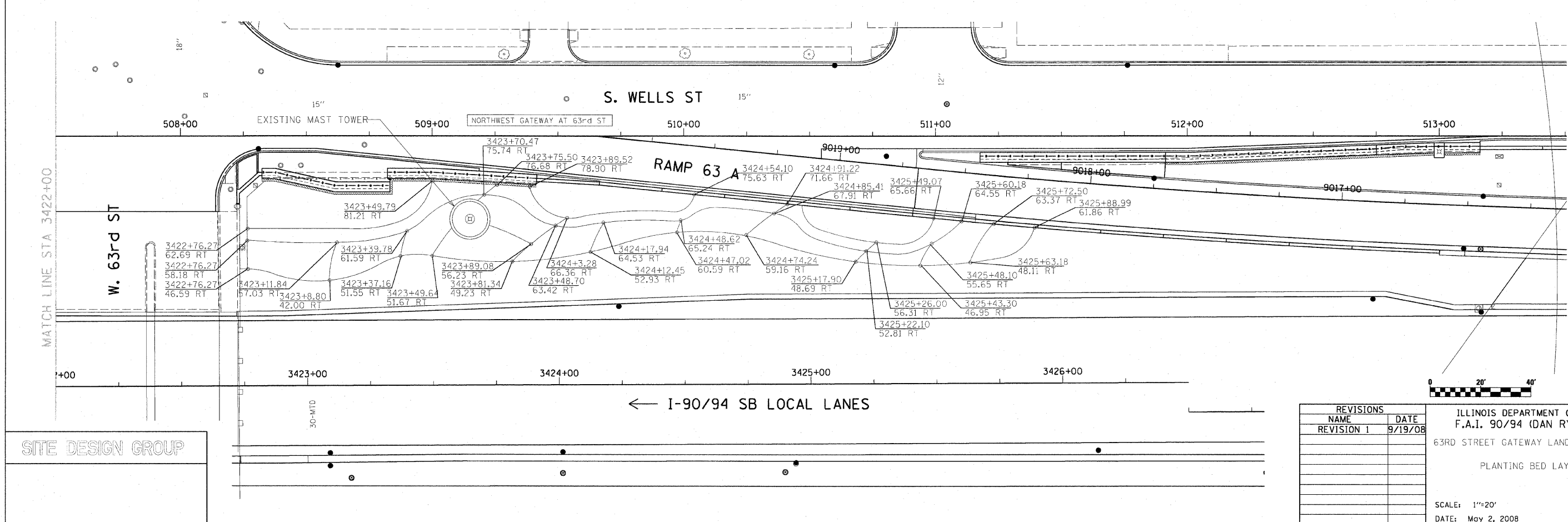

SITE DESIGN GROUP

REVISIONS	
NAME	DATE
REVISION 1	9/19/08

ILLINOIS DEPARTMENT OF TRANSPORTATION
 F.A.I. 90/94 (DAN RYAN EXPRESSWAY)
 63RD STREET GATEWAY LANDSCAPING AND IRRIGATION
 PLANTING BED LAYOUT PLANS
 SCALE: 1"=20'
 DATE: May 2, 2008
 DRAWN BY: EM
 CHECKED BY: JO

P:\P40468\civ\23-gateway-irrigation\sg\081908\sg\files\662.63rdL_C00R.dwg 5/18/2008 1:08:50 PM