

F.A.I. RTE.	SECTION	COUNTY	TOTAL SHEETS	SHEET NO.
90/94	2005-071 LS	COOK	39	27
STA. 4418+50		TO STA. 4427+05		
FED. ROAD DIST. NO. 1		ILLINOIS FED. AID PROJECT		
60A77				

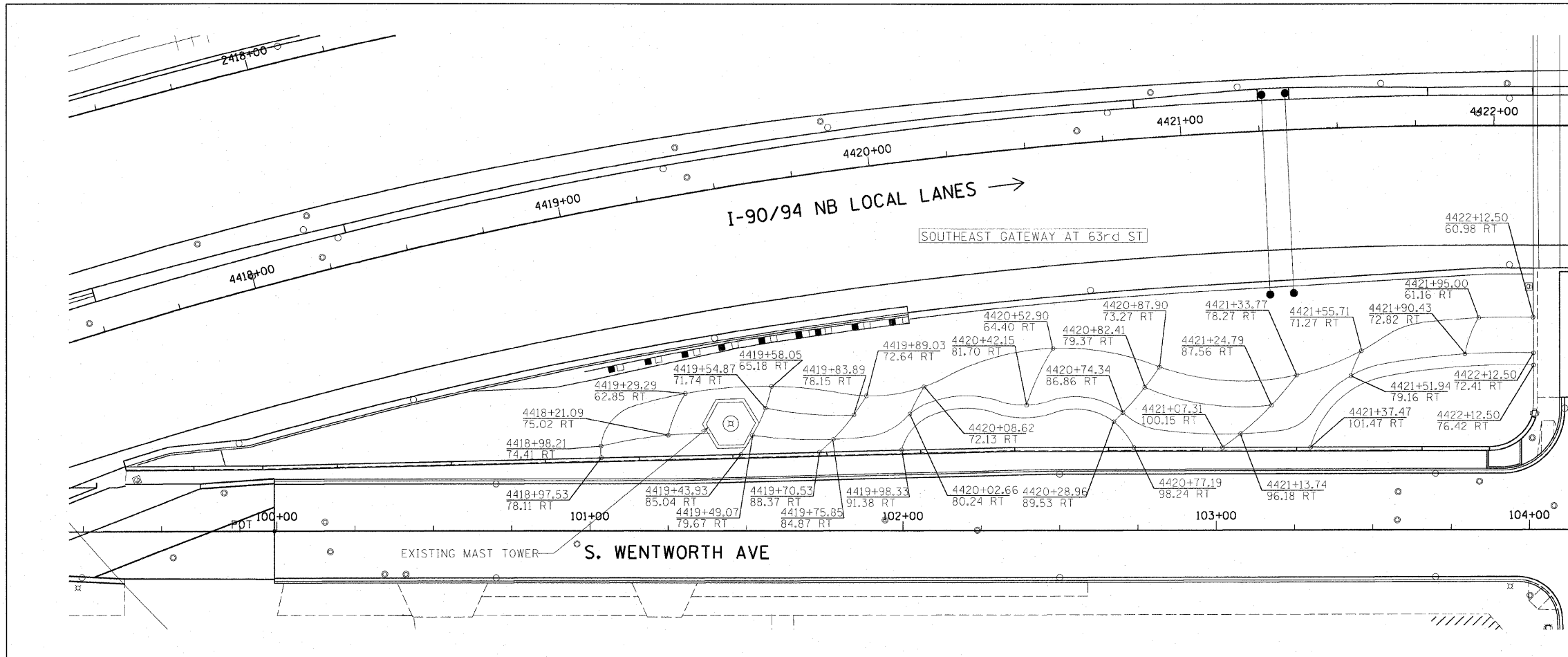

MATCH LINE STA 4422+25  
W. 63rd ST

**X** NOT INCLUDED IN THIS CONTRACT

NOTE: THE LOCATION OF ALL PLANT MATERIAL SHALL BE STAKED BY CONTRACTOR FOR APPROVAL BY ENGINEER IN FIELD PRIOR TO INSTALLATION. INDIVIDUAL TREES SHALL BE STAKED WITH IDENTITIES WRITTEN ON STAKES. SHRUB AND PERENNIAL BEDS SHALL BE OUTLINED WITH STAKES AND PAINTED LINES.

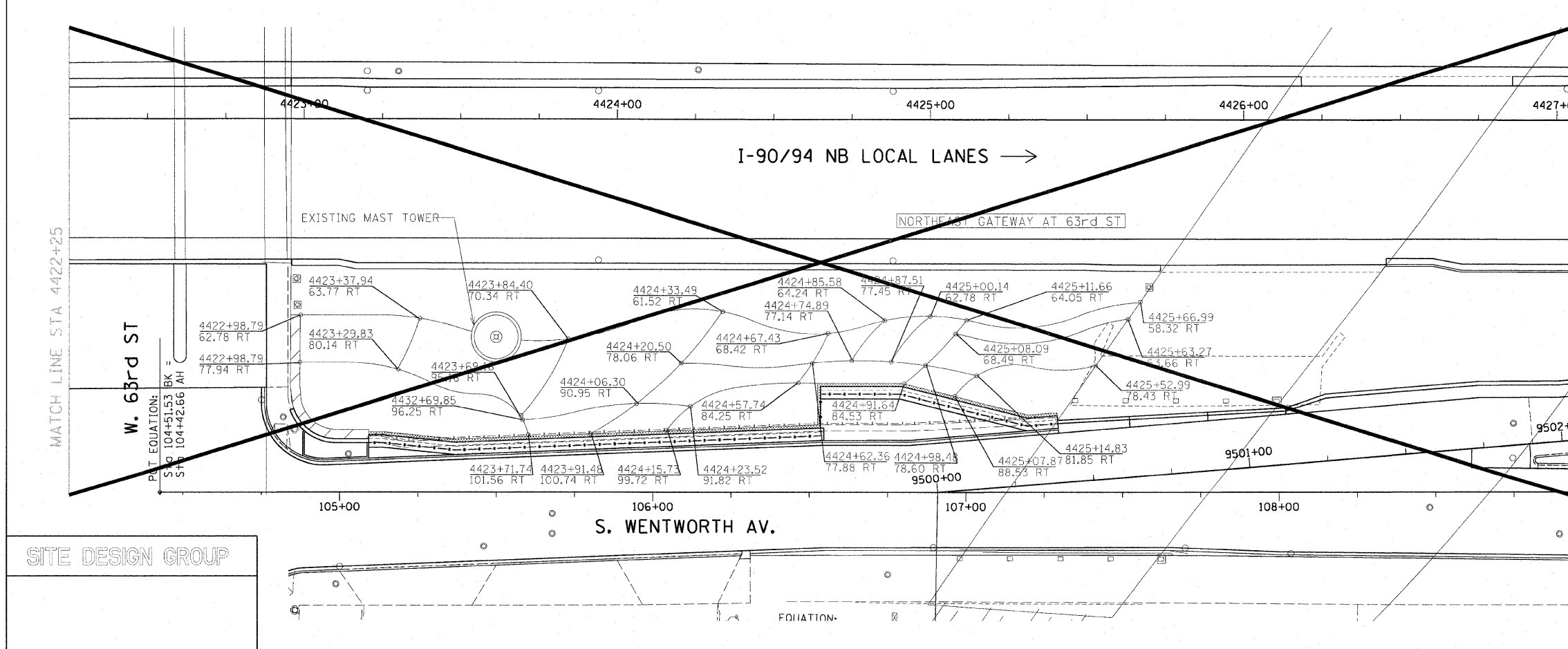

MATCH LINE STA 4422+25

W. 63rd ST

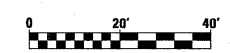

REVISIONS	
NAME	DATE
REVISION 1	9/19/08

ILLINOIS DEPARTMENT OF TRANSPORTATION  
F.A.I. 90/94 (DAN RYAN EXPRESSWAY)  
63RD STREET GATEWAY LANDSCAPE AND IRRIGATION  
PLANTING BED LAYOUT PLANS

SCALE: 1"=20'  
DATE: May 2, 2008

DRAWN BY: EM  
CHECKED BY: JO

SITE DESIGN GROUP

I:\p\0466\civil\29-gateway\_irrigation\sg080908\sg080908.dwg Files\6162\_63rd\27-000.dwg