

F.A.I. RTE.	SECTION	COUNTY	TOTAL SHEETS	SHEET NO.
90/94	2005-071 LS	COOK	39	29
STA. 4418+50		TO STA. 4427+05		
FED. ROAD DIST. NO. 1		ILLINOIS FED. AID PROJECT		

60A77



LEGEND:

- AREA TO BE IRRIGATED
- NOT INCLUDED IN THIS CONTRACT

NOTES:

1. ALL PERENNIAL AND SHRUB BEDS SHALL BE IRRIGATED.
2. FOR IRRIGATION SERVICE DETAILS SEE WATER SERVICE LINE PLANS.
3. ALL CORNER GARDENS SHALL BE IRRIGATED.

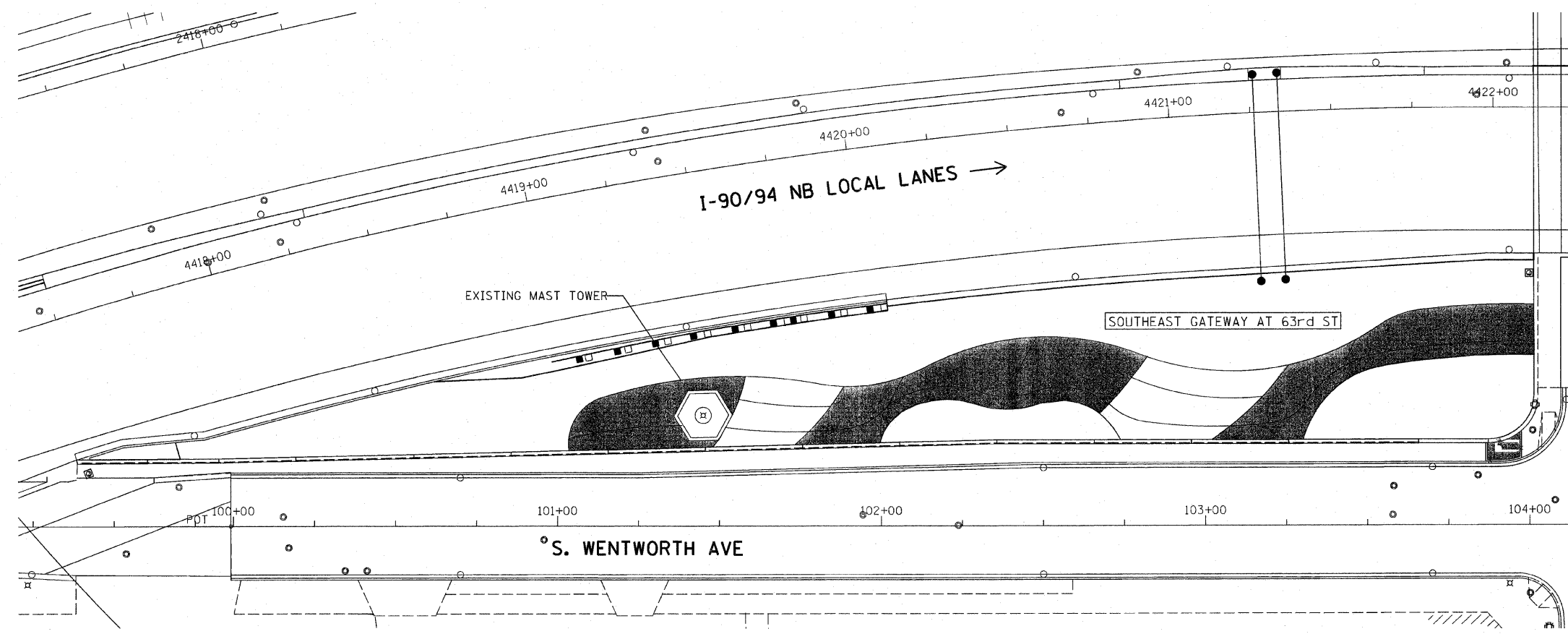

MATCH LINE STA 4422+25
W. 63rd ST

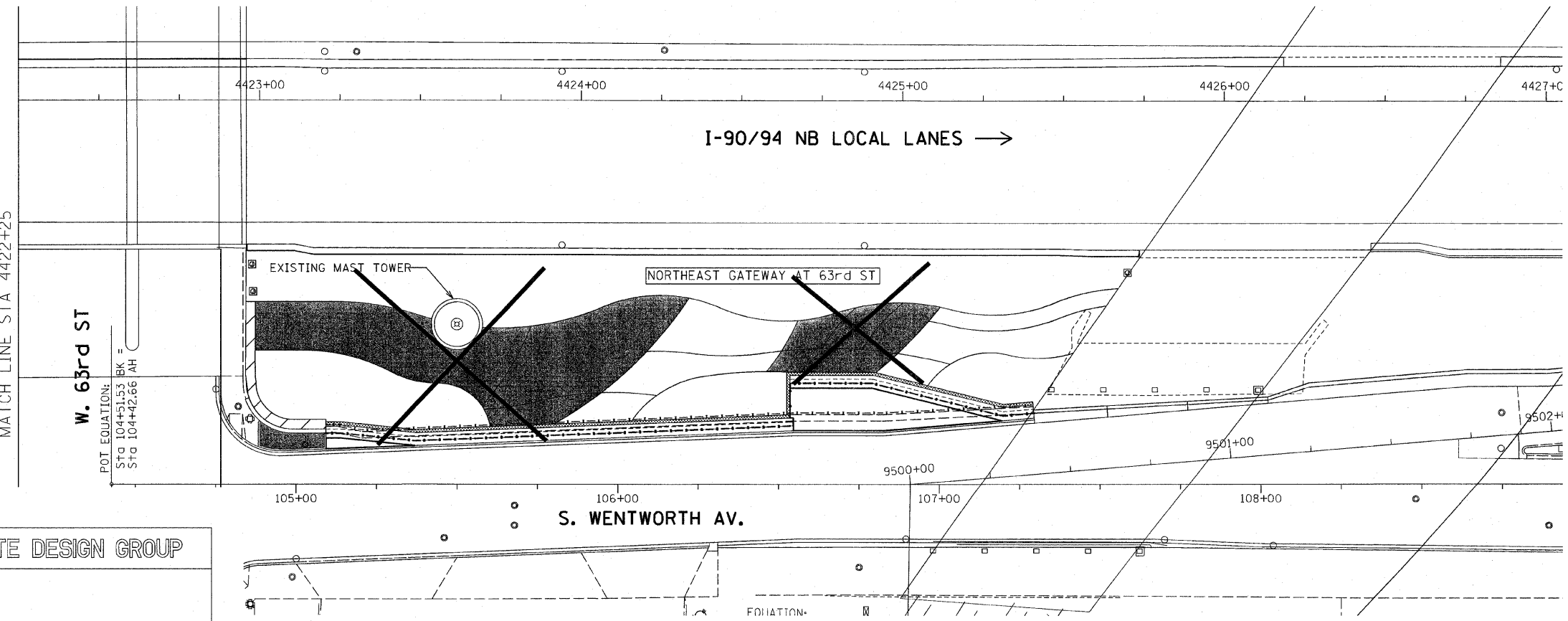

MATCH LINE STA 4422+25

W. 63rd ST

POT EQUATION:
STG 104+51.53 BK =
STG 104+42.66 AH

SITE DESIGN GROUP

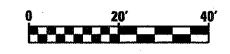

SHT-I-2

REVISIONS	
NAME	DATE
REVISION 1	9/19/08

ILLINOIS DEPARTMENT OF TRANSPORTATION
F.A.I. 90/94 (DAN RYAN EXPRESSWAY)
63RD STREET GATEWAY LANDSCAPE AND IRRIGATION
IRRIGATION PLANS

SCALE: 1"=20'
DATE: May 2, 2008
DRAWN BY: EM
CHECKED BY: JO

DATE