

F.A.P. RTE.	SECTION	COUNTY	TOTAL SHEETS	SHEET NO.
876	9Y-RS-7	WILL	100	14
STA. 1+100		TO STA. 1+475		
FED. ROAD DIST. NO. 1		ILLINOIS FED. AID PROJECT		
CONTRACT #60E52				

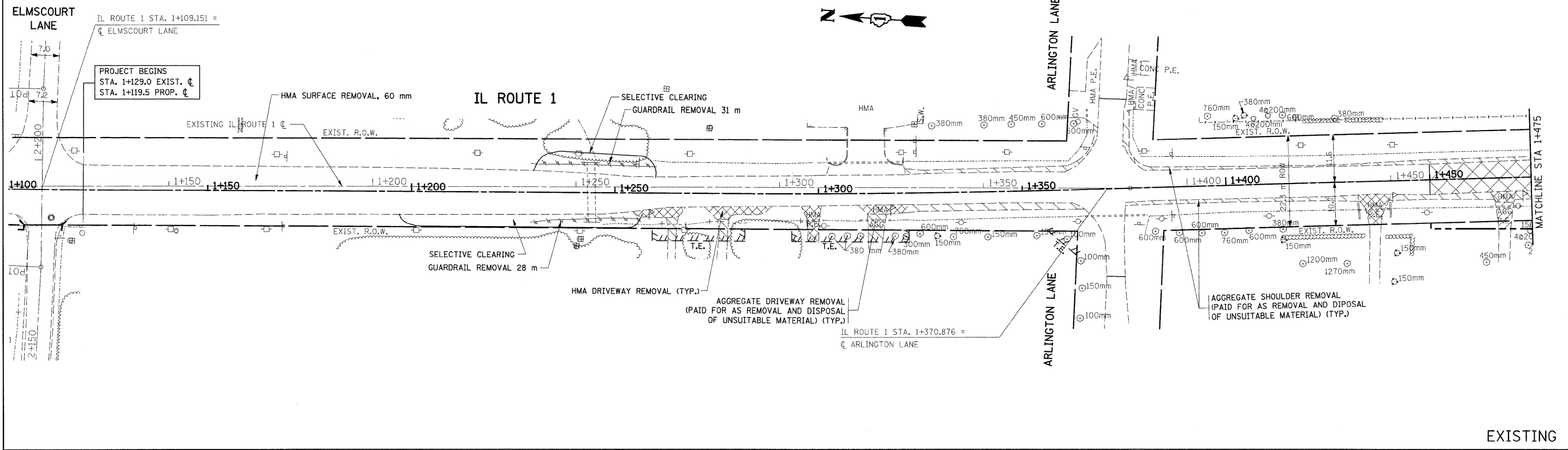

EXISTING

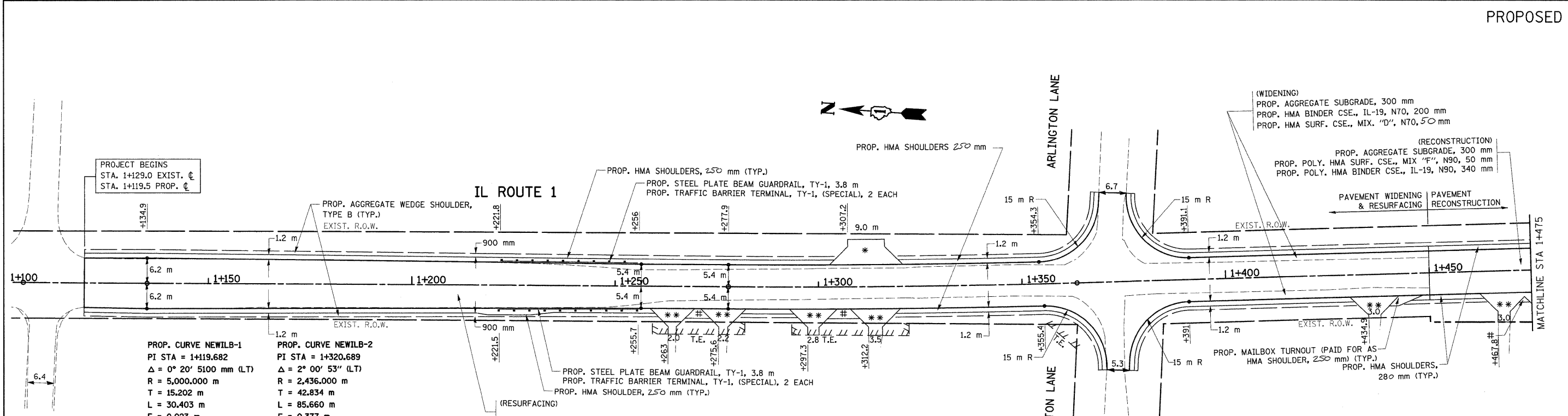

PROPOSED

<p>PROP. CURVE NEWILB-1 PI STA = 1+119.682 Δ = 0° 20' 5100 mm (LT) R = 5,000.000 m T = 15.202 m L = 30.403 m E = 0.023 m e = ----- T.R. = ----- m S.E. RUN. = ----- m P.C. STA = 1+104.481 P.T. STA = 1+134.884</p>	<p>PROP. CURVE NEWILB-2 PI STA = 1+320.689 Δ = 2° 00' 53" (LT) R = 2,436.000 m T = 42.834 m L = 85.660 m E = 0.377 m e = ----- T.R. = ----- m S.E. RUN. = ----- m P.C. STA = 1+277.855 P.T. STA = 1+363.515</p>
---	---

REVISIONS	
NAME	DATE

ILLINOIS DEPARTMENT OF TRANSPORTATION

**IL. ROUTE 1
EXISTING AND PROPOSED
ROADWAY PLAN**

SCALE 1:500
DATE 8/28/2008

DRAWN BY
CHECKED BY