

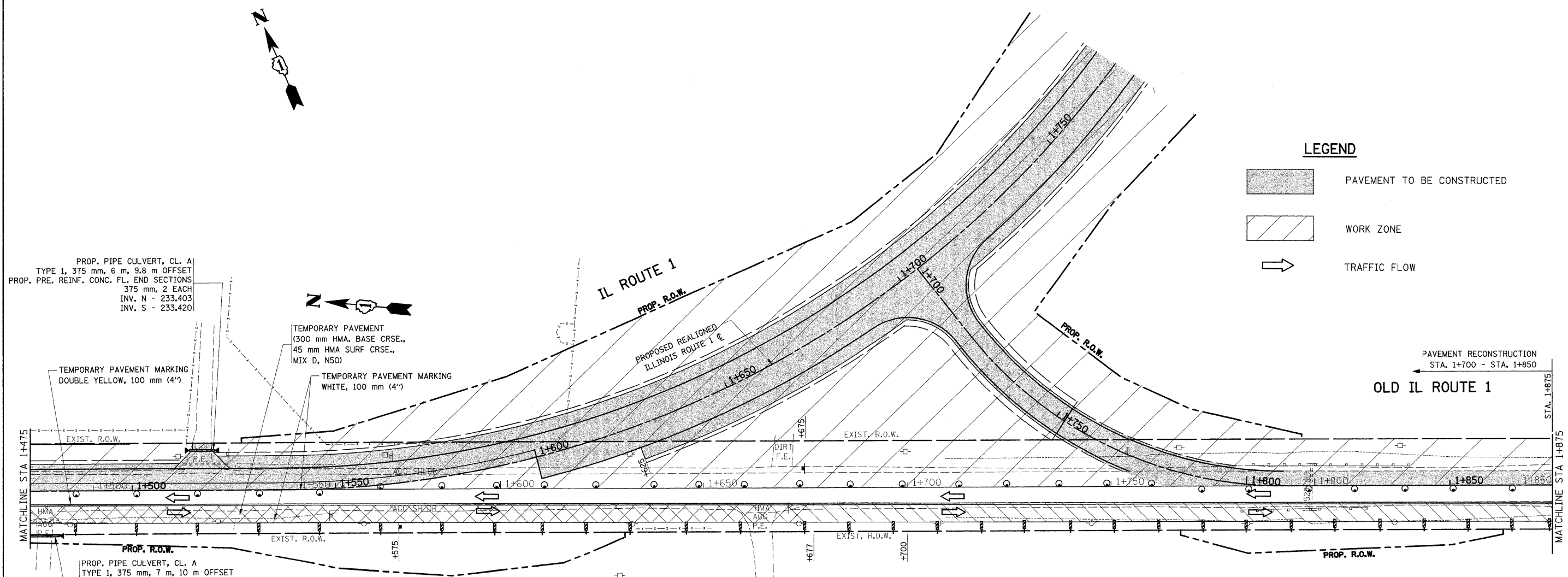

F.A.P. RTE.	SECTION	COUNTY	TOTAL SHEETS	SHEET NO.
876	9Y-RS-7	WILL	100	25
STA. 1+475		TO STA. 1+875		
FED. ROAD DIST. NO. 1		ILLINOIS FED. AID PROJECT		

CONTRACT NO. 60E52

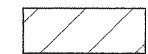
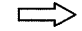

LEGEND

-  PAVEMENT TO BE CONSTRUCTED
-  WORK ZONE
-  TRAFFIC FLOW

PROP. PIPE CULVERT, CL. A
TYPE 1, 375 mm, 6 m, 9.8 m OFFSET
PROP. PRE. REINF. CONC. FL. END SECTIONS
375 mm, 2 EACH
INV. N - 233.403
INV. S - 233.420

TEMPORARY PAVEMENT
(300 mm HMA. BASE CRSE.,
45 mm HMA SURF CRSE.,
MIX D, N50)

TEMPORARY PAVEMENT MARKING
DOUBLE YELLOW, 100 mm (4")

TEMPORARY PAVEMENT MARKING
WHITE, 100 mm (4")

PAVEMENT RECONSTRUCTION
STA. 1+700 - STA. 1+850
OLD IL ROUTE 1

PROP. PIPE CULVERT, CL. A
TYPE 1, 375 mm, 7 m, 10 m OFFSET
PROP. PRE. REINF. CONC. FL. END SECTIONS
375 mm, 2 EACH
INV. N - 233.100
INV. S - 233.105

REVISIONS	
NAME	DATE

ILLINOIS DEPARTMENT OF TRANSPORTATION
**SUGGESTED
MAINTENANCE OF TRAFFIC
IL. 1
STAGE I**

SCALE 1:500
DATE 9/3/2008

DRAWN BY
CHECKED BY