

F.A.P. RTE.	SECTION	COUNTY	TOTAL SHEETS	SHEET NO.
876	9Y-RS-7	WILL	100	30
STA. 1+100		TO STA. 1+875		
FED. ROAD DIST. NO. 1		ILLINOIS FED. AID PROJECT		
CONTRACT NO. 60E52				

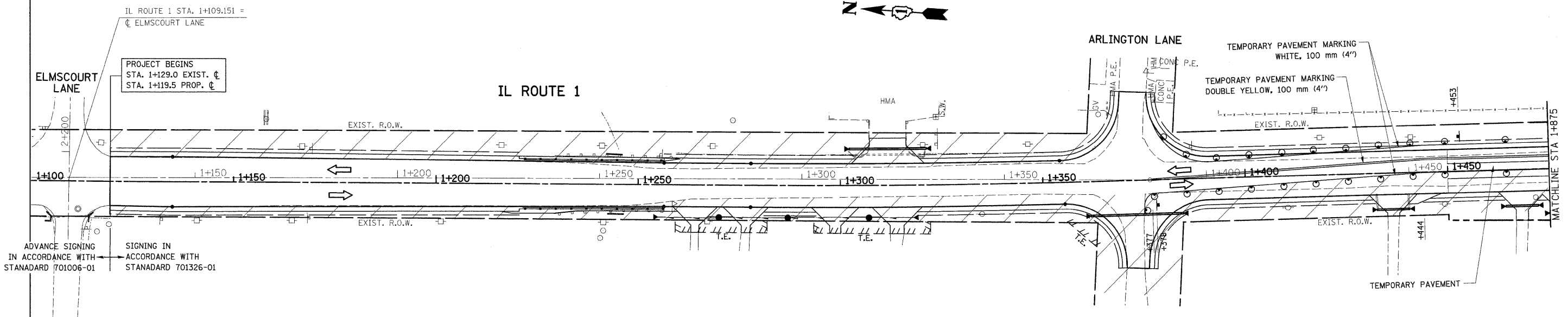

PROJECT BEGINS  
STA. 1+129.0 EXIST. C  
STA. 1+119.5 PROP. C

IL ROUTE 1 STA. 1+109.151 =  
C ELMSCOURT LANE

ELMSCOURT LANE

IL ROUTE 1

ARLINGTON LANE

TEMPORARY PAVEMENT MARKING  
WHITE, 100 mm (4")  
TEMPORARY PAVEMENT MARKING  
DOUBLE YELLOW, 100 mm (4")

ADVANCE SIGNING  
IN ACCORDANCE WITH  
STANADARD 701006-01

SIGNING IN  
ACCORDANCE WITH  
STANADARD 701326-01

TEMPORARY PAVEMENT

**LEGEND**

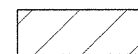

WORK ZONE



TRAFFIC FLOW DIRECTION



DRUM WITH STEADY BURNING MONODIRECTIONAL LIGHT @ 15 m CTS.,  
8 m CTS. IN TAPER AND ON CURVES

REVISIONS	
NAME	DATE

ILLINOIS DEPARTMENT OF TRANSPORTATION  
**SUGGESTED  
MAINTENANCE OF TRAFFIC  
IL. 1  
STAGE III**

SCALE 1:500  
DATE 9/3/2008

DRAWN BY  
CHECKED BY