

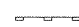
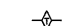
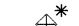

F.A.P. RTE.	SECTION	COUNTY	TOTAL SHEETS	SHEET NO.
876	9Y-RS-7	WILL	100	38
STA. 1+475		TO STA. 1+875		
FED. ROAD DIST. NO. 1		ILLINOIS FED. AID PROJECT		

CONTRACT NO. 60E52

LEGEND

-  PERIMETER EROSION CONTROL
-  TEMPORARY DITCH CHECKS, URETHANE FORM
-  SEDIMENT CONTROL DRAINAGE STRUCTURE INLET FILTER CLEANING
-  INLET FILTERS

 PAVEMENT TO BE CONSTRUCTED

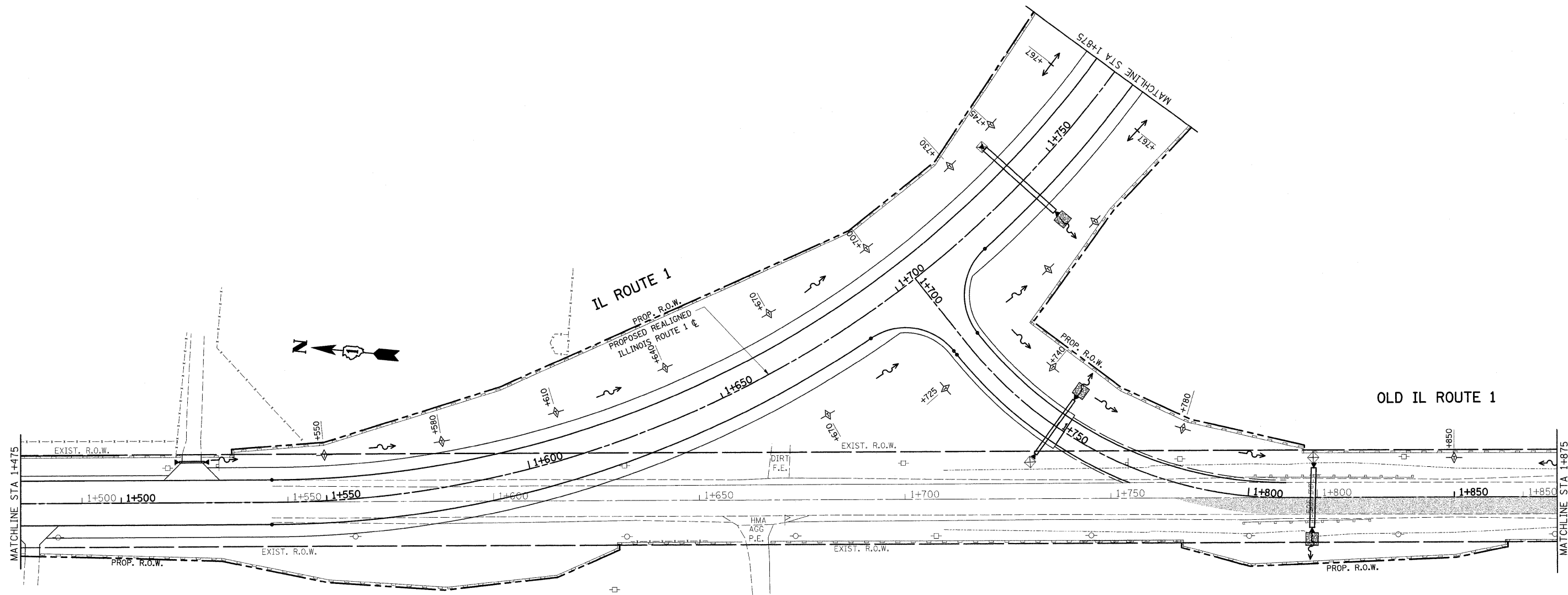

REVISIONS	
NAME	DATE

ILLINOIS DEPARTMENT OF TRANSPORTATION  
**EROSION CONTROL PLAN**  
**IL. 1**  
**STAGE II**

SCALE 1:500  
 DATE 9/23/2008

DRAWN BY  
 CHECKED BY