

**31st STREET
STAGE II
ROADWAY TYPICAL SECTION**

(A) TEMPORARY CONCRETE BARRIER TO BE PLACED IN ALL AREAS WHERE EXISTING GUARDRAIL HAS BEEN REMOVED AND PROPOSED GUARDRAIL IS NOT YET IN PLACE.

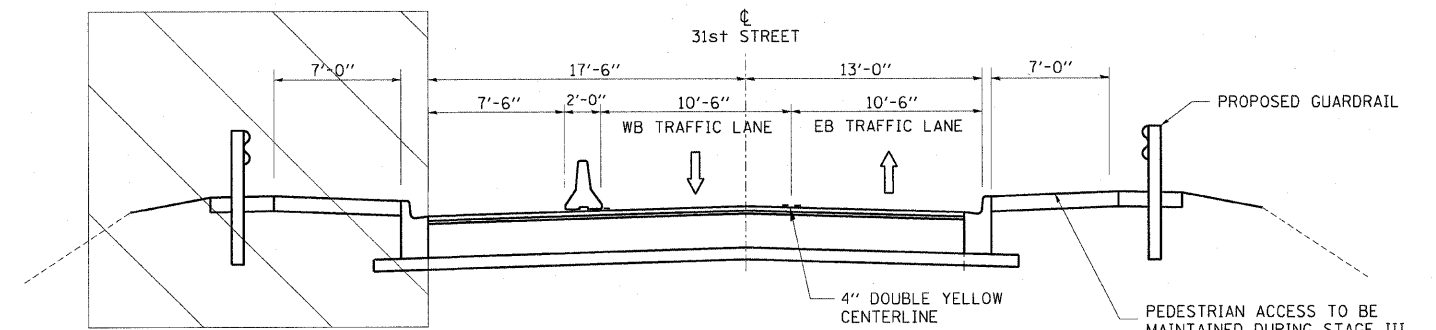

**31st STREET
STAGE III
ROADWAY TYPICAL SECTION**

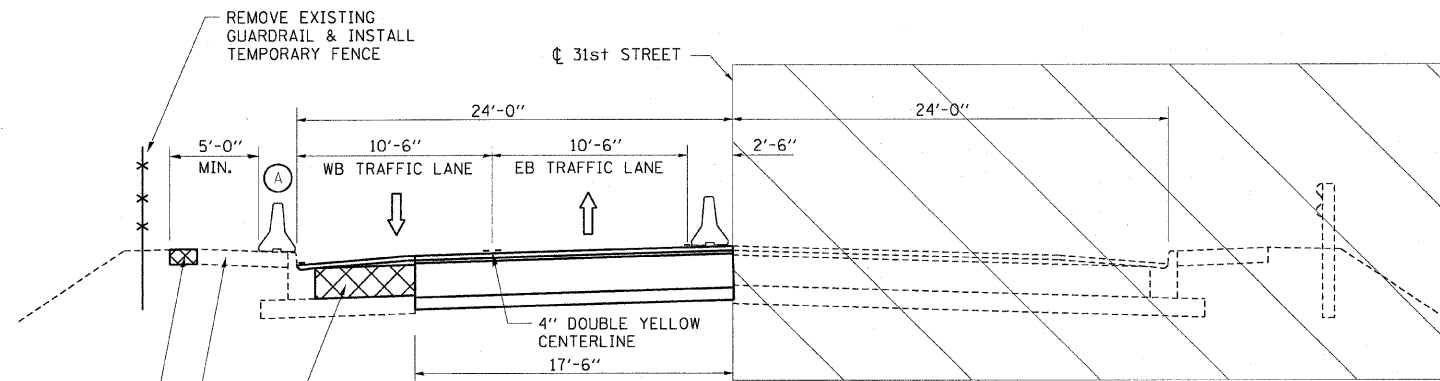

**31st STREET
STAGE II
ROADWAY TYPICAL SECTION
BETWEEN STRUCTURES**

PEDESTRIAN ACCESS TO BE MAINTAINED DURING STAGE II AT ALL TIMES

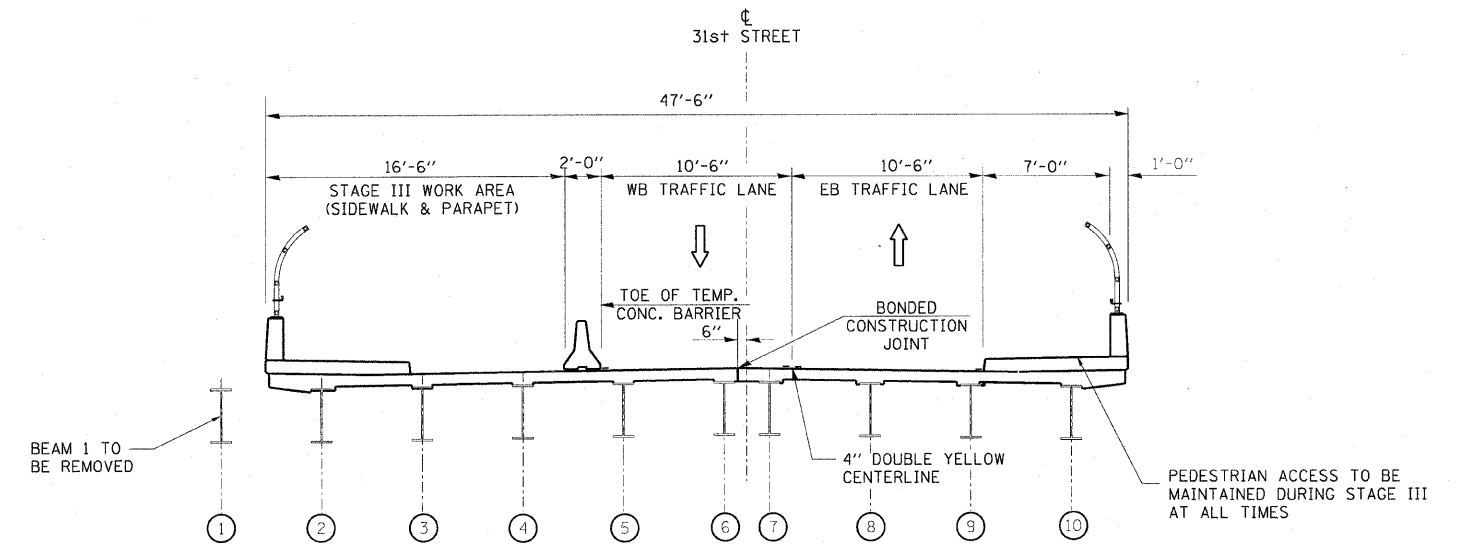

**31st STREET
STAGE III
STRUCTURE TYPICAL SECTION**

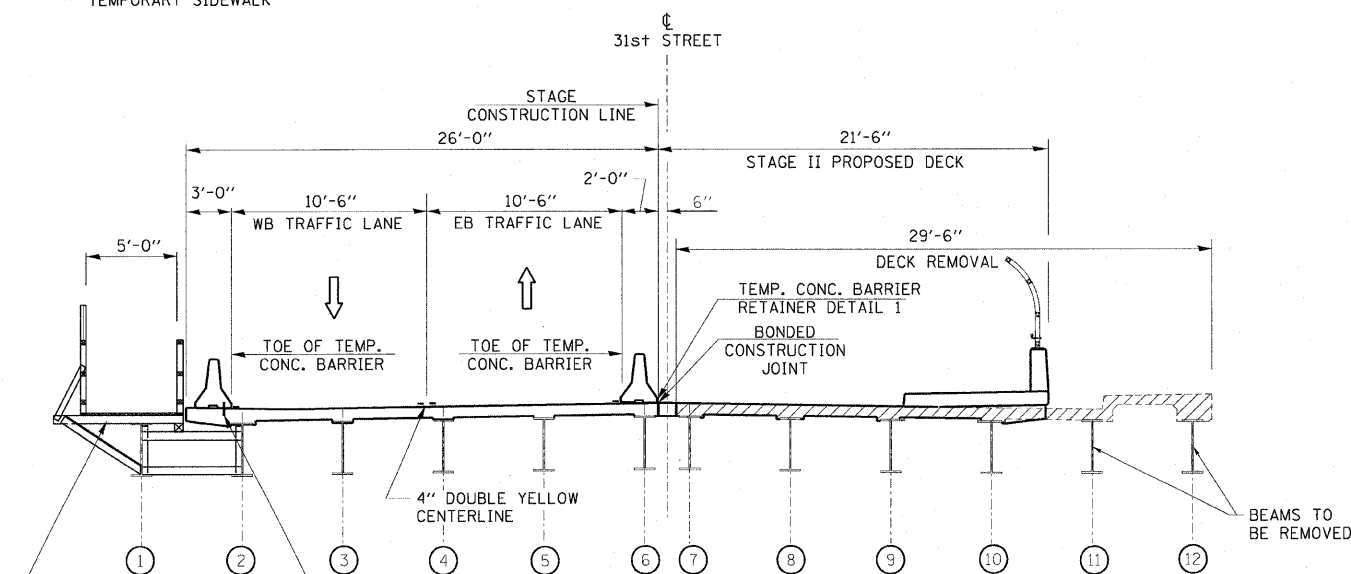

**31st STREET
STAGE II
STRUCTURE TYPICAL SECTION**

TEMPORARY WALKWAY (SEE STRUCTURAL PLANS)

REVISIONS	
NAME	DATE

ILLINOIS DEPARTMENT OF TRANSPORTATION
31st STREET
**SUGGESTED
MAINTENANCE OF TRAFFIC
TYPICAL SECTIONS**

SCALE: N.T.S. DRAWN BY: CJO
DATE: APRIL 8, 2008 CHECKED BY: MJE