

DATE: _____ BY: _____
 CHECKED: _____
 NO. _____

DATE: _____ BY: _____
 CHECKED: _____
 NO. _____

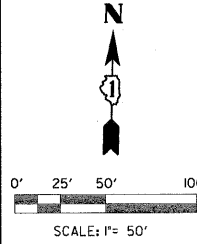

MATCH LINE STA. 213+00

MATCH LINE STA. 226+00

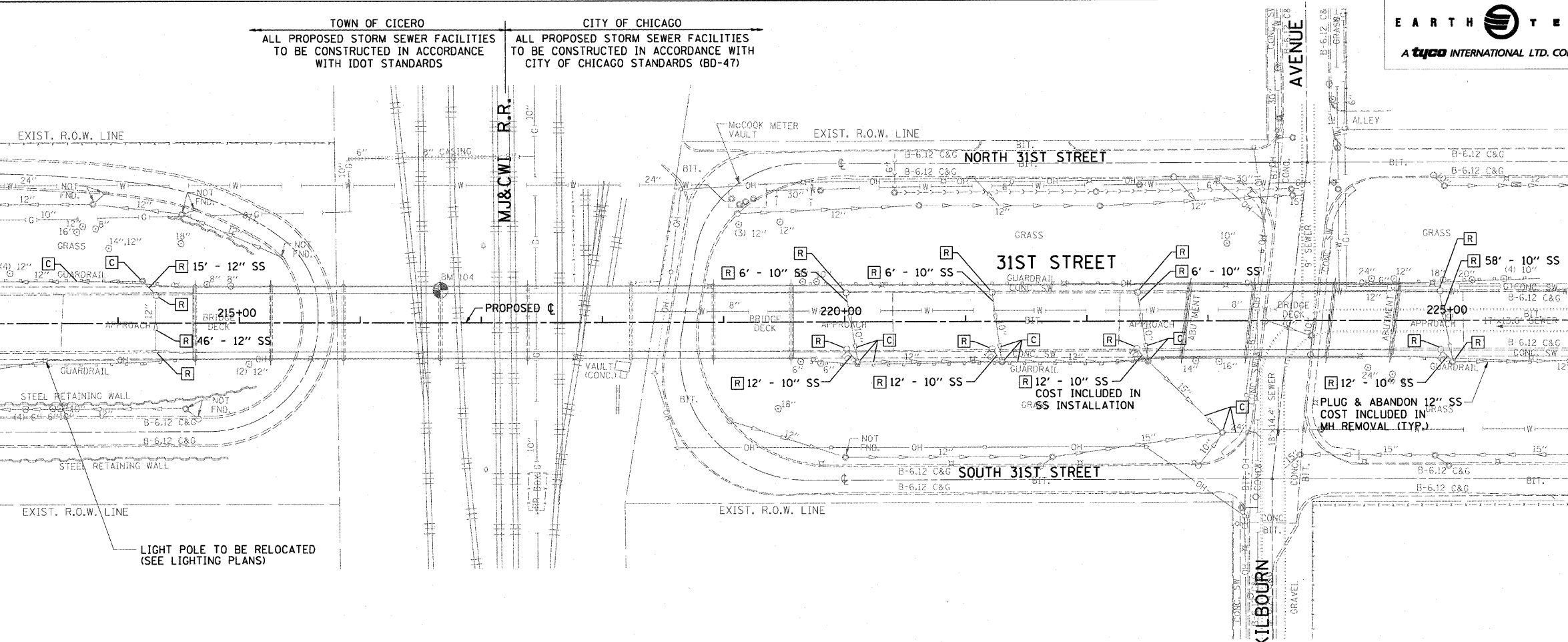

EARTH TECH
 A tyco INTERNATIONAL LTD. COMPANY

F.A.U. RTE.	SECTION	COUNTY	TOTAL SHEETS	SHEET NO.
1463	1010.1B	COOK	171	31
STA. 213+00		TO STA. 226+00		
FED. ROAD DIST. NO.		ILLINOIS FED. AID PROJECT		
CONTRACT NO. 62196				

- LEGEND**
- EXISTING STORM SEWER
 - SANITARY SEWER
 - W— WATER MAIN
 - G— GAS MAIN
 - E— ELECTRIC CABLE
 - OH— OVERHEAD UTILITY
 - EXISTING MANHOLE
 - EXISTING CATCH BASIN
 - EXISTING INLET
 - [C] STRUCTURE TO BE CLEANED
 - [R] STRUCTURE TO BE REMOVED
 - [REC] STRUCTURE TO BE RECONSTRUCTED
 - [ADJ] STRUCTURE TO BE ADJUSTED
 - [ADJ] STRUCTURE TO BE ADJUSTED WITH NEW FRAME & GRATE, TYPE 23
 - [ADJ] STRUCTURE TO BE ADJUSTED WITH NEW FRAME & PERFORATED LID, CHICAGO STANDARD
 - (A) VALVE VAULT TO BE ADJUSTED
 - ◇ DOMESTIC SERVICE BOX TO BE ADJUSTED

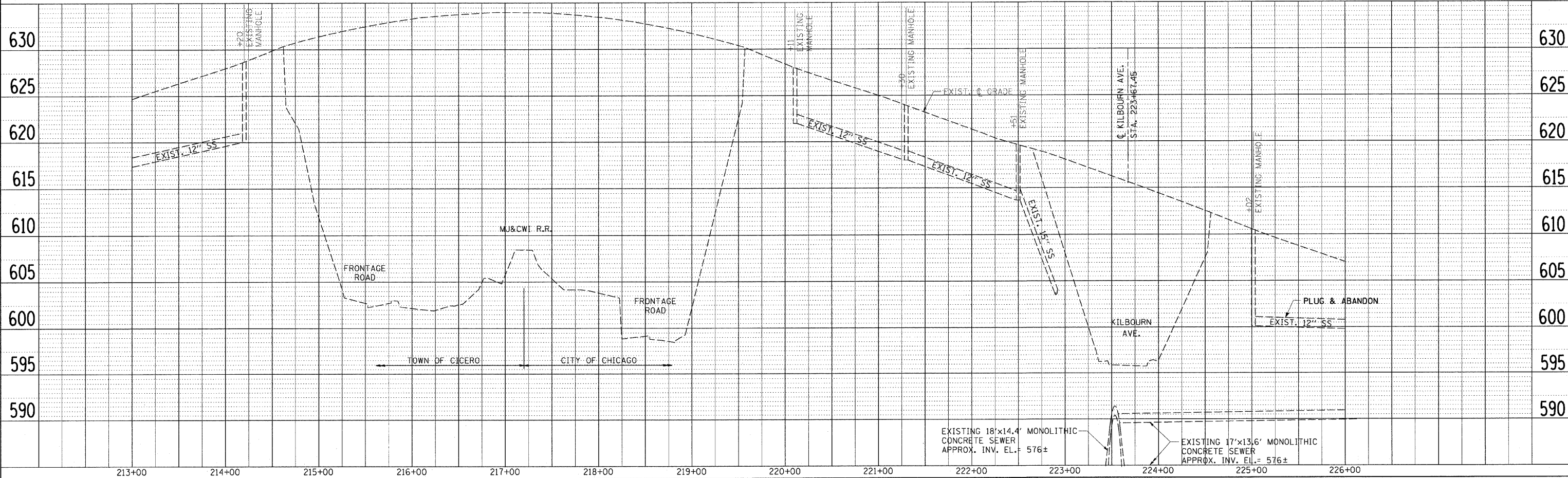

31st STREET - EXISTING DRAINAGE AND UTILITY PLAN AND PROFILE