

- ②② STA. 226+49, 22.5' LT. CITY OF CHICAGO CATCH BASIN, TYPE A, 4' DIA. TYPE 1 FRAME, OPEN LID RIM EL.= 604.89 8" INV.EL.= 599.89 DIRECT CONNECTION TO 17'x13.6' SEWER
- ②③ STA. 226+49, 17.1' RT. CITY OF CHICAGO CATCH BASIN, TYPE A, 4' DIA. TYPE 1 FRAME, OPEN LID RIM EL.= 604.97 8" INV.EL.= 599.97 DIRECT CONNECTION TO 17'x13.6' SEWER

- △65 6' - 8" ESVCP SS TYPE 2 20' - 8" DIP SS TYPE 2 TBF =
- △66 6' - 8" ESVCP SS TYPE 2 20' - 8" DIP SS TYPE 2 TBF =

PLAN	REVISION	DATE
NO.	BY	
NO.	BY	
NO.	BY	
NO.	BY	
NO.	BY	
NO.	BY	
NO.	BY	
NO.	BY	
NO.	BY	
NO.	BY	

PROFILE	REVISION	DATE
NO.	BY	
NO.	BY	
NO.	BY	
NO.	BY	
NO.	BY	
NO.	BY	
NO.	BY	
NO.	BY	
NO.	BY	
NO.	BY	

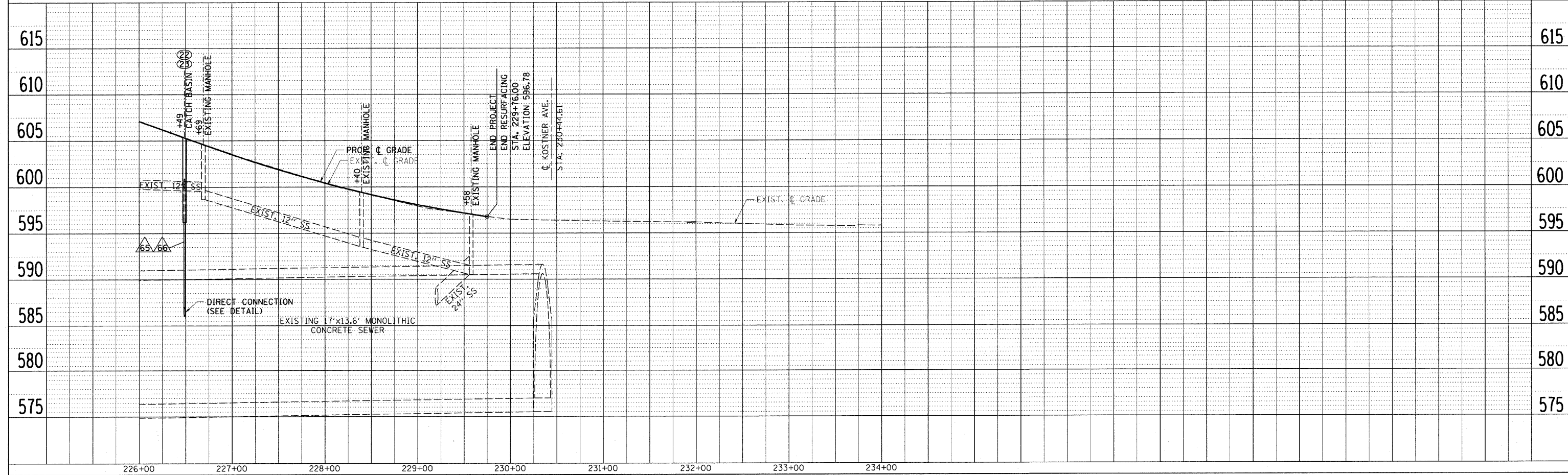

31st STREET - PROPOSED DRAINAGE AND UTILITY PLAN AND PROFILE