

F.A.U. RTE.	SECTION	COUNTY	TOTAL SHEETS	SHEET NO.
1463	1010.1B	COOK	171	37
STA. 403+00		TO STA. 418+00		
FED. ROAD DIST. NO.		ILLINOIS	FED. AID PROJECT	
CONTRACT NO. 62196				

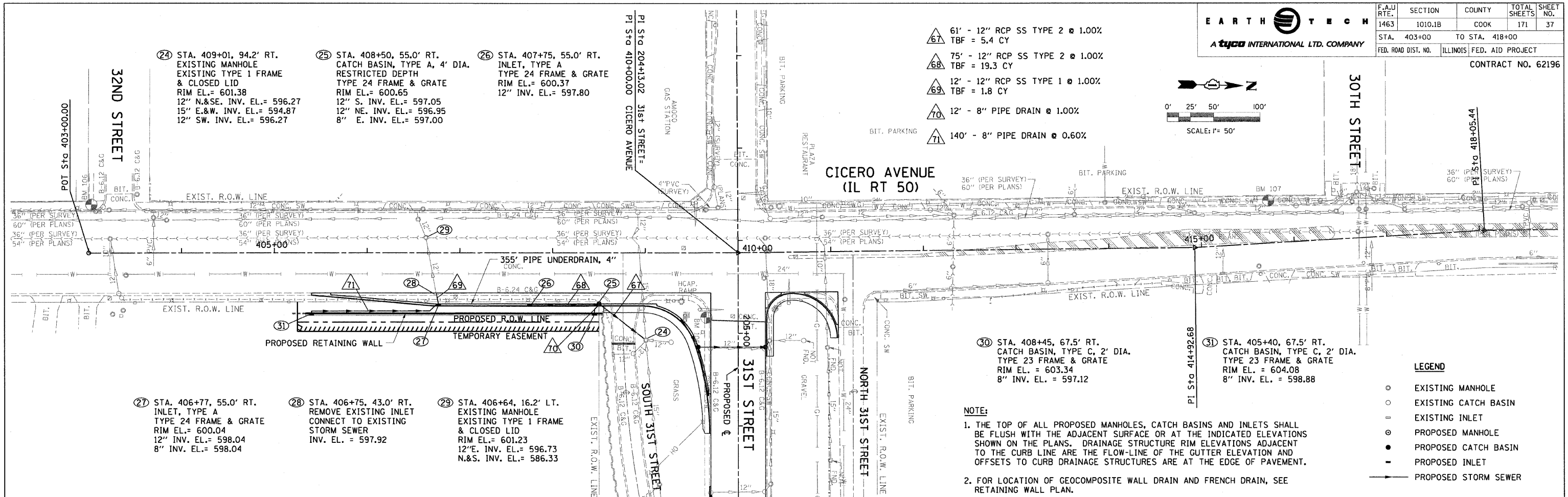
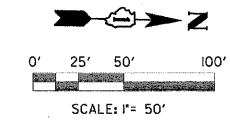

- 24 STA. 409+01, 94.2' RT. EXISTING MANHOLE EXISTING TYPE 1 FRAME & CLOSED LID RIM EL.= 601.38 12" N.&SE. INV. EL.= 596.27 15" E.&W. INV. EL.= 594.87 12" SW. INV. EL.= 596.27
- 25 STA. 408+50, 55.0' RT. CATCH BASIN, TYPE A, 4' DIA. RESTRICTED DEPTH TYPE 24 FRAME & GRATE RIM EL.= 600.65 12" S. INV. EL.= 597.05 12" NE. INV. EL.= 596.95 8" E. INV. EL.= 597.00
- 26 STA. 407+75, 55.0' RT. INLET, TYPE A TYPE 24 FRAME & GRATE RIM EL.= 600.37 12" INV. EL.= 597.80

- 67 61' - 12" RCP SS TYPE 2 @ 1.00% TBF = 5.4 CY
- 68 75' - 12" RCP SS TYPE 2 @ 1.00% TBF = 19.3 CY
- 69 12' - 12" RCP SS TYPE 1 @ 1.00% TBF = 1.8 CY
- 70 12' - 8" PIPE DRAIN @ 1.00%
- 71 140' - 8" PIPE DRAIN @ 0.60%

- 27 STA. 406+77, 55.0' RT. INLET, TYPE A TYPE 24 FRAME & GRATE RIM EL.= 600.04 12" INV. EL.= 598.04 8" INV. EL.= 598.04
- 28 STA. 406+75, 43.0' RT. REMOVE EXISTING INLET CONNECT TO EXISTING STORM SEWER INV. EL. = 597.92
- 29 STA. 406+64, 16.2' LT. EXISTING MANHOLE EXISTING TYPE 1 FRAME & CLOSED LID RIM EL.= 601.23 12"E. INV. EL.= 596.73 N.&S. INV. EL.= 586.33

- 30 STA. 408+45, 67.5' RT. CATCH BASIN, TYPE C, 2' DIA. TYPE 23 FRAME & GRATE RIM EL. = 603.34 8" INV. EL. = 597.12
- 31 STA. 405+40, 67.5' RT. CATCH BASIN, TYPE C, 2' DIA. TYPE 23 FRAME & GRATE RIM EL. = 604.08 8" INV. EL. = 598.88

NOTE:
1. THE TOP OF ALL PROPOSED MANHOLES, CATCH BASINS AND INLETS SHALL BE FLUSH WITH THE ADJACENT SURFACE OR AT THE INDICATED ELEVATIONS SHOWN ON THE PLANS. DRAINAGE STRUCTURE RIM ELEVATIONS ADJACENT TO THE CURB LINE ARE THE FLOW-LINE OF THE GUTTER ELEVATION AND OFFSETS TO CURB DRAINAGE STRUCTURES ARE AT THE EDGE OF PAVEMENT.
2. FOR LOCATION OF GEOCOMPOSITE WALL DRAIN AND FRENCH DRAIN, SEE RETAINING WALL PLAN.

- LEGEND**
- EXISTING MANHOLE
 - EXISTING CATCH BASIN
 - EXISTING INLET
 - PROPOSED MANHOLE
 - PROPOSED CATCH BASIN
 - PROPOSED INLET
 - PROPOSED STORM SEWER

DATE	BY
DATE	BY
DATE	BY

DATE	BY
DATE	BY
DATE	BY

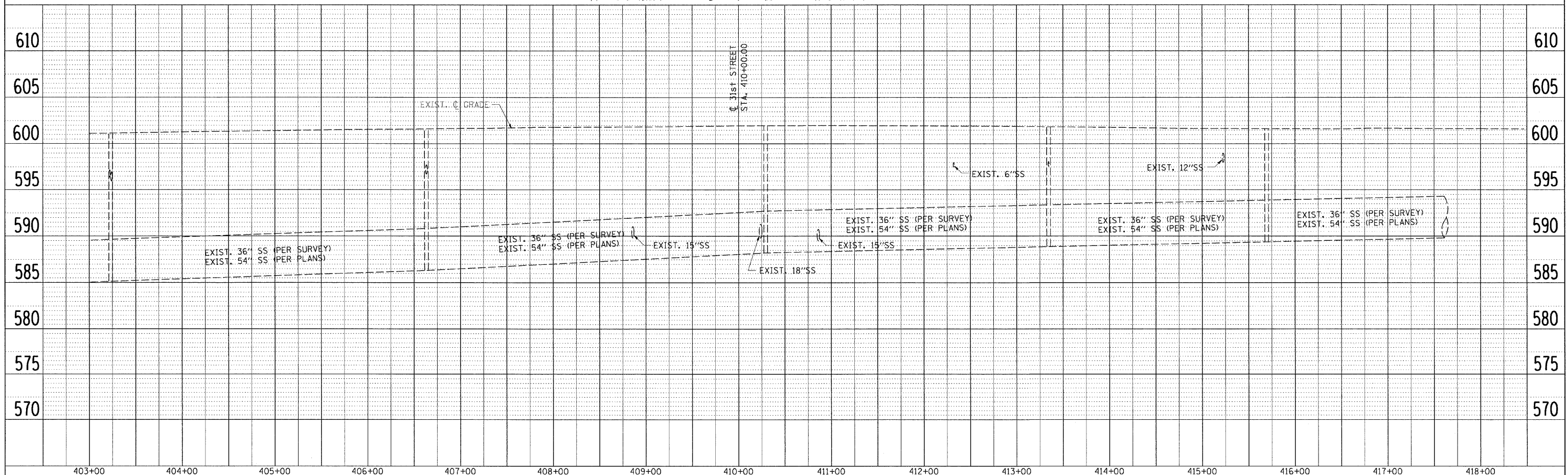

CICERO AVENUE - PROPOSED DRAINAGE AND UTILITY PLAN AND PROFILE