

BENCHMARK BM103
Set chiseled cross on sidewalk on NE corner of
the intersection of 31st Street and Kostner Avenue
Sta. 230+77.59, 27.33' Lt. El. 596.16

EXISTING STRUCTURE: SN. 016-0871 originally built in 1957
under section 159-1010.1B M.F.T. The Structure is
a seven-span steel multi-girder bridge. The bridge is
approximately 495'-11" feet long (back to back of abutments),
and 60' wide (out to out of deck)
Traffic to be maintained during the rehabilitation
using stage construction.
No salvage.

EARTHTECH A tyco INTERNATIONAL LTD. COMPANY	F.A.U. RTE.	SECTION	COUNTY	TOTAL SHEETS	SHEET NO.
	1463	1010.1B	COOK	171	76
STA.		TO STA.		CONTRACT NO. 62196	
FED. ROAD DIST. NO.		ILLINOIS		FED. AID PROJECT	
SI of S30					

LOADING HS20-44

Allow 50#/sq. ft. for future wearing surface.

DESIGN SPECIFICATIONS

2002 AASHTO Standard Specifications for Highway Bridges

DESIGN STRESSES

(NEW CONSTRUCTION)

$f_c = 3,500$ psi
 $f_y = 36,000$ psi (AASHTO M270, Gr. 36)
 $f_y = 60,000$ psi (reinforcement)

(EXISTING CONSTRUCTION)

$f_c = 800$ psi (w/Earth pressure)
 $f_y = 33,000$ psi (structural steel)
 $f_y = 40,000$ psi (reinforcement)

SEISMIC DATA

Seismic Performance Category (SPC) = A
Bedrock Acceleration Coefficient (A) = 0.04g
Site Coefficient (S) = 1.0

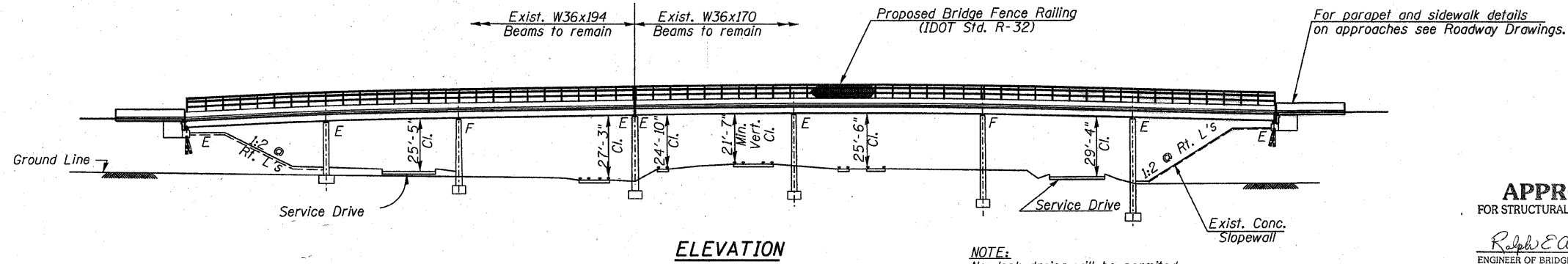

APPROVED
FOR STRUCTURAL ADEQUACY ONLY

Ralph E. Anderson
ENGINEER OF BRIDGES AND STRUCTURES

NOTE:
No deck drains will be permitted
in spans over tracks or within
10' of cross arms of railroad
pole line.

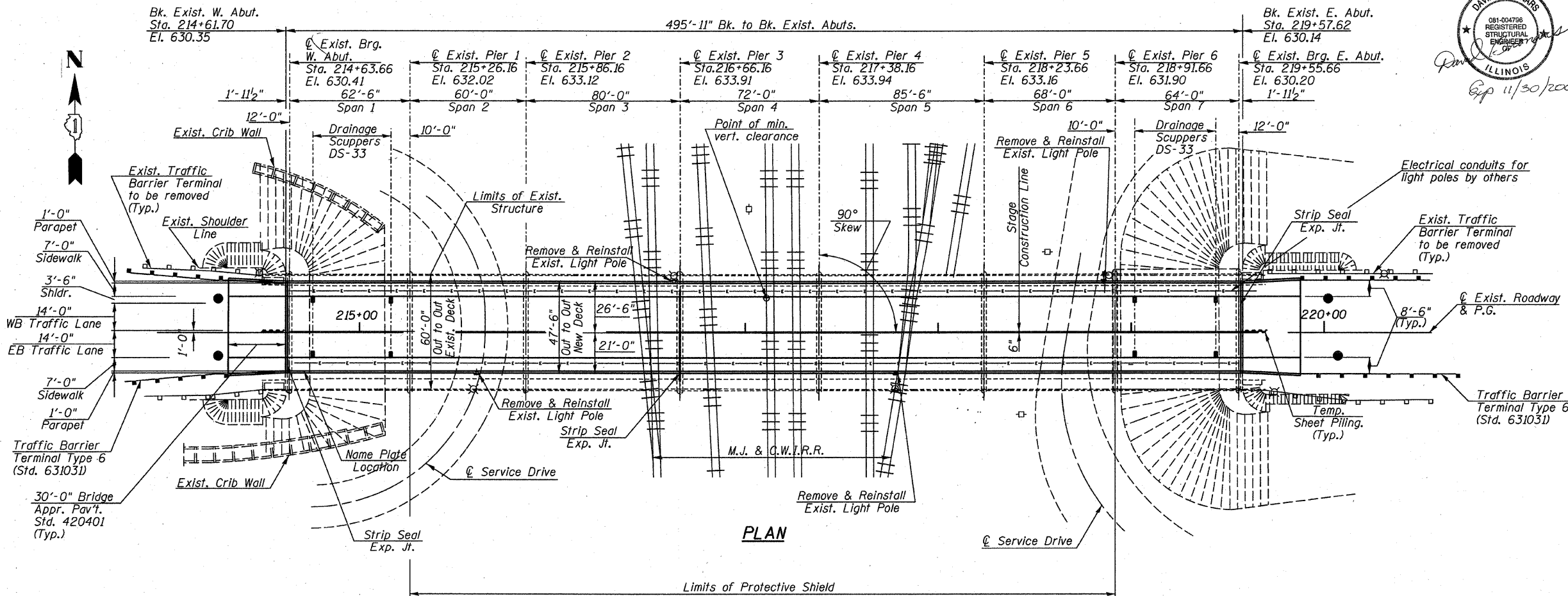

DAVID S. BROWARS
081-004798
REGISTERED
STRUCTURAL
ENGINEER
ILLINOIS
Exp 11/30/2008

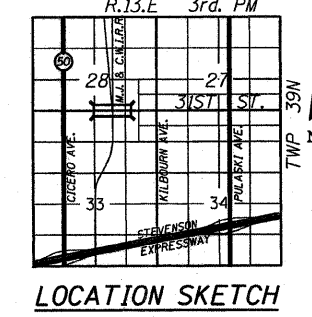
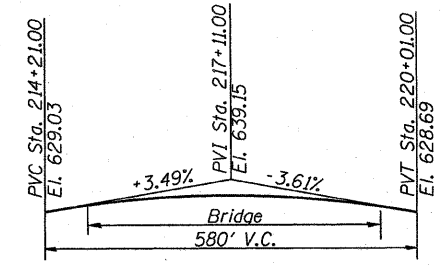

- Notes:
- For approach pavement, see roadway drawings.
 - For quantity of "Remove & Reinstall Light Poles", see roadway drawings.

REVISIONS	
NAME	DATE

ILLINOIS DEPARTMENT OF TRANSPORTATION
GENERAL PLAN & ELEVATION
31 ST. STREET OVER M.J. & C.W.I.R.R.
F.A.U. ROUTE 1463 SECTION 159-1010.1B
COOK COUNTY
STATION 217+09.66
STR. NO. 016-0871
SCALE: VERT. DRAWN BY JHR
 HORIZ. CHECKED BY CLS
DATE: JANUARY 2008