

F.A.L. NO.	SECTION	COUNTY	TOTAL SHEETS	SHEET NO.
2906	02-00077-00-WR	COOK	073	018
STA. 13+25		TO STA. 22+44.15		
FED. ROAD DIST. NO. 1		ILLINOIS	FED. AID PROJECT M-8003(596)	

CONTRACT #63061



201	STA 14+03.97, 25' RT INLET TA, T24 F&G RIM ELEV = 603.39 W 12" INV = 598.89	208	STA 18+50, 40' RT CB TC, T8G RIM ELEV = 600.45 SW 12" INV = 596.95
202	STA 14+03.97, 26.61' LT MH TA, 7" DIA, T24 F&G RIM EL = 603.39 N-S 54" INV = 596.48 E 4" INV = 600.31 E 12" INV = 598.65	209	STA 17+92.50, 23.5' RT CB TA, 4" DIA, T24 F&G RIM ELEV = 603.32 W 12" INV = 596.57 NE 12" INV = 596.67
203	STA 15+50, 38.95' RT CB TA, 4" DIA, T24 F&G RIM ELEV = 601.11 SW 12" INV = 597.61	210	STA 17+92.50, 23.50' LT CB TA, 4" DIA, T24 F&G RIM ELEV = 601.08 E 12" INV = 597.58 (EXTENSION OF EXISTING PIPE)
204	STA 15+00, 23.5' RT CB TA, 4" DIA, T24 F&G RIM ELEV = 603.69 NE 12" INV = 597.37 W 12" INV = 597.27	211	STA 20+67.34, 39.38' LT CB TC, T8G RIM ELEV = 601.08 E 12" INV = 597.58
205	STA 15+00, 26.66' LT MH TA, 7" DIA, T24 F&G RIM ELEV = 603.69 N-S 54" INV = 596.36 E 12" INV = 597.03	212	STA 21+60.67, 25' RT INLET TA, T24 F&G RIM ELEV = 603.71 W 12" INV = 599.21
206	STA 17+00, 25' RT INLET TA, T24 F&G RIM ELEV = 603.69 W 12" INV = 599.19	213	STA 21+60.67, 27.78' LT MH TA, 8" DIA, T24 F&G RIM ELEV = 603.71 N-S 54" INV = 595.78 E 4" INV = 600.71 E 12" INV = 598.97
207	STA 17+00, 27.75' LT MH TA, 8" DIA, T24 F&G RIM ELEV = 603.69 N-S 54" INV = 596.08 E 12" INV = 598.95		

BENCH MARK: #38
 SQUARE CUT IN SOUTH EDGE OF CONC. BASE OF R.R. SIGNAL, THE WEST OF THE TWO. N.E. CORNER VINCENNES RD. AND TAFT DR. ELEVATION = 606.50

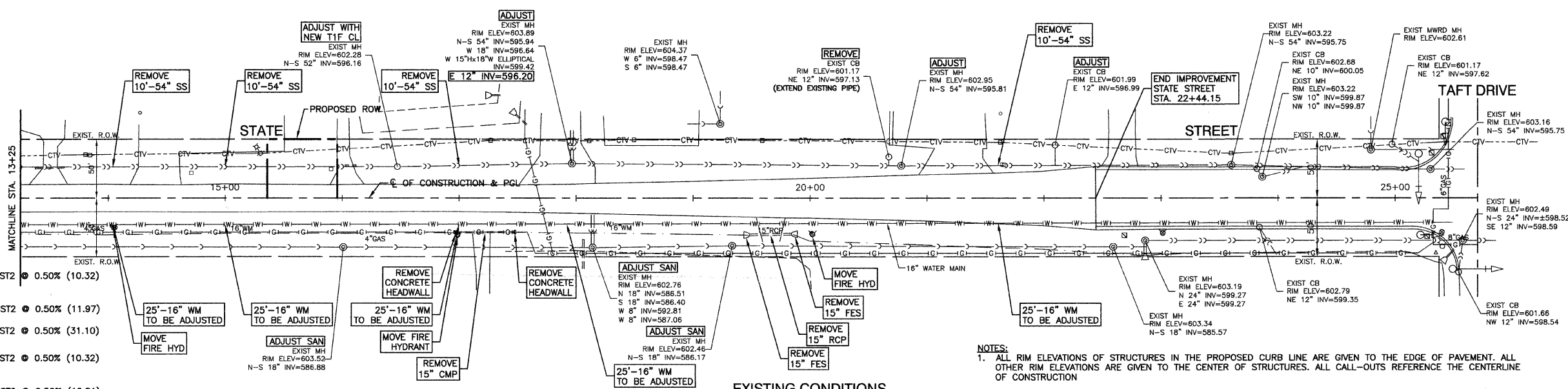

- NOTES:**
- ALL RIM ELEVATIONS OF STRUCTURES IN THE PROPOSED CURB LINE ARE GIVEN TO THE EDGE OF PAVEMENT. ALL OTHER RIM ELEVATIONS ARE GIVEN TO THE CENTER OF STRUCTURES. ALL CALL-OUTS REFERENCE THE CENTERLINE OF CONSTRUCTION
 - (XX.X) DENOTES CUBIC YARDS OF TRENCH BACKFILL
 - [XX' WMR] DENOTES WATER MAIN REQUIREMENT STORM SEWER PIPE, AS DESCRIBED IN THE SPECIAL PROVISIONS
 - THERE ARE EXISTING 12KV OVERHEAD FACILITIES AND APPROXIMATELY 3 POLES IN CONFLICT WITH THE SUBJECT IMPROVEMENT. THE CONTRACTORS SHOULD USE CAUTION IN OPERATING CRANES OR OTHER EQUIPMENT NEAR COMED OVERHEAD FACILITIES.

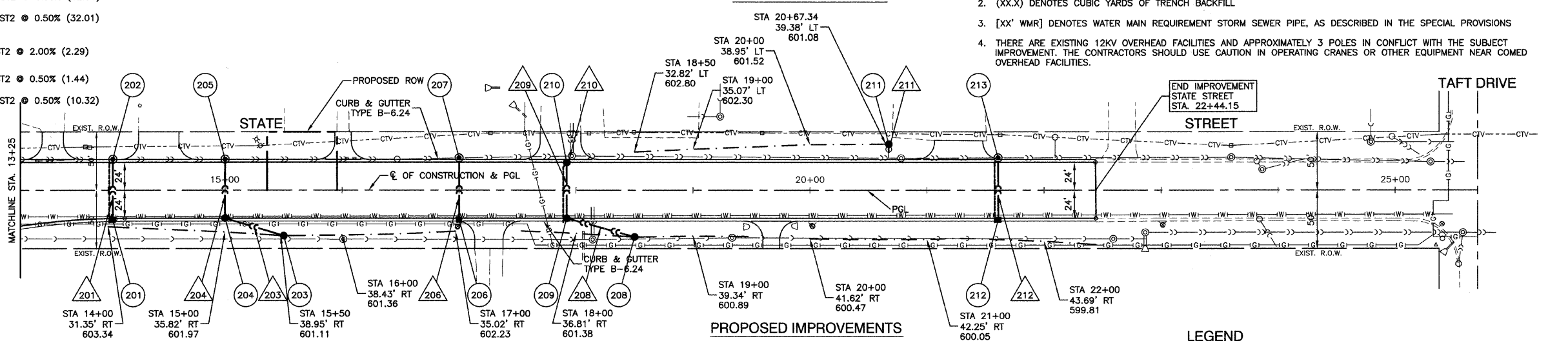

LEGEND

ADJUST	ADJUST STORM SEWER STRUCTURE FRAME AND LID
ADJUST SAN	ADJUST SANITARY SEWER STRUCTURE FRAME AND LID
PPR	POWER POLE TO BE RELOCATED BY OTHERS
TPR	TELEPHONE POLE TO BE RELOCATED BY OTHERS
---	4" PIPE UNDERDRAIN

201	34' - 12" SST2 @ 0.50% (10.32) [14' WMR]
203	48' - 12" SST2 @ 0.50% (11.97)
204	32' - 12" SST2 @ 0.50% (31.10) [16' WMR]
206	34' - 12" SST2 @ 0.50% (10.32) [14' WMR]
208	56' - 12" SST2 @ 0.50% (12.81)
209	30' - 12" SST2 @ 0.50% (32.01) [16' WMR]
210	2' - 12" SST2 @ 2.00% (2.29)
211	5' - 12" SST2 @ 0.50% (1.44)
212	33' - 12" SST2 @ 0.50% (10.32) [15' WMR]

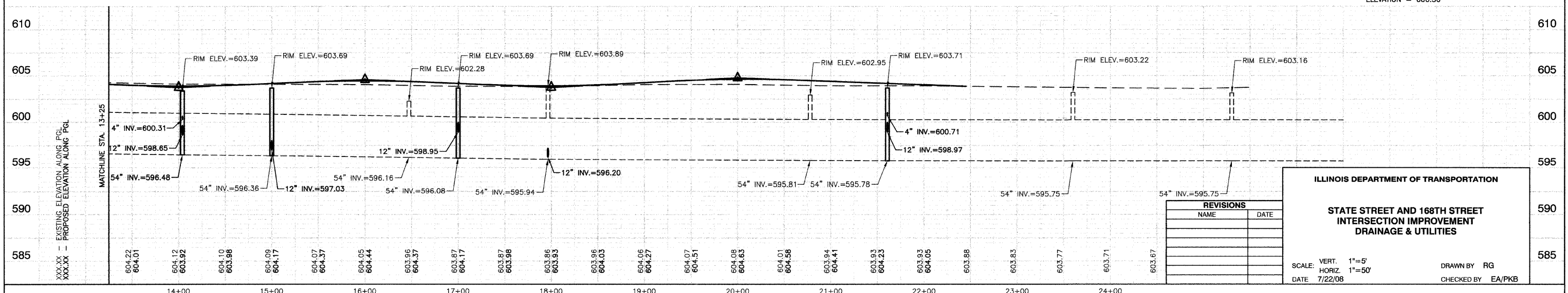

REVISIONS	
NAME	DATE

ILLINOIS DEPARTMENT OF TRANSPORTATION

STATE STREET AND 168TH STREET INTERSECTION IMPROVEMENT DRAINAGE & UTILITIES

SCALE: VERT. 1"=5'
 HORIZ. 1"=50'
 DATE 7/22/08

DRAWN BY RG
 CHECKED BY EA/PKB