

F. A. U. RE.	SECTION	COUNTY	TOTAL SHEETS	SHEET NO.
2906	02-0077-00-WR	COOK	073	024
STA.	TO STA.			
FED. ROAD DIST. NO. 1	SLURRY	FED. AID PROJECT	M-8003(596)	

CONTRACT #63061

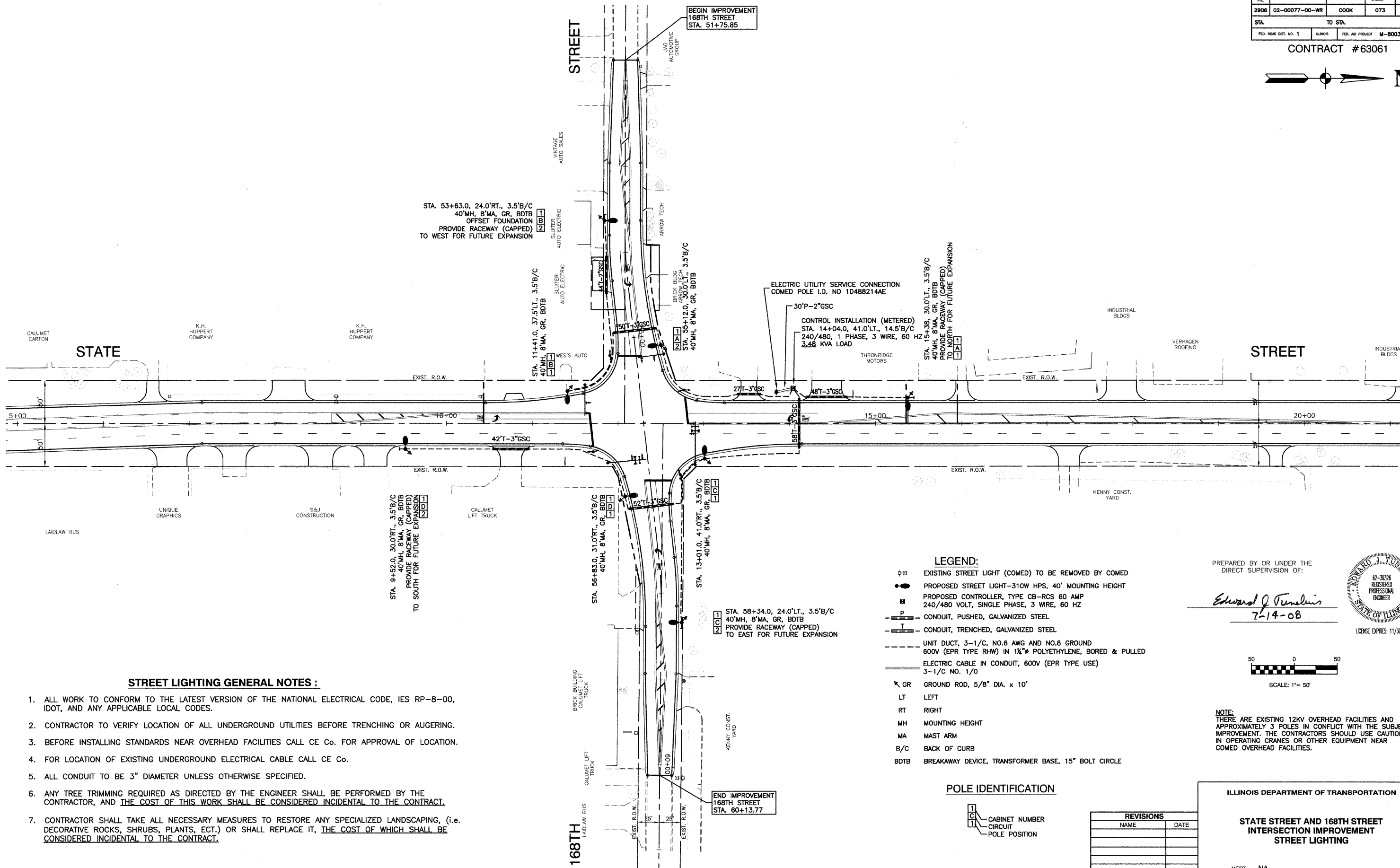
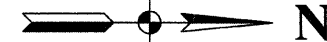

STREET LIGHTING GENERAL NOTES :

1. ALL WORK TO CONFORM TO THE LATEST VERSION OF THE NATIONAL ELECTRICAL CODE, IES RP-8-00, IDOT, AND ANY APPLICABLE LOCAL CODES.
2. CONTRACTOR TO VERIFY LOCATION OF ALL UNDERGROUND UTILITIES BEFORE TRENCHING OR AUGERING.
3. BEFORE INSTALLING STANDARDS NEAR OVERHEAD FACILITIES CALL CE Co. FOR APPROVAL OF LOCATION.
4. FOR LOCATION OF EXISTING UNDERGROUND ELECTRICAL CABLE CALL CE Co.
5. ALL CONDUIT TO BE 3" DIAMETER UNLESS OTHERWISE SPECIFIED.
6. ANY TREE TRIMMING REQUIRED AS DIRECTED BY THE ENGINEER SHALL BE PERFORMED BY THE CONTRACTOR, AND THE COST OF THIS WORK SHALL BE CONSIDERED INCIDENTAL TO THE CONTRACT.
7. CONTRACTOR SHALL TAKE ALL NECESSARY MEASURES TO RESTORE ANY SPECIALIZED LANDSCAPING, (i.e. DECORATIVE ROCKS, SHRUBS, PLANTS, ECT.) OR SHALL REPLACE IT, THE COST OF WHICH SHALL BE CONSIDERED INCIDENTAL TO THE CONTRACT.

- LEGEND:**
- ⊕-⊕ EXISTING STREET LIGHT (COMED) TO BE REMOVED BY COMED
 - PROPOSED STREET LIGHT-310W HPS, 40' MOUNTING HEIGHT
 - ⊠ PROPOSED CONTROLLER, TYPE CB-RCS 60 AMP 240/480 VOLT, SINGLE PHASE, 3 WIRE, 60 HZ
 - P- CONDUIT, PUSHED, GALVANIZED STEEL
 - T- CONDUIT, TRENCHED, GALVANIZED STEEL
 - - - UNIT DUCT, 3-1/C, NO.6 AWG AND NO.8 GROUND 600V (EPR TYPE RHW) IN 1 1/2" POLYETHYLENE, BORED & PULLED
 - ELECTRIC CABLE IN CONDUIT, 600V (EPR TYPE USE) 3-1/C NO. 1/0
 - GR GROUND ROD, 5/8" DIA. x 10'
 - LT LEFT
 - RT RIGHT
 - MH MOUNTING HEIGHT
 - MA MAST ARM
 - B/C BACK OF CURB
 - BDTB BREAKAWAY DEVICE, TRANSFORMER BASE, 15" BOLT CIRCLE

POLE IDENTIFICATION

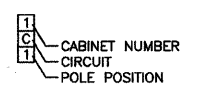

PREPARED BY OR UNDER THE DIRECT SUPERVISION OF:
Edward J. Funelin
7-14-08

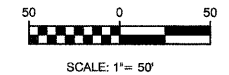

NOTE:
THERE ARE EXISTING 12KV OVERHEAD FACILITIES AND APPROXIMATELY 3 POLES IN CONFLICT WITH THE SUBJECT IMPROVEMENT. THE CONTRACTORS SHOULD USE CAUTION IN OPERATING CRANES OR OTHER EQUIPMENT NEAR COMED OVERHEAD FACILITIES.

ILLINOIS DEPARTMENT OF TRANSPORTATION

STATE STREET AND 168TH STREET INTERSECTION IMPROVEMENT STREET LIGHTING

SCALE: VERT. NA
HORIZ. 1"=50'
DATE: 6/4/08
DRAWN BY: RG/PS
CHECKED BY: MRS

REVISIONS	
NAME	DATE